

Submit to Appropriate  
District Office  
State Lease - 6 copies  
Fee Lease - 5 copies

State of New Mexico  
Energy, Minerals and Natural Resources Department

Form C-101  
Revised 1-1-89

OIL CONSERVATION DIVISION

P.O. Box 2088  
Santa Fe, New Mexico 87504-2088

DISTRICT I  
P.O. Box 1980, Hobbs, NM 88240

DISTRICT II  
P.O. Drawer DD, Artesia, NM 88210

DISTRICT III  
1000 Rio Brazos Rd., Aztec, NM 87410

API NO. (assigned by OCD on New Wells)

30-025-31550

5. Indicate Type of Lease

STATE ☒

FEE ☐

6. State Oil & Gas Lease No.

B 2359

APPLICATION FOR PERMIT TO DRILL, DEEPEN, OR PLUG BACK

1a. Type of Work:

DRILL ☒

RE-ENTER ☐

DEEPEN ☐

PLUG BACK ☐

b. Type of Well:

OIL

WELL ☒

GAS

WELL ☐

OTHER ☐

SINGLE  
ZONE ☐

MULTIPLE  
ZONE ☐

2. Name of Operator

Greenhill Petroleum Corporation

3. Address of Operator

11490 Westheimer, Suite 200; Houston, Tx. 77077

7. Lease Name or Unit Agreement Name

Lovington San Andres Unit

8. Well No.

#84

9. Pool name or Wildcat

Lovington Grayburg San Andres

4. Well Location

Unit Letter B : 1290 Feet From The North Line and 2490 Feet From The East Line

Section 1 Township 17 South Range 36 East NMPM Lea, County

10. Proposed Depth

5150'

11. Formation

San Andres

12. Rotary or C.T.

13. Elevations (Show whether DF, RT, GR, etc.)

3830

14. Kind & Status Plug. Bond

On File

15. Drilling Contractor

TBD

16. Approx. Date Work will start

4/92

17.

PROPOSED CASING AND CEMENT PROGRAM

SIZE OF HOLE	SIZE OF CASING	WEIGHT PER FOOT	SETTING DEPTH	SACKS OF CEMENT	EST. TOP
12 1/2	8 5/8	24	1300'	550	Surface
7 7/8	5 1/2	15.5	5150'	1000	Surface

IN ABOVE SPACE DESCRIBE PROPOSED PROGRAM: IF PROPOSAL IS TO DEEPEN OR PLUG BACK, GIVE DATA ON PRESENT PRODUCTIVE ZONE AND PROPOSED NEW PRODUCTIVE ZONE. GIVE BLOWOUT PREVENTER PROGRAM, IF ANY.

I hereby certify that the information above is true and complete to the best of my knowledge and belief.

SIGNATURE

*Michael J. Newport*

TITLE Land Manager-Permian Basin

DATE 3-23-92

(713)

TYPE OR PRINT NAME

Michael J. Newport

TELEPHONE NO. 589-8484

(This space for State Use)

PERMITS SECTION

APR 06 '92

APPROVED BY

TITLE

DATE

CONDITIONS OF APPROVAL, IF ANY:

NSL-3108

Permit Expires 6 Months From Approval  
Date Unless Drilling Underway.

GREENHILL PETROLEUM CORPORATION  
BOP PROGRAM FOR  
LOVINGTON SAN ANDRES UNIT NUMBER 84

<u>CASING PROGRAM</u>				<u>BOP PROGRAM</u>	
<u>Size</u>	<u>Depth</u>	<u>Wt.</u>	<u>Grade</u>	<u>Configuration</u>	<u>Test Pressure</u>
8 5/8"	1300'	24	H40, STC	RA*	200 psi
5 1/2"	5150'	15.5	K55, STC	RR*	250/1500 psi

\*RR-Ram Ram

RA-Ram Annular

Diverter-Hydrill may be substituted for a diverter.

sjs:s  
92.222

## OIL CONSERVATION DIVISION

P.O. Box 2088  
Santa Fe, New Mexico 87504-2088

### DISTRICT I

P.O. Box 1980, Hobbs, NM 88240

### DISTRICT II

P.O. Drawer DD, Artesia, NM 88210

### DISTRICT III

1000 Rio Brazos Rd., Aztec, NM 87410

## WELL LOCATION AND ACREAGE DEDICATION PLAT

All Distances must be from the outer boundaries of the section

Operator Greenhill Petroleum Corp.			Lease Lovington San Andres Unit		Well No. 84
Unit Letter B	Section 1	Township 17 South	Range 36 East	County Lea	
Actual Footage Location of Well: 1290 feet from the north line and 2490 feet from the east line					
Ground Level Elev. 3830.3'	Producing Formation San Andres		Pool Lovington Grayburg San Andres	Dedicated Acreage: 39.8640 Acres	

- Outline the acreage dedicated to the subject well by colored pencil or hatchure marks on the plat below.
- If more than one lease is dedicated to the well, outline each and identify the ownership thereof (both as to working interest and royalty).
- If more than one lease of different ownership is dedicated to the well, have the interest of all owners been consolidated by communitization, unitization, force-pooling, etc.?  
☒ Yes ☐ No If answer is "yes" type of consolidation unitized

If answer is "no" list of owners and tract descriptions which have actually been consolidated. (Use reverse side of this form necessary.)

No allowable will be assigned to the well unit all interests have been consolidated (by communitization, unitization, forced-pooling, otherwise) or until a non-standard unit, eliminating such interest, has been approved by the Division.

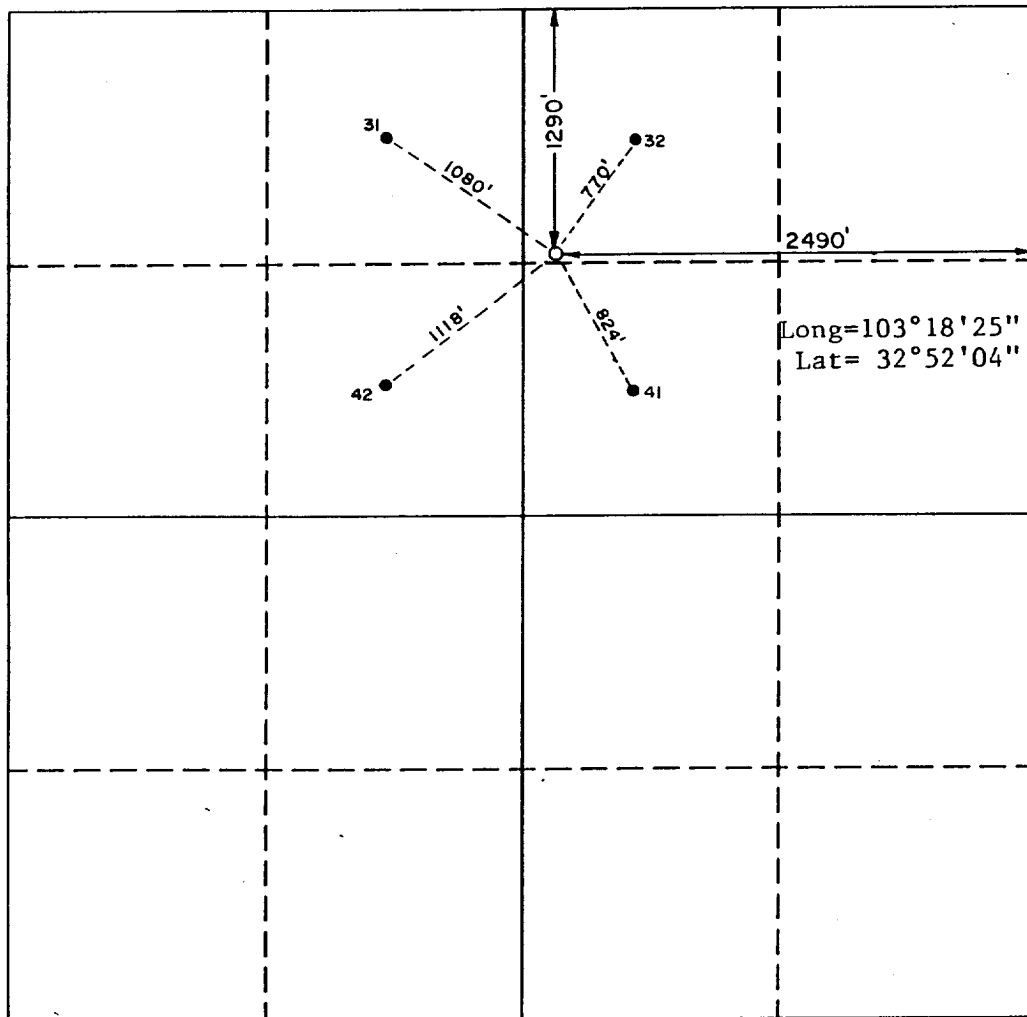

### OPERATOR CERTIFICATION

I hereby certify the the information contained herein is true and complete to the best of my knowledge and belief.

Signature

Printed Name

Michael J. Newport

Position

Land Manager-Permian Basin

Company

Greenhill Petroleum Corp.

Date

3-23-92

### SURVEYOR CERTIFICATION

I hereby certify that the well location shown on this plat was plotted from field notes of actual surveys made by me or under my supervision, and that the same is true and correct to the best of my knowledge and belief.

Date Surveyed

February 27, 1992

Signature & Seal of  
Professional Surveyor

REGISTERED LAND SURVEYOR  
No. 976  
JOHN M. WEST  
Certificate No. 3239  
RONALD J. EDSON  
RONALD J. EDSON  
GARY C. JONES, 7877

W.O. 92-11-0245

0 330 660 990 1320 1650 1980 2310 2640 2000 1500 1000 500 0