

Submit to Appropriate
District Office
State Lease - 4 copies
Fee Lease - 3 copies

State of New Mexico
Energy, Minerals and Natural Resources Department

Form C-102
Revised 1-1-87

OIL CONSERVATION DIVISION

P.O. Box 2088
Santa Fe, New Mexico 87504-2088

DISTRICT I
P.O. Box 1960, Hobbs, NM 88240

DISTRICT II
P.O. Drawer DD, Artesia, NM 88210

DISTRICT III
1000 Rio Brazos Rd., Artesia, NM 87410

WELL LOCATION AND ACREAGE DEDICATION PLAT

All Distances must be from the outer boundaries of the section

Operator AMTEX ENERGY, Inc.			Lease RECORD		Well No. 1
Unit Letter K	Section 26	Township 19 SOUTH	Range 35 EAST	County NMPM	LEA
Actual Footage Location of Well: 2030 feet from the SOUTH line and 2310 feet from the WEST line					
Ground Level Elev. 3710.0'	Producing Formation Wolfcamp	Pool South Wildcat Pearl Wolfcamp			Dedicated Acreage: 40 Acres

- Outline the acreage dedicated to the subject well by colored pencil or hatchure marks on the plat below.
- If more than one lease is dedicated to the well, outline each and identify the ownership thereof (both as to working interest and royalty).
- If more than one lease of different ownership is dedicated to the well, have the interest of all owners been consolidated by communization, unitization, force-pooling, etc.?
☐ Yes ☐ No If answer is "yes" type of consolidation _____
If answer is "no" list of owners and tract descriptions which have actually been consolidated. (Use reverse side of this form necessary.)
No allowable will be assigned to the well unit all interests have been consolidated (by communization, unitization, forced-pooling, otherwise) or until a non-standard unit, eliminating such interest, has been approved by the Division.

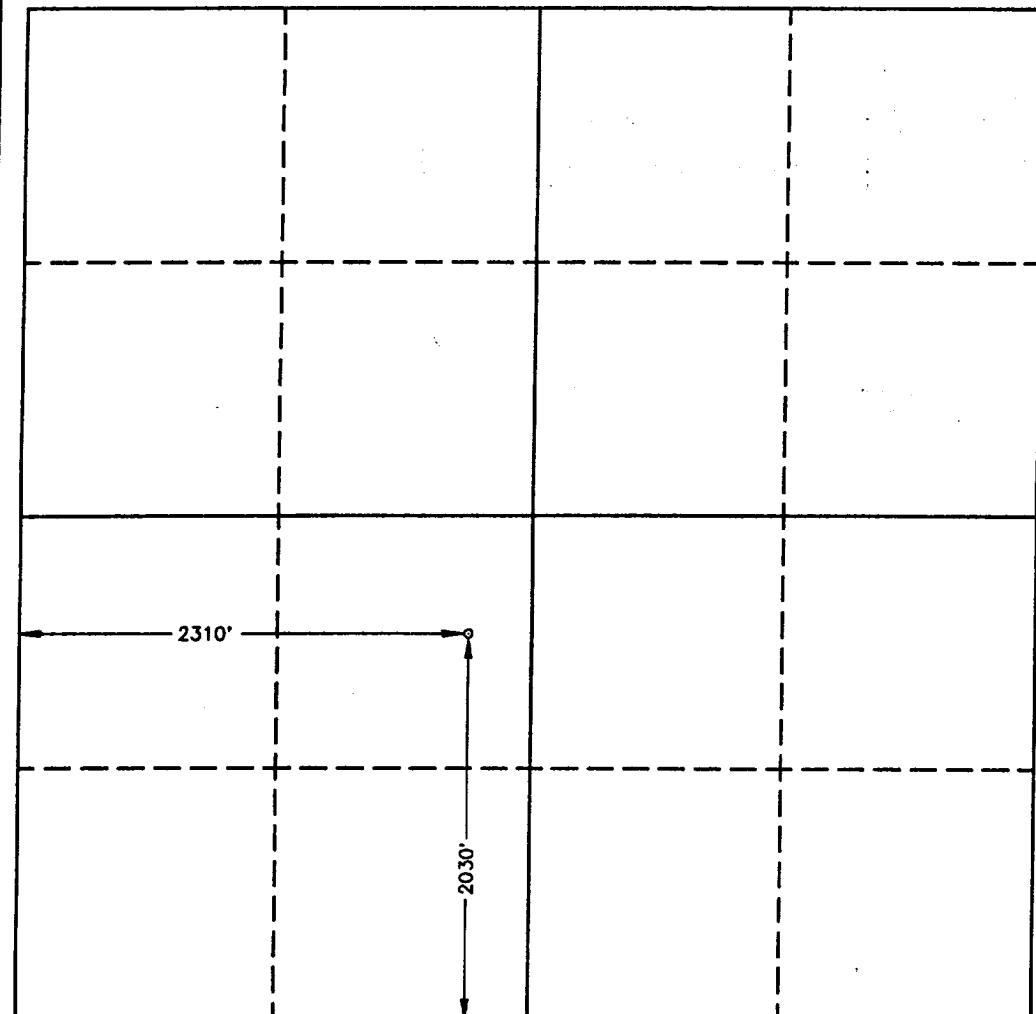

OPERATOR CERTIFICATION

I hereby certify the the information
contained herein is true and complete to the
best of my knowledge and belief.

Signature
William J. Savage

Printed Name
William J. Savage

Position
President

Company
Amtext Energy, Inc.

Date
10/29/92

SURVEYOR CERTIFICATION

I hereby certify that the well location shown
on this plat was plotted from field notes of
actual survey made by me or under my
supervision, and that the same is true and
correct to the best of my knowledge and
belief.

Date Surveyed
OCTOBER 10, 1992

Signature & Seal of
Professional Surveyor

Ronald J. Eison
Certificate No. JOHN W. WEST, 676
RONALD J. EISON, 3238
GARY L. JONES, 7977

92-11-1554

100-3943

ELF

RECEIVED

OCT 30 1992

OCD HOBBS OFFICE