

Submit to Appropriate  
District Office  
State Lease - 4 copies  
Fee Lease - 3 copies

State of New Mexico  
Energy, Minerals and Natural Resources Department

Form C-102  
Revised 1-1-89

OIL CONSERVATION DIVISION

P.O. Box 2088

Santa Fe, New Mexico 87504-2088

DISTRICT I

P.O. Box 1980, Hobbs, NM 88240

DISTRICT II

P.O. Drawer DD, Artesia, NM 88210

DISTRICT III

1000 Rio Brazos Rd., Aztec, NM 87410

WELL LOCATION AND ACREAGE DEDICATION PLAT

All Distances must be from the outer boundaries of the section

Operator PHILLIPS PETROLEUM COMPANY			Lease EAST VACUUM Gb/SA UNIT TRACT 3202		Well No. 021
Unit Letter O	Section 32	Township 17 SOUTH	Range 35 EAST	NMPM	County LEA
Actual Footage Location of Well: 1300 feet from the SOUTH line and 2180 feet from the EAST line					
Ground Level Elev. 3957.4'	Producing Formation San Andres		Pool Vacuum Gb/SA		Dedicated Acreage: 40 Acres

- Outline the acreage dedicated to the subject well by colored pencil or hatchure marks on the plat below.
- If more than one lease is dedicated to the well, outline each and identify the ownership thereof (both as to working interest and royalty).
- If more than one lease of different ownership is dedicated to the well, have the interest of all owners been consolidated by communitization, unitization, force-pooling, etc.?  
☐ Yes ☐ No If answer is "yes" type of consolidation \_\_\_\_\_

If answer is "no" list of owners and tract descriptions which have actually been consolidated. (Use reverse side of this form necessary.)

No allowable will be assigned to the well unit all interests have been consolidated (by communitization, unitization, forced-pooling, otherwise) or until a non-standard unit, eliminating such interest, has been approved by the Division.

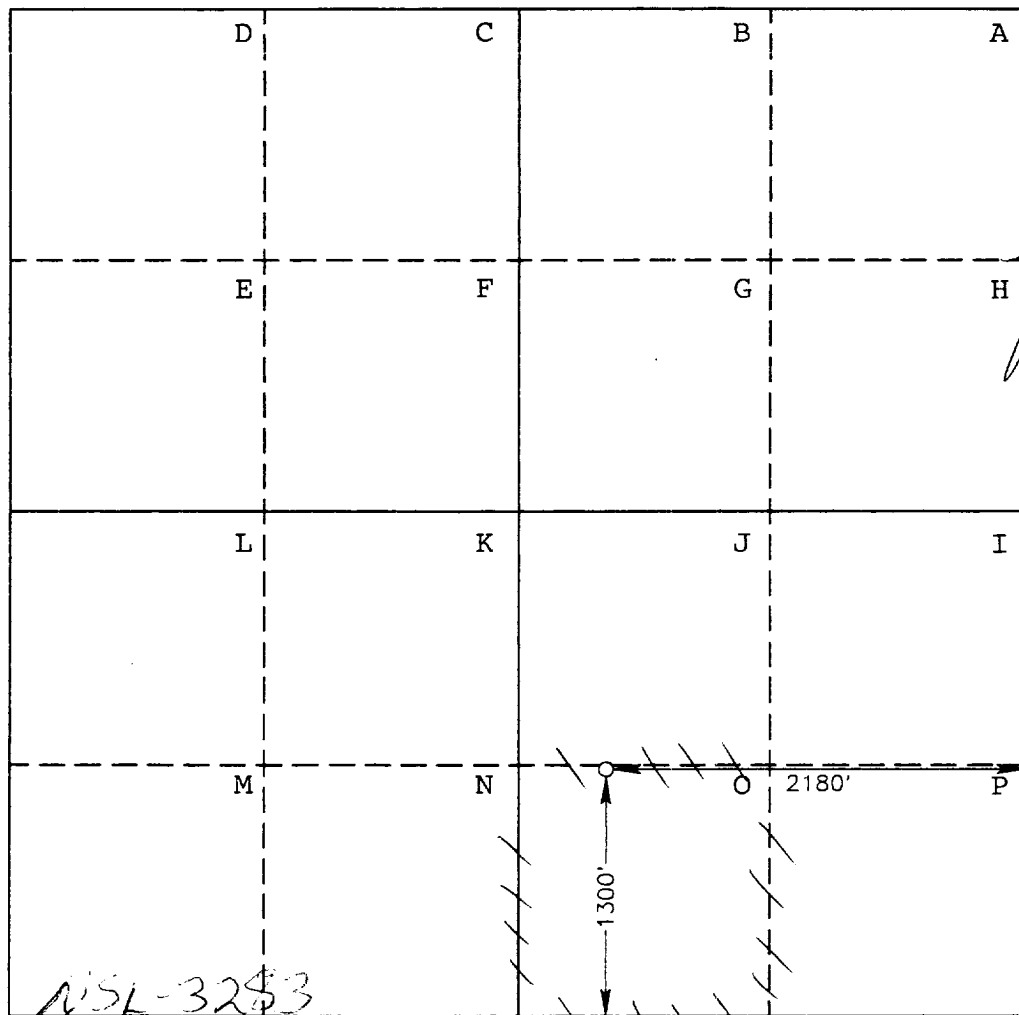

OPERATOR CERTIFICATION

I hereby certify the the information contained herein is true and complete to the best of my knowledge and belief.

Signature

Printed Name

M. M. Sanders

Position

Supv., Reg. Affairs

Company

Phillips Petroleum Co.

Date

June 23, 1993

SURVEYOR CERTIFICATION

I hereby certify that the well location shown on this plat was plotted from field notes of actual surveys made by me or under my supervision, and that the same is true and correct to the best of my knowledge and belief.

Date Surveyed

APRIL 12, 1993

Signature & Seal of  
Professional Surveyor

GARY L. JONES  
NEW MEXICO  
Professional Surveyor  
Certificate No. JOHN W. WEST, 676  
RONALD J. SIDSON, 3239  
GARY L. JONES, 7977

83-11-0514

RECEIVED

MAY 28 1993

HOBBBS  
OFFICE