

District I  
PO Box 1980, Hobbs, NM 88241-1980  
District II  
81. S. 1st Street, Artesia, NM 88210-2834  
District III  
1000 Rio Brazos Rd., Aztec, NM 87410  
District IV  
2040 South Pacheco, Santa Fe, NM 87505

Energy, Minerals & Natural Resources Department

OIL CONSERVATION DIVISION  
2040 South Pacheco  
Santa Fe, NM 87505

Form C  
Revised October 18, 1998  
Instructions on 1  
Submit to Appropriate District Office  
State Lease - 4 Co  
Fee Lease - 3 Co

☐ AMENDED REPORT

WELL LOCATION AND ACREAGE DEDICATION PLAT

<sup>1</sup> API Number 30-025-32311	<sup>2</sup> Pool Code 62320	<sup>3</sup> Pool Name Vacuum, Wolfcamp
<sup>4</sup> Property Code 6483	<sup>5</sup> Property Name Warn St. A/C 1	<sup>6</sup> Well Number 6
<sup>7</sup> OGRID No. 014021	<sup>8</sup> Operator Name Marathon Oil Company	<sup>9</sup> Elevation GL 3979

<sup>10</sup> Surface Location									
UL or lot no. K	Section 31	Township 17S	Range 35E	Lot. Idn	Feet from the 1980	North/South Line South	Feet from the 2030	East/West line West	County Lea

<sup>11</sup> Bottom Hole Location If Different From Surface

UL or lot no.	Section	Township	Range	Lot. Idn	Feet from the	North/South Line	Feet from the	East/West line	County
<sup>12</sup> Dedicated Acres 80	<sup>13</sup> Joint or Infill	<sup>14</sup> Consolidation Code	<sup>15</sup> Order No. SD-98.3						

NO ALLOWABLE WILL BE ASSIGNED TO THIS COMPLETION UNTIL ALL INTERESTS HAVE BEEN CONSOLIDATED OR A NON-STANDARD UNIT HAS BEEN APPROVED BY THE DIVISION

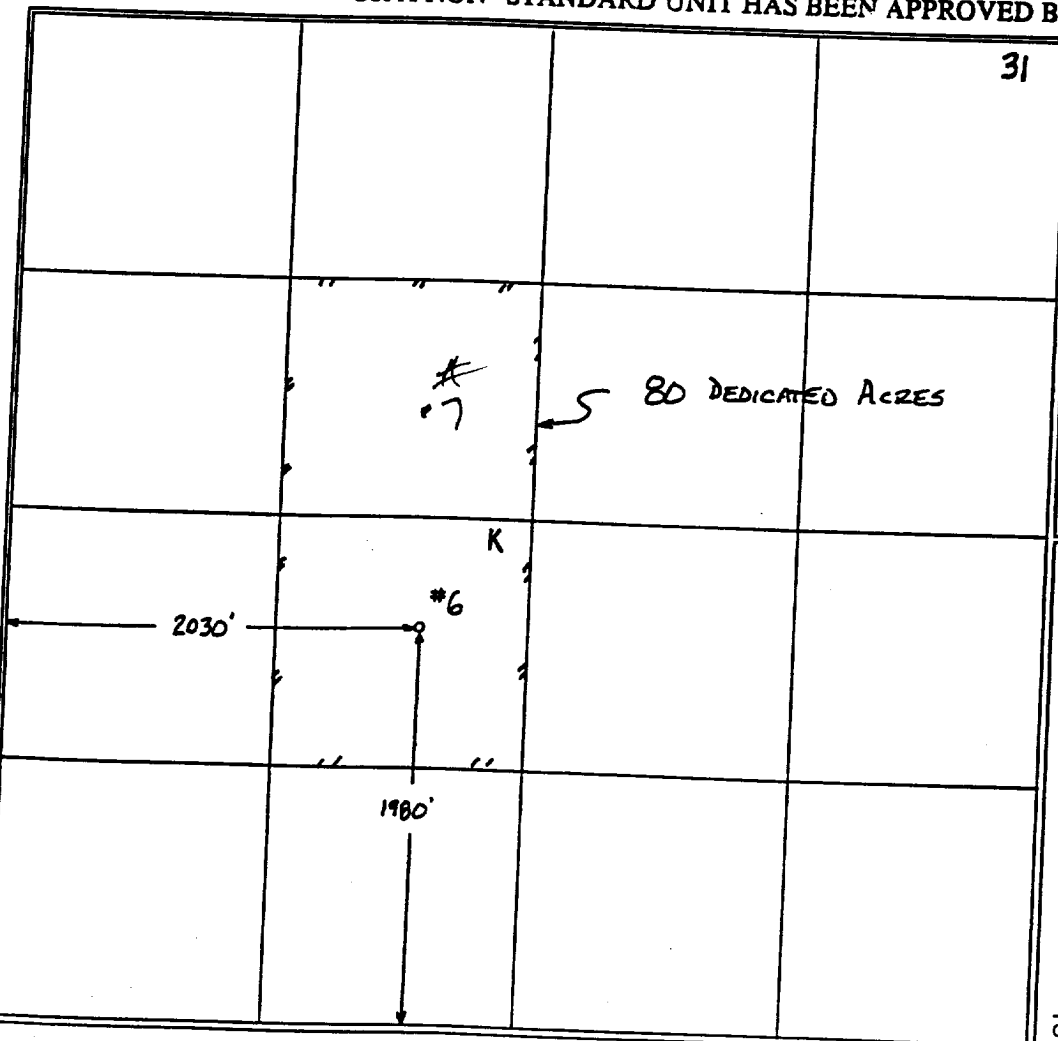

<sup>17</sup> OPERATOR CERTIFICATION  
I hereby certify that the information contained herein is true and complete to the best of my knowledge and belief.

Signature Bryan L. Williams  
Printed Name Bryan L. Williams  
Title Production Engineer  
Date March 10, 1998

<sup>18</sup> SURVEYOR CERTIFICATION  
I hereby certify that the well location shown on this plat was plotted from field notes of actual surveys made by me or under my supervision, and that the same is true and correct to the best of my belief.

Date of Survey \_\_\_\_\_  
Signature and Seal of Professional Surveyor: \_\_\_\_\_  
Certificate Number \_\_\_\_\_

District I  
PO Box 1980, Hobbs, NM 88241-1980  
District II  
811 S. 1st Street, Artesia, NM 88210-2834  
District III  
1000 Rio Brazos Rd., Aztec, NM 87410  
District IV  
2040 South Pacheco, Santa Fe, NM 87505

Energy, Minerals & Natural Resources Department

OIL CONSERVATION DIVISION  
2040 South Pacheco  
Santa Fe, NM 87505

Revised October 18,  
Instructions on  
Submit to Appropriate District O  
State Lease - 4 Co  
Fee Lease - 3 Co

☐ AMENDED REPORT

WELL LOCATION AND ACREAGE DEDICATION PLAT

<sup>1</sup> API Number 30-025-32311	<sup>2</sup> Pool Code 61760	<sup>3</sup> Pool Name Vacuum, Abo
<sup>4</sup> Property Code 6483	<sup>5</sup> Property Name Warn St. A/C 1	<sup>6</sup> Well Number 6
<sup>7</sup> OGRID No. 014021	<sup>8</sup> Operator Name Marathon Oil Company	<sup>9</sup> Elevation GL 3979

<sup>10</sup> Surface Location									
UL or lot no. K	Section 31	Township 17S	Range 35E	Lot. Idn	Feet from the 1980	North/South Line South	Feet from the 2030	East/West line West	County Lea

<sup>11</sup> Bottom Hole Location If Different From Surface									
UL or lot no.	Section	Township	Range	Lot. Idn	Feet from the	North/South Line	Feet from the	East/West line	County
<sup>12</sup> Dedicated Acres 80		<sup>13</sup> Joint or Infill	<sup>14</sup> Consolidation Code		<sup>15</sup> Order No. 50-98-3				

NO ALLOWABLE WILL BE ASSIGNED TO THIS COMPLETION UNTIL ALL INTERESTS HAVE BEEN CONSOLIDATED  
OR A NON-STANDARD UNIT HAS BEEN APPROVED BY THE DIVISION

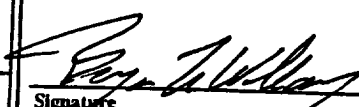
				31		<sup>17</sup> OPERATOR CERTIFICATION I hereby certify that the information contained herein is true and complete to the best of my knowledge and belief.   Signature Bryan L. Williams Printed Name Production Engineer Title March 10, 1998 Date
						<sup>18</sup> SURVEYOR CERTIFICATION I hereby certify that the well location shown on this plat was plotted from field notes of actual surveys made by me or under my supervision, and that the same is true and correct to the best of my belief.  Date of Survey Signature and Seal of Professional Surveyer:  Certificate Number

#7  
#6  
2030'  
1980'  
K  
80 DEDICATED ACRES