

UNITED STATES  
DEPARTMENT OF THE INTERIOR  
BUREAU OF LAND MANAGEMENT

N.M. Oil Cons. Division  
P.O. Box 1980  
Hobbs, NM 88241

FORM APPROVED  
Budget Bureau No. 1004-0135  
Expires March 31, 1993

**SUNDRY NOTICES AND REPORTS ON WELLS**

Do not use this form for proposals to drill or to deepen or reentry to a different reservoir  
Use "APPLICATION FOR PERMIT --" for such proposals

SUBMIT IN TRIPLICATE

1. Type of Well

☒ Oil Well ☐ Gas Well ☐ Other:

2. Name of Operator

Mallon Oil Company

3. Address and Telephone No.

P.O. Box 3256, Carlsbad, NM 88220 (505) 885-4596

4. Location of Well (Footage, Sec., T., R., M., or Survey Description)

1980' FNL and 860' FEL (SE NE) Unit H  
Sec. 34, T19S-R34E

5. Lease Designation and Serial No.  
NM052

6. If Indian, Allotee or Tribe Name

N/A

7. If Unit or CA, Agreement Designation

N/A

8. Well Name and No.

Mallon 34 Federal No. 7

9. Well API No.

30-025-32782

10. Field and Pool, or Exploratory Area

Grayburg

11. County or Parish, State

Lea County, New Mexico

12. CHECK APPROPRIATE BOX(S) TO INDICATE NATURE OF NOTICE, REPORT, OR OTHER DATA

TYPE OF SUBMISSION

- ☒ Notice of Intent  
☐ Subsequent Report  
☐ Final Abandonment Notice

TYPE OF ACTION

- ☐ Abandonment ☐ Change of Plans  
☐ Recompletion ☐ New Construction  
☐ Plugging Back ☐ Non-Routine Fracturing  
☐ Casing Repair ☐ Water Shut-Off  
☐ Altering Casing ☐ Conversion to Injection  
☒ Other: Surface Commingling ☐ Dispose Water

(Note: Report results of multiple completion on Well  
Completion or Recompletion Report and Log form.)

13. Describe Proposed or Completed Operations (Clearly state all pertinent details, and give pertinent dates, including estimated date of starting any proposed work. If well is directionally drilled, give subsurface locations and measured and true vertical depths for all markers and zones pertinent to this zone.)\*

See Attachment.

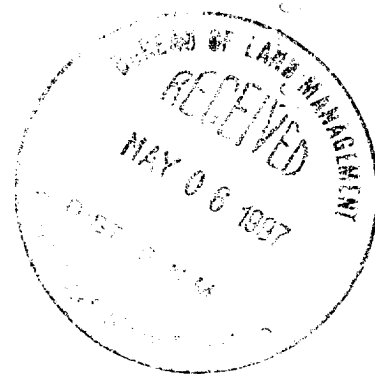

14. I hereby certify that the foregoing is true and correct

Signed

Theresa A. McAndrews  
Theresa A. McAndrews

Title

Office Manager

Date

5-6-97

(THIS SPACE FOR FEDERAL OR STATE OFFICE USE)

Approved By (ORIG. SGD.) DAVID R. GLASS

Title

PETROLEUM ENGINEER

Date

MAY 13 1997

Conditions of approval, if any:

SEE ATTACHED FOR  
CONDITIONS OF APPROVAL

Title 18 U. S. C. Section 1001, makes it a crime for any person knowingly and willfully to make any department or agency of the United States any false, fictitious or fraudulent statements or representations as to any matter within its jurisdiction.

\*See Instruction on Reverse Side

CRA BLM FORMATAPPLICATION FOR SURFACE COMMINGLING,  
OFF LEASE STORAGE AND MEASUREMENT APPROVALThis Format Should Be Attached To A Sundry Notice

To: Bureau of Land Management  
 P. O. Box 1778  
 Carlsbad, New Mexico 88221-1778

Mallon Oil Company (Operator's Name) is requesting approval for surface commingling and off-lease storage and measurement of hydrocarbon production from the following formation(s) and well(s) on Federal Lease No. NM052 ; Lease Name: Mallon 34 Federal

<u>Well</u> <u>No.</u>	<u>Loc.</u>	<u>Sec.</u>	<u>Twp.</u>	<u>Rng.</u>	<u>Formation</u>
<u>7</u>	<u>SENE</u>	<u>34</u>	<u>19S</u>	<u>34E</u>	<u>Grayburg</u>
<u>      </u>	<u>      </u>	<u>      </u>	<u>      </u>	<u>      </u>	<u>      </u>
<u>      </u>	<u>      </u>	<u>      </u>	<u>      </u>	<u>      </u>	<u>      </u>
<u>      </u>	<u>      </u>	<u>      </u>	<u>      </u>	<u>      </u>	<u>      </u>

with hydrocarbon production from the following formation(s) and well(s) on Federal lease No. See Exhibit A ; Lease Name: Mallon 34 Federal

<u>Well</u> <u>No.</u>	<u>Loc.</u>	<u>Sec.</u>	<u>Twp.</u>	<u>Rng.</u>	<u>Formation</u>
<u>See Exhibit A</u>	<u>      </u>	<u>      </u>	<u>      </u>	<u>      </u>	<u>      </u>
<u>      </u>	<u>      </u>	<u>      </u>	<u>      </u>	<u>      </u>	<u>      </u>
<u>      </u>	<u>      </u>	<u>      </u>	<u>      </u>	<u>      </u>	<u>      </u>

Production from the wells involved is as follows:

<u>Well Name and No.</u>	<u>BOPD</u>	<u>Oil Gravity</u>	<u>MCFPD</u>
<u>See Exhibit B</u>	<u>      </u>	<u>      </u>	<u>      </u>
<u>      </u>	<u>      </u>	<u>      </u>	<u>      </u>
<u>      </u>	<u>      </u>	<u>      </u>	<u>      </u>
<u>      </u>	<u>      </u>	<u>      </u>	<u>      </u>
<u>      </u>	<u>      </u>	<u>      </u>	<u>      </u>
<u>      </u>	<u>      </u>	<u>      </u>	<u>      </u>

Continued ...

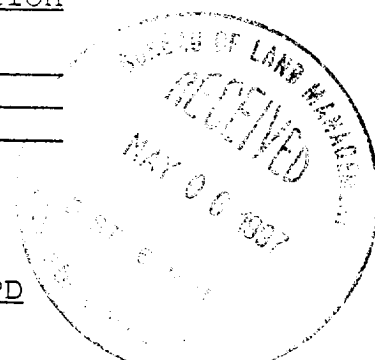

Continued:

The proposed operation is described in detail on the attached diagrams.

A map is enclosed showing the lease numbers and location of all leases and wells that will contribute production to the proposed commingling/common storage facility. All unitized/communitized areas, producing zones/pools are also clearly illustrated.

A schematic diagram is also attached which clearly identifies all equipment that will be utilized.

The storage and measuring facility is located at NE -1/4, Sec.34, T19S, R34E, on lease No. NM052, Lea County, New Mexico. BLM will be notified if there is any future change in the facility location.

Details of the proposed method for allocating production to contributing sources is as follows:

Each wells production is isolated through the test facility on a monthly basis.  
A daily production average is calculated based on the tests and used in  
figuring monthly production.

The working interest owners have been notified of the proposal.

The proposed commingling of production is in the interest of conservation and will not result in reduced royalty or improper measurement of production.

The proposed commingling is necessary for continued operation of the above referenced Federal leases.

We understand that the requested approval will not constitute the granting of any right-of-way or construction rights not granted by the lease instrument. And, we will submit within 30 days an application for right-of-way approval to the BLM's Realty Section in your office if we have not already done so.

Additional wells require additional commingling approvals.

The applicant understands that the approval of this application does not relieve the lessee or operator from any legal obligations he/she may have regarding consent from other interest holders or State regulatory agencies.

Signature

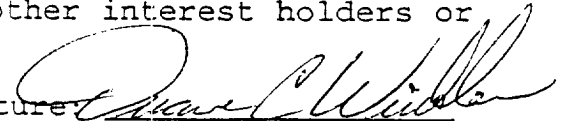

Name: Duane C. Winkler

Title: Operations Manager

Date: May 6, 1997

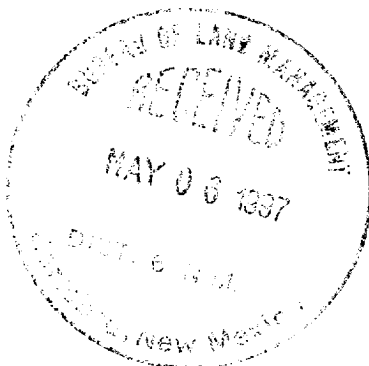

# Exhibit A

Well Name	Lease No.	Location		Formation
Mallon 34 Federal No. 7	NM052	Sec. 34, T19S-R34E	SE/NE	Grayburg
Mallon 34 Federal No. 8	NM052	Sec. 34, T19S-R34E	NW/SE	Delaware
Mallon 34 Federal No. 9	NM052	Sec. 34, T19S-R34E	SW/NE	Delaware
Mallon 34 Federal No. 10	NM052	Sec. 34, T19S-R34E	SE/SE	Delaware
Mallon 34 Federal No. 11	NM052	Sec. 34, T19S-R34E	NW/NE	Delaware
Mallon 34 Federal No. 12	NM052	Sec. 34, T19S-R34E	SW/SE	Delaware
Mallon 34 Federal No. 14	NM57285	Sec. 34, T19S-R34E	SE/SW	Delaware
Mallon 35 Federal No. 1	NM052	Sec. 35, T19S-R34E	NW/NW	Delaware
Mallon 35 Federal No. 3	NM052	Sec. 35, T19S-R34E	NW/SW	Delaware

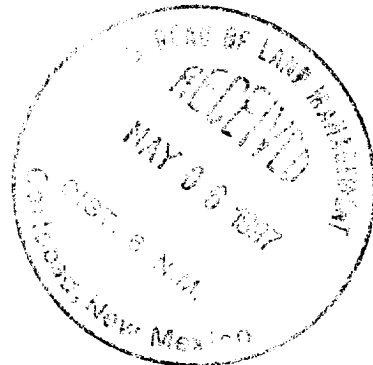

# Exhibit B

Well Name	BOPD	Gravity	MCFD
Mallon 34 Federal No. 7	60		20
Mallon 34 Federal No. 8	9	36.4	5
Mallon 34 Federal No. 9	40	36.4	3
Mallon 34 Federal No. 10	4	36.4	1
Mallon 34 Federal No. 11	37	36.4	67
Mallon 34 Federal No. 12	54	36.4	54
Mallon 34 Federal No. 14	9	36.7	0
Mallon 35 Federal No. 1	12	36.4	8
Mallon 35 Federal No. 3	53	36.4	0



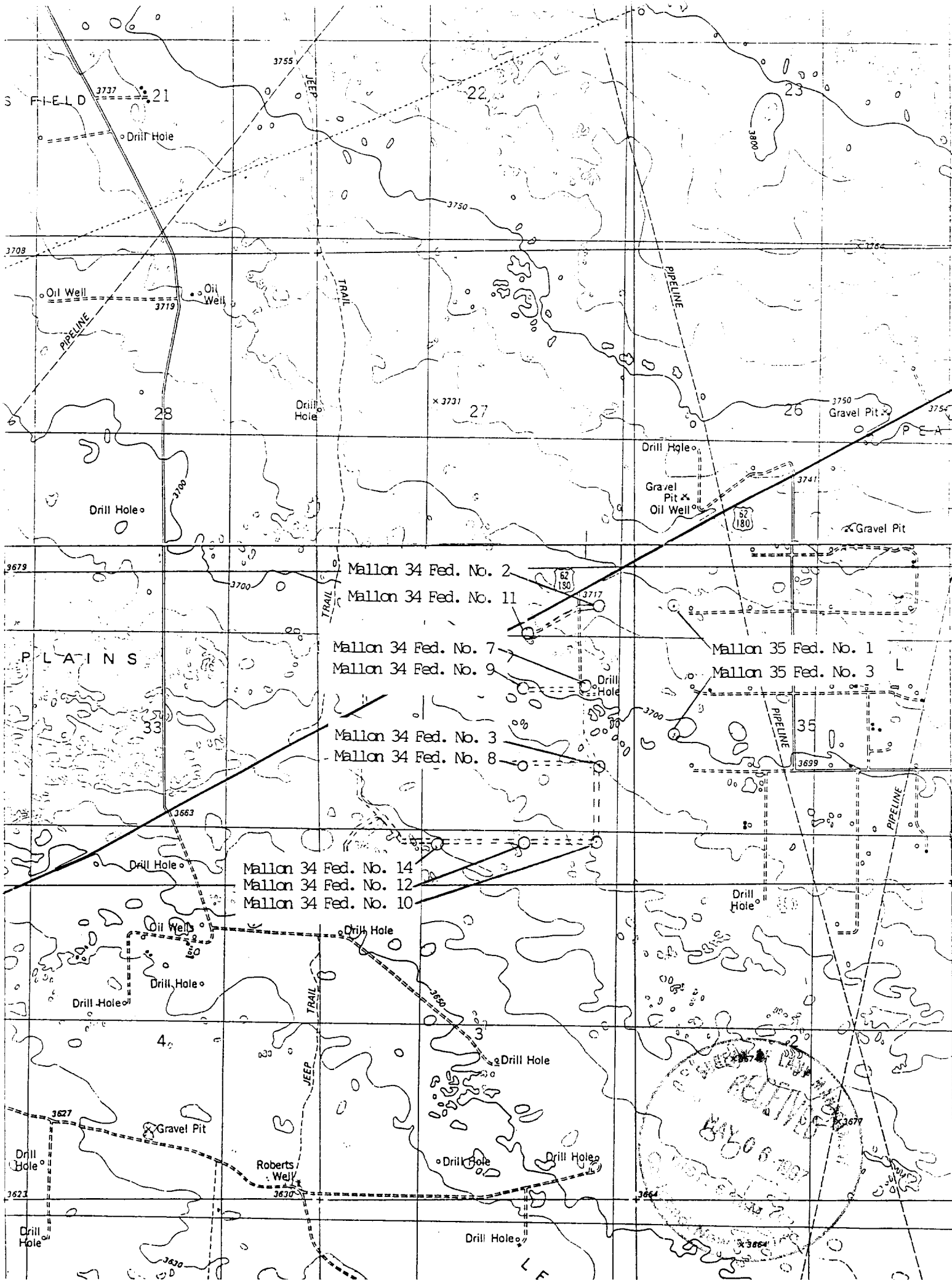

S FIELD 3737 21

3708

28

3679

PLAINS

3663

Drill Hole

3627

3623

Drill Hole

3755

JEEP

TRAIL

Drill Hole

3700

3663

Drill Hole

Drill Hole

3627

3623

Drill Hole

22

3750

27

3717

3700

3663

3627

3623

Drill Hole

23

3750

26

3717

3700

3663

3627

3623

Drill Hole

24

3750

25

3717

3700

3663

3627

3623

Drill Hole

25

3750

26

3717

3700

3663

3627

3623

Drill Hole

26

3750

27

3717

3700

3663

3627

3623

Drill Hole

27

3750

28

3717

3700

3663

3627

3623

Drill Hole

## ENGINEERING CHART

BY \_\_\_\_\_

Mallon 34 Central Battery

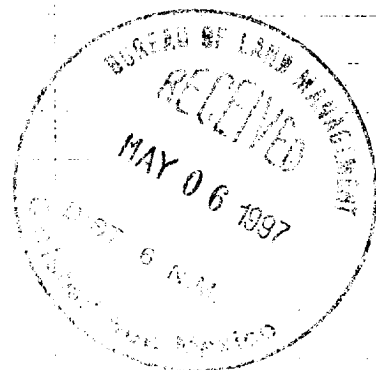
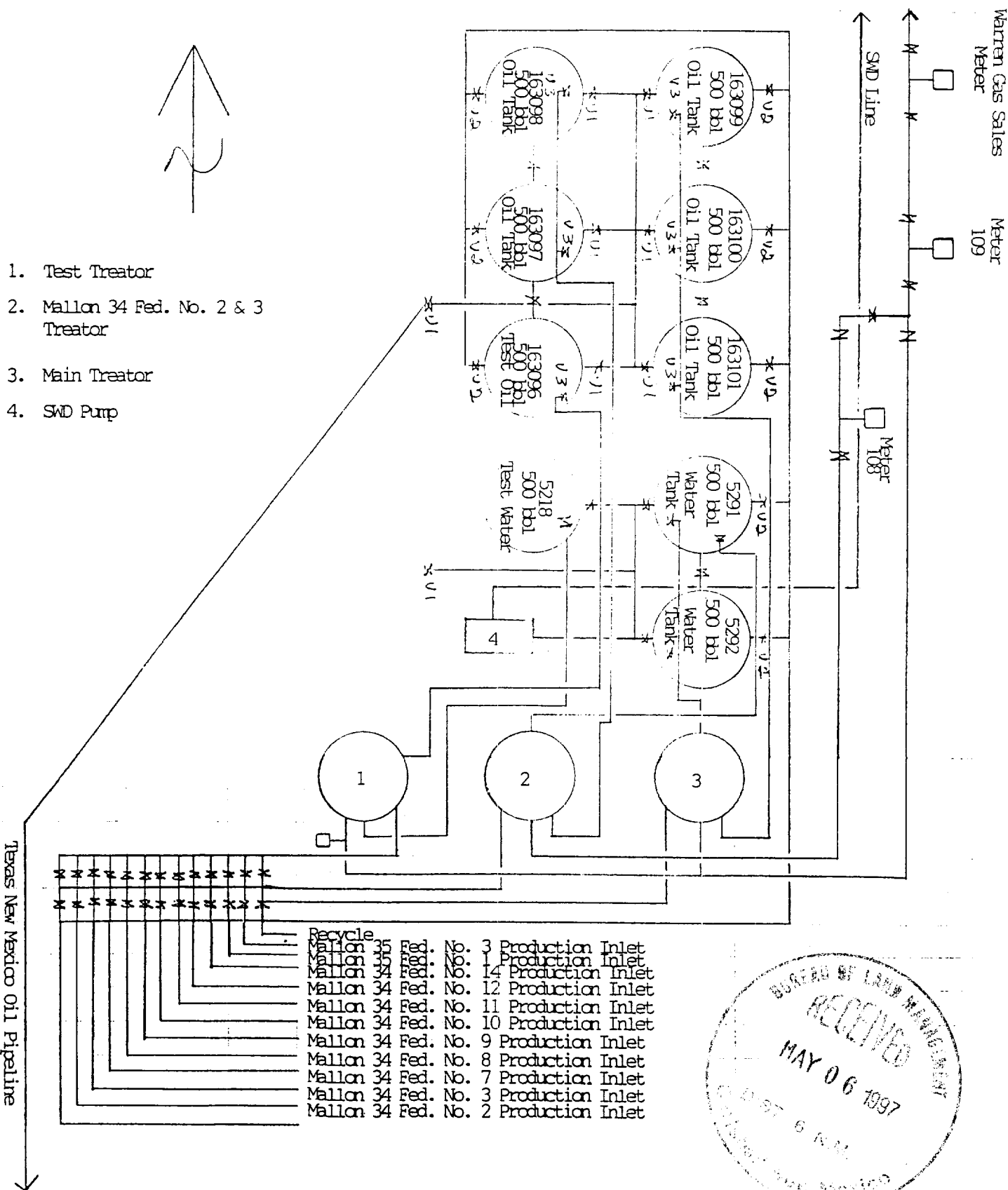

# Mallon Oil Company

Denver/Colorado ♦ Carlsbad/New Mexico

a Mallon Resources subsidiary

## Site Facility Diagram

Mallon 34 Central Battery  
NENE (Unit A)  
Sec. 34, T19S-R34E  
Lea County, New Mexico  
NM-052

## Site Facility Plan

Located in Mallon Oil Company's Office  
408 S. Halaguena  
Carlsbad, NM 88220  
(505) 885-4596  
Production Department

## Production Phase

1. Tank Sales Line
2. Water Drain Line
3. Oil Fill Line

Valve 1 - closed and sealed until shipped  
Valve 2 - closed and sealed  
Valve 3 - closed and sealed tank #'s 163099,  
163100 and 163098

1. Tank Sales Line
2. Water Drain Line
3. Oil Fill Line

Valve 1 - closed and sealed until shipped  
Valve 2 - closed and sealed  
Valve 3 - open tank #'s 163101, 163097  
and 163096

## Sales Phase

1. Tank Sales Line
2. Water Drain Line
3. Oil Fill Line

Valve 1 - closed and sealed until shipped  
Valve 2 - closed and sealed  
Valve 3 - closed and sealed tank #'s 163101,  
163097 and 163096

