

DISTRICT I

P.O. Box 1980, Hobbs, NM 88240

DISTRICT II

P.O. Box Drawer DD, Artesia, NM 88210

DISTRICT III

1000 Rio Brazos Rd., Aztec, NM 87410

OIL CONSERVATION DIVISION

P.O. Box 2088

Santa Fe, New Mexico 87504-2088

WELL API NO.	30-025-33148
5. Indicate Type of Lease	STATE <input checked="" type="checkbox"/> FEE <input type="checkbox"/>
6. State Oil / Gas Lease No.	B-155
7. Lease Name or Unit Agreement Name	NEW MEXICO O STATE NCT- 1
8. Well No.	38
9. Pool Name or Wildcat	VACUUM WOLFCAMP

SUNDRY NOTICES AND REPORTS ON WELL
(DO NOT USE THIS FORM FOR PROPOSALS TO DRILL OR TO DEEPEN OR PLUG BACK TO A
DIFFERENT RESERVOIR. USE "APPLICATION FOR PERMIT
(FORM C-101) FOR SUCH PROPOSALS.)

1. Type of Well:	OIL WELL <input checked="" type="checkbox"/> GAS WELL <input type="checkbox"/> OTHER <input type="checkbox"/>
2. Name of Operator	TEXACO EXPLORATION & PRODUCTION INC.
3. Address of Operator	205 E. Bender, HOBBS, NM 88240
4. Well Location	Unit Letter <u>I</u> 2085 Feet From The <u>SOUTH</u> Line and 710 Feet From The <u>EAST</u> Line Section <u>36</u> Township <u>17-S</u> Range <u>34-E</u> NMPM LEA COUNTY
10. Elevation (Show whether DF, RKB, RT, GR, etc.)	3987' GR

11. Check Appropriate Box to Indicate Nature of Notice, Report, or Other Data

NOTICE OF INTENTION TO:

PERFORM REMEDIAL WORK ☐ PLUG AND ABANDON ☐
TEMPORARILY ABANDON ☐ CHANGE PLANS ☐
PULL OR ALTER CASING ☐
OTHER: ☐

SUBSEQUENT REPORT OF:

REMEDIAL WORK ☐ ALTERING CASING ☐
COMMENCE DRILLING OPERATION ☐ PLUG AND ABANDONMENT ☐
CASING TEST AND CEMENT JOB ☐
OTHER: ☒ ADDED UPPER WOLFCAMP PAY

12. Describe Proposed or Completed Operations (Clearly state all pertinent details, and give pertinent dates, including estimated date of starting any proposed work) SEE RULE 1103.

7/11/97 - 7/17/97

1. MIRU. TOH w/ rods & pump. Installed BOP. TOH with tubing.

2. Perforated Upper Wolfcamp interval @ 9316'-9320', 9326'-9390', & 9420'-9436' (2 JSPF, .42" holes, 84', 168 holes).

3. TIH w/ RBP & pkr. Set RBP @ 9,500' & pkr @ 9265'. Acidized Upper Wolfcamp perms from 9316'-9436' w/ 7000 gals 15% NEFE. Max P = 4700#, AIR = 4 BPM. SI 1 hr, swabbed back load. Released & TOH w/ RBP & pkr.

4. TIH w/ tbg, rods, & pump. Returned well to production.

OPT 7/31/97 PUMPING BY ROD PUMP: 48 BOPD, 112 BWPD, 78 MCFD

(INTERNAL TEPI STATUS REMAINS PM)

I hereby certify that the information above is true and complete to the best of my knowledge and belief.

SIGNATURE Monte C. Duncan TITLE Engr Asst DATE 9/12/97
TYPE OR PRINT NAME Monte C. Duncan Telephone No. 397-0418

(This space for State Use)

APPROVED BY Kautz TITLE Geologist DATE OCT - 3 1997
CONDITIONS OF APPROVAL, IF ANY:

DISTRICT I

P.O. Box 1980, Hobbs, NM 88241-1980

DISTRICT II

P.O. Box Drawer DD, Artesia, NM 88211-0719

DISTRICT III

1000 Rio Brazos Rd., Aztec, NM 87410

DISTRICT IV

P.O. Box 2088, Santa Fe, NM 87504-2088

State of New Mexico

Energy, Minerals and Natural Resources Department

Form C-102

Revised February 10, 1994

Instructions on back

Submit to Appropriate District Office

State Lease - 4 Copies

Fee Lease - 3 Copies

☐ AMENDED REPORT

OIL CONSERVATION DIVISION

P.O. Box 2088

Santa Fe, New Mexico 87504-2088

WELL LOCATION AND ACREAGE DEDICATION PLAT

¹ API Number 30-025-33148	² Pool Code 62340	³ Pool Name VACUUM WOLFCAMP
⁴ Property Code 011048	⁵ Property Name NEW MEXICO O STATE NCT- 1	⁶ Well No. 38
⁷ OGRID Number 022351	⁸ Operator Name TEXACO EXPLORATION & PRODUCTION INC.	⁹ Elevation 3987' GR

¹⁰ Surface Location

UI or lot no.	Section	Township	Range	Lot.Idn	Feet From The	North/South Line	Feet From The	East/West Line	County
I	36	17-S	34-E		2085	SOUTH	710	EAST	LEA

¹¹ Bottom Hole Location If Different From Surface

UI or lot no.	Section	Township	Range	Lot.Idn	Feet From The	North/South Line	Feet From The	East/West Line	County

¹² Dedicated Acres 80	¹³ Joint or Infill No	¹⁴ Consolidation Code	¹⁵ Order No.
-------------------------------------	-------------------------------------	----------------------------------	-------------------------

NO ALLOWABLE WILL BE ASSIGNED TO THIS COMPLETION UNTIL ALL INTERESTS HAVE BEEN CONSOLIDATED
OR A NON-STANDARD UNIT HAS BEEN APPROVED BY THE DIVISION

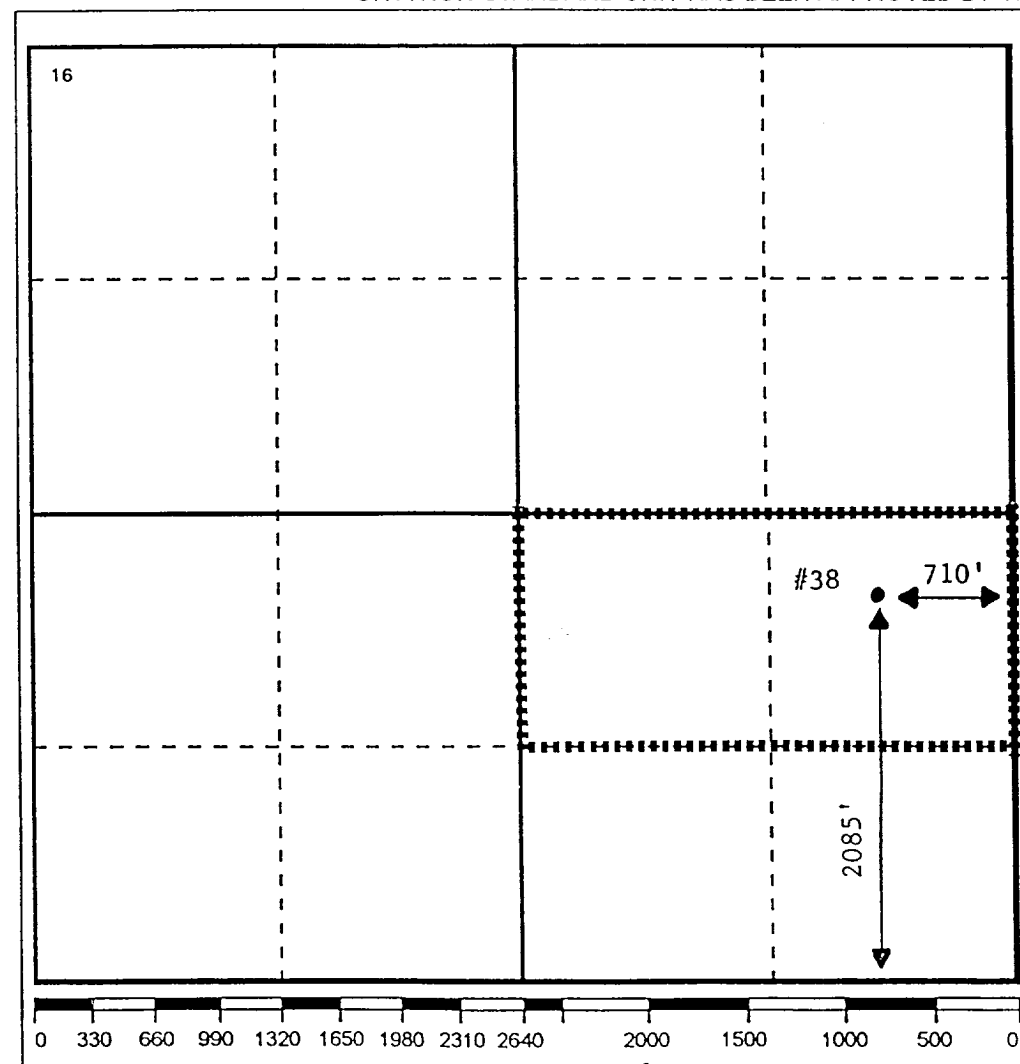

17 OPERATOR CERTIFICATION

I hereby certify that the information
contained herein is true and complete to the
best of my knowledge and belief

Signature

Printed Name

Monte C. Duncan

Position

Engr Asst

Date

9/12/97

18 SURVEYOR CERTIFICATION

I hereby certify that the well location shown
on this plat was plotted from field notes of
actual surveys made by me or under my
supervision, and that the same is true and
correct to the best of my knowledge and
belief.

Date Surveyed

Signature & Seal of
Professional Surveyor

Certificate No.

661821001

4
11/1/77
Received
Hubs
000