

District I  
PO Box 1980, Hobbs, NM 88241-1980  
District II  
PO Drawer DD, Artesia, NM 88211-0719  
District III  
1000 Rio Brazos Rd., Aztec, NM 87410  
District IV  
PO Box 2088, Santa Fe, NM 87504-2088

State of New Mexico  
Energy, Minerals & Natural Resources Department

OIL CONSERVATION DIVISION  
PO Box 2088  
Santa Fe, NM 87504-2088

Form C-101  
Revised February 21, 1994  
Instructions on back  
Submit to Appropriate District Office  
State Lease - 6 Copies  
Fee Lease - 5 Copies

☐ AMENDED REPORT

APPLICATION FOR PERMIT TO DRILL, RE-ENTER, DEEPEN, PLUGBACK, OR ADD A ZONE

Operator Name and Address. Bonneville Fuels Corporation 1660 Lincoln St., Suite 1800 Denver, Colorado 80264		OGRID Number 2678
		API Number 30-025-33197
Property Code 2158 LY 2157	Property Name Norris	Well No. #4

Surface Location									
UL or lot no.	Section	Township	Range	Lot Idn	Feet from the	North/South line	Feet from the	East/West line	County
M	13	17S	37E		710'	South	330'	East	Lea

Proposed Bottom Hole Location If Different From Surface									
UL or lot no.	Section	Township	Range	Lot Idn	Feet from the	North/South line	Feet from the	East/West line	County
Proposed Pool 1 South Humble City: Strawn					Proposed Pool 2				

Work Type Code N	Well Type Code O	Cable/Rotary R	Lease Type Code P	Ground Level Elevation 3722'
Multiple No	Proposed Depth 11,840'	Formation Atoka Shale	Contractor	Spud Date 8-1-95

Proposed Casing and Cement Program					
Hole Size	Casing Size	Casing weight/foot	Setting Depth	Sacks of Cement	Estimated TOC
17-1/2"	13-3/8"	54.5	450'	475 sx	Surface
11"	8-5/8"	32.0	4,675'	1,185 sx.	Surface
7-7/8"	5-1/2"	17.0	11,840'	1st: 550 sx	8,840'
				2nd: 530 sx	4,375'
				Stage Tool @ 8,840'	

" Describe the proposed program. If this application is to DEEPEN or PLUG BACK give the data on the present productive zone and proposed new productive zone. Describe the blowout prevention program, if any. Use additional sheets if necessary.

Drill 17-1/2" hole to 450'. Set & cement 13-3/8" casing (w/475 sx. cmt.) to surface. Install BOPE. Pressure test to 1000 PSIG. Drill 11" hole to 4,675'. Set & cement 8-5/8" intermediate casing (w/1,185 sx. cmt.) to isolate upper Permian salts and anhydrites & to provide well control prior to drilling deep oil and gas bearing formations. Test BOPE and casing to 2500 PSIG. Drill 7-7/8" hole to 11,840' to evaluate Strawn Fm. Run DST in Strawn Fm. and log 7-7/8" hole. Run 5-1/2" casing & cement to 4,375' (w/1,080 sx. cmt. in 2 stages w/Tool @ 8,840') if warranted. Otherwise, P&A well as directed by State of New Mexico.

A well plan, including BOPE specification, is attached for your information.

" I hereby certify that the information given above is true and complete to the best of my knowledge and belief.

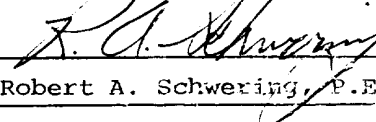
Signature: 	OIL CONSERVATION DIVISION Approved by: ORIGINAL SIGNED BY JERRY SEXTON DISTRICT I SUPERVISOR
Printed name: Robert A. Schwering, P.E.	Title:
Title: Senior Engineer	Approval Date: NOV 28 1995
Date: May 25, 1995	Phone: (303) 863-1555

Approval Date: NOV 28 1995		Expiration Date:
Conditions of Approval: Attached <input type="checkbox"/>		

Permit expires 6 Months From Approval Date Unless Drilling Underway.

m1P

**RECEIVED**

MAY 9 1964  
JUD HOODS  
OFFICE

## EIGHT POINT DRILLING PLAN

Attached to Form C-101:  
Operator: Bonneville Fuels Corporation

Norris #4  
710' FSL & 330' FEL  
Section 13, T.17S., R.37E. N.M.P.M.  
Lea County, New Mexico

### 1. ESTIMATED TOPS: IMPORTANT GEOLOGIC MARKERS:

#### Permian:

Red Beds:	Surface
Anhydrites & Red Beds:	1800'
Anhydrites, Salts & Shales:	2300'
Anhydrites & Shales:	3700'
First Hard Dolomite:	4600' to 4690'
Seven Rivers Fm.:	4800'
Queen Fm.:	5125'
Grayburg Fm.	5320'
San Andres Fm.	5605'
Glorieta Fm.	7080'
Yeso Fm.	7270'
Tubb Fm.	8160'
Lower Clearfork Fm.	8460'
3rd Bone Springs Fm.	9495'
Abo Fm.	9825'
Wolfcamp Group	9955'
Wolfcamp Detrital	11005'

#### Pennsylvanian:

Canyon Fm.	11320'
Strawn Fm.	11415'
Lower Strawn	11665'
Atoka Fm.	11740'

### 2. ESTIMATED DEPTHS OF ANTICIPATED WATER, OIL, GAS OR MINERALS:

Fresh Water:                      Occ. Surface Sands:      Surface to 400'.

Oil and Gas Targets:	Strawn Fm.:	11415'.
	Lower Strawn:	11665'.

Possible Gas and Oil:	Tubb Fm.:	8160'.
	Lower Clearfork Fm.:	8460'.
	Wolfcamp Fm.:	9955'.

PROJECTED TOTAL DEPTH:                      11,840'.

**RECEIVED**

MAY 3 1960  
OLD FORDS  
OFFICE

3. MINIMUM SPECS FOR PRESSURE CONTROL:

- a. A diagram of the Blowout Preventer Stack and Wellhead Equipment is presented in Exhibit #1. The wellhead equipment for the intermediate hole (11" @ 4675') is altered only by the replacement of the 13-5/8" 3000 psi WP x 11" 5000 psi WP cross-over spool with the 13-5/8" 3000 psi WP x 11" 5000 psi WP casing spool during the drilling of the 7-7/8" production hole. A diagram of the Choke Manifold is presented in Exhibit #2. All BOP and Choke Manifold equipment will be rated to 5000 psi WP(min).
- b. Surface Casing Wellhead Equipment will consist of:
  - i. A 13-5/8" slip-on weld-on 3000 psi WP(min) braiden head w/ 2: 2" SE outlets with 2: 2" SE XXHVY Nipples and 2: 2" SE FO 3000 psi WP(min) ball valves. This braiden head will be welded on & nipples up after the 450' 13-3/8" Surface Casing is set and cemented.
  - ii. A 13-5/8" 3000 psi WP(min) x 11" 5000 psi WP(min) cross-over spool will be installed upon the braiden head. This spool will be removed when the 8-5/8" Protective Casing has been set and cemented.
  - iii. All wellhead and BOP equipment and the 13-3/8" surface casing will be pressure tested to 1000 psi with the rig pumps prior to drilling out.
- c. Protective Casing Wellhead Equipment will consist of:
  - i. A 13-5/8" slip-on weld-on 3000 psi WP(min) braiden head w/ 2: 2" SE outlets with 2: 2" SE XXHVY Nipples and 2: 2" SE FO 3000 psi WP(min) ball valves.
  - ii. A 13-5/8" 3000 psi WP x 11" 5000 psi WP casing spool w/ 2: 2" FO FE outlets w/ 2: 2" FO FE 5000 psi WP gate valves. This casing spool will be nipples up after the 4675' 8-5/8" protective casing is set and cemented. The secondary seal will be tested to 1500 psi.
  - iii. All wellhead and BOP equipment and the 8-5/8" protective casing will be pressure tested to 2500 psi prior to drilling out.

RECEIVED

1944

1944

3. MINIMUM SPECS FOR PRESSURE CONTROL (CONTINUED):

- d. The BOP Equipment, nipped up on the 13-5/8" 3000 psi x 11" 5000 psi cross-over spool for the 11" intermediate hole, and the 13-5/8" 3000 psi x 11" 5000 psi casing spools for the 7-7/8" production hole, will be as follows:
- i. An 11" Nom. 5000 psi WP(min) mud cross with a 2" 5000 psi WP(min) FO FE kill-side inlet and a 4" 5000 psi WP(min) FO FE choke-side outlet.
  - ii. An 11" Nom. 5000 psi WP(min) double gate (or dual equivalent single gate) hydraulic ram-type preventer with Pipe Rams over Blind Rams. Pipe rams are anticipated to be 4-1/2".
  - iii. An 11" Nom. 5000 psi WP(min) hydraulic annular (bag-type) preventer.
  - iv. A choke manifold consisting of a 4" (min nom) x 5,000 psi WP(min) FE choke/bloody line between the 2: 4" 5000 psi WP(min) FO FE master gate valves at the wellhead and the choke manifold 2 x 4" and 2 x 2" 5000 psi WP(min) cross with a 4" 5000 psi WP(min) FO FE ball/gate valve downstream of the cross. Between the downstream 4" ball/gate valve and the manifold cross will be a 4" x 4" x 2" 5000 psi WP(min) FO FE tee with a 2" 5000 psi WP(min) FO FE ball/gate valve with a 2" 5000 psi WP(min) Gauge Assembly for monitoring pressure at the choke manifold. The choke manifold will have 2: 2" 5000 psi FO FE ball/gate valves between the manifold cross and the 2: 2" FO FE 5000 psi (min) adjustable chokes (a total of 4: 2" 5000 psi ball/gate valves - 2 on each wing). Provision may be made to tie in DST surface lines to the choke manifold thru an optional 2" 5000 psi WP(min) FO FE tee above the 2" 5000 psi WP(min) ball/gate valve downstream of the choke manifold cross. The 4" bloody line downstream of the choke manifold will be staked down and targeted in the reserve pit. The 2: 2" lines downstream of the chokes will be appropriately fixed or staked down to return mud to the pits, oil to test tanks, gas/oil cut mud to a separator or test tank, and gas to a flare pit.
  - v. A 5000 psi WP(min) FO safety valve and a 5000 psi WP(min) dart valve, with drill pipe threads and subs to meet other drill string threads, will be kept on the drill floor after the 13-3/8" surface casing is set. A 5000 psi (min) WP Upper kelly valve and a 5000 psi WP(min) Lower kelly valve will be kept on the kelly throughout drilling operations. All valves, and the wrenches to operate these valves, will be maintained on the floor in good order throughout drilling operations.

**RECEIVED**

APR 10 1960

MAIL ROOMS  
OFFICE



### 3. MINIMUM SPECS FOR PRESSURE CONTROL (CONTINUED):

#### d. The BOP Equipment (Continued):

- vi. An accumulator with sufficient capacity to operate the BOPE against a 3000 psi well pressure(min) will be used to operate the BOP system. It shall contain double the fluid capacity calculated to open and close the pipe rams, blind rams, and annular preventer 1 time each, and then to close the pipe rams and annular preventer 1 additional time(min) and retain accumulator pressure at 200 psig over the pre-charge pressure. The accumulator working pressure shall be 1,500 psi(minimum) with a pre-charge pressure between 700-800 psi(minimum). A Nitrogen bottle system shall provide independent (reserve) power to operate the system in the event rig motors must be shut down.

#### e. The testing procedures and frequency are as follows:

- i. For the 13-3/8" surface casing nipple-up and prior to drilling the 11" intermediate hole:  
ALL of the pressure side BOP Equipment specified in Part d. above will be nipped-up on the surface casing and each component will be hydraulically tested for ten(10) minutes(min) to 1000 psi and five(5) minutes(min) to 300 psi prior to drilling out cement. Pipe rams will be operationally checked each 24 hour period, and the blind rams operationally checked each time pipe is pulled from the hole. These pressure tests and function tests will be noted and described on the daily drilling report. After the float collar is drilled out of the surface casing (prior to drilling out the shoe) the surface casing will be pressure tested to 1,000 psi for thirty(30) minutes(min).
- ii. For the 8-5/8" intermediate casing nipple-up and prior to drilling the 7-7/8" production hole:  
ALL of the pressure side BOP Equipment specified in Part d. above will be nipped-up on the casing spool and each component will be hydraulically tested for ten(10) minutes(min) to 2500 psi and five(5) minutes(min) to 250 psi prior to drilling out cement. The Pipe rams will be operationally checked each 24 hour period, and the blind rams operationally checked each time pipe is pulled from the hole. These pressure tests and function tests will be noted and described on the daily drilling report. After the float collar is drilled out of the intermediate casing, and prior to drilling out the shoe, the intermediate casing will be pressure tested to 2,500 psi for thirty(30) minutes(min). The surface BOP equipment will be pressure tested every 30 operating days after the pressure test at protective casing nipple-up.

RECEIVED

APR 30 1963  
U.S. AIR FORCE  
OFFICE

### 3. MINIMUM SPECS FOR PRESSURE CONTROL (CONTINUED):

#### f. Tripping procedures for well control:

##### i. For the 11" intermediate hole:

A mud weight of 9.5 PPG is anticipated at a depth of 2300' and a mud weight of 10.4 PPG is anticipated at a depth of 4675' (Total Depth for this interval). The well will be drilled by a triple-derrick rig (92' avg. length per stand). The well will be monitored each 5 stands to insure that the BHA is not swabbing the well in. The well will be filled after each 20 stands of drill pipe, 3 stands of 6-1/2" drill collars, and as each stand of large outside diameter drill collars (7" O.D. or larger) are pulled from the hole. Pits will be monitored in order to insure that the well is taking fluid on trips. **In the event that the bit is plugged on a trip the well will be filled after each 7 stands of drill pipe are pulled from the well and as each stand of drill collars are pulled from the well. Swabbing will be checked each 3 stands.**

##### ii. For the 7-7/8" production hole:

The anticipated maximum bottom-hole formation pressure is 3690 psig at 9,955' (Wolfcamp) and 3670 psig at 11,415' (Strawn). The anticipated mud weight in this interval is 8.4 to 9.5 PPG. This will provide a minimum hydrostatic pressure of 4350 psig (660 psig overbalance) at the Wolfcamp and 4990 psig (1320 psig overbalance) at the Strawn. The well will be drilled by a triple-derrick rig (92' avg. length per stand). The well will be monitored each 5 stands to insure that the BHA is not swabbing the well in. The well will be filled after each 20 stands of drill pipe and as each stand of drill collars are pulled from the hole. Pits will be monitored in order to insure that the well is taking fluid on the trip. **In the event that the bit is plugged on a trip the well will be filled after each 5 stands of drill pipe are pulled from the well and as each stand of drill collars are pulled from the well. Swabbing will be checked each 3 stands.**

#### g. Procedures for running production casing:

Prior to running production casing the hole will be filled. The blind rams will be closed and the well will be monitored for flow while a set 5.5" casing rams will be installed in the BOP to replace the pipe rams. Casing will then be run and cemented. The BOPE will remain nipped up UNTIL the well is cemented.

**RECEIVED**

MAY 3 1950  
U. S. CUSTOMS  
OFFICE

#### 4. CASING AND CEMENTING PROGRAM:

##### a. The Proposed Casing Program:

- i. Surface Casing:  
13-3/8" O.D. 54.5#/ft. J-55 8rd. ST&C: Surface to 450'.
- ii. Intermediate Casing: Seat casing in first hard Dolomite.  
8-5/8" O.D. 32#/ft. HCK-55 8rd. LT&C: Surface to 40'.  
8-5/8" O.D. 32#/ft. K-55 8rd. LT&C: 40' to 3100'.  
8-5/8" O.D. 32#/ft. HCK-55 8rd. LT&C: 3100' to 4675'.
- iii. Production Casing:  
5-1/2" O.D. 17#/ft. L-80 8rd. LT&C: Surface to 3040'.  
5-1/2" O.D. 17#/ft. K-55 8rd. LT&C: 3040' to 7340'.  
5-1/2" O.D. 17#/ft. N-80 8rd. LT&C: 7340' to 11840'.

##### b. The Proposed Cementing Program:

- i. Surface Casing: Single Stage:  
Est. 75 F. @ 9.5 PPG mud @ 450'.  
Circ. Cement to Surface:  
100% excess over calculated volume.  
Top job required if cement does not circulate.  
475 sx. Class 'C' w/ 2% CaCl<sub>2</sub> + 0.25 #/sx. cellophane:  
1.33 cu.ft./sx. @ 14.8 PPG.
- ii. Intermediate Casing: Single Stage:  
Est. 115 F. @ 10.4 PPG mud @ 4675'.  
Plan Circ. Cement to Surface:  
Temp. Survey & Possible Top Job If Cement Does NOT Reach  
Surface Casing @ 450'.  
Lead Slurry: Est. Surface to 4375'.  
160 % excess over calculated volume: Est. @  
1,020 sx. Lite (65% Class 'C' + 35% Pozzalan + 6% Gel)  
w/ 3% Sodium Meta-Silicate + 15 #/sx. NaCl +  
0.25 #/sx. cellophane + Additives:  
2.76 cu.ft./sx. @ 11.8 PPG.  
Tail Slurry: Est. 4375' to 4675'.  
160 % excess over calculated volume: Est. @  
165 sx. Class 'C' w/ 2% CaCl<sub>2</sub> + 0.25 #/sx. cellophane +  
Additives:  
1.33 cu.ft./sx. @ 14.8 PPG.

RECEIVED

MAY 3 1964

OFFICE

4. CASING AND CEMENTING PROGRAM (CONTINUED):

b. The Proposed Cementing Program (Continued):

- iii. Production Casing: Two Stage: Stage Tool @ 8840':  
ALL VOLUMES TO BE BASED ON CALIPER LOG VOLUMES.

First Stage: Est. 180 F. @ 9.2 PPG mud @ 11840'.

Plan Circ. Cement to 8840':

Lead Slurry: Est. 9240' to 8840'.

100 % excess over calculated volume: Est. @

60 sx. Lite (65% Class 'H' + 35% Pozzalan + 6% Gel)

w/ 12 #/sx. NaCl + 3 #/sx. KCl + Additives.

2.30 cu.ft./sx. @ 11.4 PPG.

Tail Slurry: Est. 11840' to 9240':

40 % excess over calculated volume: Est. @

490 sx. 50% Class 'H' + 50% Pozzalan + 2% Gel

w/ 3 #/sx. KCl + Additives.

1.30 cu.ft./sx. @ 14.2 PPG.

Second Stage: Est. 150 F. @ 9.2 PPG mud @ 8840':

Lead Slurry: Est. 4375' to 7840':

60 % excess over calculated volume: Est. @

340 sx. Lite (65% Class 'C' + 35% Pozzalan + 6% Gel)

w/ 3% Sodium Meta-Silicate + 15 #/sx. NaCl +

0.50 #/sx. cellophane + Additives:

2.76 cu.ft./sx. @ 11.8 PPG.

Tail Slurry: Est. 7840' to 8840':

40 % excess over calculated volume: Est. @

190 sx. 50% Class 'H' + 50% Pozzalan + 2% Gel

w/ 3 #/sx. KCl + Additives.

1.30 cu.ft./sx. @ 14.2 PPG.

**RECEIVED**

MAY 8 1968  
U.S. MARINE  
OFFICE



## 5. PROPOSED DRILLING FLUIDS:

The reserve pit will be constructed in two segments & will be fully lined with a minimum 12 mil thickness plastic liner to protect the surface environment and fresh water resources.

- a. 17-1/2" Surface Hole: Surface to 450': Fresh Water Spud Mud:  
Additives: Gel, Lime & LCM as needed to maintain circulation.  
Est. 9.0 to 9.5 PPG @ VIS 40 to 120 sec./qt.
- b. 11" Intermediate Hole: Circulate the Reserve Pit Brine Section.
  - i. 450' to 2300': Native Mud: Fresh Water & Native Solids:  
Additives: Possible Gel sweeps & LCM as needed to maintain circulation and clean the hole.  
Est. 8.4 to 9.5 PPG @ VIS 30 to 34 sec./qt.
  - ii. 2300' to 4675': Native Mud: Saturated Brine & Native Solids:  
Additives: Possible Attapulgate Gels, Fresh Water Gels to sweep and clean the hole, field crude oil to reduce mud weight, shale sloughing and differential sticking, and LCM as needed to maintain circulation.  
Est. 9.5 to 10.4 PPG @ VIS 32 to 35 sec./qt.
- c. 7-7/8" Production Hole:
  - i. 4675' to 9800': Native Mud: Fresh Water & Native Solids:  
Circulate the Reserve Pit Fresh Water Mud Section.  
Additives: Possible Fresh Water Gels to sweep and clean the hole, field crude oil and/or diesel to reduce mud weight, shale sloughing and differential sticking, and LCM as needed to maintain circulation.  
Est. 8.34 to 8.5 PPG @ VIS 28 - 30 sec./qt.
  - ii. 9800' to 11840': Low Solids Slightly Dispersed:  
Circulate in Mud Tanks.  
Additives: Fresh Water Gel, Drispac, Soda Ash, Ben-Ex, Starch, and KCl w/ LCM as necessary to maintain circulation and stabilize shales with soltex and/or diesel if required for differential sticking.  
Est. 8.8 to 9.5 PPG @ PV 5-22 cp., YP 5-21 pphsf., and VIS @ 34 - 45 sec./qt.

**6. LOGGING, TESTING, AND CORING PROGRAM:**

- a. The logging program will consist of:
  - i. DILL/SFL - GR/SP (Induction Logs):  
T.D. to Intermediate Casing.
  - ii. LDT/CNL - GR/CAL (Density/Neutron Porosity Logs):  
T.D. to Intermediate Casing.
  - iii. BHC Sonic - GR/CAL (Sonic Porosity and Travel Time Logs):  
T.D. to Intermediate Casing.
- b. No cores are planned.
- c. A drill stem test is planned in the Upper Strawn Porosity:  
Anticipated Pressure = approx. 3670 PSIG  
Equiv. Mud Density @ 6.18 PPG @ 11,415'.
- d. Samples will be analyzed on-site by a geologist in order to determine total depth (T.D.) of the well. 30' samples (wet) to the base of the intermediate casing (4675'). 10' samples (wet & dry) from the base of the intermediate casing to T.D.

**7. ABNORMAL CONDITIONS - PRESSURE - TEMPERATURE - POTENTIAL HAZARDS:**

- a. Surface Hole to 450':  
Normal pressures (fresh water gradient or less) and temperatures (70 F. to 75 F.) are anticipated for this hole segment.
- b. Intermediate Hole from 450' to 4675':  
Saturated brine pressures (saturated salt water gradient @ 10.4 PPG: 0.54 PSI/ft.) and normal temperatures (75 F. to 115 F.) are anticipated for this hole segment. No H<sub>2</sub>S is anticipated.
- c. Production Hole from 4675' to 11840':  
Subnormal pressures (less than the fresh water gradient @ 8.34 PPG: 0.434 PSI/ft.) and normal temperatures (115 F. to 180 F.) are anticipated for this hole segment. No H<sub>2</sub>S is anticipated - although H<sub>2</sub>S detection equipment will be installed and maintained for drilling operations in this interval.

8. ANTICIPATED STARTING DATE AND DURATION OF OPERATIONS:

This proposed location is a non-standard (unorthodox) proposed location. Location construction may be commenced in late July after a surface damage agreement is reached with the surface owner, and damages are paid. Bonneville Fuels Corporation is seeking a hearing on June 29, 1995 to approve its request for an unorthodox location, and for the compulsory pooling of various unleased mineral interests. Upon granting of this request this well will be spud and drilled to a projected T.D. @ 11,840' in the Atoka Shale. Anticipated spud date is August 1, 1995. Est. 32 drilling days. Est. 10 completion days. Est. 1st production on or after September 10, 1995.

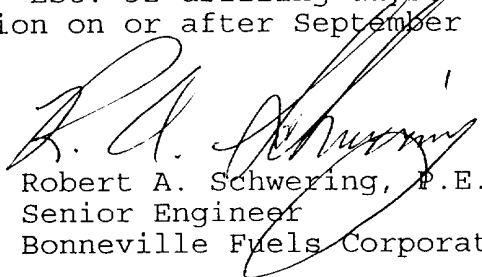
  
Robert A. Schwering, P.E.  
Senior Engineer  
Bonneville Fuels Corporation

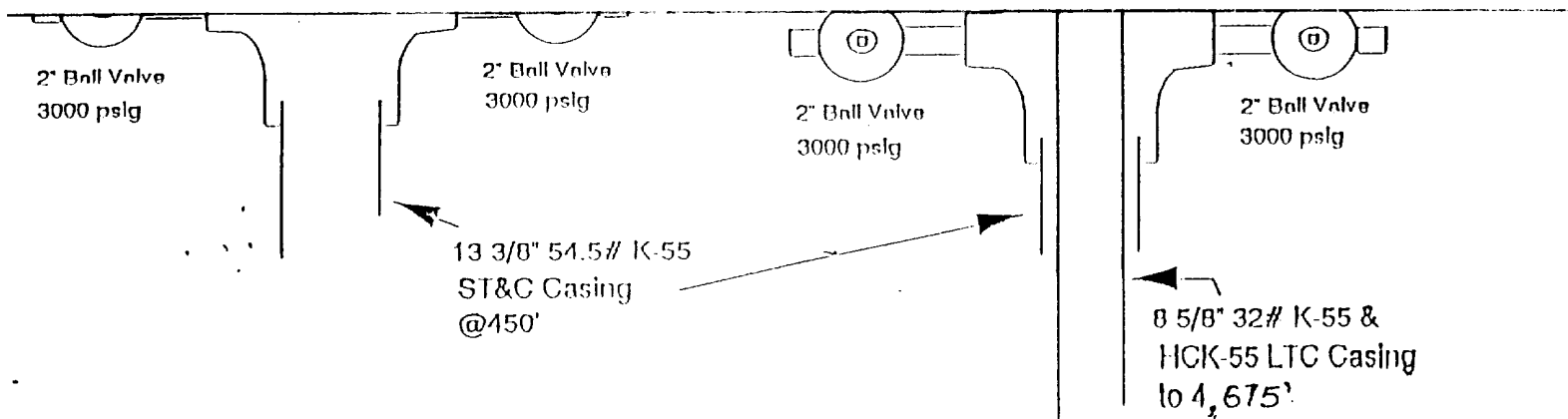

RECEIVED

MAY 30 1963  
OFFICE

NORRIS # 4  
MINIMUM BLOW-OUT PREVENTER REQUIREMENTS  
ALL 5000 PSI WP EQUIPMENT  
(Except Casinghead & Spools as noted below)

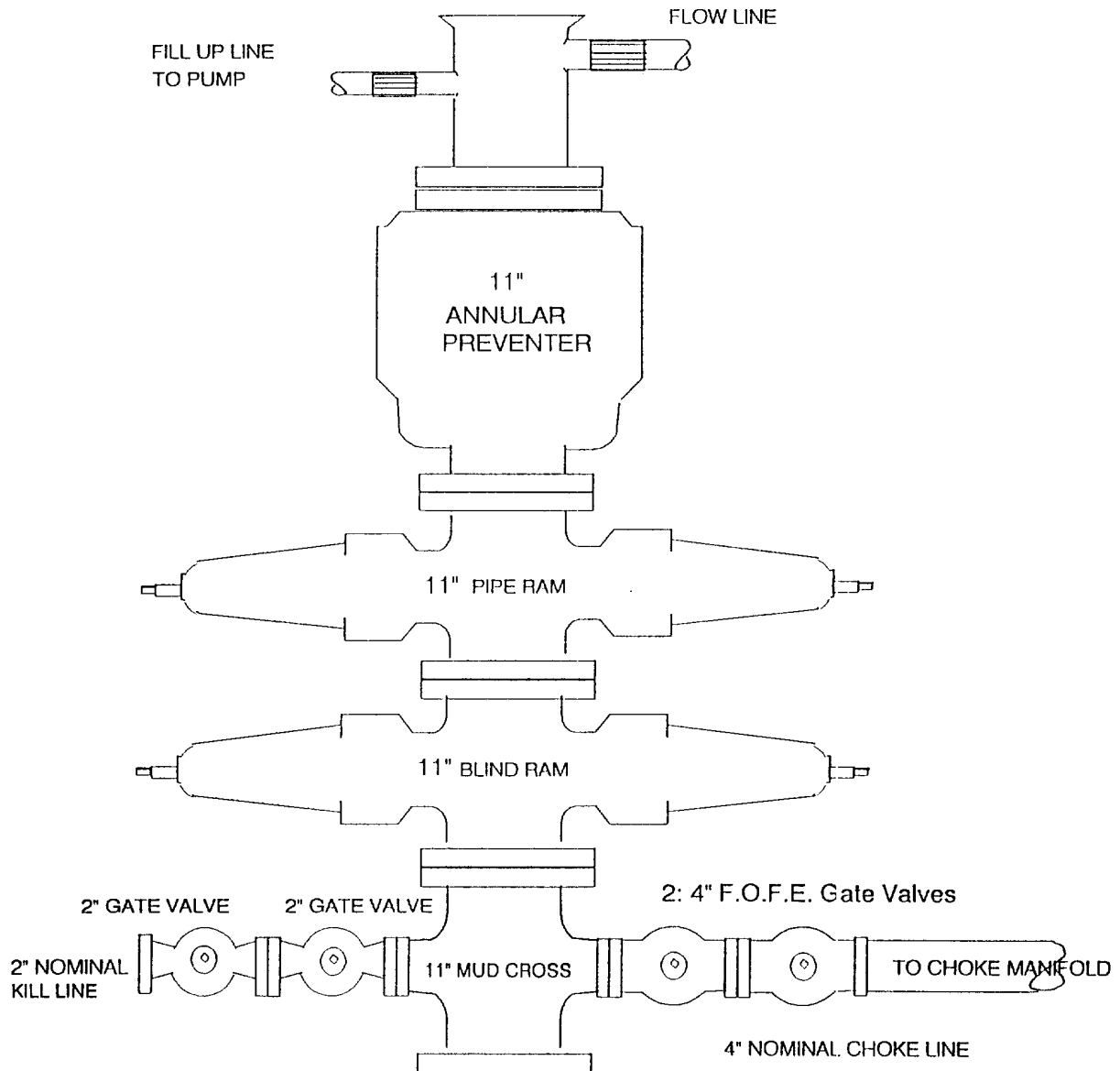

WELLHEAD EQUIPMENT:  
Surface Profile:  
450' - 4,675'

WELLHEAD EQUIPMENT:  
Intermediate Profile:  
4,675' - 11,840'

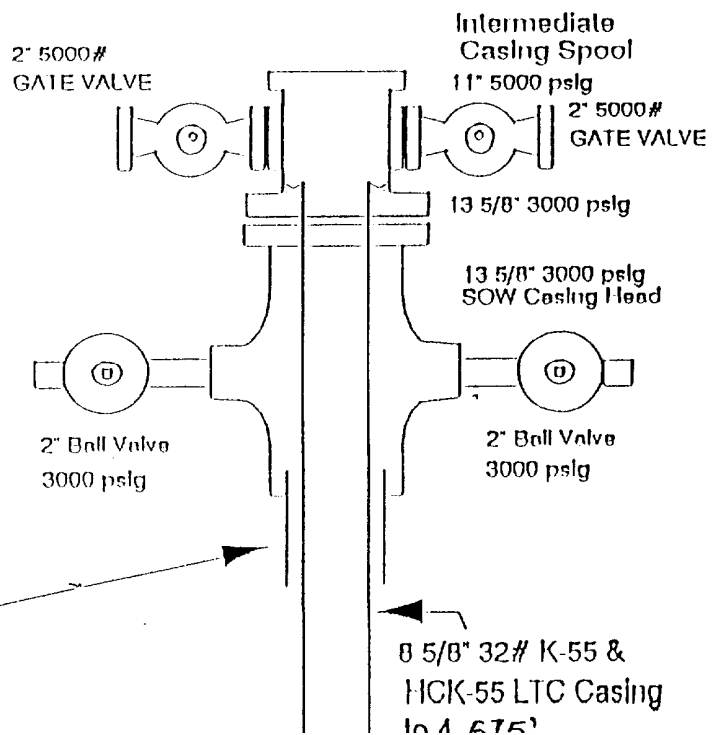
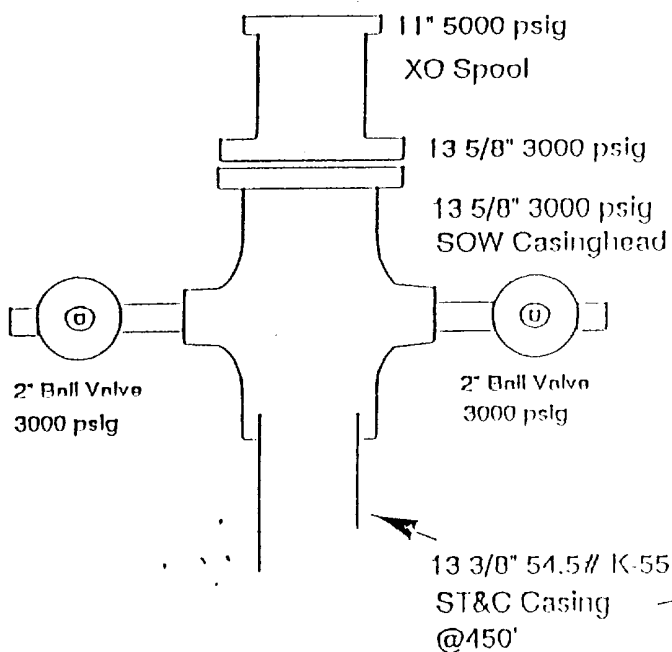

RECEIVED

MAY 3 1960

OFFICE

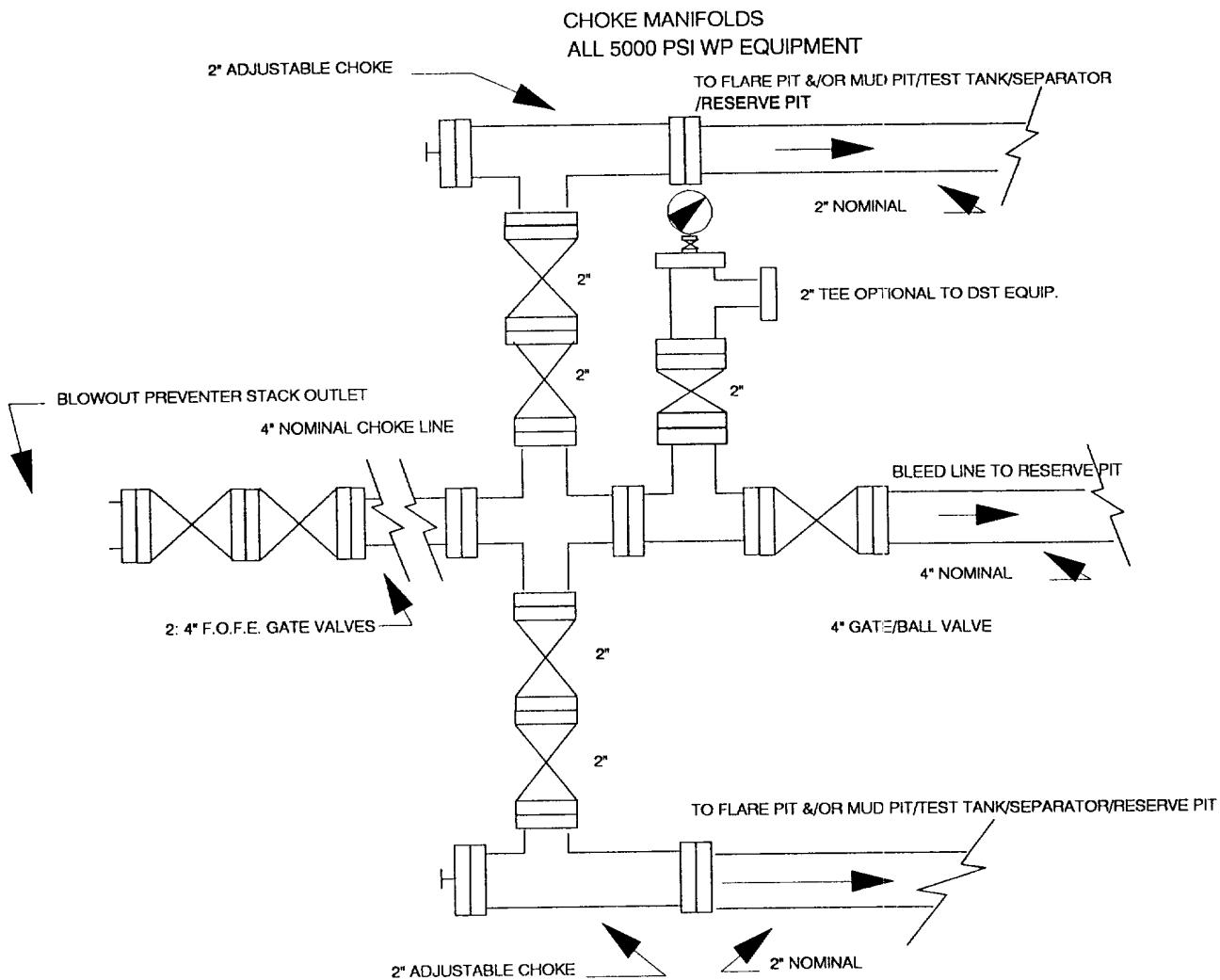

<p>330'</p> <p>710'</p>	<p>I hereby certify that the well location shown on this plat was plotted from field notes of actual surveys made by me or under my supervision and that the same is true and correct to the best of my belief.</p>	
	<p>FEBRUARY 18, 1995</p>	
	<p>Date Surveyed</p>	<p>JLP</p>
	<p>Signature of Professional Surveyor</p>	
	<p>W. O. NURD 95-0241</p>	
<p>Certificate No.</p>	<p>JOHN W. WEST, 676</p>	<p>RONALD L. EDSON, 3239</p>

DISTRICT I  
P.O. Box 1980, Hobbs, NM 88240

State of New Mexico  
Energy, Minerals and Natural Resources Department

Form C-102  
Revised February 10, 1994  
Instruction on back  
Submit to Appropriate District Office  
State Lease - 4 Copies  
Fee Lease - 3 Copies

DISTRICT II  
P.O. Drawer DD, Artesia, NM 88210

DISTRICT III  
1000 Rio Brazos Rd., Aztec, NM 87410

OIL CONSERVATION DIVISION

P.O. Box 2088  
Santa Fe, New Mexico 87504-2088

☐ AMENDED REPORT

WELL LOCATION AND ACREAGE DEDICATION PLAT

API Number <b>30-025-33197</b>	Pool Code <b>33500</b>	Pool Name <b>South Humble City: Strawn</b>
Property Code <b>2158 2157</b>	Property Name <b>NORRIS</b>	Well Number <b>4</b>
OGRID No. <b>2678 2678</b>	Operator Name <b>BONNEVILLE FUELS CORP.</b>	Elevation <b>3722</b>

Surface Location

UL or lot No. <b>M</b>	Section <b>13</b>	Township <b>17 S</b>	Range <b>37 E</b>	Lot Idn	Feet from the <b>710</b>	North/South line <b>SOUTH</b>	Feet from the <b>330</b>	East/West line <b>WEST</b>	County <b>LEA</b>
---------------------------	----------------------	-------------------------	----------------------	---------	-----------------------------	----------------------------------	-----------------------------	-------------------------------	----------------------

Bottom Hole Location If Different From Surface

UL or lot No.	Section	Township	Range	Lot Idn	Feet from the	North/South line	Feet from the	East/West line	County
Dedicated Acres <b>79.995</b>	Joint or Infill	Consolidation Code	Order No. <b>A-7285-A</b>						

NO ALLOWABLE WILL BE ASSIGNED TO THIS COMPLETION UNTIL ALL INTERESTS HAVE BEEN CONSOLIDATED  
OR A NON-STANDARD UNIT HAS BEEN APPROVED BY THE DIVISION

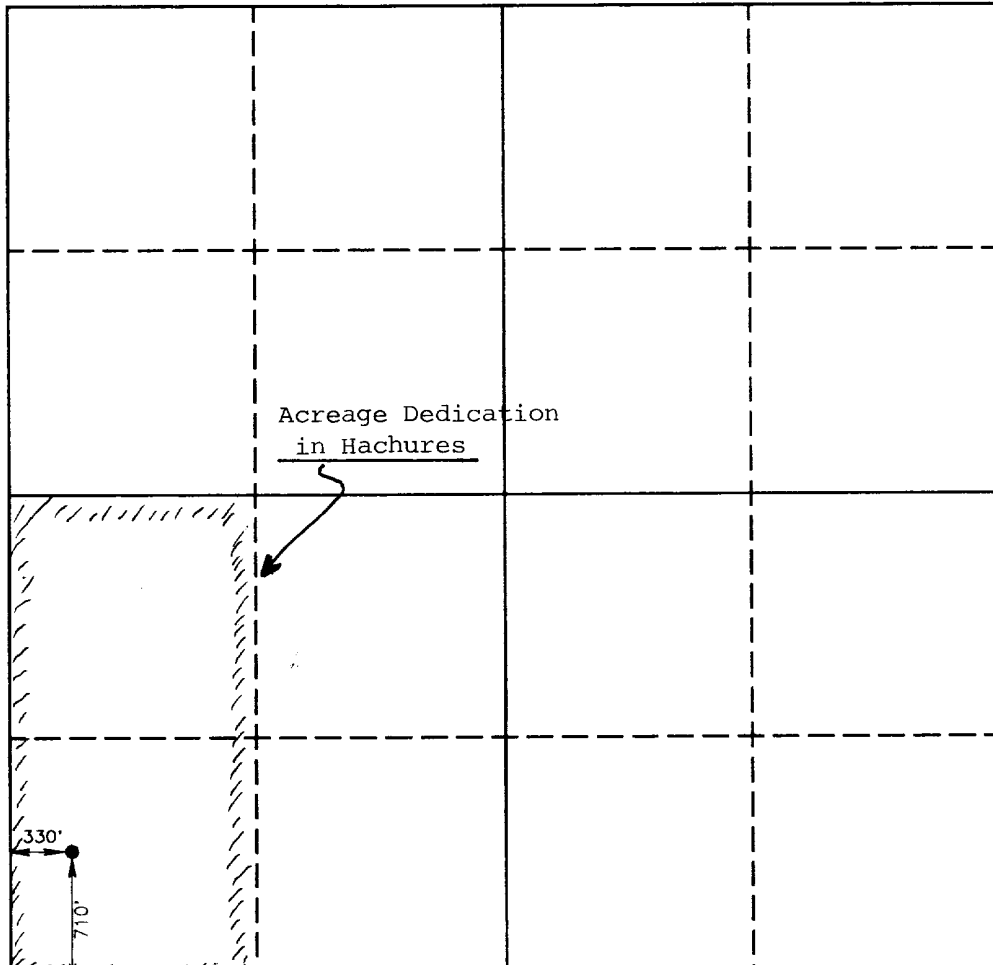
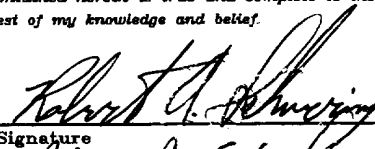
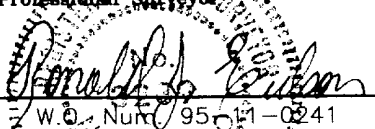
 <p>Acreage Dedication in Hachures</p>	<b>OPERATOR CERTIFICATION</b> <i>I hereby certify the the information contained herein is true and complete to the best of my knowledge and belief.</i>  Signature <b>Robert A. Schuerig, P.E.</b> Printed Name <b>Senior Engineer</b> Title <b>5/24/95</b> Date
	<b>SURVEYOR CERTIFICATION</b> <i>I hereby certify that the well location shown on this plat was plotted from field notes of actual surveys made by me or under my supervision, and that the same is true and correct to the best of my belief.</i> <b>FEBRUARY 18, 1995</b> Date Surveyed Signature  Professional Surveyor <b>W.O. Num 95-01-0241</b> Certificate No. <b>JOHN W. WEST, 676</b> <b>RONALD J. BIDSON, 3239</b>



**RECEIVED**

MAY 3 1967

JOHN F. KENNEDY  
OFFICE

# LOCATION VERIFICATION MAP

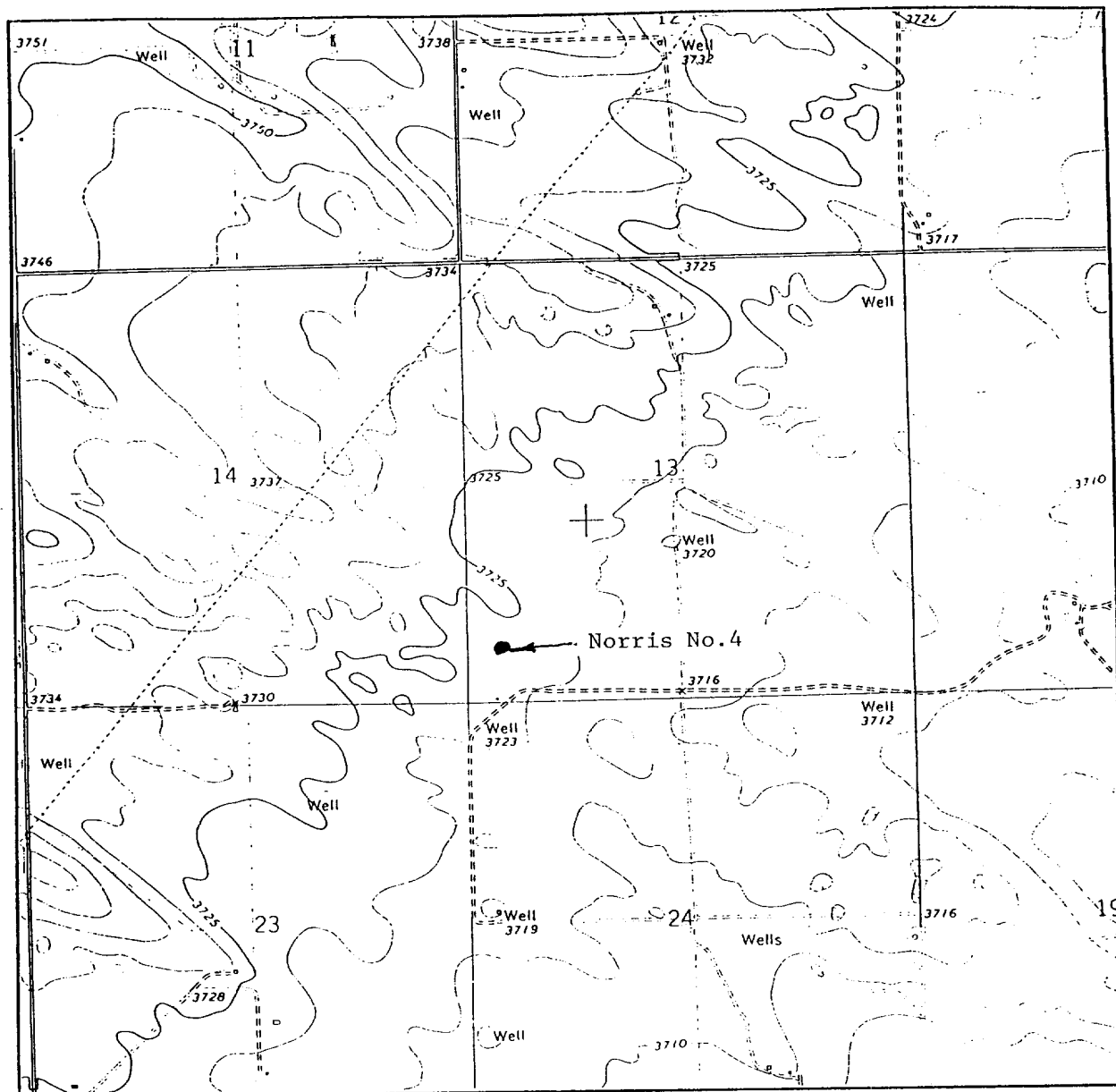

SCALE: 1" = 2000'

CONTOUR INTERVAL 5'

SEC. 13 TWP. 17-S RGE. 37-E

SURVEY N.M.P.M.

COUNTY Lea STATE N.M.

DESCRIPTION 710' FSL & 330' FWL

ELEVATION 3722

OPERATOR Bonneville Fuels Corp.

LEASE Norris No. 4

U.S.G.S. TOPOGRAPHIC MAP

Humble City, N. Mexico

**JOHN WEST ENGINEERING**  
**HOBBS, NEW MEXICO**  
**(505) 393-3117**

**RECEIVED**

MAY 5 1959

U C B BODDS  
OFFICE

# VICINITY MAP

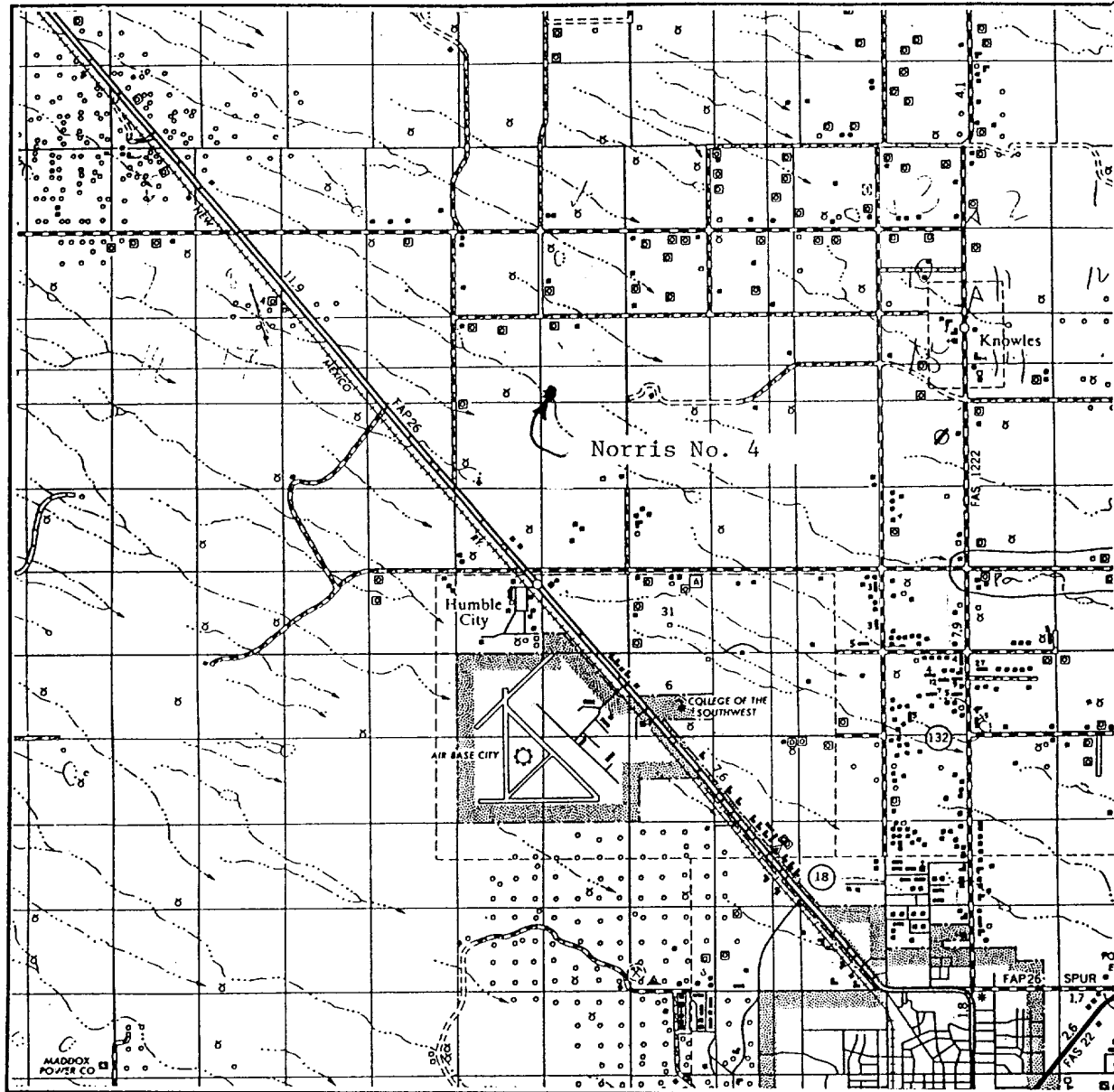

SEC. 13 TWP. 17-S RGE. 37-E

SURVEY N.M.P.M.

COUNTY Lea STATE N.M.

DESCRIPTION 710' FSL & 330' FWL

ELEVATION 3722

OPERATOR Bonneville Fuels Corp.

LEASE Norris No. 4

**JOHN WEST ENGINEERING**  
**HOBBS, NEW MEXICO**  
**(505) 393-3117**

**RECEIVED**

MAY 30 1995

**OLD HOBBS  
OFFICE**