

District I  
 P.O. Box 1984, Hobbs, NM 88241-1984  
 District II  
 P.O. Drawer DD, Artesia, NM 88211-0719  
 District III  
 1400 Rio Bravo Rd., Aztec, NM 87410  
 District IV  
 P.O. Box 2088, Santa Fe, NM 87504-2088

State of New Mexico  
 Energy, Minerals & Natural Resources Department

**OIL CONSERVATION DIVISION**  
**P.O. Box 2088**  
**Santa Fe, NM 87504-2088**

Form C-101  
 Revised February 10, 1994  
 Instructions on back  
 Submit to Appropriate District Office  
 State Lease - 6 Copies  
 Fee Lease - 5 Copies

AMENDED REPORT

**APPLICATION FOR PERMIT TO DRILL, RE-ENTER, DEEPEN, PLUGBACK, OR ADD A ZONE**

<sup>1</sup> Operator name and Address Phillips Petroleum Company 4001 Penbrook Street Odessa, TX 797962		<sup>2</sup> OGRID Number <b>017643</b>
<sup>4</sup> Property Code <b>009166</b>		<sup>3</sup> API Number 30-0 <u>25-33327</u>
<sup>5</sup> Property Name <b>EAST VACUUM GRAYBURG/SAN ANDRES UNIT</b>		<sup>6</sup> Well Number <b>392</b>

<sup>7</sup> Surface Location

UL or lot no.	Section	Township	Range	Lot. Idn	Feet from the	North/South Line	Feet from the	East/West line	County
F	27	17-S	35-E		1409	NORTH	2551	WEST	LEA

<sup>8</sup> Proposed Bottom Hole Location If Different From Surface

UL or lot no.	Section	Township	Range	Lot. Idn	Feet from the	North/South Line	Feet from the	East/West line	County
F	27	17-S	35-E		1409	NORTH	2551	WEST	LEA

<sup>9</sup> Proposed Pool 1

**VACUUM GRAYBURG/SAN ANDRES**

<sup>10</sup> Proposed Pool 2

**VACUUM GRAYBURG/SAN ANDRES**

<sup>11</sup> Work Type Code <b>N</b>	<sup>12</sup> Well Type Code <b>I</b>	<sup>13</sup> Cable/Rotary <b>R</b>	<sup>14</sup> Lease Type Code <b>STATE</b>	<sup>15</sup> Ground Level Elevation <b>3929'</b>
<sup>16</sup> Multiple <b>N</b>	<sup>17</sup> Proposed Depth <b>4,655'</b>	<sup>18</sup> Formations <b>GB/SA</b>	<sup>19</sup> Contractor <b>NA</b>	<sup>20</sup> Spud Date <b>UPON APPROVAL</b>

<sup>21</sup> Proposed Casing and Cement Program

Hole Size	Casing Size	Casing weight/foot	Setting Depth	Sacks of Cement	Estimated TOC
12-1/4"	8-5/8"	24#, J-55	1600'	600sx Class C	SURFACE
7-7/8"	5 1/2"	15.5#, J-55	4655'	900sx Class C	SURFACE

<sup>22</sup> Describe the proposed program. If this application is to DEEPEN or PLUG BACK give the data on the present productive zone and proposed new productive zone. Describe the blowout prevention program, if any. Use additional sheets if necessary

**SEE ATTACHED BLOW OUT PREVENTER SCHEMATIC  
 ATTACHED CASING & CEMENTING PROGRAM  
 ATTACHED MUD PROGRAM**

Permit Expires 1 Year From Approval  
 Date Unless Drilling Underway

OPER. OGRID NO. 17643  
 PROPERTY NO. 9166  
 POOL CODE 62182  
 EFF. DATE 3/12/96  
 API NO. 30-026-33327

<sup>23</sup> I hereby certify that the information given above is true and complete to the best of my knowledge and belief.

Signature: *Larry M. Sanders*

Printed name: **Larry M. Sanders**

Title: **Senior Regulation Analyst**

Date: **03/11/96** Phone: **(915) 368-1488**

<b>OIL CONSERVATION DIVISION</b>	
ORIGINAL SIGNED BY JERRY SEXTON	
DISTRICT I SUPERVISOR	
Title:	
Approval Date: <b>MAR 13 1996</b>	Expiration Date:
Conditions of Approval:	
Attached <input type="checkbox"/>	

Approved for Drilling only. Not to be used for injection prior to approval from Santa Fe.

*AS*

DISTRICT I  
P.O. Box 1980, Hobbs, NM 88241-1980

State of New Mexico  
Energy, Minerals and Natural Resources Department

Form C-102  
Revised February 10, 1994  
Submit to Appropriate District Office  
State Lease - 4 Copies  
Fee Lease - 3 Copies

DISTRICT II  
P.O. Drawer DD, Artesia, NM 88211-0719

DISTRICT III  
1000 Rio Brazos Rd., Aztec, NM 87410

**OIL CONSERVATION DIVISION**  
P.O. Box 2088

Santa Fe, New Mexico 87504-2088

DISTRICT IV  
P.O. BOX 2066, SANTA FE, N.M. 87504-2066

AMENDED REPORT

**WELL LOCATION AND ACREAGE DEDICATION PLAT**

API Number		Pool Code	Pool Name
		62180	Vacuum Graygurg/San Andres
Property Code	Property Name		Well Number
009166	EVGSAU		392
GGRID No.	Operator Name		Elevation
017643	PHILLIPS PETROLEUM COMPANY		3929

**Surface Location**

UL or lot No.	Section	Township	Range	Lot Idn	Feet from the	North/South line	Feet from the	East/West line	County
F	27	17 S	35 E		1409	NORTH	2551	WEST	LEA

**Bottom Hole Location If Different From Surface**

UL or lot No.	Section	Township	Range	Lot Idn	Feet from the	North/South line	Feet from the	East/West line	County

Dedicated Acres	Joint or Infill	Consolidation Code	Order No.
40			

NO ALLOWABLE WILL BE ASSIGNED TO THIS COMPLETION UNTIL ALL INTERESTS HAVE BEEN CONSOLIDATED OR A NON-STANDARD UNIT HAS BEEN APPROVED BY THE DIVISION

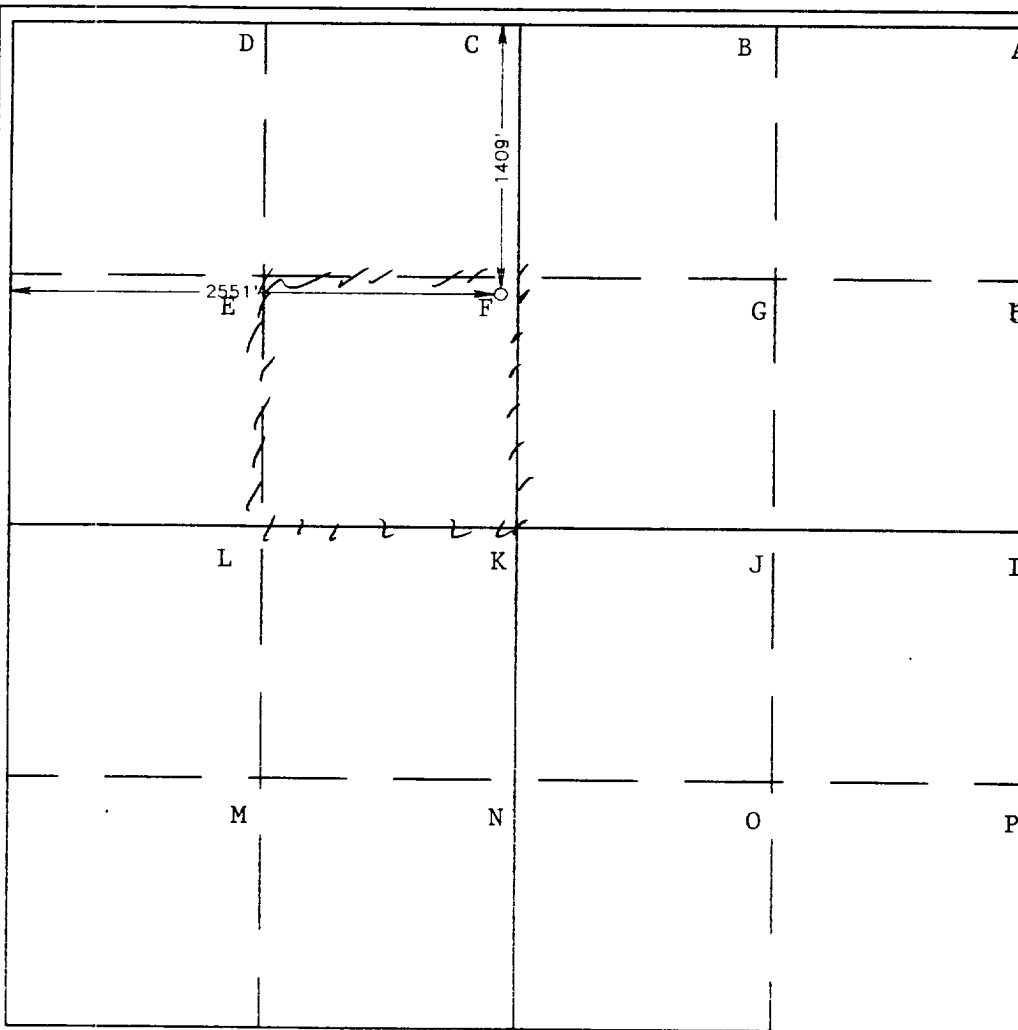

**OPERATOR CERTIFICATION**

I hereby certify the the information contained herein is true and complete to the best of my knowledge and belief.

*L. M. Sanders*  
Signature

L. M. Sanders  
Printed Name

Sr. REgulation Analyst  
Title

March 11, 1996  
Date

---

**SURVEYOR CERTIFICATION**

I hereby certify that the well location shown on this plat was plotted from field notes of actual surveys made by me or under my supervision, and that the same is true and correct to the best of my belief.

FEBRUARY 16, 1996  
Date Surveyed

SJA

*Ronald J. Eidson*  
Signature & Seal of Professional Surveyor

W.O. Num. 96-118-0222

Certificate No. JOHN W. WEST 676  
RONALD J. EIDSON 3239  
GARY WILSON 12641

## CASING & CEMENTING PROGRAM

EVGSAU 2738-392

### 8 5/8" 24 lb/ft J-55 Surface Casing Set at 1600' - 12 1/4" Hole:

Lead: 450 sx Class "C" +4% Gel + 2% CaCl<sub>2</sub>.  
Desired TOC = Surface.

Slurry Weight:	13.5 ppg
Slurry Yield:	1.72 ft <sup>3</sup> /sx
Water Requirement:	9.06 gals/sx

Tail: 150 sx Class "C" + 2% CaCl<sub>2</sub>.  
Desired TOC = 1300'.

Slurry Weight:	14.8 ppg
Slurry Yield:	1.32 ft <sup>3</sup> /sx
Water Requirement:	6.3 gals/sx

### 5 1/2" 15.5 lb/ft J-55 Production Casing Set at 4655' - 7 7/8" Hole:

Lead: 700 sx Class "C" 65/35 Poz + 6% Gel + 3% Salt.  
Desired TOC = Surface.

Slurry Weight:	12.8 ppg
Slurry Yield:	1.85 ft <sup>3</sup> /sx
Water Requirement:	9.9 gals/sx

Tail: 200 sx Class "C" 50/50 Poz + Fluid Loss + 1.5% CaCl<sub>2</sub>.  
Desired TOC = 4000'.

Slurry Weight:	14.6 ppg
Slurry Yield:	1.15 ft <sup>3</sup> /sx
Water Requirement:	5.0 gals/sx

## MUD PROGRAM

East Vacuum Grayburg San Andres (3467 - 391 & 2738 - 392)

DEPTH	MUD WEIGHT	VISCOSITY	FLUID LOSS	CL PPM	% SOLIDS	ADDITIVES
Surf. - 1600'	8.3 - 9.0 ppg	28 - 36 sec/1000 cc	N/C	-	-	Native Solids
1600' - 4000'	10.0 ppg	28 - 32 sec/1000 cc	N/C	Saturated	-	Native Solids
4000' - TD	10.0 - 10.2 ppg	32 - 36 sec/1000 cc	20 cc	Saturated	-	Starch/Drispac+

The Mud Engineer shall include on each test report the materials used for the previous 24 hour period. Daily fax the test reports to (915) 368-1507 Attn: J.C. Shoumaker / L.E. Robinson.

Send two copies of the Well Recap (Final Cost & Engineering Summaries) to Phillips Petroleum Company, Attn: J.C. Shoumaker / L.E. Robinson, 4001 Penbrook, Odessa, Texas 79762

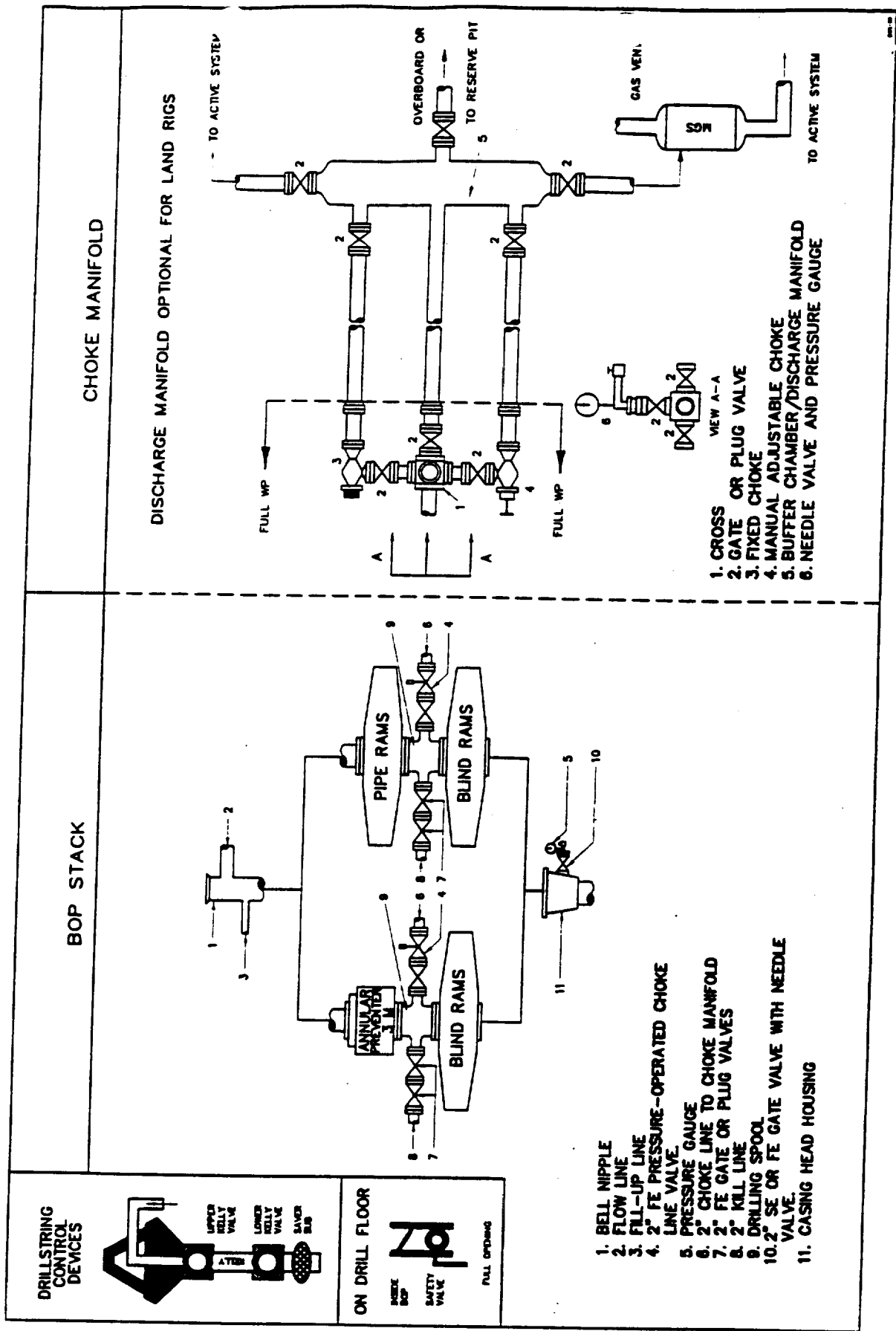

Fig. 2.4. Class 2 BOP and Choke Manifold.