

SECTION 1 TOWNSHIP 17 SOUTH, RANGE 35 EAST,
LEA COUNTY NEW MEXICO

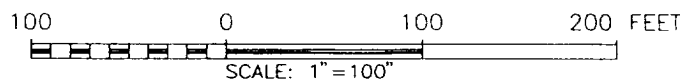
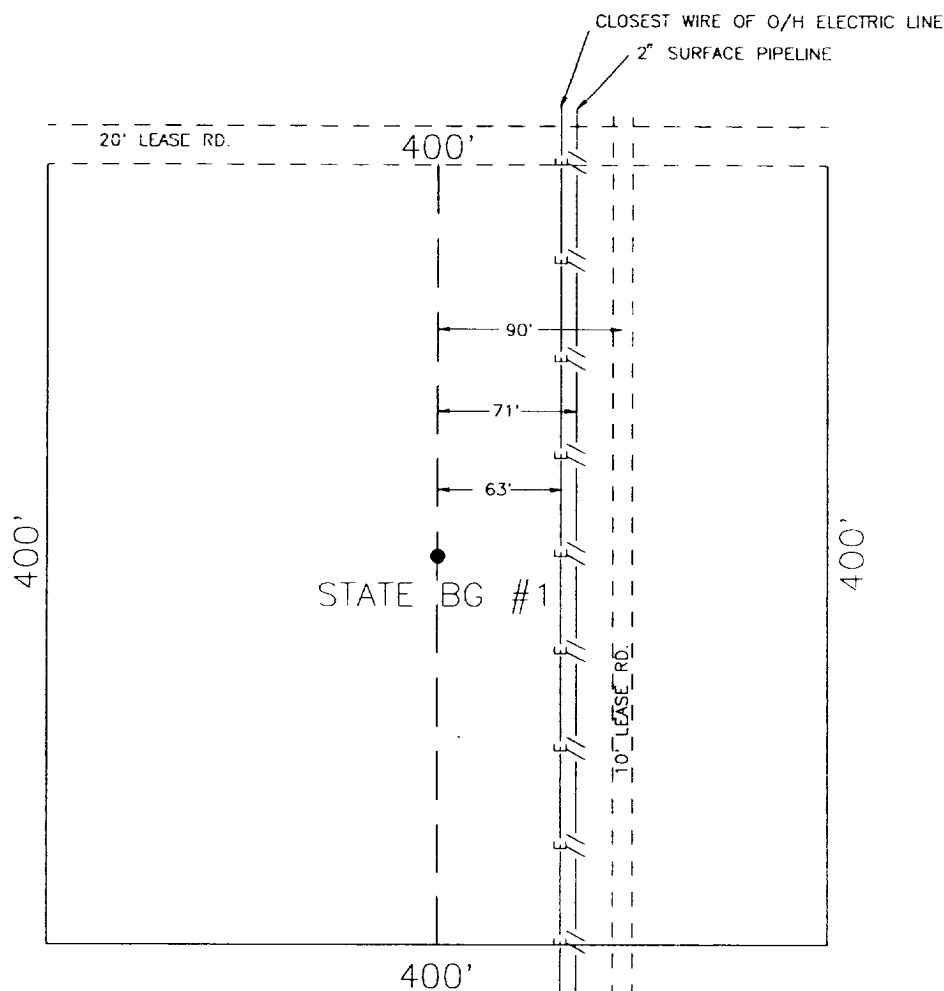

SHELL WESTERN E & P, INC.

THE STATE BG No. 1, LOCATED 990 FEET FROM THE
NORTH LINE AND 2310 FEET FROM THE EAST LINE OF
SECTION 19, TOWNSHIP 17 SOUTH, RANGE 35 EAST,
LEA COUNTY, NEW MEXICO.

JOHN W. WEST ENGINEERING COMPANY
CONSULTING ENGINEERS & SURVEYORS - HOBBS, NEW MEXICO

| | |
|-------------------------|-----------------------|
| Survey Date: 3-20-96 | Sheet 1 of 1 Sheets |
| W.O. Number: 96-11-0366 | Drawn By: D. McCARLEY |
| Date: 3-20-96 | DISK: SHELL |
| | 4X40366 |