

District I
PO Box 1980, Hobbs, NM 88241-1980
District II
811 South First, Artesia, NM 88210
District III
1000 Rio Brazos Rd., Aztec, NM 87410
District IV
2040 South Pacheco, Santa Fe, NM 87505

State of New Mexico
Energy, Minerals & Natural Resources Department

OIL CONSERVATION DIVISION
2040 South Pacheco
Santa Fe, NM 87505

Form C-101

Revised October 18, 1994

Instructions on back

Submit to Appropriate District Office

State Lease - 6 Copies

Fee Lease - 5 Copies

☐ AMENDED REPORT

APPLICATION FOR PERMIT TO DRILL, RE-ENTER, DEEPEN, PLUGBACK, OR ADD A ZONE

¹ Operator Name and Address. HENRY PETROLEUM CORP. 3525 Andrews Highway - Suite 200 Midland TX 79703-5048		² OGRID Number 155453
⁴ Property Code 1949D	³ Property Name STATE -27-	⁵ API Number 30 - 0 25-33582
		⁶ Well No. 1

⁷ Surface Location

UL or lot no.	Section	Township	Range	Lot Idn	Feet from the	North/South line	Feet from the	East/West line	County
K	27	17S	35E		1650	South	1980	West	LEA

⁸ Proposed Bottom Hole Location If Different From Surface

UL or lot no.	Section	Township	Range	Lot Idn	Feet from the	North/South line	Feet from the	East/West line	County
⁹ Proposed Pool 1 Wildcat					¹⁰ Proposed Pool 2				

¹¹ Work Type Code N	¹² Well Type Code O	¹³ Cable/Rotary R	¹⁴ Lease Type Code S	¹⁵ Ground Level Elevation 3936
¹⁶ Multiple NO	¹⁷ Proposed Depth 12,900	¹⁸ Formation Devonian	¹⁹ Contractor FWA - Rig #25	²⁰ Spud Date 10/01/96

²¹ Proposed Casing and Cement Program

Hole Size	Casing Size	Casing weight/foot	Setting Depth	Sacks of Cement	Estimated TOC
17-1/2	13-3/8	48#	400	325	Surface
12-1/4	8-5/8	32#	4850	2570	Surface
7-7/8	5-1/2	17#	12900	500	10,000'

²² Describe the proposed program. If this application is to DEEPEN or PLUG BACK give the data on the present productive zone and proposed new productive zone. Describe the blowout prevention program, if any. Use additional sheets if necessary.

B.O.P. Equipment: 13-5/8" x 10,000# Shaffer double ram and 13-5/8" x 10,000# Shaffer annular or 13-5/8" x 5,000# Cameron double ram with H2S service and 13-5/8" x 5,000# Hydril annular, 4" double valve 5,000# choke manifold, Koomey 6-station accumulator with remote closing unit. Permit Expires 1 Year From Approval Date Unless Drilling Underway

²³ I hereby certify that the information given above is true and complete to the best of my knowledge and belief.

Signature:

Printed name:

ROY R. JOHNSON

Title:

REGULATORY & MATERIALS TECH.

OIL CONSERVATION DIVISION

Approved by:

ORIGINAL SIGNED BY JERRY SEXTON

Title:

DIRECTOR

Approval Date:

SEP 17 1996

Expiration Date:

C-101 Instructions

Measurements and dimensions are to be in feet/inches. Well locations will refer to the New Mexico Principal Meridian.

IF THIS IS AN AMENDED REPORT CHECK THE BOX LABELED "AMENDED REPORT" AT THE TOP OF THIS DOCUMENT.

program. Attach additional sheets if necessary.

23

The signature, printed name, and title of the person authorized to make this report. The date this report was signed and the telephone number to call for questions about this report.

- 1 Operator's OGRID number. If you do not have one it will be assigned and filled in by the District office.
- 2 Operator's name and address
- 3 API number of this well. If this is a new drill the OCD will assign the number and fill this in.
- 4 Property code. If this is a new property the OCD will assign the number and fill it in.
- 5 Property name that used to be called 'well name'
- 6 The number of this well on the property.
- 7 The surveyed location of this well New Mexico Principal Meridian NOTE: If the United States government survey designates a Lot Number for this location use that number in the 'UL or lot no.' box. Otherwise use the OCD Unit Letter.
- 8 The proposed bottom hole location of this well at TD
- 9 and 10 The proposed pool(s) to which this well is being drilled.
- 11 Work type code from the following table:

N	New well
E	Re-entry
D	Drill deeper
P	Plugback
A	Add a zone
- 12 Well type code from the following table:

O	Single oil completion
G	Single gas completion
M	Multiple completion
I	Injection well
S	SWD well
W	Water supply well
C	Carbon dioxide well
- 13 Cable or rotary drilling code

C	Propose to cable tool drill
R	Propose to rotary drill
- 14 Lease type code from the following table:

S	State
P	Private
- 15 Ground level elevation above sea level
- 16 Intend to multiple complete? Yes or No
- 17 Proposed total depth of this well
- 18 Geologic formation at TD
- 19 Name of the intended drilling company if known.
- 20 Anticipated spud date.
- 21 Proposed hole size ID inches, proposed casing OD inches, casing weight in pounds per foot, setting depth of the casing or depth and top of liner, proposed cementing volume, and estimated top of cement
- 22 Brief description of the proposed drilling program and BOP

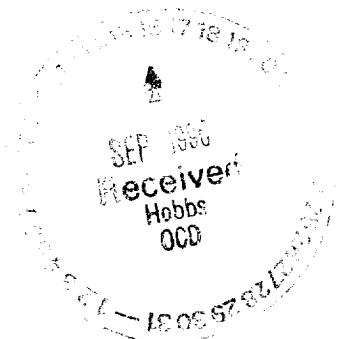

DISTRICT I
P.O. Box 1880, Hobbs, NM 88241-1880

DISTRICT II
P.O. Drawer 10, Artesia, NM 88211-0719

DISTRICT III
1000 Rio Brazos Rd., Artesia, NM 87410

DISTRICT IV
P.O. Box 2088, Santa Fe, N.M. 87504-2088

State of New Mexico
Energy, Minerals and Natural Resources Department

Form C-102
Revised February 10, 1984
Submit to Appropriate District Office
State Lease - 4 Copies
Fee Lease - 3 Copies

OIL CONSERVATION DIVISION

P.O. Box 2088
Santa Fe, New Mexico 87504-2088

☐ AMENDED REPORT

WELL LOCATION AND ACREAGE DEDICATION PLAT

API Number 30-025-33582	Pool Code ✓	Pool Name Wildcat Devonian
Property Code 19490	Property Name STATE 27	Well Number 1
OGED No. 155453	Operator Name HENRY PETROLEUM CORP.	Elevation 3936

Surface Location

UL or lot No. K	Section 27	Township 17 S	Range 35 E	Lot Idn	Feet from the 1980	North/South line WEST	Feet from the 1650	East/West line SOUTH	County LEA
--------------------	---------------	------------------	---------------	---------	-----------------------	--------------------------	-----------------------	-------------------------	---------------

Bottom Hole Location If Different From Surface

UL or lot No.	Section	Township	Range	Lot Idn	Feet from the	North/South line	Feet from the	East/West line	County
Dedicated Acres 40	Joint or Infill	Consolidation Code	Order No.						

NO ALLOWABLE WILL BE ASSIGNED TO THIS COMPLETION UNTIL ALL INTERESTS HAVE BEEN CONSOLIDATED
OR A NON-STANDARD UNIT HAS BEEN APPROVED BY THE DIVISION

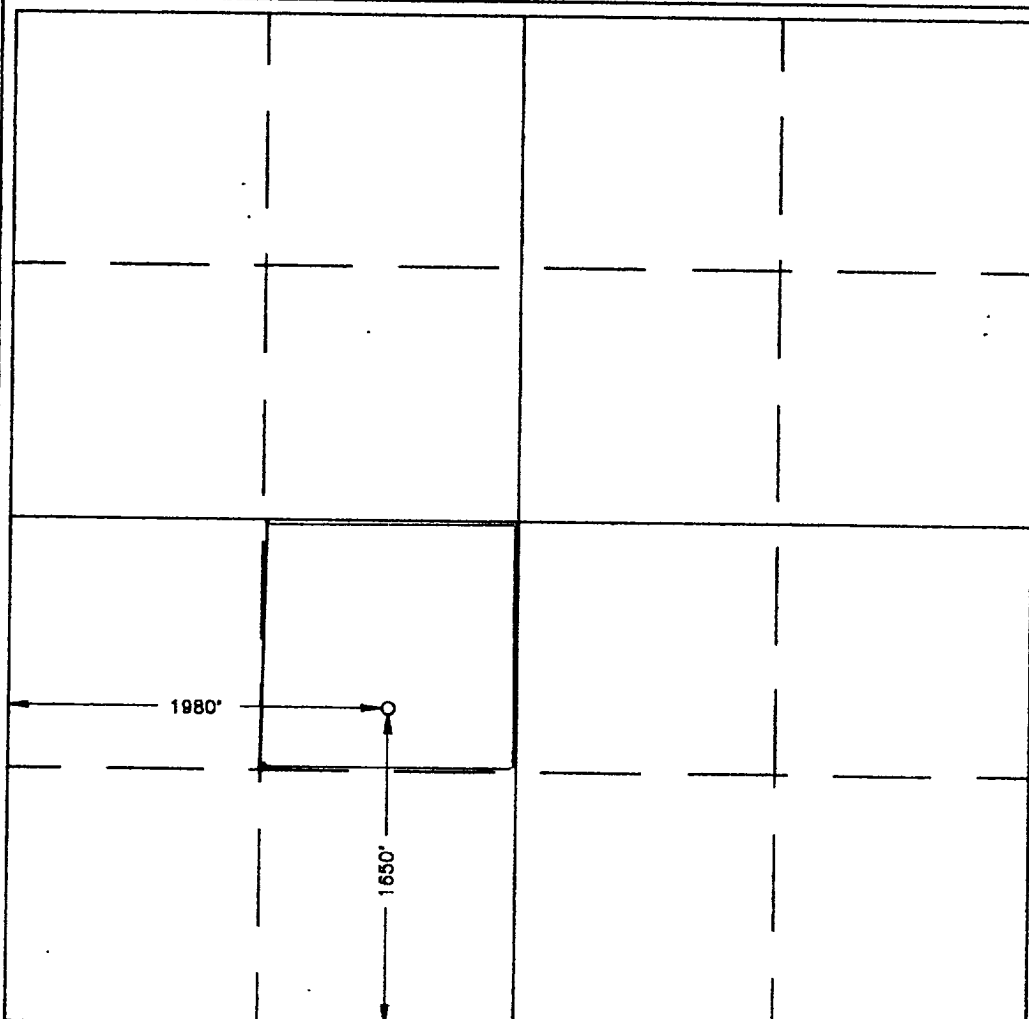
	<p>OPERATOR CERTIFICATION</p> <p>I hereby certify the the information contained herein is true and complete to the best of my knowledge and belief.</p> <p><i>Roy R. Johnson</i> Signature ROY R. JOHNSON Printed Name REGULATORY TECHNICIAN Title SEPTEMBER 10, 1996 Date</p>
	<p>SURVEYOR CERTIFICATION</p> <p>I hereby certify that the well location shown on this plat was plotted from field notes of actual surveys made by me or under my supervision, and that the same is true and correct to the best of my belief.</p> <p>AUGUST 13, 1996 Date Surveyed RES Signature & Seal of Professional Surveyor <i>Ronald J. Edson</i> W.O. Num. 96-11-1010 Certificate No. JOHN W. WEST 876 RONALD J. EDSON 3239 GARY EDSON 12641</p>

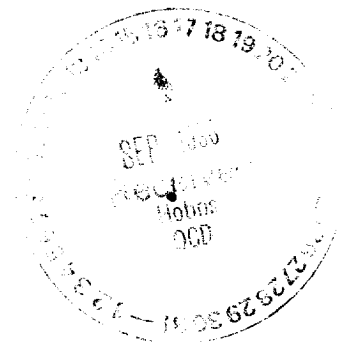

FOUR

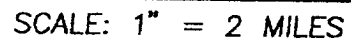

LEASE STATE 27

**JOHN WEST ENGINEERING
HOBBS, NEW MEXICO
(505) 393-3117**

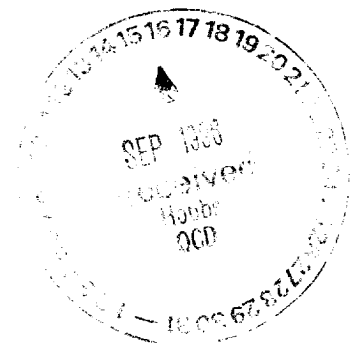

LOCATION VERIFICATION MAP

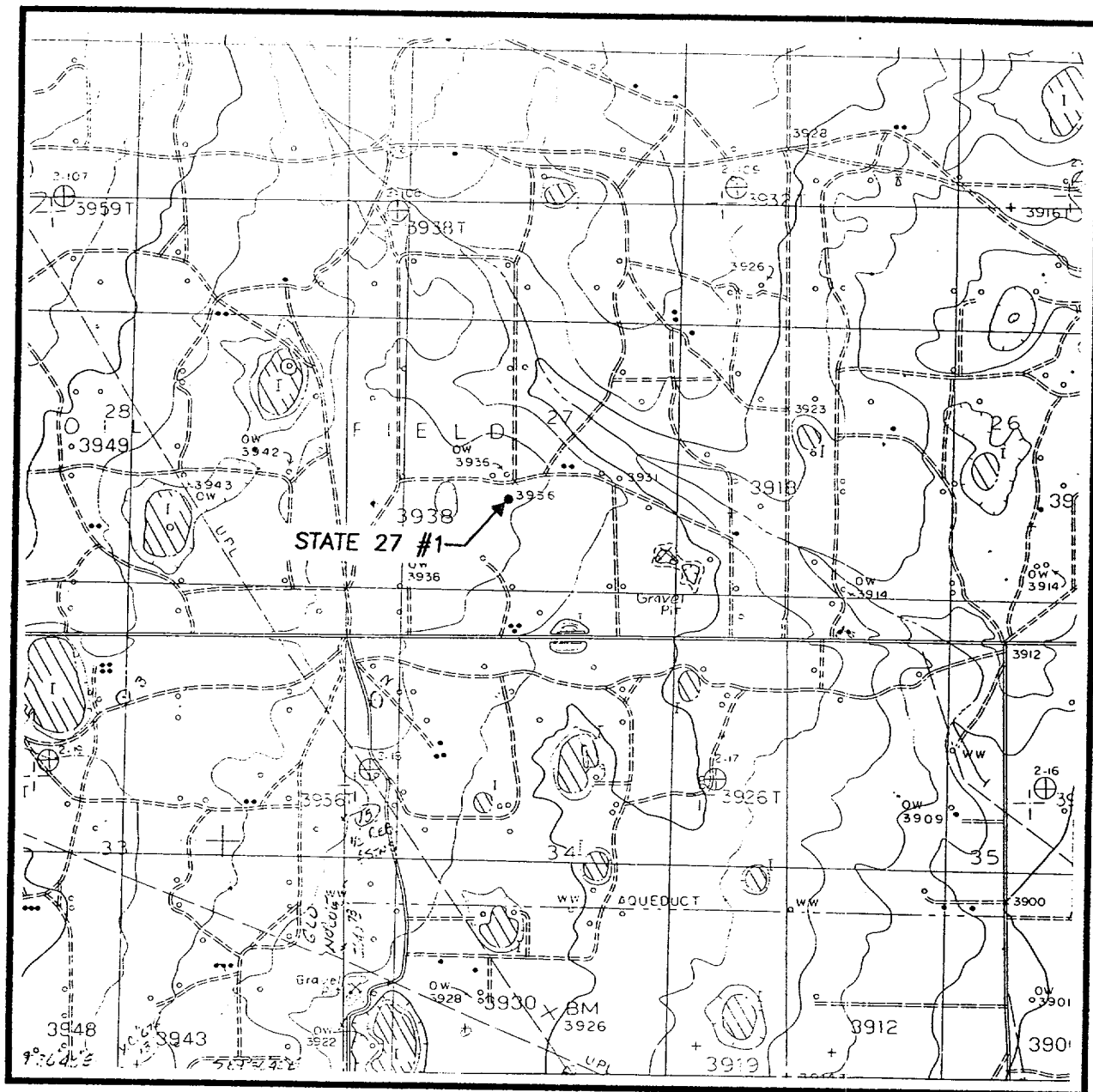

SCALE: 1" = 2000'

CONTOUR INTERVAL:
LOVINGTON, N.M., NW - 5'

SEC. 27 TWP. 17-S RGE. 35-E

SURVEY N.M.P.M.

COUNTY LEA

DESCRIPTION 1980' FWL & 1650' FSL

ELEVATION 3936'

OPERATOR HENRY PETROLEUM CORP.

LEASE STATE 27

U.S.G.S. TOPOGRAPHIC MAP

LOVINGTON, N.M., SW

**JOHN WEST ENGINEERING
HOBBS, NEW MEXICO**

(505) 393-3117

46/27/9
46/28/9
46/29/9
46/30/9
46/31/9

