

SECTION 28, TOWNSHIP 17 SOUTH, RANGE 35 EAST,
LEA COUNTY NEW MEXICO.

NW/4 SE/4

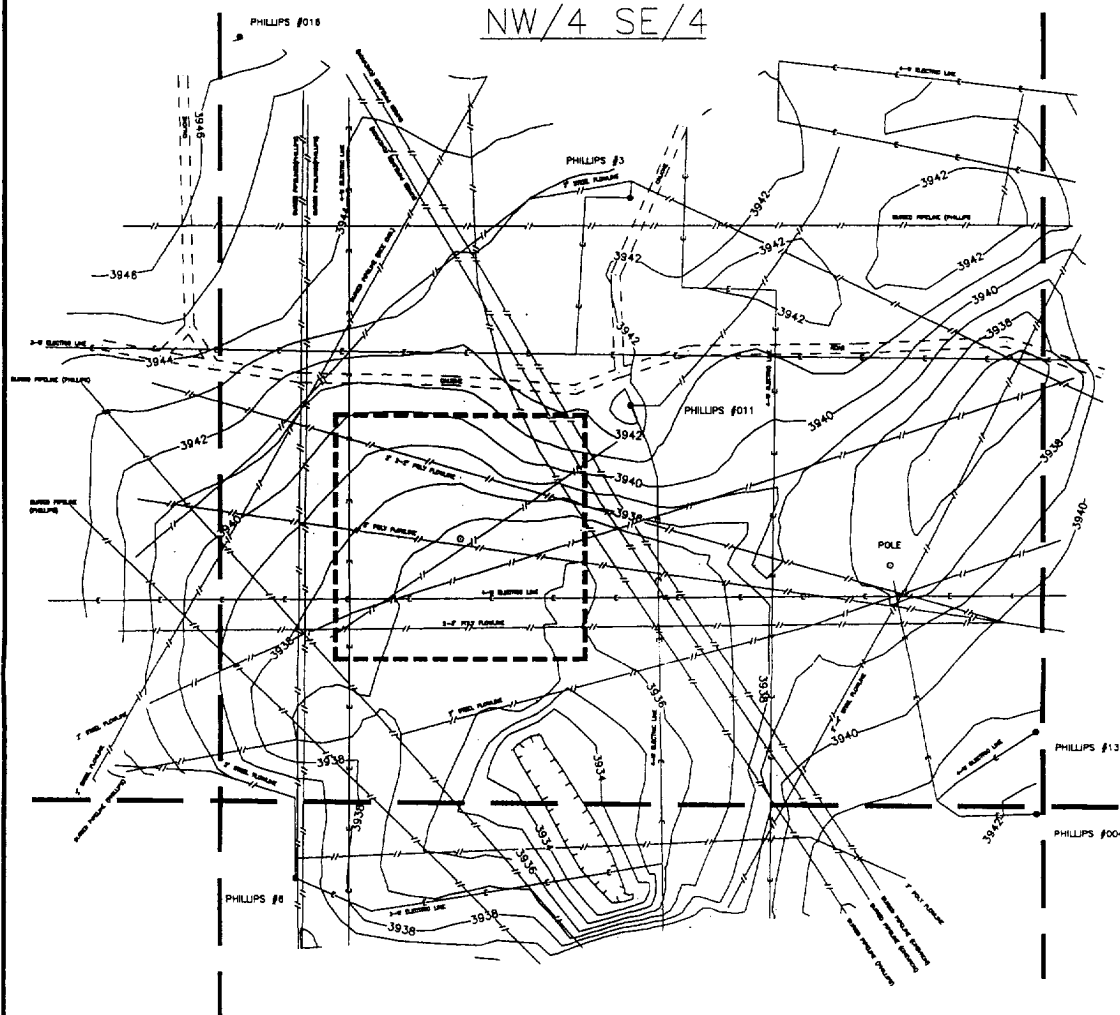

SCALE: 1" = 200'



SHELL WESTERN E & P, INC.

TOPOGRAPHIC SURVEY FOR THE HOOVER 28 #1
2256 FSL AND 1761 FEL, SECTION 28,
TOWNSHIP 17 SOUTH, RANGE 35 EAST, N.M.P.M.,
LEA COUNTY, NEW MEXICO.

Survey Date: 10/22/96	Sheet 1 of 1 Sheets
W.O. Number: 96-11-1353	Drawn By: D. McCARLEY
Date: 10/29/96	Disk: SHELL
SHEL1353	Scale: 1" = 200'

JOHN W. WEST ENGINEERING COMPANY
CONSULTING ENGINEERS & SURVEYORS - HOBBS, NEW MEXICO