

DISTRICT I
P.O. Box 1980, Hobbs, NM 88241-1980

State of New Mexico
Energy, Minerals and Natural Resources Department

Form C-101
Revised February 10, 1994

DISTRICT II
P.O. Box Drawer DD, Artesia, NM 88211-0719

OIL CONSERVATION DIVISION
P.O. Box 2088
Santa Fe, New Mexico 87504-2088

DISTRICT III
1000 Rio Brazos Rd., Aztec, NM 87410

DISTRICT IV
P.O. Box 2088, Santa Fe, NM 87504-2088

Instructions on back
Submit to Appropriate District Office
State Lease - 6 Copies
Fee Lease - 5 Copies

☐ AMENDED REPORT

APPLICATION FOR PERMIT TO DRILL, RE-ENTER, DEEPEN, PLUGBACK, OR ADD A ZONE

¹ Operator Name and Address TEXACO EXPLORATION & PRODUCTION INC. 205 E. Bender, HOBBS, NM 88240		² OGRID Number 022351
		³ API Number 30-025-33850
⁴ Property Code 11050	⁵ Property Name NEW MEXICO Q STATE	⁶ Well No. 12

⁷ Surface Location									
UI or lot no.	Section	Township	Range	Lot.Idn	Feet From The	North/South Line	Feet From The	East/West Line	County
O	25	17-S	34-E		400	SOUTH	1900	EAST	LEA

⁸ Proposed Bottom Hole Location If Different From Surface									
UI or lot no.	Section	Township	Range	Lot.Idn	Feet From The	North/South Line	Feet From The	East/West Line	County
⁹ Proposed Pool 1 WOLFCAMP & UPPER PENN					¹⁰ Proposed Pool 2				

¹¹ Work Type Code P	¹² WellType Code O	¹³ Rotary or C.T. ROTARY	¹⁴ Lease Type Code S	¹⁵ Ground Level Elevation 3998' GR
¹⁶ Multiple No	¹⁷ Proposed Depth 10350'	¹⁸ Formation PENN/WOLFCAMP	¹⁹ Contractor	²⁰ Spud Date 11/20/98

²¹ Proposed Casing and Cement Program					
SIZE OF HOLE	SIZE OF CASING	WEIGHT PER FOOT	SETTING DEPTH	SACKS OF CEMENT	EST. TOP
14 3/4"	11 3/4"	42#	1504'	840 SX, CIR O SX	SURFACE
11"	8 5/8"	32#	3718'	1825 SX, CIR 183 SX	SURFACE
7 7/8"	5 1/2"	15.5 & 17#	10349'	2500 SX, CIR 278 SX	3400'

22 Describe the proposed program. If this application is to DEEPEN or PLUG BACK give the data on the present productive zone and proposed new productive zone.
Describe the blowout prevention program, if any. Use additional sheets if necessary.

TEXACO INTENDS TO PERFORATE ADDITIONAL PAY IN THE WOLFCAMP FORMATION. A SUCCESSFUL RECOMPLETION WILL THEN BE COMMINGLED WITH THE UPPER PENN ZONE CURRENTLY BEING PRODUCED.

THE INTENDED PROCEDURE IS ATTACHED.

Permit Expires 1 Year From Approval
Date Unless Drilling Underway
Plug Back

²³ I hereby certify that the rules and regulations of the Oil Conservation Division have been complied with and that the information given above is true and complete to the best of my knowledge and belief.		OIL CONSERVATION DIVISION	
Signature <i>J. Denise Leake</i>		Approved By: <i>ORRILL L. WILLIAMS</i> DISTRICT SUPERVISOR	
Printed Name J. Denise Leake		Title:	
Title Engineering Assistant		Approval Date: <i>DEC 16 1998</i> Expiration Date:	
Date 11/10/98	Telephone 397-0405	Conditions of Approval: Attached <input type="checkbox"/>	

New Mexico "Q" St. No. 12

PROPOSED WORKOVER PROCEDURE

Prior to workover notify NMOCD of intent to commingle Upper Penn and Wolfcamp intervals.

1. MIRU SU. Pull tubing rods and pump.
2. RU wireline crew. Set CIBP at 10000'
3. Perforate the Wolfcamp at the following intervals with 2 jspf using 4" OD cased carrier gun with 180-degree phasing and 0.50" hole.

<u>INTERVAL</u>	<u>NET</u>	<u>HOLES</u>
9310-32	22	44
9340-60	20	40
9516-34	18	36
9558-64	6	12
9578-80	2	4
9630-78	48	96
9800-04	4	8
9810-12	2	4
9918-22	4	8
9925-27	<u>2</u>	<u>4</u>
Total	128	256

4. RU Dowell. RIH with 5-1/2" packer and 2-7/8" workstring to 9950'. Spot acid from 9927' to 9450. Test tubing and lines to 5000 psig. Acidize perfs with 13000 gals 15% HCL NEFE with 200 ball sealers. Add scale inhibitor as required. Displace with 2% KCl water. Flow acid residue back.
5. Swab test perfs. Record rate, fluid levels, and cut.
6. Pull tbg and packer.
7. Run 2-7/8" tubing string, pump and rods to 9900'. Pump test Wolfcamp perfs.
8. After achieving a stabilized rate, apply for commingling permit. Drill out CIBP at 10000'. Rerun rods and tubing to 10200' and pump Wolfcamp and Upper Penn zones together for commingled production

DISTRICT I

P.O. Box 1980, Hobbs, NM 88241-1980

DISTRICT II

P.O. Box Drawer DD, Artesia, NM 88211-0719

DISTRICT III

1000 Rio Brazos Rd., Aztec, NM 87410

DISTRICT IV

P.O. Box 2088, Santa Fe, NM 87504-2088

State of New Mexico

Energy, Minerals and Natural Resources Department

OIL CONSERVATION DIVISION

P.O. Box 2088

Santa Fe, New Mexico 87504-2088

Form C-102

Revised February 10, 1994

Instructions on back

Submit to Appropriate District Office

State Lease - 4 Copies

Fee Lease - 3 Copies

☐ AMENDED REPORT

WELL LOCATION AND ACREAGE DEDICATION PLAT

¹ API Number 30-025-33850	² Pool Code 62340	³ Pool Name VACUUM WOLFCAMP
⁴ Property Code 11050	⁵ Property Name NEW MEXICO Q STATE	⁶ Well No. 12
⁷ OGRID Number 022351	⁸ Operator Name TEXACO EXPLORATION & PRODUCTION INC.	⁹ Elevation 3998' GR

¹⁰ Surface Location

Ul or lot no.	Section	Township	Range	Lot.Idn	Feet From The	North/South Line	Feet From The	East/West Line	County
O	25	17-S	34-E		400	SOUTH	1900	EAST	LEA

¹¹ Bottom Hole Location If Different From Surface

Ul or lot no.	Section	Township	Range	Lot.Idn	Feet From The	North/South Line	Feet From The	East/West Line	County

¹² Dedicated Acres 80	¹³ Joint or Infill No	¹⁴ Consolidation Code	¹⁵ Order No.
-------------------------------------	-------------------------------------	----------------------------------	-------------------------

NO ALLOWABLE WILL BE ASSIGNED TO THIS COMPLETION UNTIL ALL INTERESTS HAVE BEEN CONSOLIDATED
OR A NON-STANDARD UNIT HAS BEEN APPROVED BY THE DIVISION

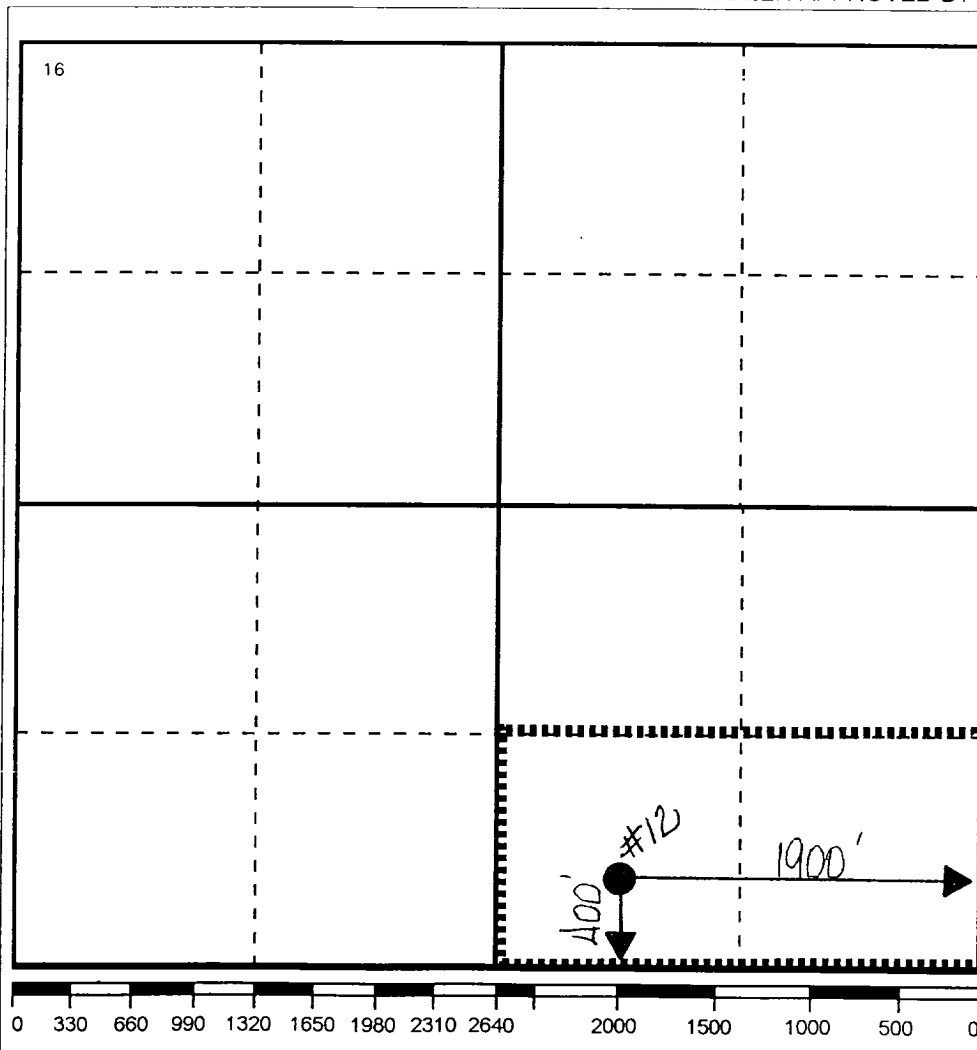

17 OPERATOR CERTIFICATION

I hereby certify that the information contained herein is true and complete to the best of my knowledge and belief

Signature

Printed Name

J. Denise Leake

Position

Engineering Assistant

Date

12/10/98

18 SURVEYOR CERTIFICATION

I hereby certify that the well location shown on this plat was plotted from field notes of actual surveys made by me or under my supervision, and that the same is true and correct to the best of my knowledge and belief.

Date Surveyed

Signature & Seal of
Professional Surveyor

Certificate No.

DISTRICT I

P.O. Box 1980, Hobbs, NM 88241-1980

DISTRICT II

P.O. Box Drawer DD, Artesia, NM 88211-0719

DISTRICT III

1000 Rio Brazos Rd., Aztec, NM 87410

DISTRICT IV

P.O. Box 2088, Santa Fe, NM 87504-2088

State of New Mexico
Energy, Minerals and Natural Resources Department

OIL CONSERVATION DIVISION

P.O. Box 2088
Santa Fe, New Mexico 87504-2088

Form C-102

Revised February 10, 1994

Instructions on back

Submit to Appropriate District Office

State Lease - 4 Copies

Fee Lease - 3 Copies

☐ AMENDED REPORT

WELL LOCATION AND ACREAGE DEDICATION PLAT

¹ API Number 30-025-33850	² Pool Code 62320	³ Pool Name VACUUM UPPER PENN
⁴ Property Code 11050	⁵ Property Name NEW MEXICO Q STATE	⁶ Well No. 12
⁷ OGRID Number 022351	⁸ Operator Name TEXACO EXPLORATION & PRODUCTION INC.	⁹ Elevation 3998' GR

¹⁰ Surface Location

UI or lot no.	Section	Township	Range	Lot.Idn	Feet From The	North/South Line	Feet From The	East/West Line	County
O	25	17-S	34-E		400	SOUTH	1900	EAST	LEA

¹¹ Bottom Hole Location If Different From Surface

UI or lot no.	Section	Township	Range	Lot.Idn	Feet From The	North/South Line	Feet From The	East/West Line	County
¹² Dedicated Acres 80	¹³ Joint or Infill No	¹⁴ Consolidation Code	¹⁵ Order No.						

NO ALLOWABLE WILL BE ASSIGNED TO THIS COMPLETION UNTIL ALL INTERESTS HAVE BEEN CONSOLIDATED
OR A NON-STANDARD UNIT HAS BEEN APPROVED BY THE DIVISION

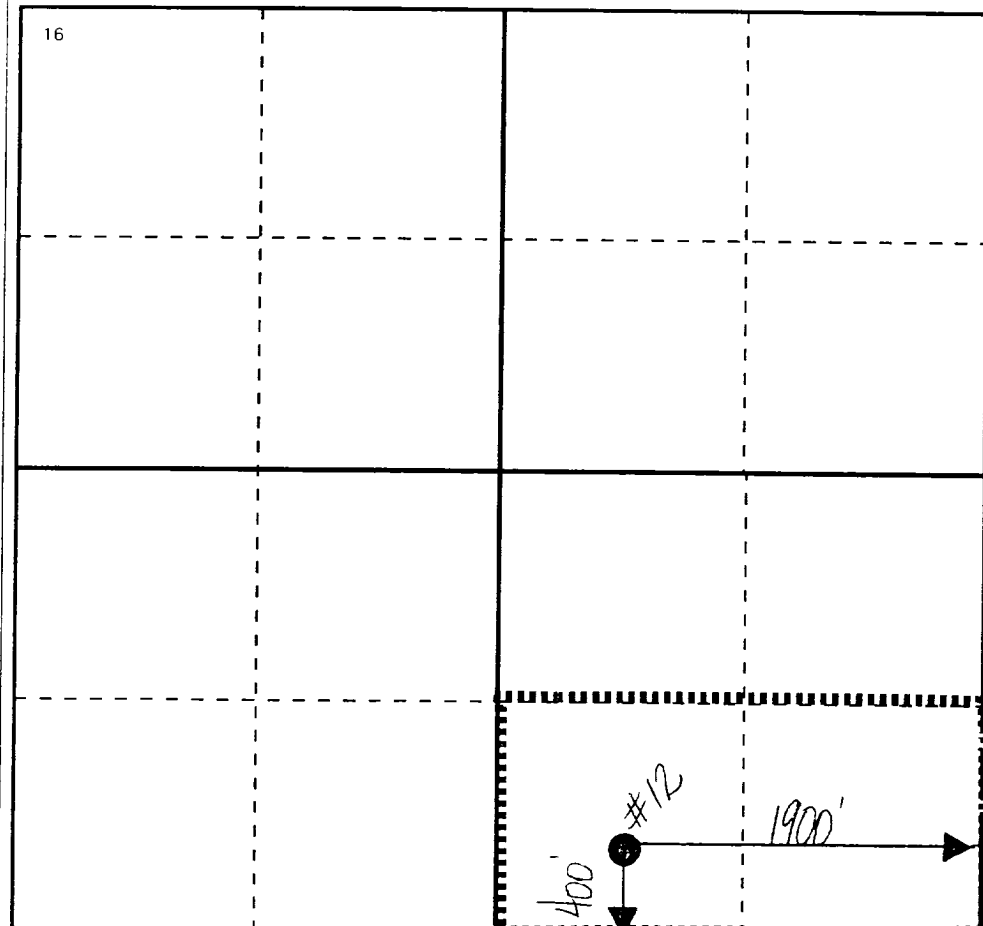
¹⁷ OPERATOR CERTIFICATION

I hereby certify that the information
contained herein is true and complete to the
best of my knowledge and belief

Signature

Printed Name

J. Denise Leake

Position

Engineering Assistant

Date

12/10/98

¹⁸ SURVEYOR CERTIFICATION

I hereby certify that the well location shown
on this plat was plotted from field notes of
actual surveys made by me or under my
supervision, and that the same is true and
correct to the best of my knowledge and
belief.

Date Surveyed

Signature & Seal of

Professional Surveyor

Certificate No.

