

District I
PO Box 1960, Hobbs, NM 88241-1960
District II
PO Drawer DD, Artesia, NM 88211-0719
District III
1000 Rio Brazos Rd., Aztec, NM 87410
District IV
PO Box 2068, Santa Fe, NM 87504-2068

OIL CONSERVATION DIVISION
P.O. Box 2088
Santa Fe, NM 87504-2088

Instructions on back
Submit to Appropriate District Office
State Lease - 6 Copies
Fee Lease - 5 Copies

☐ AMENDED REPORT

APPLICATION FOR PERMIT TO DRILL, RE-ENTER, DEEPEN, PLUGBACK, OR ADD A ZONE

¹ Operator name and Address ALTURA ENERGY LTD P O BOX 4294 HOUSTON TX 77210-4294		² OGRID Number 157984
		³ API Number 30-0 25-33979
⁴ Property Code 49975-20807	⁵ Property Name HOOVER 28	
		⁶ Well Number 4

⁷ Surface Location									
UL or lot no.	Section	Township	Range	Lot. Idn	Feet from the	North/South Line	Feet from the	East/West line	County
I	28	17S	35E		1650	SOUTH	330	EAST	LEA

⁸ Proposed Bottom Hole Location If Different From Surface									
UL or lot no.	Section	Township	Range	Lot. Idn	Feet from the	North/South Line	Feet from the	East/West line	County
⁹ Proposed Pool 1 EAST VACUUM - DRINKARD					¹⁰ Proposed Pool 2 EAST VACUUM - BLINEBRY				

¹¹ Work Type Code N	¹² Well Type Code O	¹³ Cable/Rotary R	¹⁴ Lease Type Code S	¹⁵ Ground Level Elevation 3939'
¹⁶ Multiple N	¹⁷ Proposed Depth 8500'	¹⁸ Formations DRINKARD/BLINEBRY	¹⁹ Contractor NORTON	²⁰ Spud Date APPROX 05/27/97

²¹ Proposed Casing and Cement Program					
Hole Size	Casing Size	Casing weight/foot	Setting Depth	Sacks of Cement	Estimated TOC
17-1/2"	13-3/8"	CONDUCTOR	40'	50 SXS	SURFACE
11"	8-5/8"	32#	1550'	500 SXS	SURFACE
7-7/8"	5-1/2"	17#	8500'	700/875 sxs	SURFACE

²² Describe the proposed program. If this application is to DEEPEN or PLUG BACK give the data on the present productive zone and proposed new productive zone. Describe the blowout prevention program, if any. Use additional sheets if necessary

BOP PROGRAM 2000# RAM PREVENTER.

Form C-101, Rev. 10-94, Form Approved
Prescribed by 48 CFR 101-11.6

²³ I hereby certify that the information given above is true and complete to the best of my knowledge and belief.

Signature:

Printed name: JEFF A DETHROW CPL

Title: CONTRACT LANDMAN

Date:
05-20-97

Phone:
(281) 544-3226

OIL CONSERVATION DIVISION

Approved by:

Title:

Approval Date: MAY 22 1997 Expiration Date:

Conditions of Approval:
Attached ☐

DISTRICT I
P.O. Box 1980, Hobbs, NM 88241-1980

State of New Mexico
Energy, Minerals and Natural Resources Department

Form C-102
Revised February 10, 1994
Submit to Appropriate District Office
State Lease - 4 Copies
Fee Lease - 3 Copies

DISTRICT II
P.O. Drawer DD, Artesia, NM 88211-0719

DISTRICT III
1000 Rio Brazos Rd., Aztec, NM 87410

OIL CONSERVATION DIVISION

P.O. Box 2088
Santa Fe, New Mexico 87504-2088

☐ AMENDED REPORT

DISTRICT IV
P.O. Box 2088, Santa Fe, NM 87504-2088

WELL LOCATION AND ACREAGE DEDICATION PLAT

API Number 30-025- 33979	Pool Code 96246	Pool Name East Vacuum - Drinkard
Property Code 19975 20807	Property Name HOOVER 28	Well Number 4
OGRID No. 157984	Operator Name ALTURA ENERGY LTD.	Elevation 3939

Surface Location

UL or lot No.	Section	Township	Range	Lot Idn	Feet from the	North/South line	Feet from the	East/West line	County
I	28	17 S	35 E		1650	SOUTH	330	EAST	LEA

Bottom Hole Location If Different From Surface

UL or lot No.	Section	Township	Range	Lot Idn	Feet from the	North/South line	Feet from the	East/West line	County
Dedicated Acres 40	Joint or Infill	Consolidation Code	Order No.						

NO ALLOWABLE WILL BE ASSIGNED TO THIS COMPLETION UNTIL ALL INTERESTS HAVE BEEN CONSOLIDATED
OR A NON-STANDARD UNIT HAS BEEN APPROVED BY THE DIVISION

				OPERATOR CERTIFICATION I hereby certify the the information contained herein is true and complete to the best of my knowledge and belief. Signature JEFF A DETHROW CPL Printed Name CONTRACT LANDMAN Title 04-24-97 Date	
				SURVEYOR CERTIFICATION I hereby certify that the well location shown on this plat was plotted from field notes of actual surveys made by me or under my supervision, and that the same is true and correct to the best of my belief. APRIL 8, 1997 Date Surveyed Signature & Seal of Professional Surveyor W.Q. Num. 97-11-0639 Certificate No. JOHN W. WEST, 676 RONALD J. EIDSON, 3239 GARY G. EIDSON, 1264	

DISTRICT I
P.O. Box 1980, Hobbs, NM 88241-1980

DISTRICT II
P.O. Drawer DD, Artesia, NM 88211-0719

DISTRICT III
1000 Rio Brazos Rd., Aztec, NM 87410

DISTRICT IV
P.O. Box 2088, Santa Fe, NM 87504-2088

State of New Mexico
Energy, Minerals and Natural Resources Department

Form C-102
Revised February 10, 1994
Submit to Appropriate District Office
State Lease - 4 Copies
Fee Lease - 3 Copies

OIL CONSERVATION DIVISION
P.O. Box 2088
Santa Fe, New Mexico 87504-2088

☐ AMENDED REPORT

WELL LOCATION AND ACREAGE DEDICATION PLAT

API Number 30-025- 33979	Pool Code 96373	Pool Name East Vacuum - Blinebry
Property Code 19975	Property Name HOOVER 28	Well Number 4
OGRID No. 157984	Operator Name ALTURA ENERGY LTD.	Elevation 3939

Surface Location

UL or lot No.	Section	Township	Range	Lot Idn	Feet from the	North/South line	Feet from the	East/West line	County
I	28	17 S	35 E		1650	SOUTH	330	EAST	LEA

Bottom Hole Location If Different From Surface

UL or lot No.	Section	Township	Range	Lot Idn	Feet from the	North/South line	Feet from the	East/West line	County
Dedicated Acres 40	Joint or Infill	Consolidation Code	Order No.						

NO ALLOWABLE WILL BE ASSIGNED TO THIS COMPLETION UNTIL ALL INTERESTS HAVE BEEN CONSOLIDATED
OR A NON-STANDARD UNIT HAS BEEN APPROVED BY THE DIVISION

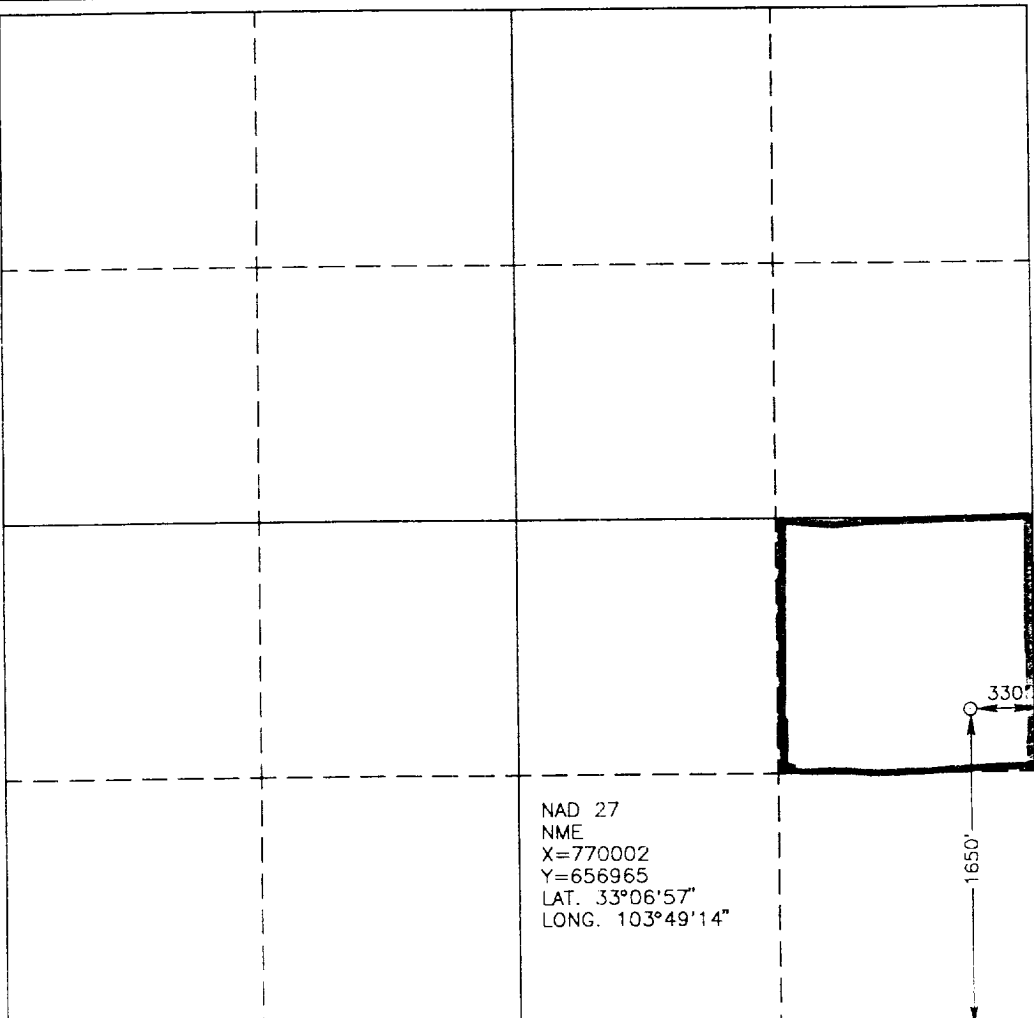
	NAD 27 NME X=770002 Y=656965 LAT. 33°06'57" LONG. 103°49'14"

OPERATOR CERTIFICATION

I hereby certify the the information contained herein is true and complete to the best of my knowledge and belief.

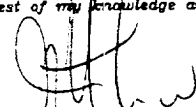

Signature
JEFF A DETHROW CPL
Printed Name
CONTRACT LANDMAN
Title
04-24-97
Date

SURVEYOR CERTIFICATION

I hereby certify that the well location shown on this plat was plotted from field notes of actual surveys made by me or under my supervision, and that the same is true and correct to the best of my belief.

APRIL 8, 1997
Date Surveyed
Signature & Seal of Professional Surveyor

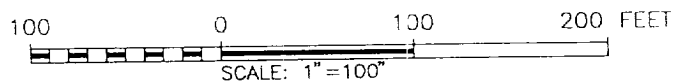
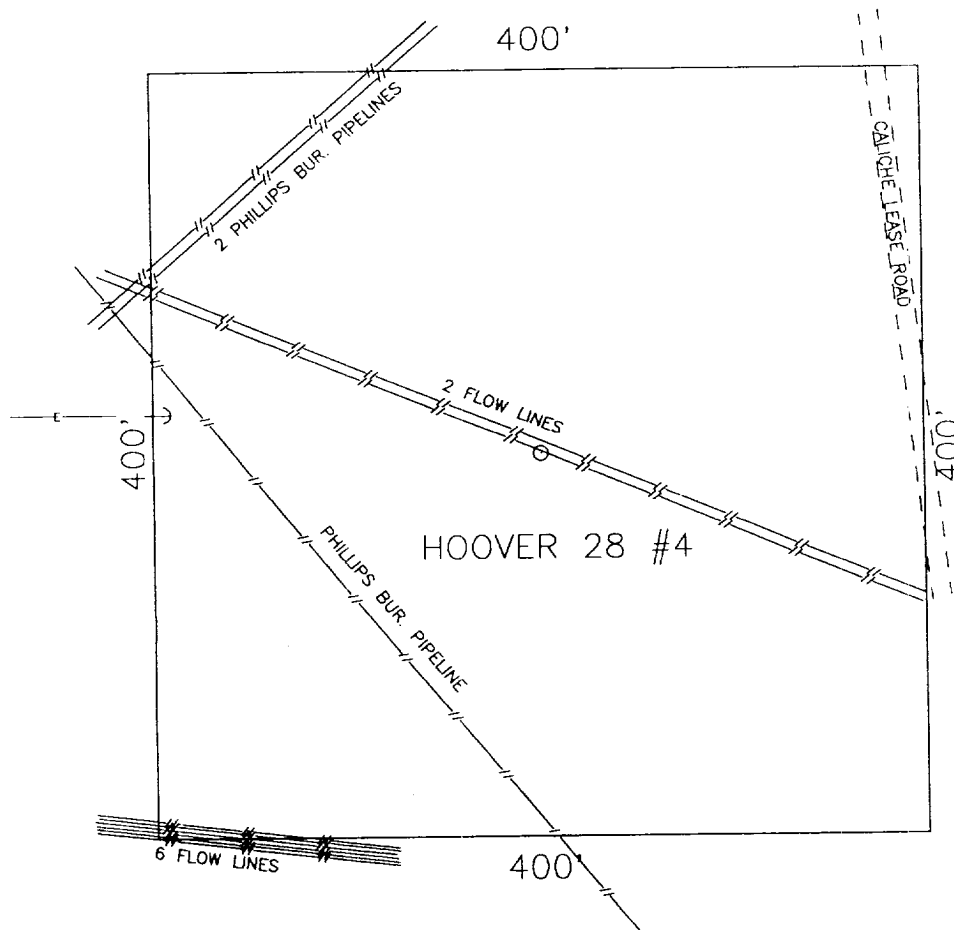
W.O. Num. 97-11-0639
Certificate No. JOHN W. WEST, 676
RONALD J. EIDSON, 3239
GARY G. EIDSON, 12641

SECTION 28, TOWNSHIP 17 SOUTH, RANGE 35 EAST, N.M.P.M.,
LEA COUNTY NEW MEXICO



Altura
ENERGY LTD.

ALTURA ENERGY LTD.

THE HOOVER 28 #4 LOCATED 1650 FEET FROM THE SOUTH
LINE AND 330 FEET FROM THE EAST OF SECTION 28,
TOWNSHIP 17 SOUTH, RANGE 35 EAST, N.M.P.M.,
LEA COUNTY, NEW MEXICO.

Survey Date: 4/8/97	Sheet 1 of 1 Sheets
W.O. Number: 97-11-0639	Drawn By: JAMES L. PRESLEY
Date: 4/10/97	DISK: ALT0639

JOHN W. WEST ENGINEERING COMPANY
CONSULTING ENGINEERS & SURVEYORS - HOBBS, NEW MEXICO

VICINITY MAP

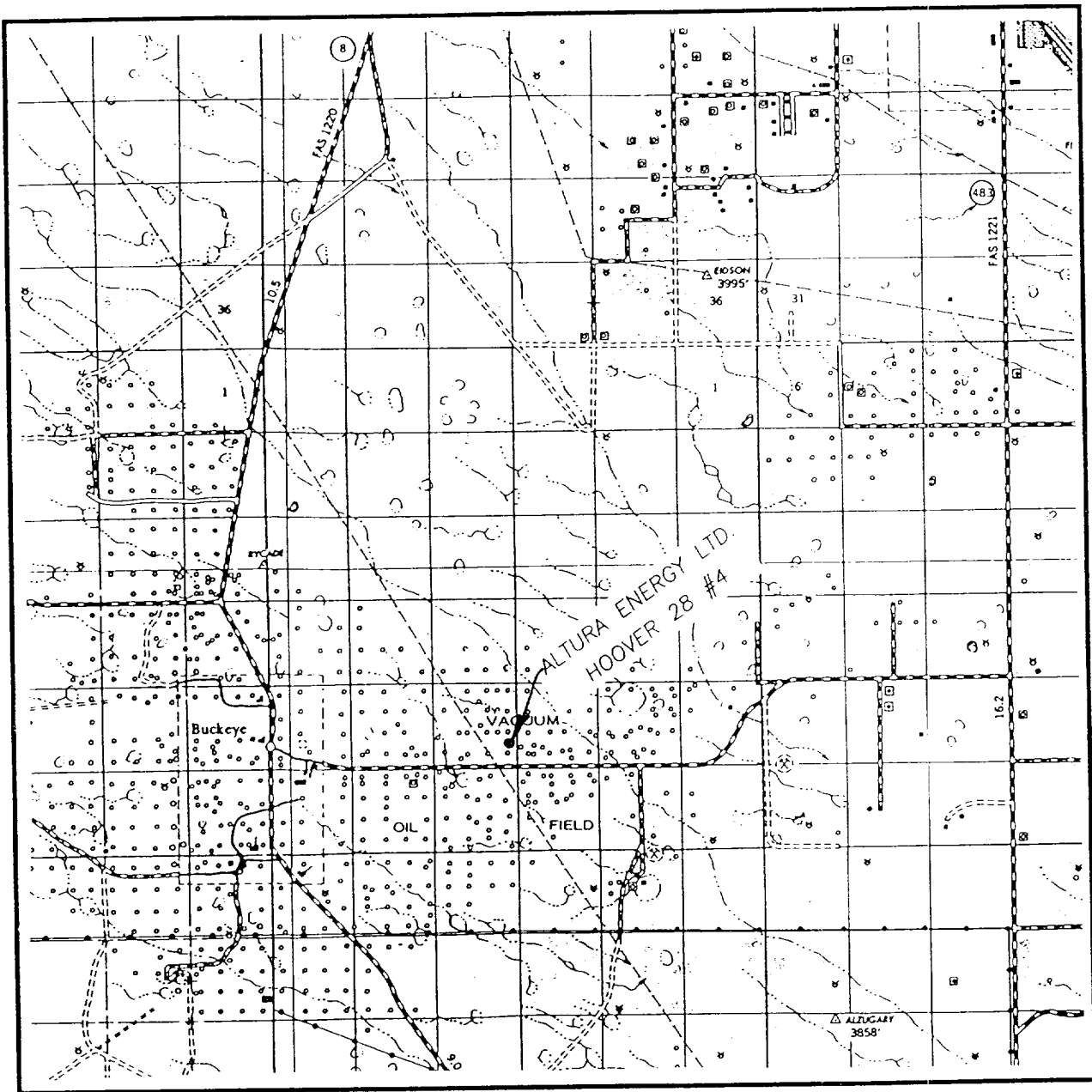

SCALE: 1" = 2 MILES

SEC. 32 TWP. 17-S RGE. 35-E
 SURVEY N.M.P.M.
 COUNTY LEA
 DESCRIPTION 1650' FSL & 330' FEL
 ELEVATION 3939'
 OPERATOR ALTURA ENERGY LTD.
 LEASE HOOVER 28

JOHN WEST ENGINEERING
HOBBS, NEW MEXICO
 (505) 393-3117

LOCATION VERIFICATION MAP

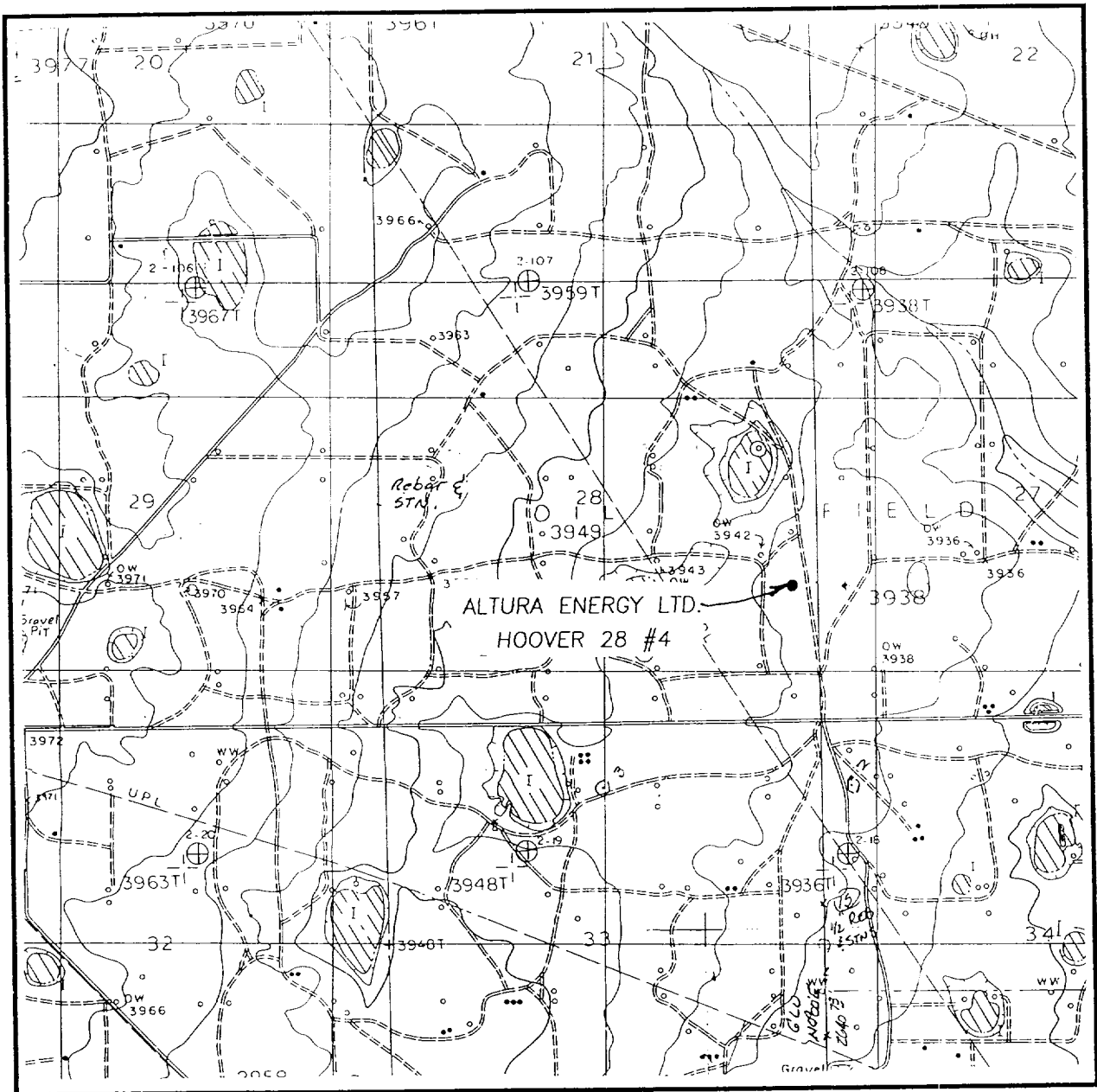

SCALE: 1" = 2000'

CONTOUR INTERVAL - 5'

SEC. 28 TWP. 17-S RGE. 35-E

SURVEY N.M.P.M.

COUNTY LEA

DESCRIPTION 1650' FSL & 330' FEL

ELEVATION 3939'

OPERATOR ALTURA ENERGY LTD.

LEASE HOOVER 28

U.S.G.S. TOPOGRAPHIC MAP
LOVINGTON SW, N.M.

JOHN WEST ENGINEERING
HOBBS, NEW MEXICO
(505) 393-3117