

UNITED STATES
DEPARTMENT OF THE INTERIOR
BUREAU OF LAND MANAGEMENT

APPLICATION FOR PERMIT TO DRILL OR DEEPEN

1a. TYPE OF WORK

DRILL ☒DEEPEN ☐

b. TYPE OF WELL

OIL
WELL ☒GAS
WELL ☐OTHER ☐SINGLE
ZONE ☐MULTIPLE
ZONE ☐

2. NAME OF OPERATOR

Nearburg Producing Company

3. ADDRESS AND TELEPHONE NO.

3300 North "A" Street, Bldg 2, Suite 120, Midland, TX 79705

4. LOCATION OF WELL (Report location clearly and in accordance with any State requirements.*)

At surface

660' FNL and 660' FWL

At proposed prod. zone

14. DISTANCE IN MILES AND DIRECTION FROM NEAREST TOWN OR POST OFFICE*

10 miles NE of Halfway, New Mexico

15. DISTANCE FROM PROPOSED*

LOCATION TO NEAREST
PROPERTY OR LEASE LINE, FT.
(Also to nearest drlg. unit line, if any)

660'

18. DISTANCE FROM PROPOSED LOCATION*

TO NEAREST WELL, DRILLING, COMPLETED,
OR APPLIED FOR, ON THIS LEASE, FT.

1,320'

21. ELEVATIONS (Show whether DF, RT, GR, etc.)

3,811' GR

23.

PROPOSED CASING AND CEMENTING PROGRAM

SIZE OF HOLE	GRADE, SIZE OF CASING	WEIGHT PER FOOT	SETTING DEPTH	QUANTITY OF CEMENT
17-1/2"	H-40 - 13-3/8"	48#	350'	500 sx circulate
11"	J-55 - 8-5/8"	24#	0'-2,000'	
	J-55 - 8-5/8"	32#	2,000'-3,900'	1,200 sx circulate to surface
7-7/8"	N-80 - 5-1/2"	17#	0'-3,000'	
	K-55 - 5-1/2"	17#	3,000'-7,000'	
	N-80 - 5-1/2"	17#	7,000'-9,800'	

CAPITAN CONTROLLED WATER BASIN

OPER. OGRID NO. 15742

PROPERTY NO. 21478

POOL CODE 21650

EFF. DATE 8/25/97

API NO. 30-025-34115

Propose to drill the well to sufficient depth to evaluate the Bone Spring formation. After reaching TD, logs will be run and casing set if the evaluation is positive. Perforate, test and stimulate as necessary to establish production.

APPROVAL SUBJECT TO
GENERAL REQUIREMENTS AND
SPECIAL STIPULATIONS

IN ABOVE SPACE DESCRIBE PROPOSED PROGRAM: If proposal is to deepen, give data on present production and proposed new productive zone. If proposal is to drill or deepen directionally, give pertinent data on subsurface locations and measured and true vertical depths. Give blowout prevention program, if any.

24.

SIGNED

Manager of

Drilling and Production

TITLE

(This space for Federal or State office use)

PERMIT NO.

APPROVAL DATE

Application approval does not warrant or certify that the applicant holds legal or equitable title to those rights in the subject lease which would entitle the applicant to conduct operations thereon.

CONDITIONS OF APPROVAL, IF ANY:

APPROVED BY

TITLE

DATE

*See Instructions On Reverse Side

Title 18 U.S.C. Section 1001, makes it a crime for any person knowingly and willfully to make to any department or agency of the United States any false, fictitious or fraudulent statements or representations as to any matter within its jurisdiction.

DISTRICT I
P.O. Box 1980, Hobbs, NM 88241-1980

State of New Mexico
Energy, Minerals and Natural Resources Department

Form C-102
Revised February 10, 1994
Submit to Appropriate District Office
State Lease - 4 Copies
Fee Lease - 3 Copies

DISTRICT II
P.O. Drawer DD, Artesia, NM 88211-0719

DISTRICT III
1000 Rio Brazos Rd., Aztec, NM 87410

DISTRICT IV
P.O. BOX 2088, SANTA FE, N.M. 87504-2088

OIL CONSERVATION DIVISION

P.O. Box 2088
Santa Fe, New Mexico 87504-2088

☐ AMENDED REPORT

WELL LOCATION AND ACREAGE DEDICATION PLAT

API Number 30-025-34115	Pool Code 21650	Pool Name EK Buffalo Bone Spring, SE
Property Code 21478	Property Name BUFFALO "6" FEDERAL	Well Number 1
OGRID No. 15742	Operator Name NEARBURG PRODUCING COMPANY	Elevation 3811

Surface Location

UL or lot No.	Section	Township	Range	Lot Idn	Feet from the	North/South line	Feet from the	East/West line	County
LOT 4	6	19 S	34 E		660	NORTH	660	WEST	LEA

Bottom Hole Location If Different From Surface

UL or lot No.	Section	Township	Range	Lot Idn	Feet from the	North/South line	Feet from the	East/West line	County
Dedicated Acres 88.57	Joint or Infill	Consolidation Code	Order No.						

NO ALLOWABLE WILL BE ASSIGNED TO THIS COMPLETION UNTIL ALL INTERESTS HAVE BEEN CONSOLIDATED
OR A NON-STANDARD UNIT HAS BEEN APPROVED BY THE DIVISION

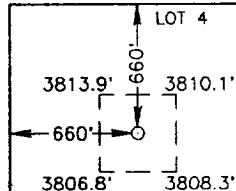
	LOT 3	LOT 2	LOT 1
43.27 ACRES LOT 5	45.30 ACRES	45.16 ACRES	45.03 ACRES
38.06 ACRES LOT 6			
38.02 ACRES LOT 7			
37.98 ACRES			

OPERATOR CERTIFICATION

I hereby certify the the information contained herein is true and complete to the best of my knowledge and belief.

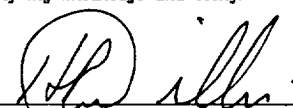

Signature
H. R. Willis
Printed Name
Drlg. Supt.
Title
July 15, 1997
Date

SURVEYOR CERTIFICATION

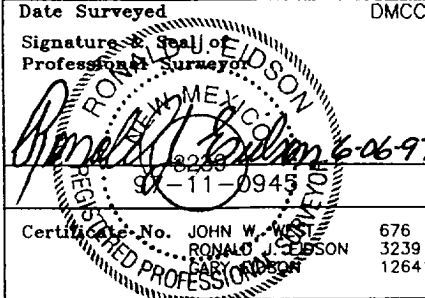
I hereby certify that the well location shown on this plat was plotted from field notes of actual surveys made by me or under my supervision, and that the same is true and correct to the best of my belief.

JUNE 4, 1997
Date Surveyed
Signature of Professional Surveyor

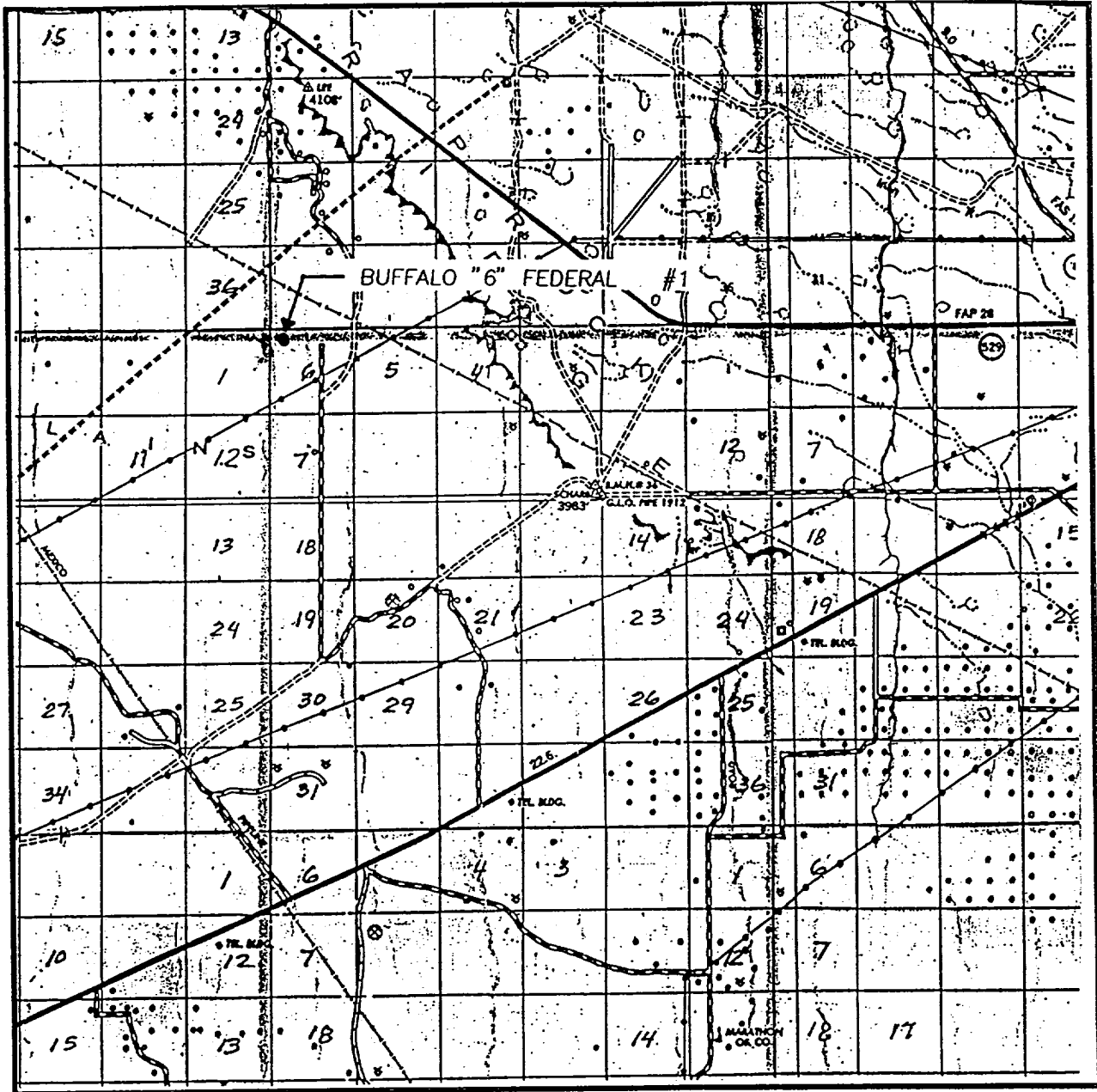
Certificate No. JOHN W. WEST 676
RONALD W. ELLISON 3239
GARY ANDERSON 12641

VICINITY MA^D



SCALE: 1" = 2 MILES

SEC. 6 TWP. 19-S RGE. 34-E

SURVEY N.M.P.M.

COUNTY LEA

DESCRIPTION 660' FNL & 660' FWL

ELEVATION 3811

OPERATOR NEARBURG PRODUCING COMPANY

LEASE BUFFALO "6" FEDERAL

JOHN WEST ENGINEERING
HOBBS, NEW MEXICO
(505) 393-3117

EXHIBIT "C"

SUPPLEMENTAL DRILLING DATA
NEARBURG PRODUCING COMPANY
BUFFALO "6" FEDERAL #1

1. SURFACE FORMATION:

Sand Dunes

2. ESTIMATED TOPS OF GEOLOGIC MARKERS: (Get from Geo. dept.)

T/Rustler	1,600'	T/Bone Spring	7,745'
T/Yates	3,250'	T/Bone Spring Sd.	8,950'
T/Queen	4,400'	T/2nd Bone Spring	9,280'
T/Delaware	5,680'	T/2nd Bone Spring Sd.	9,530'

3. ANTICIPATED POSSIBLE HYDROCARBON BEARING ZONES:

2nd Bone Spring Carb.

2nd Bone Spring Sd.

4. CASING AND CEMENTING PROGRAM:

<u>Casing Size</u>	<u>Setting Depth</u>		<u>Weight</u>	<u>Grade</u>	<u>Joint</u>
	<u>From</u>	<u>To</u>			
13-3/8"	0	350'	48#	H-40	ST&C
8-5/8"	0	2,000'	24#	J-55	LT&C
8-5/8"	2,000'	3,900'	32#	J-55	LT&C
5-1/2"	0	3,000'	17#	N-80	LT&C
5-1/2"	3,000'	7,000'	17#	K-55	LT&C
5-1/2"	7,000'	9,800'	17#	N-80	LT&C

We plan to drill a 17-1/2" hole to equal 350'. 13-3/8" casing will be cemented with 500 sx or volume to tie back to surface.

8-5/8" casing will be cemented with 1,200 sx or volume necessary to circulate to surface.

5-1/2" production casing will be cemented with 600 sx of Class "H" 50/50 POZ. TOC 7,000'.

5. PRESSURE CONTROL EQUIPMENT:

The BOP stack will consist of a 3,000 psi working pressure, dual ram type preventer and annular.

A BOP sketch is attached.

6. CIRCULATING MEDIUM:

Surface to 9,800':

Spud drill to 350' with fresh water mud, wt 8.4 to 9.0 ppg and viscosity 30 to 34. Drill intermediate hole from 350' to 3,900' with brine water, 10 ppg, viscosity 28 to 30. Below 3,900' to TD with cut brine, wt. 8.7 to 9.1 ppg and viscosity 28 to 34.

7. AUXILIARY EQUIPMENT:

None required.

8. TESTING, LOGGING AND CORING PROGRAM:

DLL/LDT/CNL/GR/CAL log is planned. Drill stem tests, cores and sidewall cores possible.

9. ABNORMAL PRESSURES, TEMPERATURES OR HYDROGEN SULFIDE GAS:

None anticipated. Maximum bottom hole psi is estimated to be 2,000 psi.

10. ANTICIPATED STARTING DATE:

It is planned that operations will commence on September 15, 1997, with drilling and completion operations lasting about 45 days.

BOPE SCHEMATIC NEARBURG PRODUCING COMPANY

Rotating Head (Optional)
Drilling Nipple option
must include a fill-up
line. Do not use kill line
for fill up.

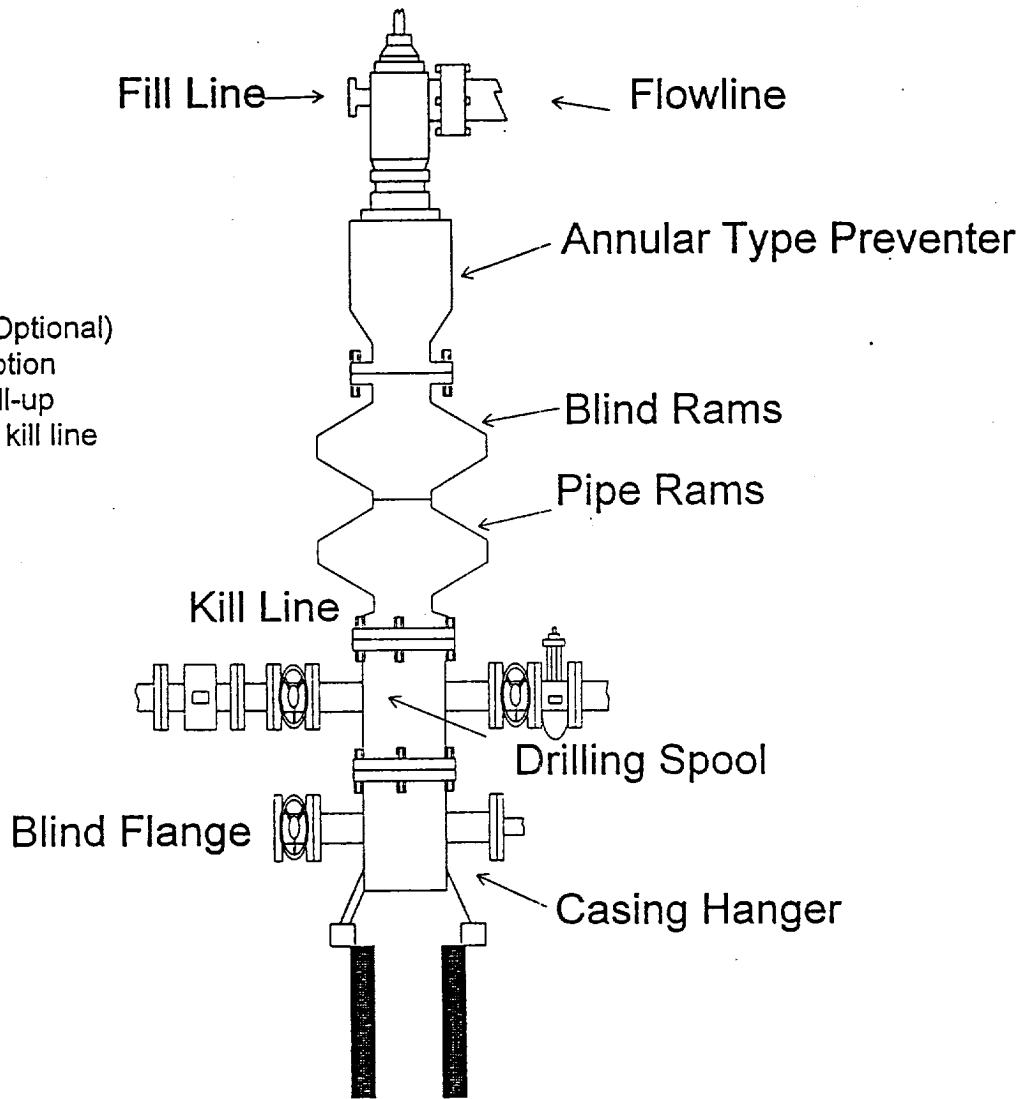

900 Series

BUFFALO "6" FEDERAL #1
660' FNL AND 660' FWL
SECTION 6, T19S, R34E
LEA COUNTY, NEW MEXICO