

UNITED STATES  
DEPARTMENT OF THE INTERIOR  
BUREAU OF LAND MANAGEMENT

## APPLICATION FOR PERMIT TO DRILL OR DEEPEN

## 1a. TYPE OF WORK

DRILL ☒DEEPEN ☐

## b. TYPE OF WELL

OIL  
WELL ☐GAS  
WELL ☒

OTHER

SINGLE  
ZONE ☐MULTIPLE  
ZONE ☒

## 2. NAME OF OPERATOR

Nearburg Producing Company

## 3. ADDRESS AND TELEPHONE NO.

3300 N. "A" St., Bldg. 2, Suite 120, Midland, TX 79705

## 4. LOCATION OF WELL (Report location clearly and in accordance with any State requirements.)\*

At surface

1,980' FNL &amp; 1,980' FWL

At proposed prod. zone

## 14. DISTANCE IN MILES AND DIRECTION FROM NEAREST TOWN OR POST OFFICE\*

15 1/2 miles SW of Buckeye

## 15. DISTANCE FROM PROPOSED\*

LOCATION TO NEAREST  
PROPERTY OR LEASE LINE, FT.  
(Also to nearest drg. unit line, if any)18. DISTANCE FROM PROPOSED LOCATION\*  
TO NEAREST WELL, DRILLING, COMPLETED,  
OR APPLIED FOR, ON THIS LEASE, FT.

## 16. NO. OF ACRES IN LEASE

320

## 19. PROPOSED DEPTH

13,500'

17. NO. OF ACRES ASSIGNED  
TO THIS WELL

320

## 20. ROTARY OR CABLE TOOLS

Rotary

## 21. ELEVATIONS (Show whether DF, RT, GR, etc.)

3,599' GR

SECRETARY'S POTASH

## 22. APPROX. DATE WORK WILL START\*

8/1/97

## 23.

## PROPOSED CASING AND CEMENTING PROGRAM

SIZE OF HOLE	GRADE, SIZE OF CASING	WEIGHT PER FOOT	SETTING DEPTH	QUANTITY OF CEMENT
17 1/2"	13-3/8" H-40	48#	350' 500'	375 sx.
11" K-55 580H	8-5/8" J-55	24# & 32#	5,200'	2,400 sx.
7-7/8"	5-1/2" N-80	17# & 20#	13,600'	3,200 sx.

13,500'

CAPITAN CONTROLLED WATER BASIN

Propose to drill the well to sufficient depth to evaluate the Morrow formation.  
After reaching TD, logs will be run and casing set if the evaluation is positive.  
Perforate, test and stimulate as necessary to establish production.

OPER. GRID NO. 15742

PROPERTY NO. 21509

POOL CODE 77370

EFF. DATE 9/2/97

API NO. 30-025-34121

APPROVAL SUBJECT TO  
GENERAL REQUIREMENTS AND  
SPECIAL STIPULATIONS  
ATTACHEDacc  
7/14/97

IN ABOVE SPACE DESCRIBE PROPOSED PROGRAM: If proposal is to deepen, give data on present productive zone and proposed new productive zone. If proposal is to drill or deepen directionally, give pertinent data on subsurface locations and measured and true vertical depths. Give blowout preventer program, if any.

## 24.

SIGNATURE

TITLE

Manager, Drilling and  
Production

DATE

May 30, 1997

(This space for Federal or State office use)

PERMIT NO.

APPROVAL DATE

Application approval does not warrant or certify that the applicant holds legal or equitable title to those rights in the subject lease which would entitle the applicant to conduct operations thereon.  
CONDITIONS OF APPROVAL, IF ANY:

APPROVED BY Richard A. Whiney TITLE Acting State Director DATE 7-21-97

\*See Instructions On Reverse Side

Topographic map of the Cobra 28 Federal #1 area. The map shows contour lines and elevation points. Key features include:

- COBRA 28 FEDERAL #1**: Labeled in the upper left quadrant.
- ACCESS ROAD**: A dashed line labeled **2138** running diagonally across the center.
- AQUEDUCT**: Labeled in two locations, one near the center and one near the bottom left.
- PIPELINE**: Labeled near the bottom right.
- Drill Hole**: Multiple locations marked with dots and labeled.
- Elevation Points**: Various numbers indicating elevation, including 3609, 3611, 3628, 3632, 3576, 3565, 3550, 3563, 3574, 3365, and 2138.
- Lagoa Tafo (600)**: A large shaded area at the bottom center.
- Grid**: A coordinate grid with labels 20, 21, 22, 27, 28, 29, 32, and 34.

CONTOUR INTERVAL:  
LUGUNA GATUNA - 10'  
LUGUNA GATUNA NW - 10'

LAGUNA GATUNA, LAGUNA GATUNA NW, N.M.

**JOHN WEST ENGINEERING  
HOBBS, NEW MEXICO  
(505) 393-3117**

DISTRICT I  
P.O. Box 1980, Hobbs, NM 88241-1980

State of New Mexico  
Energy, Minerals and Natural Resources Department

Form C-102  
Revised February 10, 1994  
Submit to Appropriate District Office  
State Lease - 4 Copies  
Fee Lease - 3 Copies

DISTRICT II  
P.O. Drawer DD, Artesia, NM 88211-0719

DISTRICT III  
1000 Rio Brazos Rd., Aztec, NM 87410

DISTRICT IV  
P.O. BOX 2088, SANTA FE, N.M. 87504-2088

## OIL CONSERVATION DIVISION

P.O. Box 2088  
Santa Fe, New Mexico 87504-2088

☐ AMENDED REPORT

### WELL LOCATION AND ACREAGE DEDICATION PLAT

API Number <b>30-025-34121</b>	Pool Code <b>7737D</b>	Pool Name <b>Gem - Wildcat - Morrow</b>
Property Code <b>21509</b>	Property Name <b>Maduro</b> <del>COBRA 28 FEDERAL</del> <b>Federal Unit</b>	Well Number <b>+5</b>
OGRID No. <b>15742</b>	Operator Name <b>NEARBURG PRODUCING COMPANY</b>	Elevation <b>3599</b>

#### Surface Location

UL or lot No. <b>F</b>	Section <b>28</b>	Township <b>19 S</b>	Range <b>33 E</b>	Lot Idn	Feet from the <b>1980</b>	North/South line <b>NORTH</b>	Feet from the <b>1980</b>	East/West line <b>WEST</b>	County <b>LEA</b>
---------------------------	----------------------	-------------------------	----------------------	---------	------------------------------	----------------------------------	------------------------------	-------------------------------	----------------------

#### Bottom Hole Location If Different From Surface

UL or lot No.	Section	Township	Range	Lot Idn	Feet from the	North/South line	Feet from the	East/West line	County
Dedicated Acres <b>320</b>	Joint or Infill <b>N</b>	Consolidation Code	Order No.						

NO ALLOWABLE WILL BE ASSIGNED TO THIS COMPLETION UNTIL ALL INTERESTS HAVE BEEN CONSOLIDATED  
OR A NON-STANDARD UNIT HAS BEEN APPROVED BY THE DIVISION

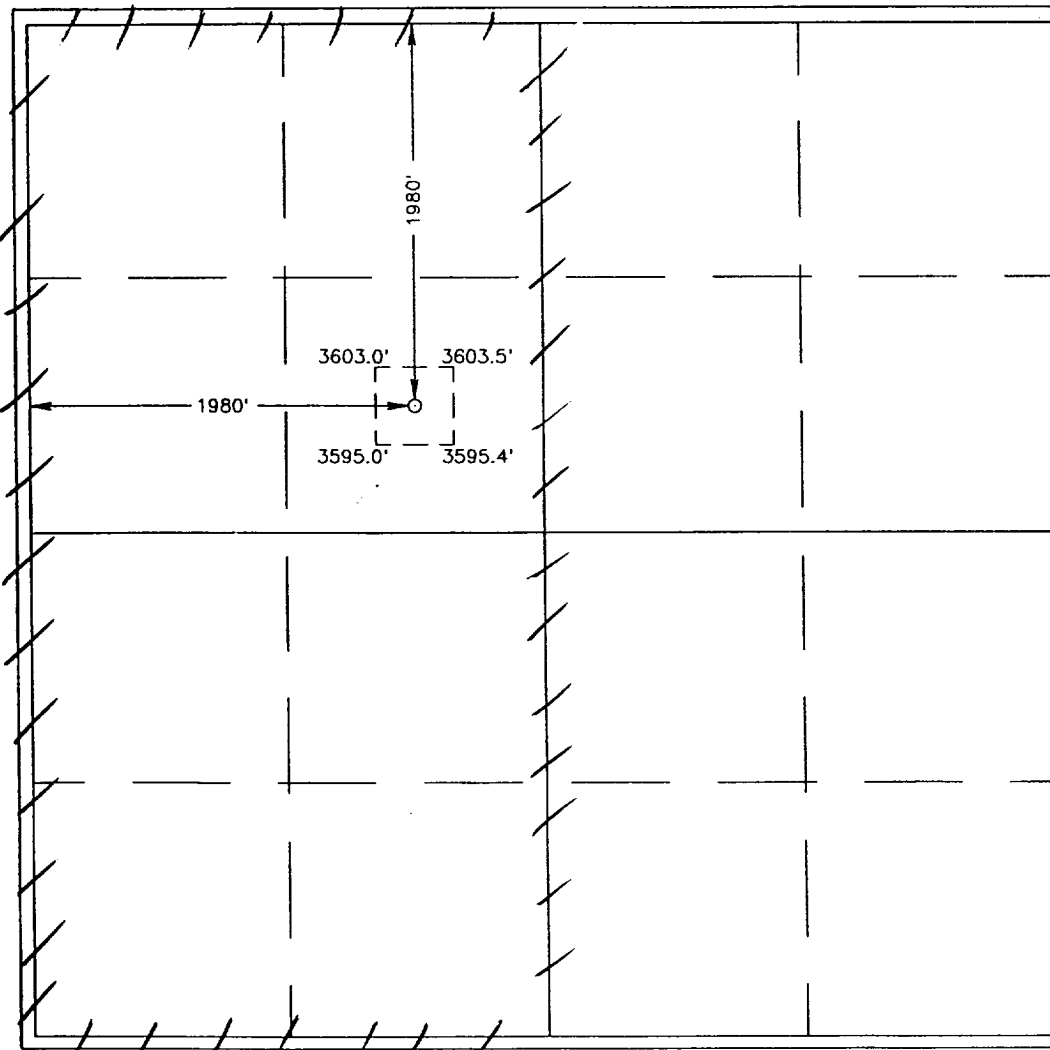

#### OPERATOR CERTIFICATION

I hereby certify the information contained herein is true and complete to the best of my knowledge and belief.

*E. Scott Kimbrough*  
Signature  
E. Scott Kimbrough  
Printed Name  
Mgr. of Drlg & Prod.  
Title  
May 12, 1997  
Date

#### SURVEYOR CERTIFICATION

I hereby certify that the well location shown on this plat was plotted from field notes of actual surveys made by me or under my supervision, and that the same is true and correct to the best of my belief.

MARCH 27, 1997

Date Surveyed  
Signature & Seal of Professional Surveyor  
Professional Surveyor  
DMCC  
Certificate No. JOHN W. WEST 676  
RONALD J. EIDSON 3239  
PROFESSIONAL SURVEYOR EIDSON 12641

**SUPPLEMENTAL DRILLING DATA  
NEARBURG PRODUCING COMPANY  
MADURO FEDERAL UNIT #5**

- Revised well ~~name~~ name
- Revised casing design (int.)

acc

7/14/97

**1. SURFACE FORMATION:**

Red Beds

**2. ESTIMATED TOPS OF GEOLOGIC MARKERS:**

T/Delaware	5,150'
T/Bone Spring	7,870'
T/Wolfcamp	10,945'
T/Stawn	12,100'
T/Atoka	12,480'
T/Morrow	12,730'

**3. ANTICIPATED POSSIBLE HYDROCARBON BEARING ZONES:**

Morrow

**4. CASING AND CEMENTING PROGRAM:**

Casing Size	Setting Depth From To	Weight	Grade	1) Joint
13-3/8"	0 - 500'	48#	<del>S-55</del> H-40	ST&C
8-5/8"	0 - 2,000'	24#	K-55	ST&C
	2,000 - 4,400' 4000'	32#	K-55	ST&C
	4,400' - 5,200' per Buick Willis	32#	S-80HC HCK-55*	ST&C
5-1/2"	0 - 4,200'	20#	N80	LT&C
	4,200' - 8,400'	17#	N80	LT&C
	8,400' - 13,500'	20#	N80	LT&C

1) AS SHOWN ON  
FORM 3160-3.

\* S-80 GRADE HAS BEEN CHANGED TO HIGH COLLAPSE K-55 (HCK-55), NO CHANGES IN PERFORMANCE EQUIVALENT OR ADEQUATE GRADES AND WEIGHTS OF CASING MAY BE SUBSTITUTED AT TIME CASING IS RUN, DEPEND ON AVAILABILITY. PROPERTIES, LONE STAR, 2<sup>ST</sup> ED.

We plan to drill a 17-1/2" hole to equal 500'. 13-3/8" casing will be cemented with 500 sx or volume necessary to tie back to surface.

8-5/8" casing will be cemented with 2,300 sx of 35/65 Poz "C" or volume based on fluid caliper necessary to tie back to surface.

5-1/2" production casing will be cemented with 1,500 sx of 50/50 and 35/65 Poz "H" cement or volume necessary to tie back to 8-5/8" casing.

**5. PRESSURE CONTROL EQUIPMENT:**

The BOP stack will consist of a 5,000 psi working pressure, dual ram type preventer and annular.

A BOP sketch is attached.

**6. CIRCULATING MEDIUM:**

**Surface to 13,500':**

Spud and drill to 500' with fresh water mud for surface string. The intermediate section will be drilled with 10 ppg brine to 5,200'. The production section from 5,200' to 10,800' will be fresh water at 8.4 ppg, from 10,800' to 12,400' with 9 ppg cut brine, from 12,400' to 13,500' with a Brine/Poly Pac/XCD system with 9.5 ppg mud weight.

**7. AUXILIARY EQUIPMENT:**

None required.

**8. TESTING, LOGGING AND CORING PROGRAM:**

DLL/CNL/LDT/Cal/GR is planned, drill stem tests, cores and sidewall cores possible.

**9. ABNORMAL PRESSURES, TEMPERATURES OR HYDROGEN SULFIDE GAS:**

None anticipated. Expected maximum SBHP is estimated to be 5,000 psi.

**10. ANTICIPATED STARTING DATE:**

It is planned that operations will commence on August 1, 1997, with drilling and completion operations lasting about 45 days.

# BOPE SCHEMATIC NEARBURG PRODUCING COMPANY

Rotating Head (Optional)  
Drilling Nipple option  
must include a fill-up  
line. Do not use kill line  
for fill up.

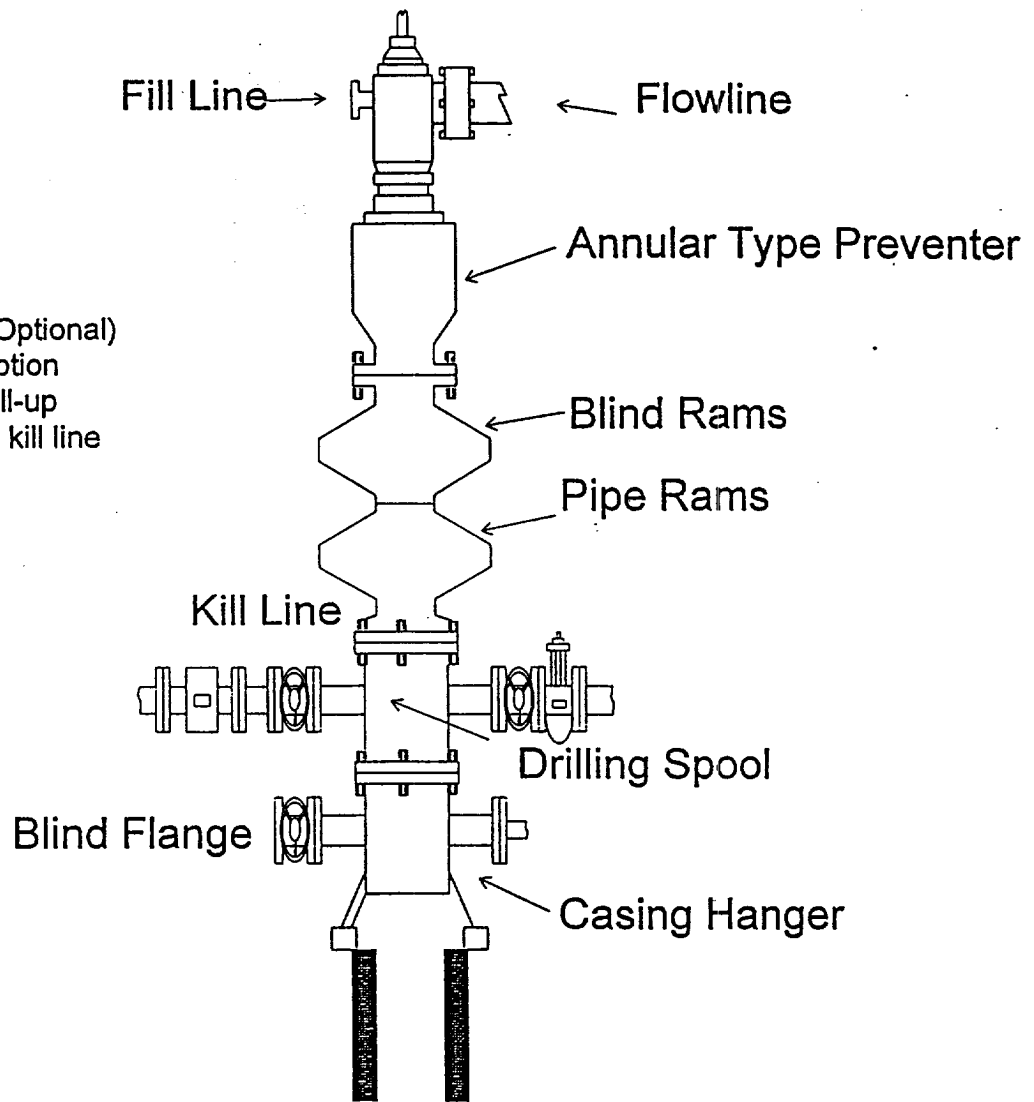

900 Series

800/4

**EL**  
L-1000