

District I
PO Box 1980, Hobbs, NM 88241-1980
District II
PO Drawer DD, Artesia, NM 88211-0719
District III
1000 Rio Brazos Rd., Aztec, NM 87410
District IV
PO Box 2088, Santa Fe, NM 87504-2088

State of New Mexico
Energy, Minerals & Natural Resources Department

OIL CONSERVATION DIVISION
PO Box 2088
Santa Fe, NM 87504-2088

Form C-101
Revised February 10, 1994
Instructions on back
Submit to Appropriate District Office
State Lease - 6 Copies
Fee Lease - 5 Copies

☐ AMENDED REPORT

APPLICATION FOR PERMIT TO DRILL, RE-ENTER, DEEPEN, PLUGBACK, OR ADD A ZONE

¹ Operator Name and Address. Altura Energy LTD P.O. Box 4294 Houston, Texas 77210-4294		² OGRID Number 157984
		³ API Number 30-025-34229
⁴ Property Code 20807	⁵ Property Name Hoover 28	⁶ Well No. 5

⁷ Surface Location

UL or lot no.	Section	Township	Range	Lot Idn	Feet from the	North/South line	Feet from the	East/West line	County
N	28	17-S	35-E		554	South	1707	West	Lea

⁸ Proposed Bottom Hole Location If Different From Surface

UL or lot no.	Section	Township	Range	Lot Idn	Feet from the	North/South line	Feet from the	East/West line	County
⁹ Proposed Pool 1 East Vacuum Drinkard					¹⁰ Proposed Pool 2 East Vacuum Blinebry				

¹¹ Work Type Code N	¹² Well Type Code O	¹³ Cable/Rotary R	¹⁴ Lease Type Code S	¹⁵ Ground Level Elevation 3948'
¹⁶ Multiple N	¹⁷ Proposed Depth 8200'	¹⁸ Formation Drinkard/Blinebry	¹⁹ Contractor Norton	²⁰ Spud Date January 1998

²¹ Proposed Casing and Cement Program

Hole Size	Casing Size	Casing weight/foot	Setting Depth	Sacks of Cement	Estimated TOC
24"	20"	Conductor	40'	50 sx.	Surface
12-1/4"	8-5/8"	24	1725'	1050 sx.	Surface
7-7/8"	5-1/2"	17	8200'	4500 sx.	3300' from surface

²² Describe the proposed program. If this application is to DEEPEN or PLUG BACK give the data on the present productive zone and proposed new productive zone. Describe the blowout prevention program, if any. Use additional sheets if necessary.

See attached for proposed drilling program

BOP Program 3000# Ram Preventer

Permit Expires 1 Year From
Date Unless Drilling Underway

²³ I hereby certify that the information given above is true and complete to the best of my knowledge and belief.

Signature:

Mark Stephens

Printed name:

Mark Stephens

Title:

Business Analyst (SG)

Date:

12/5/97

Phone:

(281) 552-1158

OIL CONSERVATION DIVISION

Approved by:

ORIGINAL SIGNED BY CHRIS WILLIAMS

Title:

DISTRICT I SUPERVISOR

Approval Date:

DEC 10 1997

Expiration Date:

Conditions of Approval:

Attached ☐

C-101 Instructions

Measurements and dimensions are to be in feet/inches. Well locations will refer to the New Mexico Principal Meridian.

IF THIS IS AN AMENDED REPORT CHECK THE BOX LABELED "AMENDED REPORT" AT THE TOP OF THIS DOCUMENT.

- | | | | | | | | | | | | | | | | | | | | | | | | | | | | | | | | | | | | | | | | | | | | |
|-------------------------------------------------------------------------------------------------------------------------------------------------------------------------------------------------------------------------------------------------------------------------------------------------------------------------------------------------------------------------------------------------------------------------------------------------------------------------------------------------------------------------------------------------------------------------------------------------------------------------------------------------------------------------------------------------------------------------------------------------------------------------------------------------------------------------------------------------------------------------------------------------------------------------------------------------------------------------------------------------------------------------------------------------------------------------------------------------------------------------------------------------------------------------------------------------------------------------------------------------------------------------------------------------------------------------------------------------------------------------------------------------------------------------------------------------------------------------------------------------------------------------------------------------------------------------------------------------------------------------------------------------------------------------------------------------------------------------------------------------------------------------------------------------------------------------------------------------------------------------------------------------------------------------------------------------------------------------------------------------------------------------------------------------------------------------------------------------------------------------------------------------------------------------------------------------------------------------------------------------------|-----------------------------|----------|---|----------|---|--------------|---|----------|---|------------|---|-----------------------|---|-----------------------|---|---------------------|---|----------------|---|----------|---|-------------------|---|---------------------|---|-----------------------------|---|-------------------------|---|---------|---|-------|---|---------|---|--------|---|-----------|---|-----|---|--------------------|------------------------------------------------------------------------------------------------------------------------------------------------------------------------------------------------------------------------------------------------------------------------------------------------------------------------------------------------------------------------------------------------------------------------------------------------------------------------------------------------------------------------------------------------------------------------------------------------------------------------------------------------------------------------|
| <p>1 Operator's OGRID number. If you do not have one it will be assigned and filled in by the District office.</p> <p>2 Operator's name and address</p> <p>3 API number of this well. If this is a new drill the OCD will assign the number and fill this in.</p> <p>4 Property code. If this is a new property the OCD will assign the number and fill it in.</p> <p>5 Property name that used to be called 'well name'</p> <p>6 The number of this well on the property.</p> <p>7 The surveyed location of this well New Mexico Principal Meridian NOTE: If the United States government survey designates a Lot Number for this location use that number in the 'UL or lot no.' box. Otherwise use the OCD Unit Letter.</p> <p>8 The proposed bottom hole location of this well at TD</p> <p>9 and 10 The proposed pool(s) to which this well is being drilled.</p> <p>11 Work type code from the following table:</p> <table border="0"> <tr><td>N</td><td>New well</td></tr> <tr><td>E</td><td>Re-entry</td></tr> <tr><td>D</td><td>Drill deeper</td></tr> <tr><td>P</td><td>Plugback</td></tr> <tr><td>A</td><td>Add a zone</td></tr> </table> <p>12 Well type code from the following table:</p> <table border="0"> <tr><td>O</td><td>Single oil completion</td></tr> <tr><td>G</td><td>Single gas completion</td></tr> <tr><td>M</td><td>Multiple completion</td></tr> <tr><td>I</td><td>Injection well</td></tr> <tr><td>S</td><td>SWD well</td></tr> <tr><td>W</td><td>Water supply well</td></tr> <tr><td>C</td><td>Carbon dioxide well</td></tr> </table> <p>13 Cable or rotary drilling code</p> <table border="0"> <tr><td>C</td><td>Propose to cable tool drill</td></tr> <tr><td>R</td><td>Propose to rotary drill</td></tr> </table> <p>14 Lease type code from the following table:</p> <table border="0"> <tr><td>F</td><td>Federal</td></tr> <tr><td>S</td><td>State</td></tr> <tr><td>P</td><td>Private</td></tr> <tr><td>N</td><td>Navajo</td></tr> <tr><td>J</td><td>Jicarilla</td></tr> <tr><td>U</td><td>Ute</td></tr> <tr><td>I</td><td>Other Indian tribe</td></tr> </table> <p>15 Ground level elevation above sea level</p> <p>16 Intend to multiple complete? Yes or No</p> <p>17 Proposed total depth of this well</p> | N | New well | E | Re-entry | D | Drill deeper | P | Plugback | A | Add a zone | O | Single oil completion | G | Single gas completion | M | Multiple completion | I | Injection well | S | SWD well | W | Water supply well | C | Carbon dioxide well | C | Propose to cable tool drill | R | Propose to rotary drill | F | Federal | S | State | P | Private | N | Navajo | J | Jicarilla | U | Ute | I | Other Indian tribe | <p>18 Geologic formation at TD</p> <p>19 Name of the intended drilling company if known.</p> <p>20 Anticipated spud date.</p> <p>21 Proposed hole size ID inches, proposed casing OD inches, casing weight in pounds per foot, setting depth of the casing or depth and top of liner, proposed cementing volume, and estimated top of cement</p> <p>22 Brief description of the proposed drilling program and BOP program. Attach additional sheets if necessary.</p> <p>23 The signature, printed name, and title of the person authorized to make this report. The date this report was signed and the telephone number to call for questions about this report.</p> |
| N | New well | | | | | | | | | | | | | | | | | | | | | | | | | | | | | | | | | | | | | | | | | | |
| E | Re-entry | | | | | | | | | | | | | | | | | | | | | | | | | | | | | | | | | | | | | | | | | | |
| D | Drill deeper | | | | | | | | | | | | | | | | | | | | | | | | | | | | | | | | | | | | | | | | | | |
| P | Plugback | | | | | | | | | | | | | | | | | | | | | | | | | | | | | | | | | | | | | | | | | | |
| A | Add a zone | | | | | | | | | | | | | | | | | | | | | | | | | | | | | | | | | | | | | | | | | | |
| O | Single oil completion | | | | | | | | | | | | | | | | | | | | | | | | | | | | | | | | | | | | | | | | | | |
| G | Single gas completion | | | | | | | | | | | | | | | | | | | | | | | | | | | | | | | | | | | | | | | | | | |
| M | Multiple completion | | | | | | | | | | | | | | | | | | | | | | | | | | | | | | | | | | | | | | | | | | |
| I | Injection well | | | | | | | | | | | | | | | | | | | | | | | | | | | | | | | | | | | | | | | | | | |
| S | SWD well | | | | | | | | | | | | | | | | | | | | | | | | | | | | | | | | | | | | | | | | | | |
| W | Water supply well | | | | | | | | | | | | | | | | | | | | | | | | | | | | | | | | | | | | | | | | | | |
| C | Carbon dioxide well | | | | | | | | | | | | | | | | | | | | | | | | | | | | | | | | | | | | | | | | | | |
| C | Propose to cable tool drill | | | | | | | | | | | | | | | | | | | | | | | | | | | | | | | | | | | | | | | | | | |
| R | Propose to rotary drill | | | | | | | | | | | | | | | | | | | | | | | | | | | | | | | | | | | | | | | | | | |
| F | Federal | | | | | | | | | | | | | | | | | | | | | | | | | | | | | | | | | | | | | | | | | | |
| S | State | | | | | | | | | | | | | | | | | | | | | | | | | | | | | | | | | | | | | | | | | | |
| P | Private | | | | | | | | | | | | | | | | | | | | | | | | | | | | | | | | | | | | | | | | | | |
| N | Navajo | | | | | | | | | | | | | | | | | | | | | | | | | | | | | | | | | | | | | | | | | | |
| J | Jicarilla | | | | | | | | | | | | | | | | | | | | | | | | | | | | | | | | | | | | | | | | | | |
| U | Ute | | | | | | | | | | | | | | | | | | | | | | | | | | | | | | | | | | | | | | | | | | |
| I | Other Indian tribe | | | | | | | | | | | | | | | | | | | | | | | | | | | | | | | | | | | | | | | | | | |

Proposed Drilling Program
Hoover 28 Well No. 5
Lea County, New Mexico

20" Conductor should be set at 40' before moving on location. A 12-1/4" hole will be drilled from surface to approximately 1725' or 25' into the Rustler, whichever is deeper. A full string of 8-5/8", 24#, J-55 surface casing will be run to approximately 1725' with cement circulated to surface. After casing is run and cemented, weld on wellhead. Wait on cement for 12 hours and test casing to 1000 psi and the BOPs to their rating prior to drilling out.

A 7-7/8" hole will be drilled out from surface casing point (approx. 1725') to a total depth of 8200'. A full string of 5-1/2", 17# , K-55 casing will be run to TD. The casing will be cemented in two stages with TOC calculated to 3300' from surface.

DISTRICT I
P.O. Box 1980, Hobbs, NM 88241-1980

DISTRICT II
P.O. Drawer DD, Artesia, NM 88211-0719

DISTRICT III
1000 Rio Brazos Rd., Aztec, NM 87410

DISTRICT IV
P.O. BOX 2088, SANTA FE, N.M. 87504-2088

State of New Mexico
Energy, Minerals and Natural Resources Department

Form C-102
Revised February 10, 1994
Submit to Appropriate District Office
State Lease - 4 Copies
Fee Lease - 3 Copies

OIL CONSERVATION DIVISION

P.O. Box 2088
Santa Fe, New Mexico 87504-2088

☐ AMENDED REPORT

WELL LOCATION AND ACREAGE DEDICATION PLAT

API Number 30-025-34229	Pool Code 96246	Pool Name East Vacuum Drinkard
Property Code 20807	Property Name HOOVER 28	Well Number 5
OGRID No. 157984	Operator Name ALTURA ENERGY LTD.	Elevation 3948'

Surface Location

UL or lot No.	Section	Township	Range	Lot Idn	Feet from the	North/South line	Feet from the	East/West line	County
N	28	17-S	35-E		554	SOUTH	1707	WEST	LEA

Bottom Hole Location If Different From Surface

UL or lot No.	Section	Township	Range	Lot Idn	Feet from the	North/South line	Feet from the	East/West line	County
Dedicated Acres 40	Joint or Infill	Consolidation Code	Order No.						

NO ALLOWABLE WILL BE ASSIGNED TO THIS COMPLETION UNTIL ALL INTERESTS HAVE BEEN CONSOLIDATED
OR A NON-STANDARD UNIT HAS BEEN APPROVED BY THE DIVISION

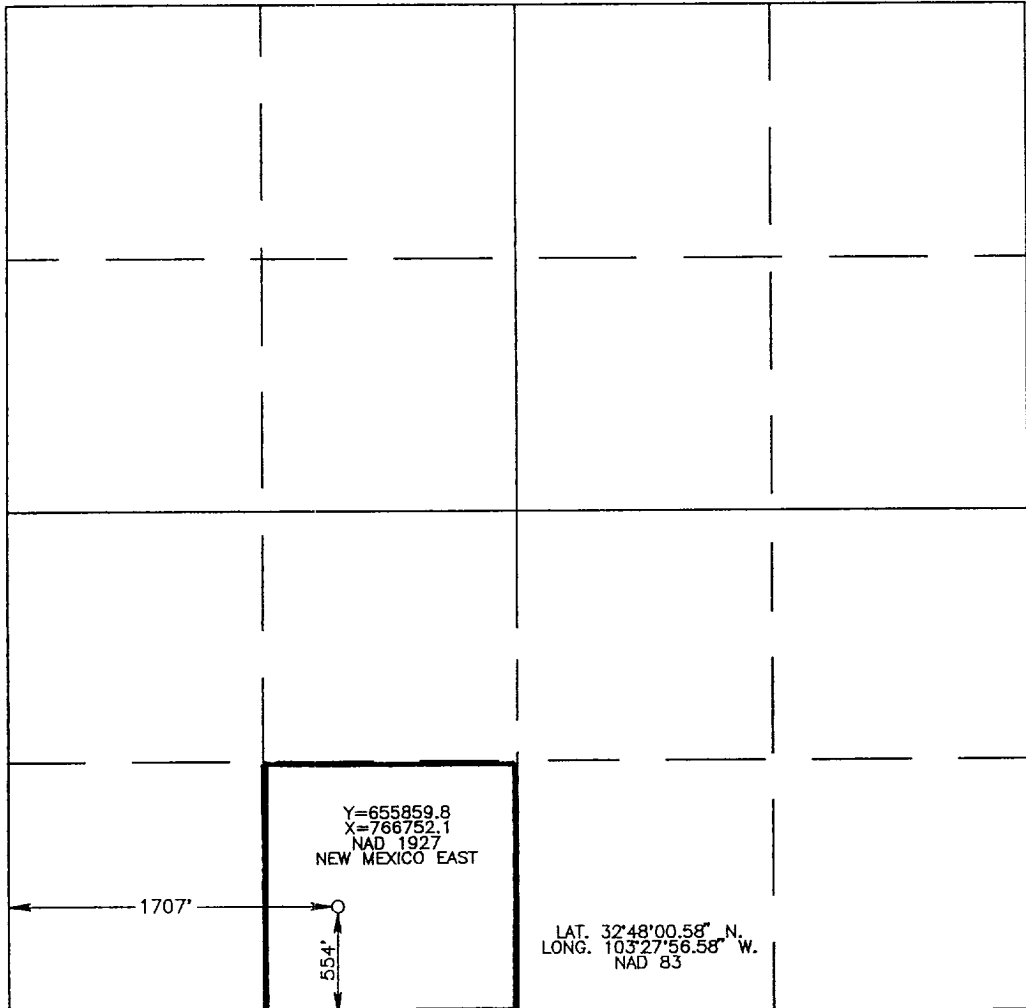
	OPERATOR CERTIFICATION I hereby certify the the information contained herein is true and complete to the best of my knowledge and belief. <u>Mark Stephens</u> Signature Mark Stephens Printed Name Business Analyst (SG) Title December 8, 1997 Date
	SURVEYOR CERTIFICATION I hereby certify that the well location shown on this plat was plotted from field notes of actual surveys made by me or under my supervision, and that the same is true and correct to the best of my belief. NOVEMBER 26, 1997 Date Surveyed Signature of Seal of Professional Surveyor RONALD Q. EDSON 3239 12-01-97 Certificate No. RONALD Q. EDSON 3239 12641

VICINITY MAP

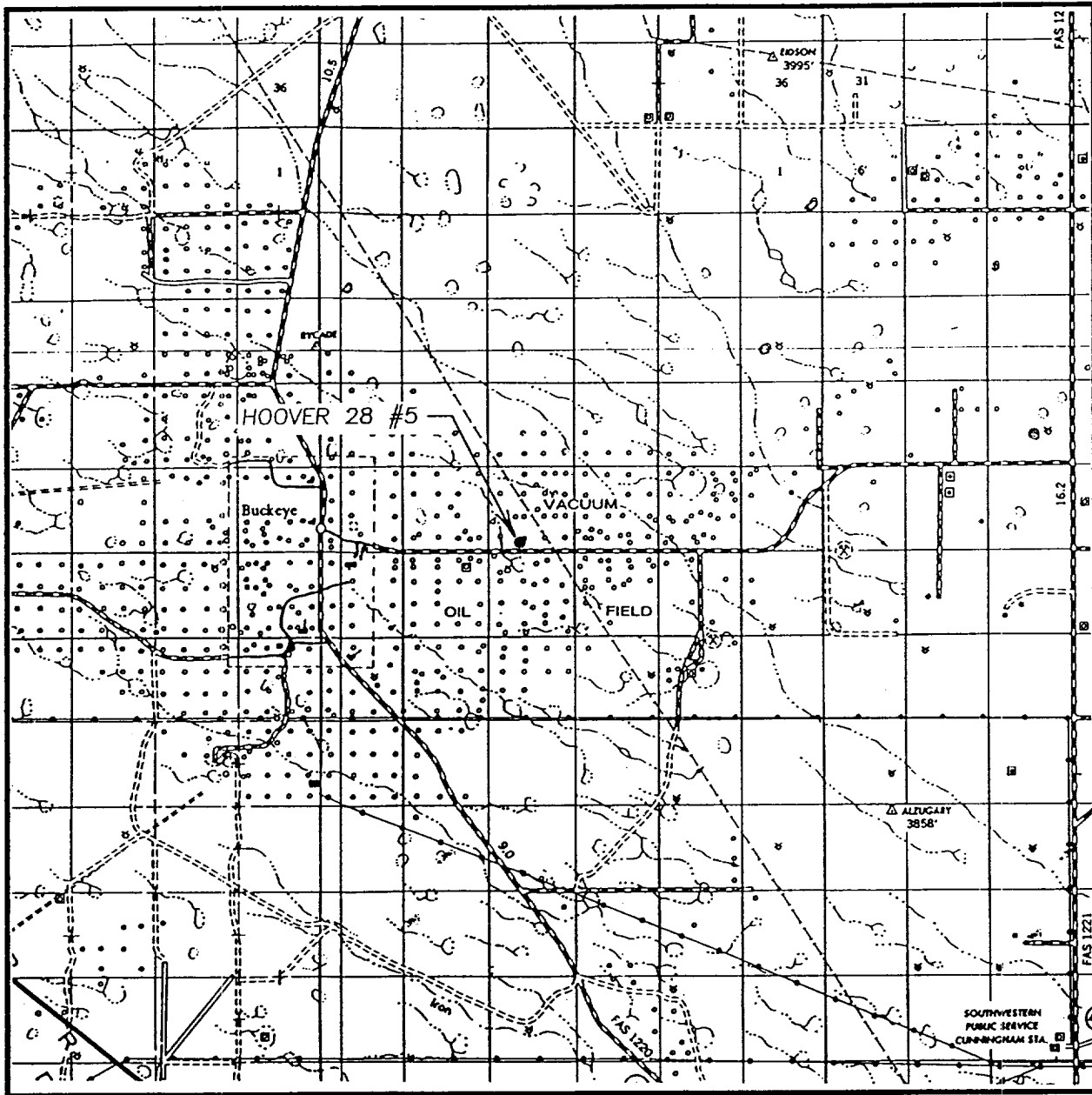

SCALE: 1" = 2 MILES

SEC. 28 TWP. 17-S RGE. 35-E

SURVEY N.M.P.M.

COUNTY LEA

DESCRIPTION 554' FSL & 1707' FWL

ELEVATION 3948'

OPERATOR ALTURA ENERGY LTD.

LEASE HOOVER 28

**JOHN WEST ENGINEERING
HOBBS, NEW MEXICO**

(505) 393-3117

LOCATION VERIFICATION MAP

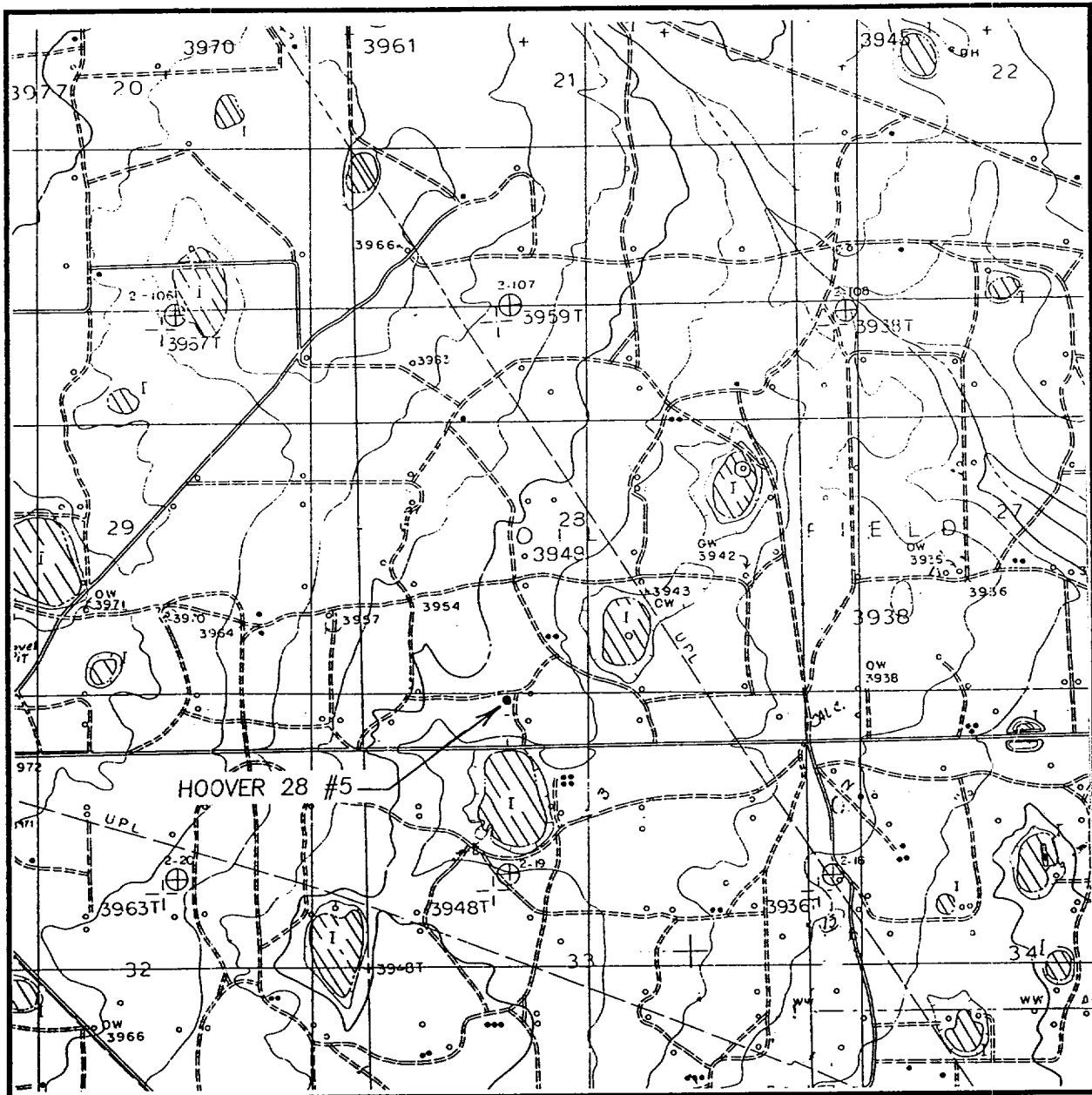

SCALE: 1" = 2000'

CONTOUR INTERVAL
LOVINGTON SW - 5'

SEC. 28 TWP. 17-S RGE. 35-E

SURVEY N.M.P.M.

COUNTY LEA

DESCRIPTION 554' FSL & 1707' FWL

ELEVATION 3948'

OPERATOR ALTURA ENERGY LTD.

LEASE HOOVER 28

U.S.G.S. TOPOGRAPHIC MAP

LOVINGTON SW, NM

JOHN WEST ENGINEERING

HOBBS, NEW MEXICO

(505) 393-3117