

DISTRICT I  
P.O. Box 1980, Hobbs, NM 88241-1980

DISTRICT II  
P.O. Drawer DD, Artesia, NM 88211-0719

DISTRICT III  
1000 Rio Brazos Rd., Aztec, NM 87410

DISTRICT IV  
P.O. BOX 2088, SANTA FE, N.M. 87504-2088

State of New Mexico  
Energy, Minerals and Natural Resources Department

Form C-102  
Revised February 10, 1994  
Submit to Appropriate District Office  
State Lease - 4 Copies  
Fee Lease - 3 Copies

OIL CONSERVATION DIVISION

P.O. Box 2088  
Santa Fe, New Mexico 87504-2088

☐ AMENDED REPORT

WELL LOCATION AND ACREAGE DEDICATION PLAT

API Number <b>30-025-34981</b>	Pool Code <del>06660</del> <b>97021</b>	Pool Name <b>Wildcat Blinebry</b>
Property Code <b>25506</b>	Property Name <b>BIMINI 13 STATE</b>	Well Number <b>1</b>
GRID No. <b>148111</b>	Operator Name <b>SOUTHWESTERN ENERGY PRODUCTION CO</b>	Elevation <b>3921</b>

Surface Location

UL or lot No. <b>E</b>	Section <b>13</b>	Township <b>17 S</b>	Range <b>35 E</b>	Lot Idn	Feet from the <b>2310</b>	North/South line <b>NORTH</b>	Feet from the <b>990</b>	East/West line <b>WEST</b>	County <b>LEA</b>
---------------------------	----------------------	-------------------------	----------------------	---------	------------------------------	----------------------------------	-----------------------------	-------------------------------	----------------------

Bottom Hole Location If Different From Surface

UL or lot No.	Section	Township	Range	Lot Idn	Feet from the	North/South line	Feet from the	East/West line	County
Dedicated Acres <b>40</b>	Joint or Infill	Consolidation Code	Order No.						

NO ALLOWABLE WILL BE ASSIGNED TO THIS COMPLETION UNTIL ALL INTERESTS HAVE BEEN CONSOLIDATED  
OR A NON-STANDARD UNIT HAS BEEN APPROVED BY THE DIVISION

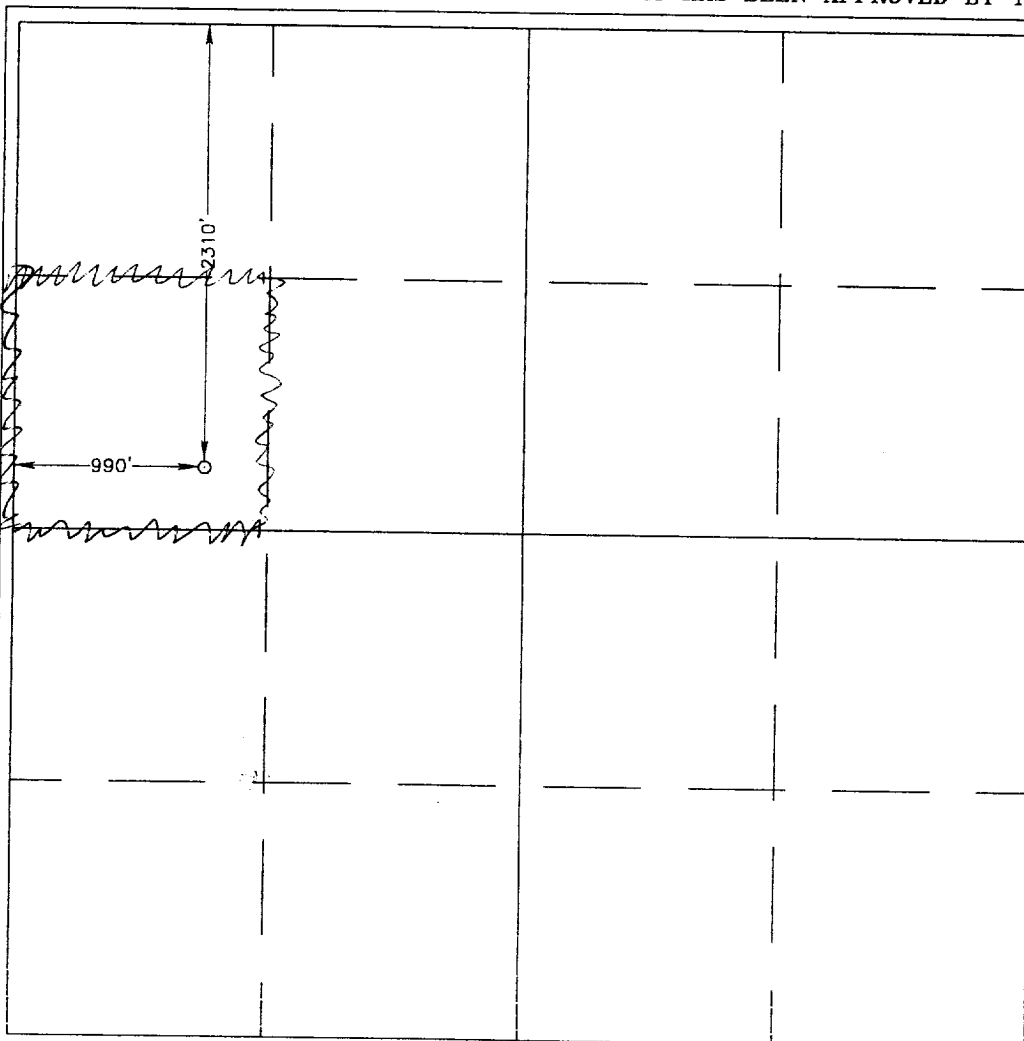

OPERATOR CERTIFICATION

I hereby certify the the information  
contained herein is true and complete to the  
best of my knowledge and belief.

Signature

**Cathy Rowan**  
Printed Name

**Drilling Technician**  
Title

**5/31/00**  
Date

SURVEYOR CERTIFICATION

I hereby certify that the well location shown  
on this plat was plotted from field notes of  
actual surveys made by me or under my  
supervision and that the same is true and  
correct to the best of my belief.

**MARCH 16, 2000**  
Date Surveyed

Signature & Seal of  
Professional Surveyor

**Ronald J. Edson** **3/17/2000**  
00-11-0358

Certificate No. **RONALD J. EDSON 3239**  
**GARY EDSON 12641**  
**MACON McDONALD 12185**