

UNITED STATES  
DEPARTMENT OF THE INTERIOR  
BUREAU OF LAND MANAGEMENT

APPLICATION FOR PERMIT TO DRILL OR DEEPEN

1a. TYPE OF WORK DRILL <input checked="" type="checkbox"/> DEEPEN <input type="checkbox"/>	5. LEASE DESIGNATION AND SERIAL NO. NMNM-40449
b. TYPE OF WELL OIL WELL <input checked="" type="checkbox"/> GAS WELL <input type="checkbox"/> OTHER <input type="checkbox"/> SINGLE ZONE <input checked="" type="checkbox"/> MULTIPLE ZONE <input type="checkbox"/>	6. IF INDIAN, ALLOTTEE OR TRIBE NAME
2. NAME OF OPERATOR HARVEY E. YATES COMPANY	7. UNIT AGREEMENT NAME BOLA 7 FED
3. ADDRESS AND TELEPHONE NO. P.O. BOX 1933, ROSWELL, NEW MEXICO 88202 505-623-6601	8. FARM OR LEASE NAME, WELL NO. 1
4. LOCATION OF WELL (REPORT LOCATION CLEARLY AND IN ACCORDANCE WITH ANY STATE REQUIREMENTS) AT SURFACE 330' FNL & 1,980' FEL AT PROPOSED PROD. ZONE SAME <b>B</b>	9. API WELL NO. <b>30-025-35056</b> 10. FIELD AND POOL, OR WILDCAT YOUNG BONE SPRINGS NORTH 11. SEC., T., R., M., OR BLK AND SURVEY OR AREA SEC 7, T18S, R32E 12. COUNTY OR PARISH LEA 13. STATE NM

14. DISTANCE IN MILES AND DIRECTION FROM NEAREST TOWN OR POST OFFICE 20 MILES SW OF MALJAMAR, NM	15. DISTANCE FROM PROPOSED LOCATION TO NEAREST PROPERTY OR LEASE LINE, FT. (Also to nearest drlg. unit line, if any) 330'	16. NO. OF ACRES IN LEASE 241.89	17. NO. OF ACRES ASSIGNED TO THIS WELL 40
18. DISTANCE FROM PROPOSED LOCATION TO NEAREST WELL DRILLING, COMPLETED, OR APPLIED FOR, ON THIS LEASE, FT. 2350'	19. PROPOSED DEPTH 9400'	20. ROTARY OR CABLE TOOLS ROTARY	
21. ELEVATIONS (Show whether DF, RT, GR, etc.) 3799			APPROX. DATE WORK WILL START 28-Jun-00

23. PROPOSED CASING AND CEMENTING PROGRAM				
SIZE OF HOLE	GRADE, SIZE OF CASING	WT PER FT	SETTING DEPTH	QUANTITY OF CEMENT
17 1/2"	13 3/8" H-40	48#	<del>300</del> 1025'	425 SX "C" W/2% CACL & 1/4# CELLOSEAL
12 1/4"	8 5/8" J-55	32#	3,100'	350 SX "C" W/2% CACL & 1/4# CELLOSEAL, 1,000 SX FILL
7 7/8"	5 1/2" J-55	17#	9,400'	1000 SX LEAD & 400 SX TAIL **
(SEE EXHIBIT "E")				

ALL CASING WILL BE NEW, OR USED MEETING BLM SPECS.  
CEMENT WILL BE CIRCULATED ON 13 3/8" AND 8 5/8" CASING.  
CEMENT QUANTITIES AND ADDITIVES ARE SUBJECT TO CHANGE DUE TO HOLE CONDITIONS.  
\* FILLER CEMENT 35/65 "C" POZ w/ 6% GEL, 5# SALT, & 1/4# FLOSEAL  
\*\* LEAD: 1000 SX "H" POZ w/ 2% GEL & 5# SALT PER SACK  
TAIL: 400 SX "H" w/ 3% KCL, .5% FLUID LOSS, .3% DISPERSANT, 1% BONDING AGENT, .3% RETARDER, & .2% SODIUM METASILICATE PER SACK

PROPOSED MUD PROGRAM	
0-400'	FRESH WATER, PAPER, & ACTIGUARD. MW-9.0 VIS-31
400'-3,100'	BRINE WATER, PAPER, & ACTIGUARD. MW-10.0, VIS-31
3,100'-9,400'	FRESH WATER, PAPER, ACTIGUARD, & AMMONIA NITRATE. 30-60,000 CHLORIDES MW-9.0 VIS-31
0	

MUD PROGRAM SUBJECT TO CHANGE DUE TO HOLE CONDITIONS

IN ABOVE SPACE DESCRIBE PROPOSED PROGRAM: If proposal is to deepen, give data on present productive zone and proposed new productive zone. If proposal is to drill or deepen directionally, give pertinent data on subsurface locations and measured and true vertical depths. Give blowout preventer program, if any.

24. SIGNED Bob Williams Bob Williams TITLE Drilling Superintendent DATE 5/2/00

(THIS SPACE FOR FEDERAL OR STATE OFFICE USE)

PERMIT NO. \_\_\_\_\_ APPROVAL DATE \_\_\_\_\_

APPLICATION APPROVAL DOES NOT WARRANT OR CERTIFY THAT THE APPLICANT HOLDS LEGAL OR EQUITABLE TITLE TO THOSE RIGHTS IN THE SUBJECT LEASE WHICH WOULD ENTITLE THE APPLICANT TO CONDUCT OPERATIONS THEREON

CONDITIONS OF APPROVAL IF ANY:

APPROVED BY /S/LARRY D. BRAY TITLE Assistant Field Manager, Lands And Minerals DATE JUN 14 2000

TITLE 18 U.S.C. SECTION 1001, MAKES IT A CRIME FOR ANY PERSONS KNOWINGLY AND WILLFULLY TO MAKE TO ANY DEPARTMENT OR AGENCY OF THE UNITED STATES ANY FALSE, FICTITIOUS OR FRAUDULENT STATEMENTS OR REPRESENTATIONS AS TO ANY MATTER WITHIN ITS JURISDICTION

APPROVED FOR 1 YEAR

OPER. LOG NO. 10179  
PROPERTY NO. 26127  
WELL NO. 65350  
DATE 6-19-00  
API NO. 30-025-35056

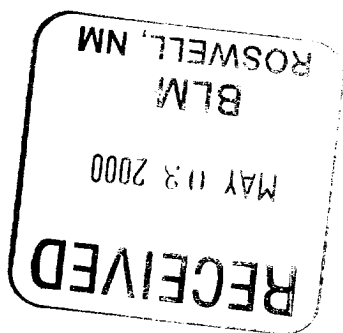

**Application  
Harvey E. Yates Company  
Bola 7 Fed #1  
Section 7, T18S, R32E  
Eddy County, New Mexico**

In conjunction with Form 3160-3, Application For Permit To Drill Or Deepen subject well, Harvey E. Yates Company submits the following ten items of pertinent information in accordance with Onshore Oil & Gas Order No. 10.

1. **Geologic Name of Surface Formation:**  
Quaternary alluvium and bolson deposits
2. **Estimated Tops of Significant Geologic Markers:**  
Rustler 950', Yates 2,320', Seven Rivers 2,720', Bowers 3,370', Queen 3,620', Penrose 3,900', Grayburg 4,225', Loco Hills 4,350', San Andres 4,725', Delaware 5,015', Bone Springs 6,100', BSPG 1<sup>st</sup> Sand 7,900', BSPG "B" Zone 8,150', BSPG 2<sup>nd</sup> Sand 8,600', BSPG "B" sand 8,670', BSPG "C" Sand 8,840', Base "C" sand 8,980', "C" Zone 9,100', 3<sup>rd</sup> Sand 9,250', PTD 9,400'.
3. **Estimated Depths at which Water, Oil, or Gas Formations are expected:**  
Oil: Bone Spring 1<sup>st</sup> sand @ 7,900  
Gas: Bone Spring 1<sup>st</sup> sand @ 7,900
4. **Proposed Casing Program:**  
See Form 3160-3
5. **Pressure Control Equipment:**  
BOP & Annular. See Exhibit C.
6. **Drilling Fluid Program:**  
See Form 3160-3
7. **Auxiliary Equipment:**  
H2S Compliance package
8. **Testing, Logging, & Coring Program:**  
Rotary sidewall cores will be taken, and one DST is planned for the "B-C" Zone Carbonates. The planned logs are Schlumberger Platform Express w/HALS.
9. **Abnormal Conditions, Pressures, Temperature, or Potential Hazards:**  
No abnormal conditions are anticipated in this well bore.  
BHST 160 deg F  
BHP 2000 psi
10. **Anticipated Starting Date & Duration of Operation:**  
Spud Date: Approximately June 28, 2000. Duration of this project will be approximately 40 days from start of Construction of drilling pad until finish of completion operations

**Surface Use Plan**  
Harvey E. Yates Company  
Bola 7 Fed #1  
Section 1, T18S, R31E  
Eddy County, New Mexico

1. **Existing Roads:**  
Exhibit A is a portion of a New Mexico map showing the location of the proposed location. The location is approximately 20 miles SouthWest of Maljamar, NM. Leave Artesia on U.S. 82 & travel 31 miles east to the junction of NM 529. Turn Southeast and go 7 miles. Turn right & go 2.6 miles. Go .5 miles & turn right. Go .4 miles & turn left. Go .5 miles & turn right. Go .4 miles & turn right. Go 360' to location.
2. **Planned Access Roads:**  
.4 Miles of existing 2 track road will be improved, & 360' of new road will be built to access this well.
3. **Location of Existing Wells:**  
See EXHIBIT B
4. **Location of Tank Batteries, Electric Lines, Etc:**  
In the event a producing well is drilled, a tank battery will be built on the location.
5. **Location and Type of Water Supply:**  
Water will be obtained from commercial sources.
6. **Source of Construction Material:**  
We will use materials from the primary and auxillary reserve pits to build the location.
7. **Methods of Handling Waste Disposal:**  
Waste will be handled in an approved manner. The wellsite will be cleaned of all waste within 30 days of final completion of the well.
8. **Ancillary Facilities:**  
N/A
9. **Wellsite Layout:**
  - a. EXHIBIT D shows the relative location and dimensions of the well pad, reserve pits, and major rig components.
  - b. The land is relatively flat with sandy soil and sand dunes
  - c. The pad and pit area have been staked.
10. **Plan for Restoration of the Surface:**
  - a. After drilling and completion operations are completed, all equipment and other materials not needed for further operations will be removed. Pits will be back filled and the location cleaned of all trash to leave the wellsite as pleasant in appearance as possible.
  - b. If the proposed operation is nonproductive, all restoration and/or vegetation requirements of the BLM will be complied with, and will be accomplished as quickly as possible. All pits will be filled and leveled within 90 days after abandonment.

**11. Other Information:**

- a. The surface and mineral owner is the Federal Government. The grazing Lessee is Virgil Linam Estate, and they have been contacted regarding operations.
- b. The topography consists of sandy soil with native grasses. No wildlife was observed, but the usual inhabitants of this region are Jackrabbits, Reptiles, Coyotes, etc.
- c. There are no ponds, lakes, or rivers in this area.
- d. An Archaeological Survey has been made and a copy has been sent to the Roswell BLM office. There is no evidence of any significant archaeological, historical, or cultural sites in the area. Further, there are no occupied dwellings or windmills in the area.
- e. Should any incidental oil be recovered during testing of this well, this oil will be considered waste oil and not sellable due to contamination by drilling and/or completion fluids.

**12. Operator's Representative:**

I certify that I, or persons under my direct supervision, have inspected the proposed drill site and access route; that I am familiar with the conditions which currently exist; that the statements made in this plan are, to the best of my knowledge, true and correct; that the work associated with operations proposed herein will be performed by Harvey E. Yates Company and its contractors and subcontractors in conformity with this plan and the terms and conditions under which it is approved. This statement is subject to the provisions of 18 U.S.C. 1001 for the filing of a false statement.

Bob Williams Drilling Superintendent  
Harvey E. Yates Company  
P.O. Box 1933  
Roswell, NM  
505-623-6601

May 2, 2000

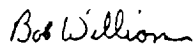

Bob Williams  
Drilling Superintendent

**United States Department of the Interior**

**BUREAU OF LAND MANAGEMENT  
Roswell Resource Area  
P.O. Drawer 1857  
Roswell, New Mexico 88202-1857**

**Statement Accepting Responsibilities for Operations**

**Operator Name: Harvey E. Yates Company  
Street or Box: P.O. Box 1933  
City, State: Roswell, New Mexico  
Zip Code: 88202**

The undersigned accepts all applicable terms, conditions, stipulations, and restrictions concerning operations conducted on the leased land or portion thereof, as described below.

**Lease No.: NMNM-40449**

**Lease Name: Bola 7 Fed #1**

**Legal description of land: Sec 7, T18S, R32E, Lea County, New Mexico**

**Formation(s) (if applicable): Bone Springs**

**Bond Coverage: (State if individually bonded or another's bond): Blanket Bond**

**BLM Bond File No.:**

**Authorized Signature: Bob William**

**Title: Drilling Superintendent**

**Date: May 2, 2000**

DISTRICT I  
P.O. Box 1980, Hobbs, NM 88241-1980

State of New Mexico  
Energy, Minerals and Natural Resources Department

Form C-102  
Revised February 10, 1994  
Submit to Appropriate District Office  
State Lease - 4 Copies  
Fee Lease - 3 Copies

DISTRICT II  
P.O. Drawer DD, Artesia, NM 88211-0719

DISTRICT III  
1000 Rio Brazos Rd., Aztec, NM 87410

DISTRICT IV  
P.O. BOX 2088, SANTA FE, N.M. 87504-2088

## OIL CONSERVATION DIVISION

P.O. Box 2088  
Santa Fe, New Mexico 87504-2088

☐ AMENDED REPORT

### WELL LOCATION AND ACREAGE DEDICATION PLAT

API Number <b>30-025-35056</b>	Pool Code <b>65350</b>	Pool Name <b>Young, Bone Spring North</b>
Property Code <b>26121</b>	Property Name <b>BOLA "7" FEDERAL</b>	Well Number <b>1</b>
OGRID No. <b>10179</b>	Operator Name <b>HARVEY E. YATES COMPANY</b>	Elevation <b>3799</b>

#### Surface Location

UL or lot No.	Section	Township	Range	Lot Idn	Feet from the	North/South line	Feet from the	East/West line	County
B	7	18 S	32 E		330	NORTH	1980	EAST	LEA

#### Bottom Hole Location If Different From Surface

UL or lot No.	Section	Township	Range	Lot Idn	Feet from the	North/South line	Feet from the	East/West line	County
Dedicated Acres <b>40</b>	Joint or Infill	Consolidation Code	Order No.						

NO ALLOWABLE WILL BE ASSIGNED TO THIS COMPLETION UNTIL ALL INTERESTS HAVE BEEN CONSOLIDATED  
OR A NON-STANDARD UNIT HAS BEEN APPROVED BY THE DIVISION

LOT 1 40.99 ACRES	SEE DETAIL NMNM-40449	<p>330'</p> <p>1980'</p> <p>3802.6'</p> <p>3799.8'</p> <p>3795.5'</p> <p>3799.5'</p> <p>DETAIL</p>
LOT 2		
LOT 3 40.97 ACRES		
LOT 4 40.95 ACRES		
LOT 5 40.93 ACRES		

#### OPERATOR CERTIFICATION

I hereby certify the the information contained herein is true and complete to the best of my knowledge and belief.

Bob Williams  
Signature

Bob Williams  
Printed Name

Drilling Superintendent  
Title

May 03, 2000  
Date

#### SURVEYOR CERTIFICATION

I hereby certify that the well location shown on this plat was plotted from field notes of actual surveys made by me or under my supervision, and that the same is true and correct to the best of my belief.

APRIL 28, 2000  
Date Surveyed

DC  
Signature & Seal of Professional Surveyor

Ronald J. Eidson 5/6/00  
60-11-0543

Certificate No. RONALD J. EIDSON 3239  
GARY EIDSON 12641  
MACON McDONALD 12185

# VICINITY MAP

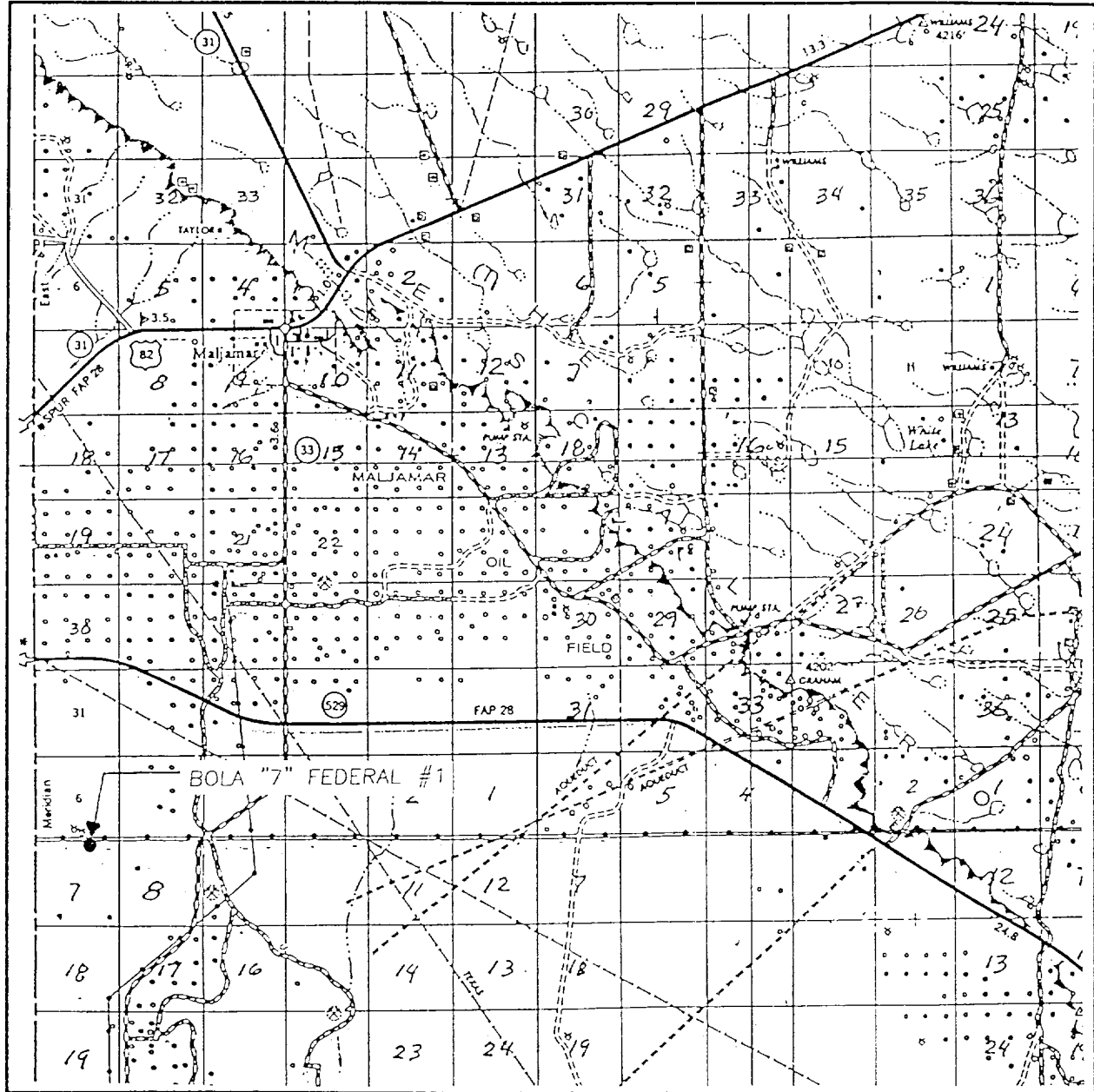

SCALE: 1" = 2 MILES

SEC. 7 TWP. 18-S RGE. 32-E

SURVEY N.M.P.M.

COUNTY LEA

DESCRIPTION 330' FNL & 1980' FEL

ELEVATION 3799

OPERATOR HARVEY E. YATES COMPANY

LEASE BOLA "7" FEDERAL

**JOHN WEST SURVEYING**  
**HOBBS, NEW MEXICO**  
**(505 393-3117)**



# LOCATION VERIFICATION MAP

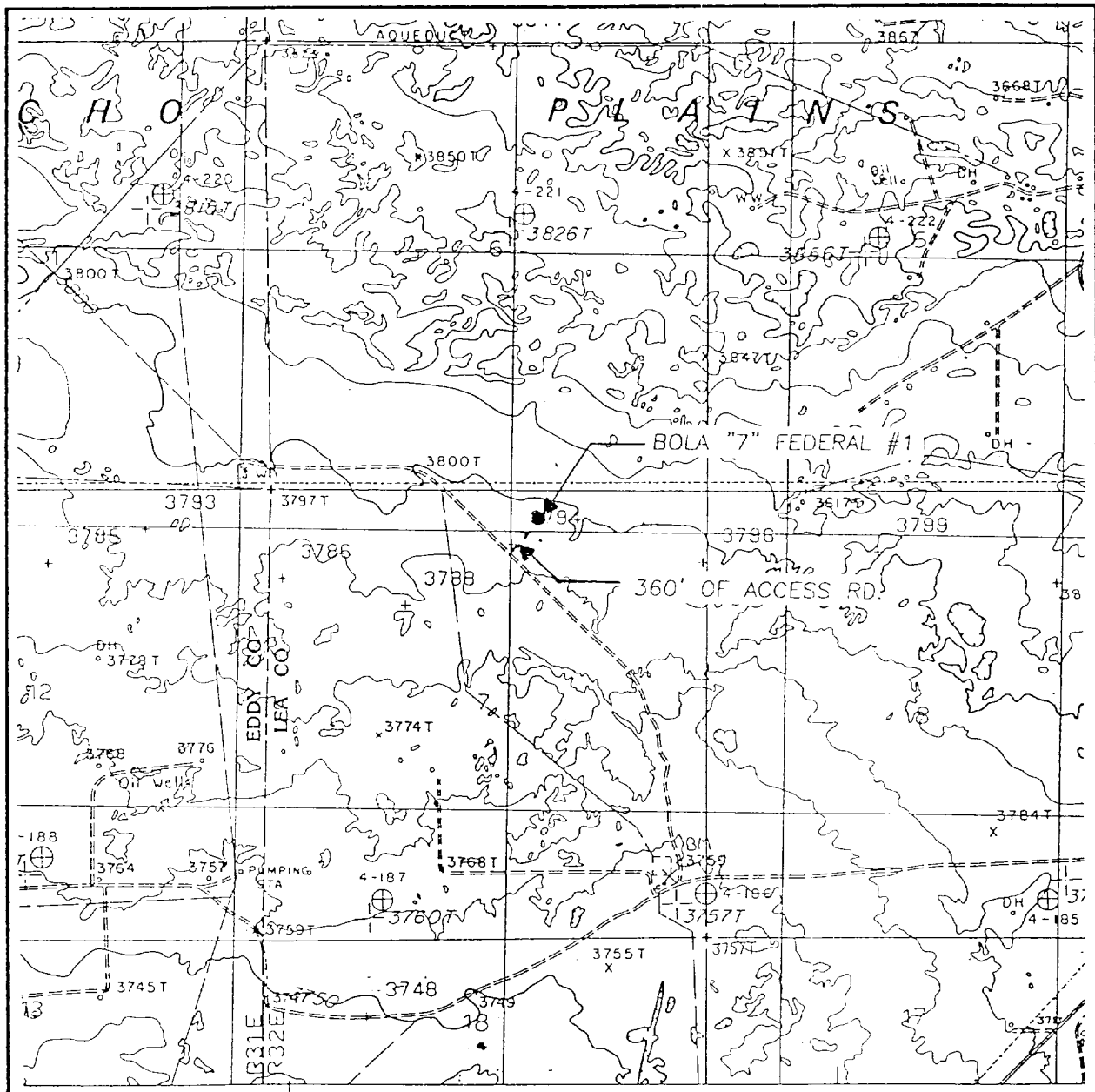

SCALE: 1" = 2000'

CONTOUR INTERVAL:  
MALJAMAR - 10'

SEC. 7 TWP. 18-S RGE. 32-E

SURVEY N.M.P.M.

COUNTY LEA

DESCRIPTION 330' FNL & 1980' FEL

ELEVATION 3799

OPERATOR HARVEY E. YATES COMPANY

LEASE BOLA "7" FEDERAL

U.S.G.S. TOPOGRAPHIC MAP

MALJAMAR, N.M.

**JOHN WEST SURVEYING**  
**HOBBS, NEW MEXICO**  
**(505 393-3117)**

EXHIBIT "C" BOP STACK

Bola 7 Fed #1  
330' FNL & 1,980' FEL  
Sec 7, T18S, R32E  
Lea County, NM

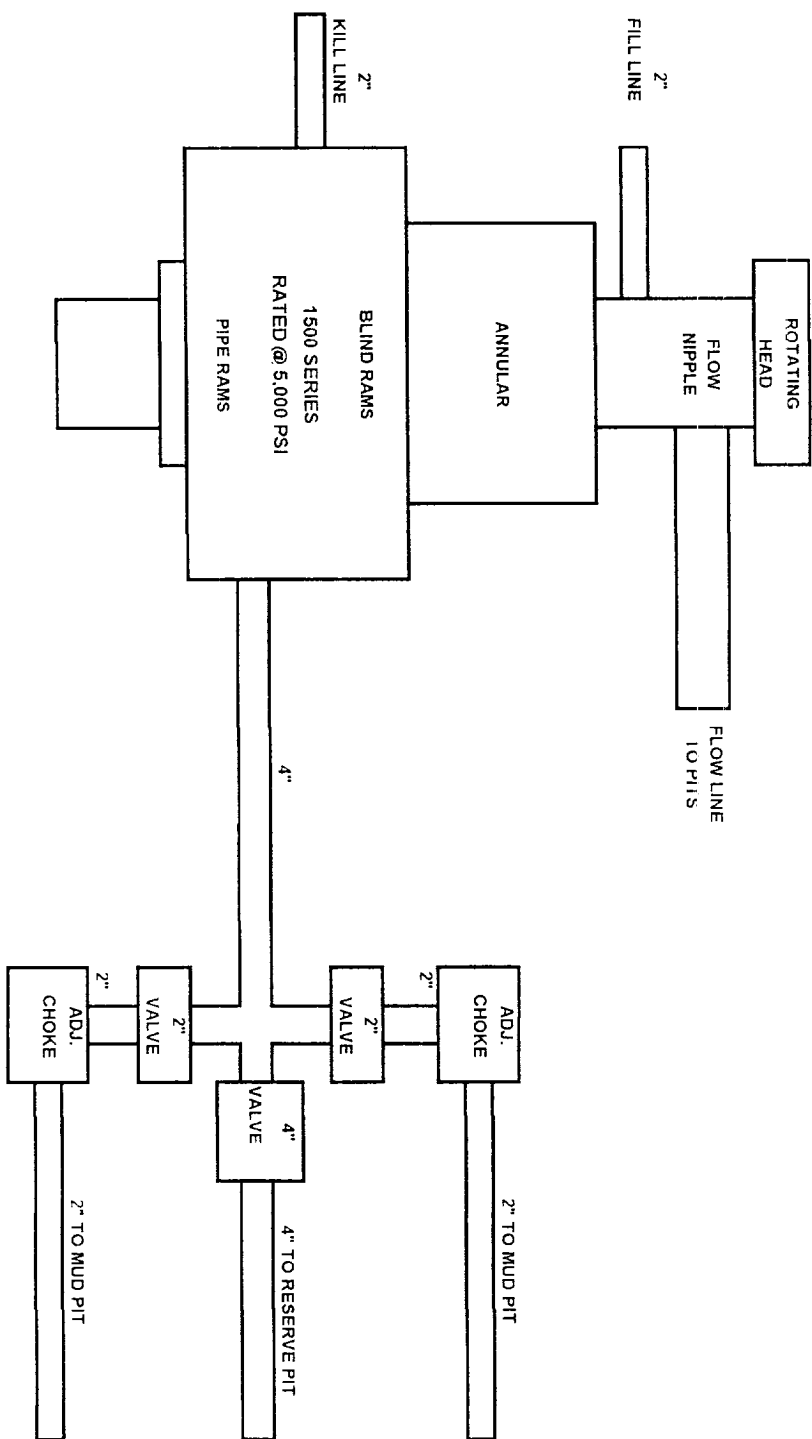

EXHIBIT "D" LOCATION DIAGRAM

Bola 7 Fed #1  
330' FNL & 1,980' FEL  
Sec 7, T18S, R32E  
Lea County, NM

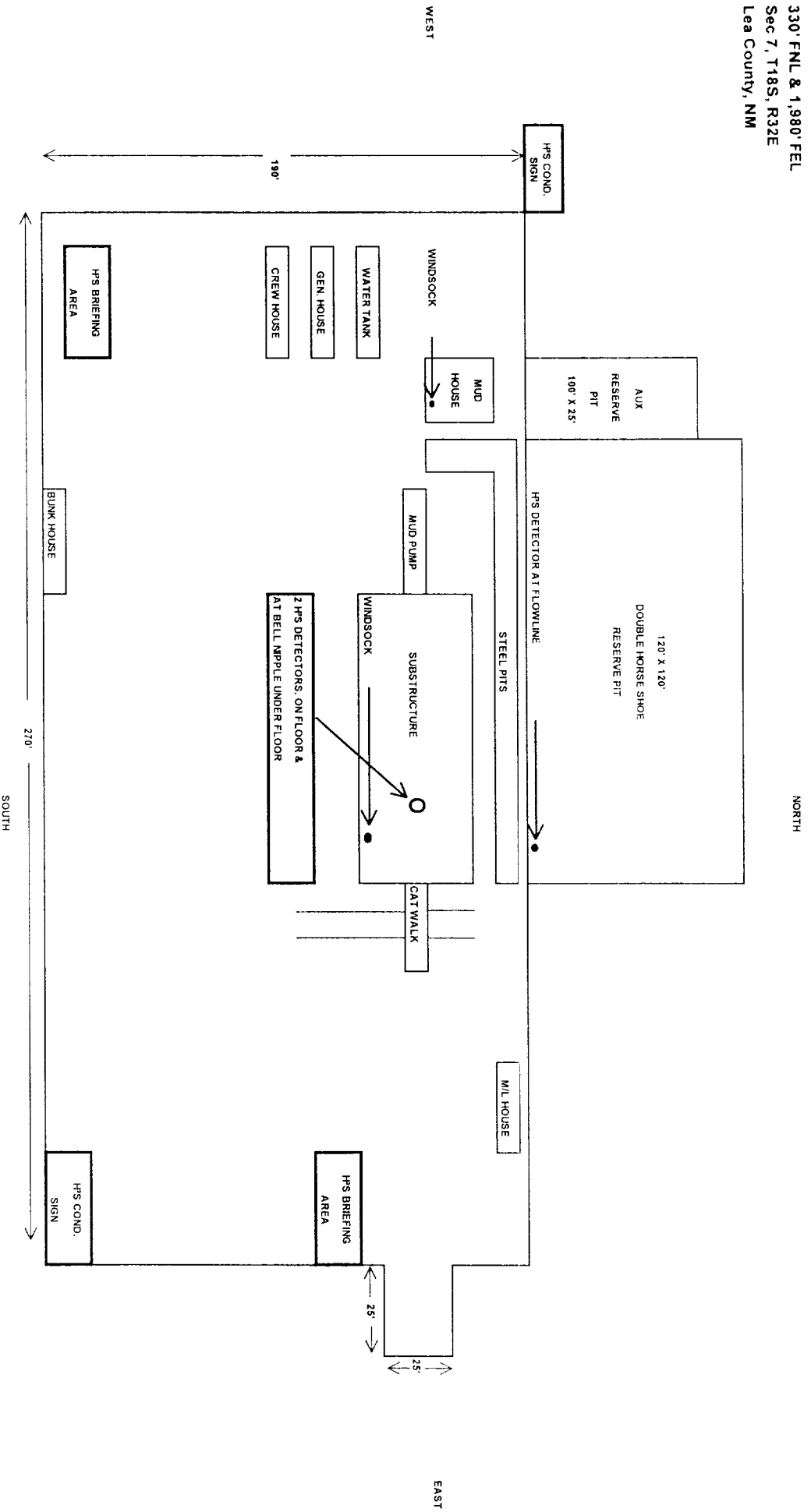
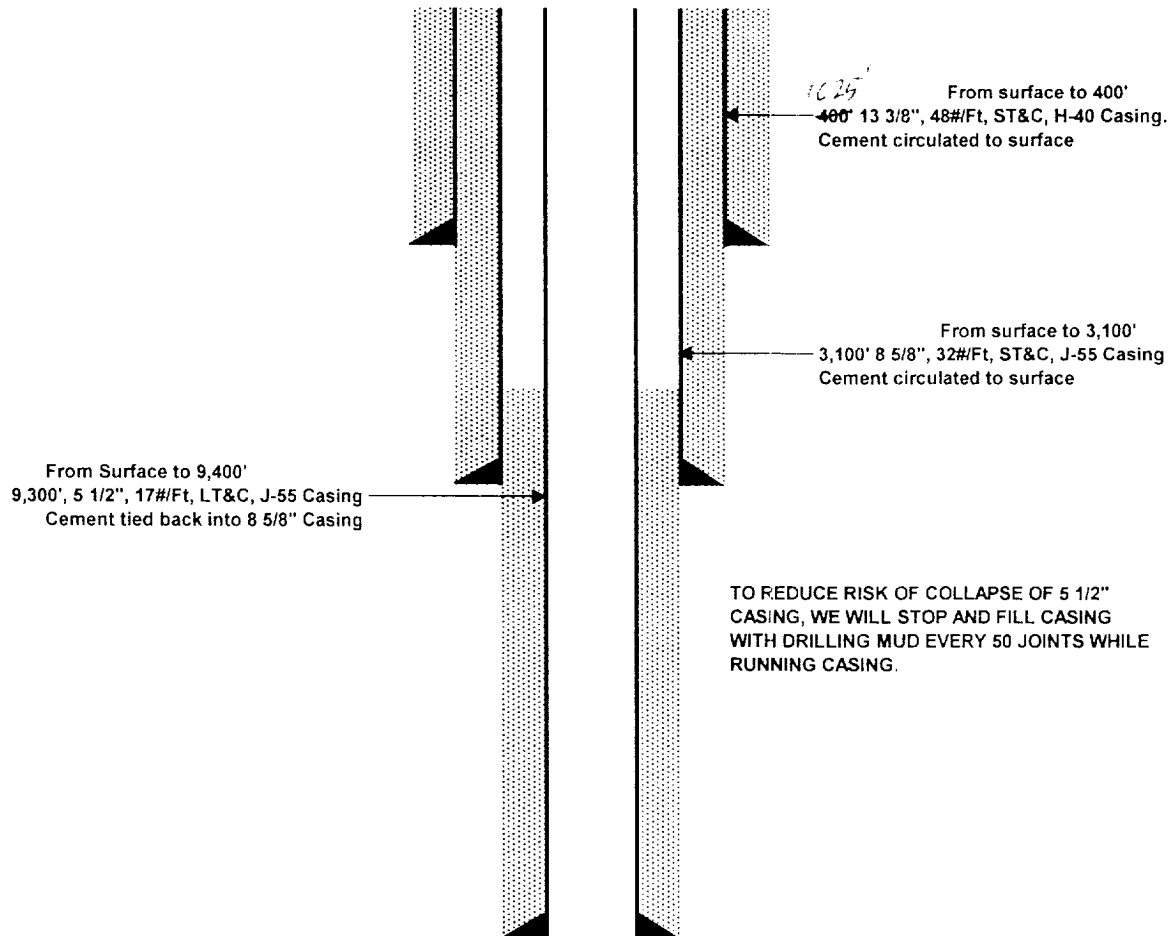

EXHIBIT "E" CASING DESIGN

## Casing Design

Bola 7 Fed #1  
330' FNL & 1,980' FEL  
Sec 7, T18S, R32E  
Lea County, NM



## EXHIBIT "F"

Harvey E. Yates Company  
Bola 7 Fed #1  
Section 7, T18S, R32E  
Lea County, New Mexico

### HYDROGEN SULFIDE DRILLING OPERATIONS PLAN

#### I Hydrogen Sulfide Training

All personnel, whether regularly assigned, contracted, or employed on an unscheduled basis will show proof of training from a qualified instructor in the following areas before commencing any work on the above named well.

1. The hazards and characteristics of hydrogen sulfide ( $H_2S$ )
2. The proper use and maintenance of personal protective equipment and life support systems.
3. The proper use of  $H_2S$  detectors, alarms, warning signs, briefing areas, and evacuation procedures.
5. The proper technique for rescues.

#### II $H_2S$ Safety Equipment and Systems

All  $H_2S$  safety equipment and systems will be installed 1,000 feet prior to penetrating the first zone containing or reasonably expected to contain  $H_2S$ .

1. Well Control Equipment
  - A. Choke manifold with a minimum of two adjustable chokes.
  - B. Blind and pipe rams to accommodate all pipe in use.
  - C. Auxiliary equipment to include annular preventer and rotating head.
2. Protective equipment for essential personnel
  - A. Four 5 minute escape units in top dog house.
  - B. One 30 minute SCBA at each briefing area.
3.  $H_2S$  detection and monitoring equipment
  - A. Three channel monitor located on floor, with detectors located on floor, on flow nipple, and on flow line on mud pit.
4. Visual Warning Systems
  - A. Windsack located on floor and mud pits.
  - B. Briefing area signs located on NE & SW corners of pad.
  - C.  $H_2S$  Condition sign located at entrance to location.
5. Mud Program

The mud program has been designed to minimize the volume of possible  $H_2S$  circulated to surface. Proper weight, safe drilling practices, and the use of  $H_2S$  scavengers will minimize hazards when penetrating possible  $H_2S$  bearing zones.

6. Metallurgy

All drill strings, casing, tubing, wellhead, blowout preventers, drilling spool, kill lines, choke manifolds, and associated lines and valves shall be suitable for an H<sub>2</sub>S environment.

7. Communications

Drilling rig and company vehicles will be equipped with two way radios or cellular telephones.

8. Well testing

One Drill Stem Test is planned for this well.

ELF  
\_\_\_\_\_  
ABOVE DATE DOES NOT  
INDICATE WHEN  
CONFIDENTIAL LOGS  
WILL BE RELEASED