

District I  
PO Box 1980, Hobbs, NM 88241-1980  
District II  
811 South First, Artesia, NM 88210  
District III  
1000 Rio Brazos Rd., Aztec, NM 87410  
District IV  
2040 South Pacheco, Santa Fe, NM 87505

State of New Mexico  
Energy, Minerals & Natural Resources Department

OIL CONSERVATION DIVISION  
2040 South Pacheco  
Santa Fe, NM 87505

Form C-101  
Revised October 18, 1994  
Instructions on back  
Submit to Appropriate District Office  
State Lease - 6 Copies  
Fee Lease - 5 Copies

☐ AMENDED REPORT

APPLICATION FOR PERMIT TO DRILL, RE-ENTER, DEEPEN, PLUGBACK, OR ADD A ZONE

<sup>1</sup> Operator Name and Address. TMBR/Sharp Drilling, Inc. P. O. Drawer 10970 Midland, TX 79702		<sup>2</sup> OGRID Number 036554
		<sup>3</sup> API Number 30-025-35175
<sup>4</sup> Property Code 26429	<sup>5</sup> Property Name Angel "13" State	<sup>6</sup> Well No. 2

<sup>7</sup> Surface Location

UL or lot no.	Section	Township	Range	Lot Idn	Feet from the	North/South line	Feet from the	East/West line	Count
G	13	17S	35E		2310	North	2310	East	Lea

<sup>8</sup> Proposed Bottom Hole Location If Different From Surface

UL or lot no.	Section	Township	Range	Lot Idn	Feet from the	North/South line	Feet from the	East/West line	Count

<sup>9</sup> Proposed Pool 1

Wildcat (Blinberry)

<sup>10</sup> Proposed Pool 2

<sup>11</sup> Work Type Code N	<sup>12</sup> Well Type Code O	<sup>13</sup> Cable/Rotary R	<sup>14</sup> Lease Type Code S	<sup>15</sup> Ground Level Elevation 3918
<sup>16</sup> Multiple No	<sup>17</sup> Proposed Depth 7300'	<sup>18</sup> Formation Blinberry	<sup>19</sup> Contractor TMBR/Sharp	<sup>20</sup> Spud Date 9/18/00

<sup>21</sup> Proposed Casing and Cement Program

Hole Size	Casing Size	Casing weight/foot	Setting Depth	Sacks of Cement	Estimated TOC
12 1/4	8 5/8	32	1800	1000	Surface
7 7/8	5 1/2	15.5	7300	250	6000

<sup>22</sup> Describe the proposed program. If this application is to DEEPEN or PLUG BACK give the data on the present productive zone and proposed new productive zone. Describe the blowout prevention program, if any. Use additional sheets if necessary.

It is proposed to drill a 12 1/4" hole to  $\pm 1800'$  with FW, set 8 5/8" casing and cement casing back to surface. A 3000 psi annular preventer and 3000 psi dual ram BOP will be nipped up and tested. A 7 7/8" hole will be drilled to an approximate TD of 7300'. Mud up will occur at about 6800', and one DST is possible. The 5 1/2" casing will be run to TD and cemented back to 6000'.

Permit Expires 1 Year From Approval  
Date Unless Drilling Underway

<sup>23</sup> I hereby certify that the information given above is true and complete to the best of my knowledge and belief.

Signature:

Printed name: Jeffrey D. Phillips

Title: Vice President

Date: September 14, 2000

Phone: (915) 699-5050

OIL CONSERVATION DIVISION

Approved by:

Title:

Approval Date: 9/15/2000

Expiration Date:

Conditions of Approval:

Attached ☐

**C-101 Instructions**

Measurements and dimensions are to be in feet/inches. Well locations will refer to the New Mexico Principal Meridian.

IF THIS IS AN AMENDED REPORT CHECK THE BOX LABELED "AMENDED REPORT" AT THE TOP OF THIS DOCUMENT.

- |          |  |    |  |
|----------|--|----|--|
| 1        | Operator's OGRID number. If you do not have one it will be assigned and filled in by the District office.  | 18 | Geologic formation at TD   |
| 2        | Operator's name and address  | 19 | Name of the intended drilling company if known.  |
| 3        | API number of this well. If this is a new drill the OCD will assign the number and fill this in.   | 20 | Anticipated spud date.   |
| 4        | Property code. If this is a new property the OCD will assign the number and fill it in.  | 21 | Proposed hole size ID inches, proposed casing OD inches, casing weight in pounds per foot, setting depth of the casing or depth and top of liner, proposed cementing volume, and estimated top of cement |
| 5        | Property name that used to be called 'well name'   | 22 | Brief description of the proposed drilling program and BOP program. Attach additional sheets if necessary.   |
| 6        | The number of this well on the property.   | 23 | The signature, printed name, and title of the person authorized to make this report. The date this report was signed and the telephone number to call for questions about this report.                   |
| 7        | The surveyed location of this well New Mexico Principal Meridian NOTE: If the United States government survey designates a Lot Number for this location use that number in the 'UL or lot no.' box. Otherwise use the OCD Unit Letter.       |    |  |
| 8        | The proposed bottom hole location of this well at TD   |    |  |
| 9 and 10 | The proposed pool(s) to which this well is being drilled.  |    |  |
| 11       | Work type code from the following table:<br>N      New well<br>E      Re-entry<br>D      Drill deeper<br>P      Plugback<br>A      Add a zone  |    |  |
| 12       | Well type code from the following table:<br>O      Single oil completion<br>G      Single gas completion<br>M      Multiple completion<br>I      Injection well<br>S      SWD well<br>W      Water supply well<br>C      Carbon dioxide well |    |  |
| 13       | Cable or rotary drilling code<br>C      Propose to cable tool drill<br>R      Propose to rotary drill  |    |  |
| 14       | Lease type code from the following table:<br>S      State<br>P      Private  |    |  |
| 15       | Ground level elevation above sea level   |    |  |
| 16       | Intend to multiple complete? Yes or No   |    |  |
| 17       | Proposed total depth of this well  |    |  |

DISTRICT I  
P.O. Box 1980, Hobbs, NM 88241-1980

DISTRICT II  
P.O. Drawer DD, Artesia, NM 88211-0719

DISTRICT III  
1000 Rio Brazos Ed., Artesia, NM 87410

DISTRICT IV  
P.O. Box 2088, Santa Fe, NM 87504-2088

State of New Mexico  
Energy, Minerals and Natural Resources Department

Form C-102  
Revised February 10, 1994  
Submit to Appropriate District Office  
State Lease - 4 Copies  
Fee Lease - 3 Copies

OIL CONSERVATION DIVISION

P.O. Box 2088  
Santa Fe, New Mexico 87504-2088

☐ AMENDED REPORT

WELL LOCATION AND ACREAGE DEDICATION PLAT

API Number 30-025-35175	Pool Code ✓	Pool Name WILDCAT (BLINEBERRY)
Property Code 26429	Property Name ANGEL "13" STATE	Well Number 2
OGRID No. 036554	Operator Name TMBR/SHARP DRILLING, INC.	Elevation 3918

Surface Location

UL or lot No. G	Section 13	Township 17 S	Range 35 E	Lot Idn	Feet from the 2310	North/South line NORTH	Feet from the 2310	East/West line EAST	County LEA
--------------------	---------------	------------------	---------------	---------	-----------------------	---------------------------	-----------------------	------------------------	---------------

Bottom Hole Location If Different From Surface

UL or lot No.	Section	Township	Range	Lot Idn	Feet from the	North/South line	Feet from the	East/West line	County
Dedicated Acres 40	Joint or Infill	Consolidation Code	Order No.						

NO ALLOWABLE WILL BE ASSIGNED TO THIS COMPLETION UNTIL ALL INTERESTS HAVE BEEN CONSOLIDATED  
OR A NON-STANDARD UNIT HAS BEEN APPROVED BY THE DIVISION

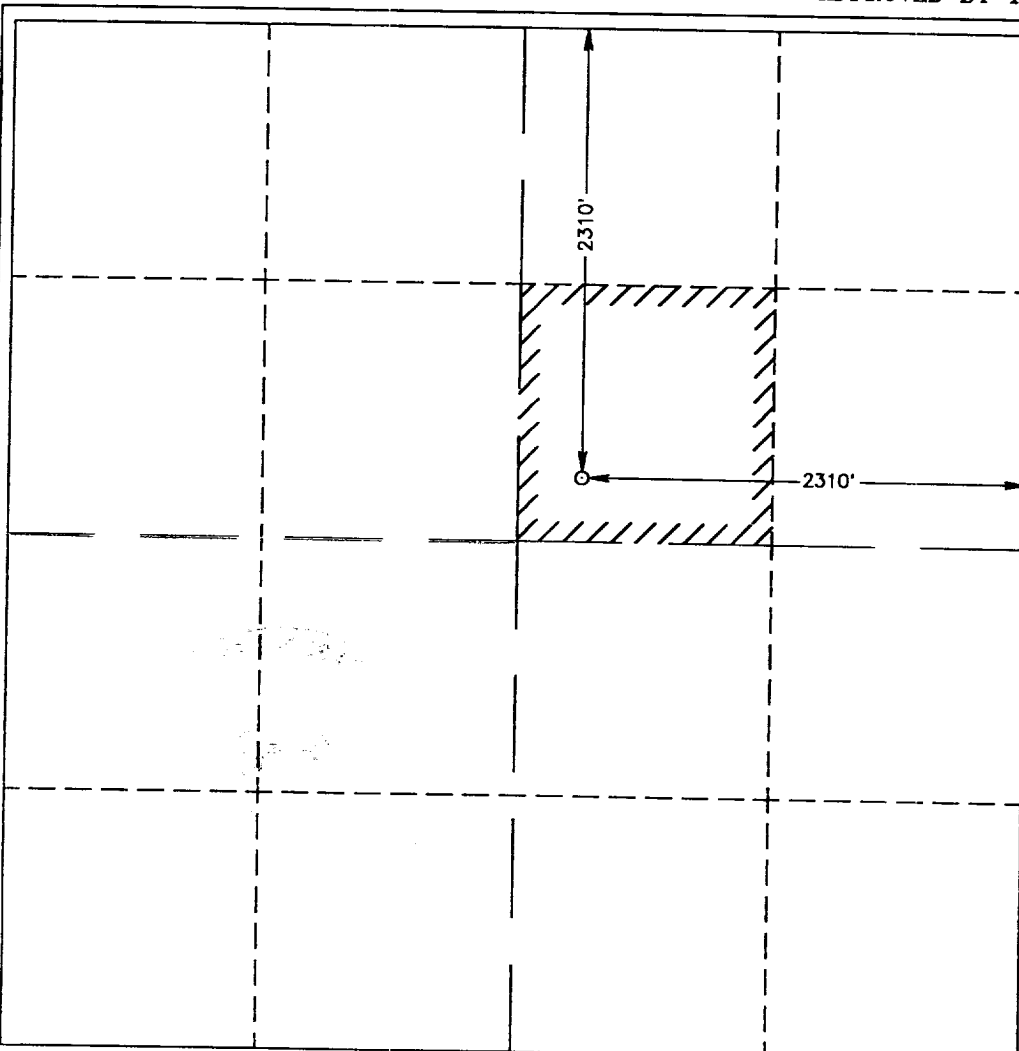

OPERATOR CERTIFICATION

I hereby certify the information contained herein is true and complete to the best of my knowledge and belief.

*Ronald J. Eidson*  
Signature

Ronald J. Eidson

Printed Name

Agent

Title

September 15, 2000

Date

SURVEYOR CERTIFICATION

I hereby certify that the well location shown on this plat was plotted from field notes of actual surveys made by me or under my supervision, and that the same is true and correct to the best of my belief.

SEPTEMBER 13, 2000

Date Surveyed

JLP

Signature & Seal of  
Professional Surveyor

*Ronald J. Eidson* 9/15/00  
W.O. Num. 00-11-1101

Certificate No. RONALD J. EIDSON, 3239  
GARY G. EIDSON, 12641  
MACON McDONALD, 12185



# TIMBER/SHARP DRILLING

B.O.P. Equipment Intended for use on Rig # 24

Well To Be drilled for Timber/Sharp

'All Valves (H2S)'

## Choke Manifold:

Pressure Rating 3,000 or 5,000 (as Req.)

1 - 4" Valves (2 if Required)

4 - 2" Valves

2 - 2" Adjustable Chokes

Valve Types Used:

Cameron - F or FC

Shaffer - B Floseal

WKM - type 2

Chokes - Cameron H2 or TC unibolt

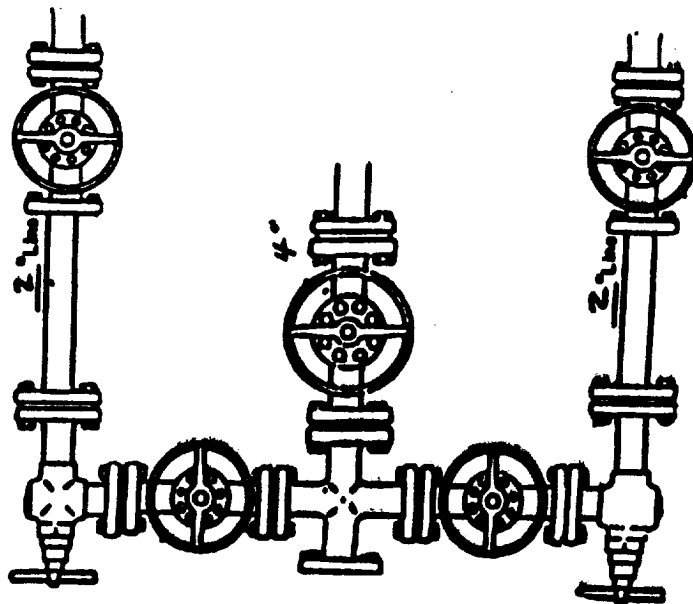

# TIMBR/SHARP DRILLING

B.O.P. Equipment Intended for use on Rig # 24

Well To Be drilled for Timbr/Sharp

' All B.O.P equipment is H2S Trim '

' All Accumulators are Koomey Type-80 : Dual Power Electric/Air '

' Choke Manifold: " See sheet 2

4" Valves : Cameron F/FC, Shaffer DB Hydraulic

2" Check Valve: Cameron Type R

2" Valves : Cameron or Shaffer

**Annular** Shaffer Type: Spherical

**Annular PSI:** 3000

( If Shaffer: Spherical , If Hydrit: Type GK )

**BOP Type** LWS 2 Gate

( If Shaffer: LWS or SL, If Cameron: Type U )

**BOP Size:** 11 " - 3000 PSI

Rotating Head Type Smith

Rot-Head Furnished By Timbr/Sharp

Rams in top gate: Blinds

Rams in bottom: 4 1/2 pipe

Side Outlets used:

Bottom X Top     

4" Valves on Tee

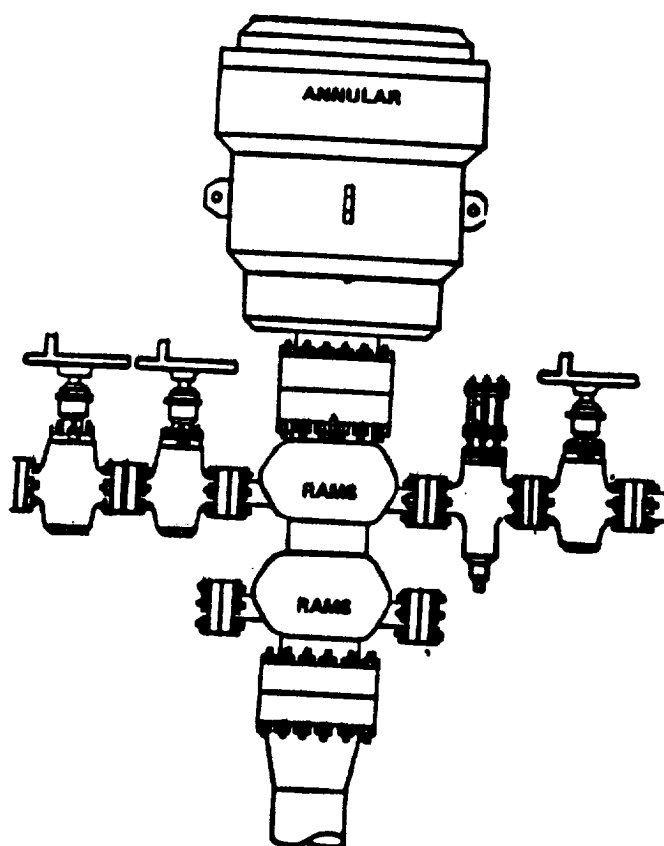

ABOVE DATE DOES NOT  
INDICATE WHEN  
CONFIDENTIAL LOGS  
WILL BE RELEASED

ELF

5/28/07  
1/16/07

UN  
CLASSIFIED  
RECEIVED