

District I  
PO Box 1980, Hobbs, NM 88241-1980  
District II  
PO Drawer DD, Artesia, NM 88211-0719  
District III  
1000 Rio Brazos Rd., Aztec, NM 87410  
District IV  
PO Box 2088, Santa Fe, NM 87504-2088

State of New Mexico  
Energy, Minerals & Natural Resources Department

OIL CONSERVATION DIVISION  
PO Box 2088  
Santa Fe, NM 87504-2088

Form C-101  
Revised February 10, 1994  
Instructions on back  
Submit to Appropriate District Office  
State Lease - 6 Copies  
Fee Lease - 5 Copies

☐ AMENDED REPORT

APPLICATION FOR PERMIT TO DRILL, RE-ENTER, DEEPEN, PLUGBACK, OR ADD A ZONE

Operator Name and Address: Chesapeake Operating, Inc. P. O. Box 18496 Oklahoma City, OK 73154-0496		OGRID Number 147179
Property Code 29048		Property Name LEE 20
		API Number 30-025-35757
		Well No. 1

Surface Location

UL or lot no.	Section	Township	Range	Lot Ids	Feet from the	North/South line	Feet from the	East/West line	County
A	20	17S	35E		660	North	660	East	Lea

Proposed Bottom Hole Location If Different From Surface

UL or lot no.	Section	Township	Range	Lot Ids	Feet from the	North/South line	Feet from the	East/West line	County
Proposed Pool 1 Vacuum North Atoka Morrow					Proposed Pool 2				

Work Type Code N	Well Type Code O/G	Cable/Rotary R	Lease Type Code S	Ground Level Elevation 3968'
Multiple N	Proposed Depth 12,400'	Formation Atoka/Morrow	Contractor Timber Sharp #24	Spud Date 12/15/01

Proposed Casing and Cement Program

Hole Size	Casing Size	Casing weight/foot	Setting Depth	Sacks of Cement	Estimated TOC
17-1/2"	13-3/8"	48#	0-500'	± 500	Surface
11"	8-5/8"	32#	0-4300'	± 1400	Surface
7-7/8"	5-1/2"	17#	0-12,400'	± 1100	4300'

Describe the proposed program. If this application is to DEEPEN or PLUG BACK give the data on the present productive zone and proposed new productive zone. Describe the blowout prevention program, if any. Use additional sheets if necessary.

Chesapeake Operating, Inc. proposes to drill to a total depth of 12,400' in the Atoka/Morrow formation with Timber/Sharp #24 as the drilling contractor. Timber/Sharp BOP consists of 11" 5M# blind & pipe rams & 11" 5M# Annular. (See Schematic

Permit Expires 1 Year From Approval  
Date Unless Drilling Underway

I hereby certify that the information given above is true and complete to the best of my knowledge and belief. Signature: <i>Barbara J. Bale</i>		OIL CONSERVATION DIVISION APPROVED BY PAUL F. KAUTZ PETROLEUM ENGINEER	
Printed name: Barbara J. Bale		Title:	
Title: Regulatory Analyst		Approval Date: NOV 14 2001	
Date: 10/31/01		Expiration Date:	
Phone: (405) 848-8000		Conditions of Approval: Attached <input type="checkbox"/>	

JCA

# C-101 Instructions

Measurements and dimensions are to be in feet/inches. Well locations will refer to the New Mexico Principal Meridian.

IF THIS IS AN AMENDED REPORT CHECK THE BOX LABELED "AMENDED REPORT" AT THE TOP OF THIS DOCUMENT.

- 1 Operator's OGRID number. If you do not have one it will be assigned and filled in by the District office.
- 2 Operator's name and address
- 3 API number of this well. If this is a new drill the OCD will assign the number and fill this in.
- 4 Property code. If this is a new property the OCD will assign the number and fill it in.
- 5 Property name that used to be called 'well name'
- 6 The number of this well on the property.
- 7 The surveyed location of this well New Mexico Principal Meridian NOTE: If the United States government survey designates a Lot Number for this location use that number in the 'UL or lot no.' box. Otherwise use the OCD Unit Letter.

8 The proposed bottom hole location of this well at TD

9 and 10 The proposed pool(s) to which this well is being drilled.

11 Work type code from the following table:

N	New well
E	Re-entry
D	Drill deeper
P	Plugback
A	Add a zone

12 Well type code from the following table:

O	Single oil completion
G	Single gas completion
M	Multiple completion
I	Injection well
S	SWD well
W	Water supply well
C	Carbon dioxide well

13 Cable or rotary drilling code

C	Propose to cable tool drill
R	Propose to rotary drill

14 Lease type code from the following table:

F	Federal
S	State
P	Private
N	Navajo
J	Jicarilla
U	Ute
I	Other Indian tribe

15 Ground level elevation above sea level

16 Intend to multiple complete? Yes or No

17 Proposed total depth of this well

18 Geologic formation at TD

19 Name of the intended drilling company if known.

20 Anticipated spud date.

21 Proposed hole size ID inches, proposed casing OD inches, casing weight in pounds per foot, setting depth of the casing or depth and top of liner, proposed cementing volume, and estimated top of cement

22 Brief description of the proposed drilling program and SOP program. Attach additional sheets if necessary.

23 The signature, printed name, and title of the person authorized to make this report. The date this report was signed and the telephone number to call for questions about this report.

DISTRICT I  
P.O. Box 1980, Hobbs, NM 88241-1980

DISTRICT II  
P.O. Drawer DD, Artesia, NM 88211-0719

DISTRICT III  
1000 Rio Brazos Rd., Aztec, NM 87410

DISTRICT IV  
P.O. BOX 2088, SANTA FE, N.M. 87504-2088

State of New Mexico  
Energy, Minerals and Natural Resources Department

OIL CONSERVATION DIVISION

P.O. Box 2088  
Santa Fe, New Mexico 87504-2088

Form C-102  
Revised February 10, 1994  
Submit to Appropriate District Office  
State Lease - 4 Copies  
Fee Lease - 3 Copies

WELL LOCATION AND ACREAGE DEDICATION PLAT

☐ AMENDED REPORT

API Number <b>30-025-35757</b>	Pool Code <b>86800</b>	Pool Name Vacuum North Atoka Morrow
Property Code <b>29048</b>	Property Name LEE 20	Well Number 1
OGRID No. 147179	Operator Name CHESAPEAKE OPERATING, INC.	Elevation 3968'

Surface Location

UL or lot No.	Section	Township	Range	Lot Idn	Feet from the	North/South line	Feet from the	East/West line	County
A	20	17-S	35-E		660	NORTH	660	EAST	LEA

Bottom Hole Location If Different From Surface

UL or lot No.	Section	Township	Range	Lot Idn	Feet from the	North/South line	Feet from the	East/West line	County
Dedicated Acres 320	Joint or Infill	Consolidation Code	Order No.						

NO ALLOWABLE WILL BE ASSIGNED TO THIS COMPLETION UNTIL ALL INTERESTS HAVE BEEN CONSOLIDATED  
OR A NON-STANDARD UNIT HAS BEEN APPROVED BY THE DIVISION

	<p>GEODETIC LOCATION SPC NMEZ NAD 27 Y = 665228.4 X = 764288.9 LAT = 32°49'33.03\"N LONG = 103°28'22.75\"W</p>	<p>OPERATOR CERTIFICATION</p> <p>I hereby certify the the information contained herein is true and complete to the best of my knowledge and belief.</p> <p><i>Barbara J. Bale</i> Signature Barbara J. Bale Printed Name Regulatory Analyst Title 10/31/01 Date</p>
		<p>SURVEYOR CERTIFICATION</p> <p>I hereby certify that the well location shown on this plat was plotted from field notes of actual surveys made by me or under my supervision, and that the same is true and correct to the best of my belief.</p> <p>OCTOBER 17, 2001 Date Surveyed AWB Signature &amp; Seal of Professional Surveyor <i>Ronald J. Eidson</i> 10/23/01 Certificate No. RONALD J. EIDSON 3239 GARY EIDSON 12641</p>

# VICINITY MAP

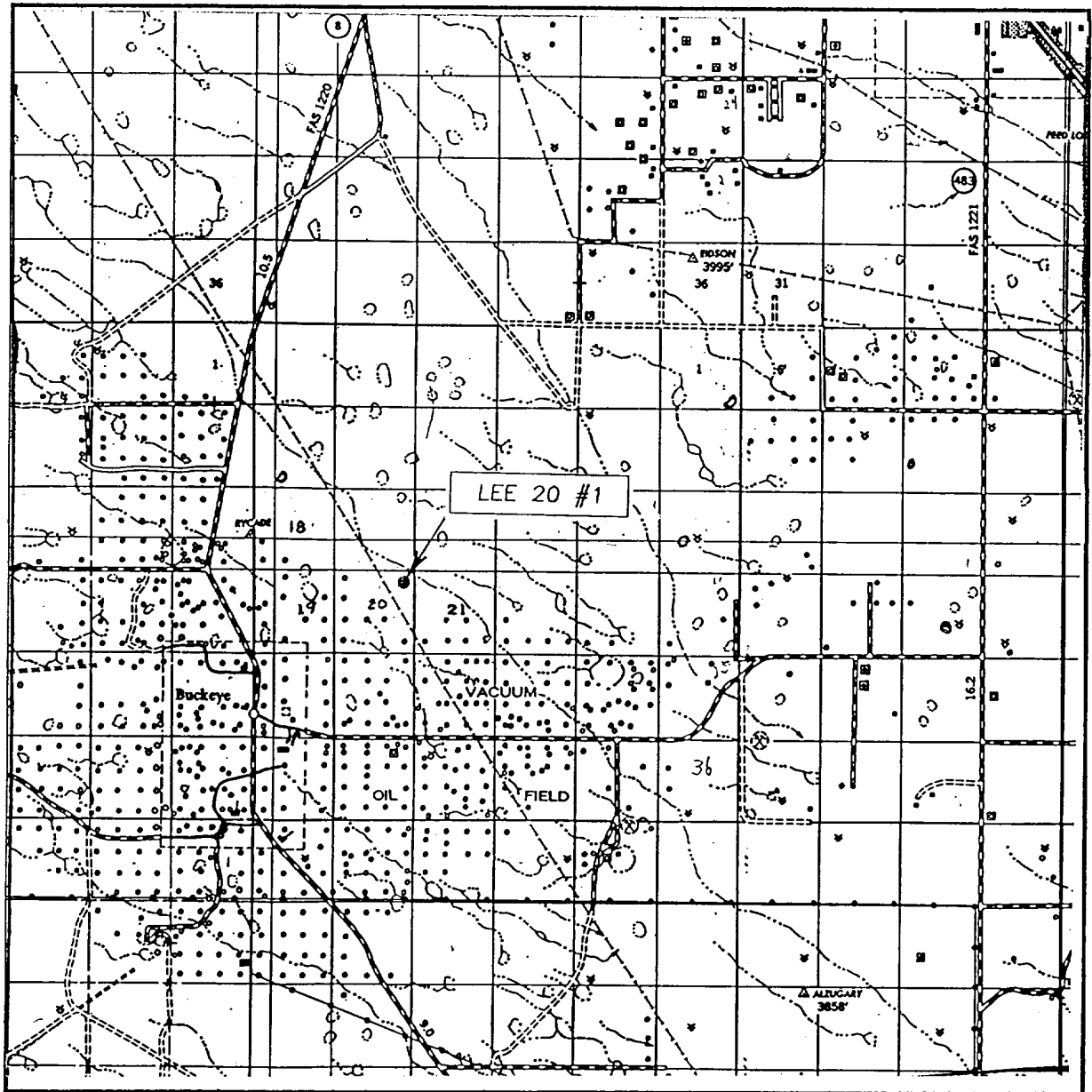

SCALE: 1" = 2 MILES

SEC. 20 TWP. 17-S RGE. 35-E

SURVEY N.M.P.M.

COUNTY LEA

DESCRIPTION 660' FNL & 660' FEL

ELEVATION 3968'

OPERATOR CHESAPEAKE OPERATING, INC.

LEASE LEE 20

JOHN WEST SURVEYING  
HOBBS, NEW MEXICO  
(505) 393-3117

# LOCATION VERIFICATION MAP

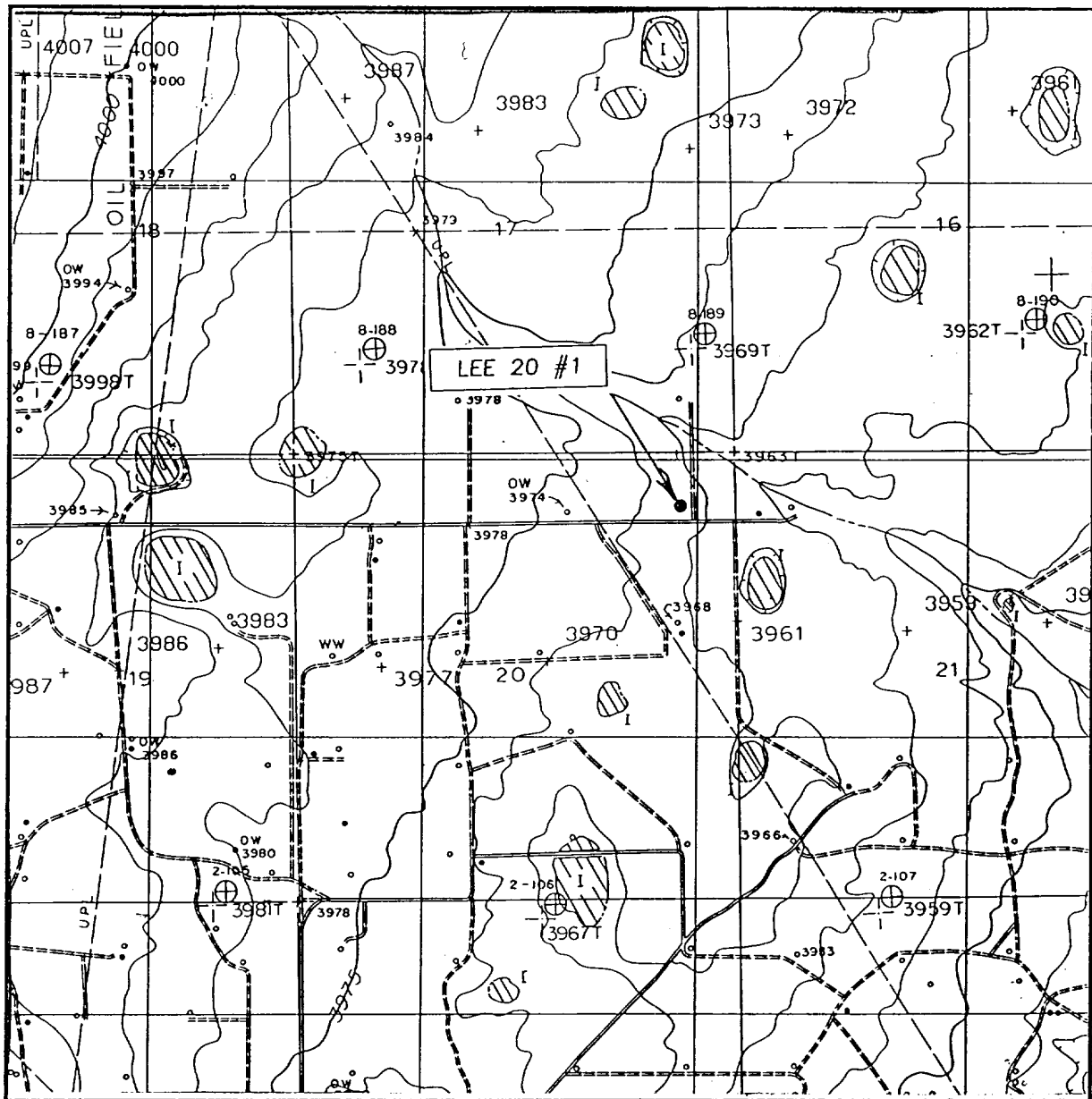

SCALE: 1" = 2000'

CONTOUR INTERVAL: 5'  
LOVINGTON SW, N.M.

SEC. 20 TWP. 17-S RGE. 35-E

SURVEY N.M.P.M.

COUNTY LEA

DESCRIPTION 660' FNL & 660' FEL

ELEVATION 3968'

OPERATOR CHESAPEAKE OPERATING, INC.

LEASE LEE 20

U.S.G.S. TOPOGRAPHIC MAP  
LOVINGTON SW, N.M.

**JOHN WEST SURVEYING**  
**HOBBS, NEW MEXICO**  
**(505) 393-3117**

BLOWOUT PREVENTOR SCHEMATIC  
CHESAPEAKE OPERATING INC

WELL : Lee 1-20

FIELD : Vacuum North Atoka Morrow

RIG : Tmbr/Shrp 24

COUNTY : Lea

OPERATION: Drill out below 8-5/8" Casing

STATE: New Mexico

	SIZE	PRESSURE	DESCRIPTION
A	11"	500#	Rot Head
B	11"	5,000#	Annular
C	11"	5,000#	Pipe Rams
D	11"	5,000#	Blind Rams
E	11"	5,000#	Mud Cross
B-Sec	11" 3M x 11" 5M		
A-Sec	13-5/8" SOW x 11" 3M		

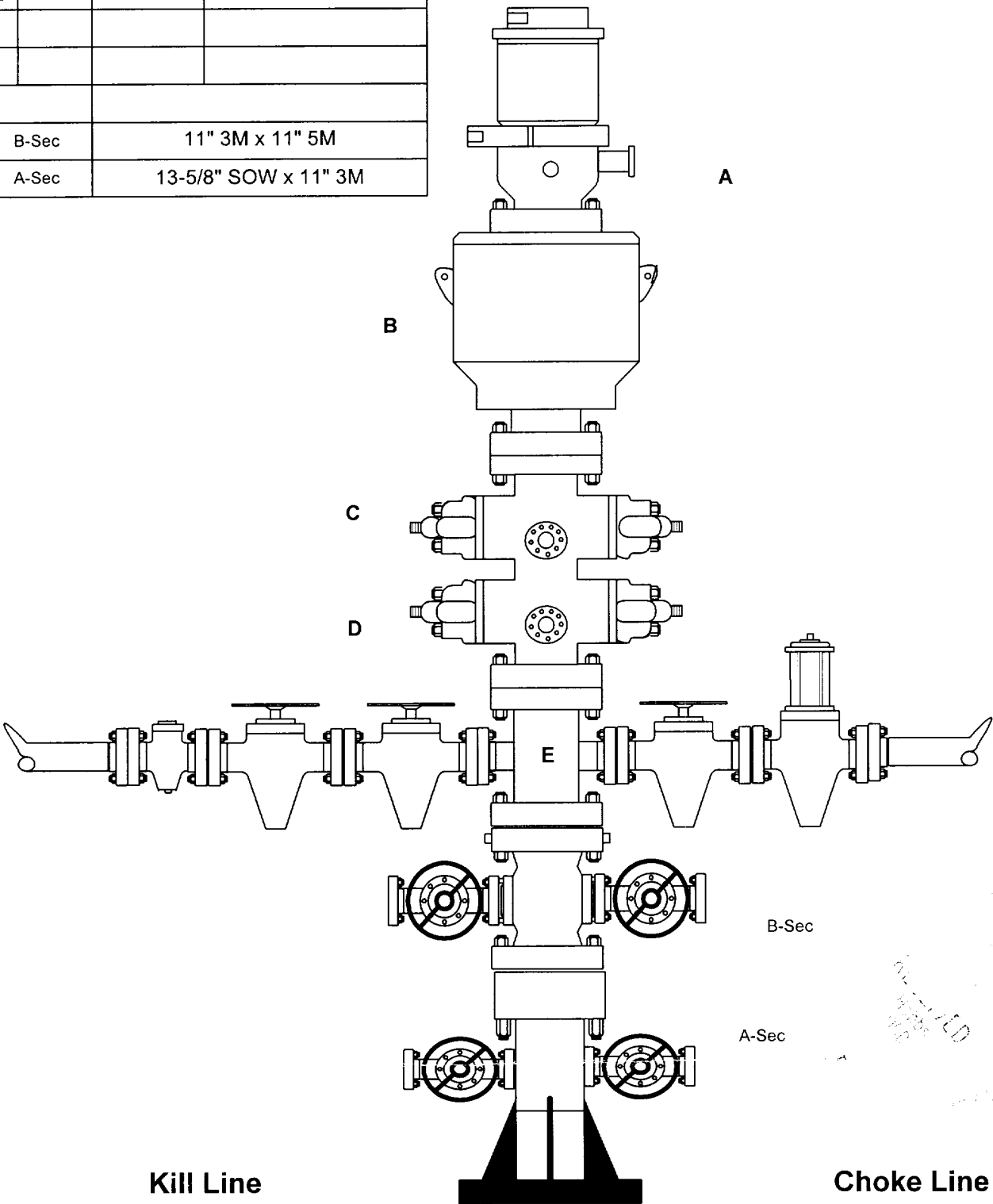

SIZE	PRESSURE	DESCRIPTION
2"	5,000#	Check Valve
2"	5,000#	Gate Valve
2"	5,000#	Gate Valve

SIZE	PRESSURE	DESCRIPTION
4"	5,000#	Gate Valve
4"	5,000#	HCR Valve

**KELLAHIN AND KELLAHIN**

ATTORNEYS AT LAW

EL PATIO BUILDING

117 NORTH GUADALUPE

POST OFFICE BOX 2265

SANTA FE, NEW MEXICO 87504-2265

TELEPHONE (505) 982-4285

TELEFAX (505) 982-2047

W. THOMAS KELLAHIN\*

\*NEW MEXICO BOARD OF LEGAL SPECIALIZATION  
RECOGNIZED SPECIALIST IN THE AREA OF  
NATURAL RESOURCES-OIL AND GAS LAW

JASON KELLAHIN (RETIRED 1991)

November 8, 2001

**FEDERAL EXPRESS**

Mr. Chris Williams, Supervisor  
Oil Conservation Division  
1625 N. French Drive  
Hobbs, New Mexico 88240

Re: Lee "20" Well No. 1  
Application for Permit to Drill  
Chesapeake Operating, Inc.  
Unit A Section 20, T17S, R35E  
Lea County, New Mexico

Dear Mr. Williams:

On behalf of Chesapeake Operating, Inc. and at their request, I have reviewed and now forward for your processing the enclosed application for approval to drill this well.

My research indicates that the Atoka/Morrow formation at this location is a standard well location and is within one mile of the North Vacuum Atoka/Morrow Gas Pool (Section 19) which is governed by Division's General Rule 104.

Please call me if you have any questions.

Very truly yours,

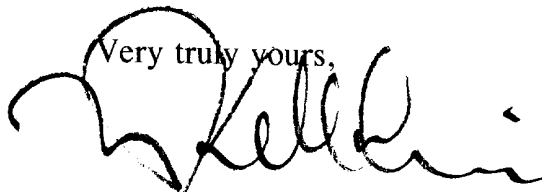

W. Thomas Kellahin

cc: Chesapeake Operating, Inc.  
Attn: Lynda Townsend  
phone (405) 848.8000 (ext 414)

RECEIVED  
Hobbs  
OCC