

SECTION 9, TOWNSHIP 17 S, TH, RANGE 35 EAST, NMPM, LEA COUNTY, NEW MEXICO.

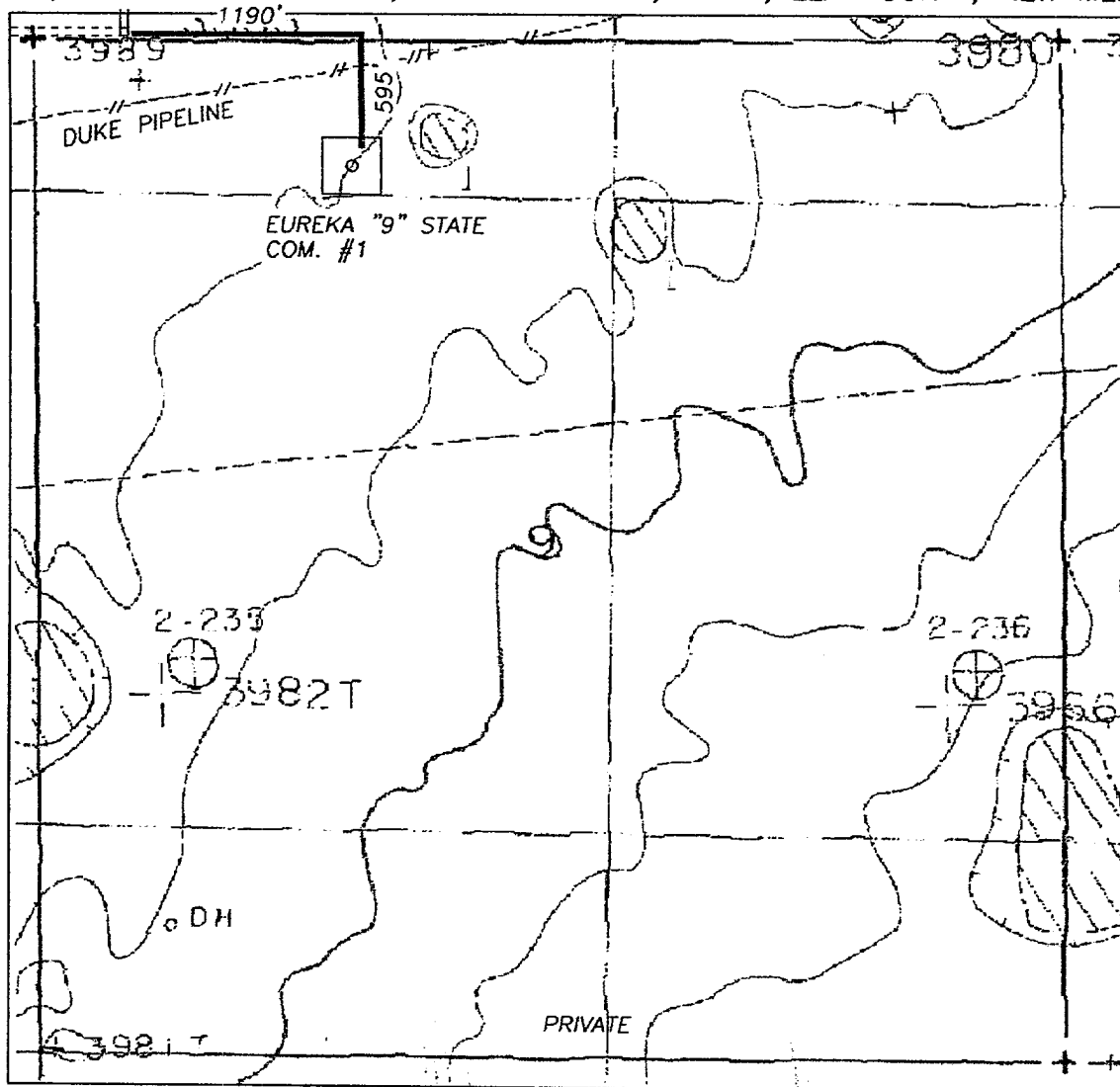

DEC 2002
RECEIVED
Hobbs
OCD

1000' 0 1000' 2000'
Scale 1" = 1000'

THE PREPARATION OF THIS PLAT AND THE PERFORMANCE OF THE SURVEY UPON WHICH IT IS BASED WERE DONE UNDER MY DIRECTION AND THE PLAT ACCURATELY DEPICTS THE RESULTS OF SAID SURVEY AND MEET THE REQUIREMENTS OF THE STANDARDS FOR LAND SURVEYS IN NEW MEXICO AS ADOPTED BY THE NEW MEXICO STATE BOARD OF REGISTRATION FOR PROFESSIONAL ENGINEERS AND LAND SURVEYORS.

HERSCHEL L. JONES, R.L.S. No. 3640

GENERAL SURVEYING COMPANY P.O. BOX 1928
LOVINGTON, NEW MEXICO 88260

MEWBOURNE OIL COMPANY

LEASE ROAD TO ACCESS THE MEWBOURNE EUREKA "9" STATE COM. #1 WELL, LOCATED IN SECTION 9, TOWNSHIP 17 SOUTH, RANGE 35 EAST, NMPM, LEA COUNTY, NEW MEXICO.

Survey Date: 12/11/2002	Sheet 1 of 1 Sheets
Drawn By: Ed Blevins	W.O. Number
Date: 12/11/02	Scale 1" = 1000' EUREKA 9-1