

NEW MEXICO OIL CONSERVATION COMMISSION  
Well Location and Acreage Dedication Plat

Section A.

Date 12-12-60

Operator The Ohio Oil Company Lease Lea Unit  
Well No. 1 Unit Letter L Section 12 Township 20 S Range 34 E NMPM  
Located 1980 Feet From South Line, 660 Feet From West Line  
County Lea G. L. Elevation 3656 Dedicated Acreage 80 Acres  
Name of Producing Formation Devonian Pool Lea Devonian

1. Is the Operator the only owner\* in the dedicated acreage outlined on the plat below?  
Yes \_\_\_\_\_ No X.
2. If the answer to question one is "no," have the interests of all the owners been consolidated by communitization agreement or otherwise? Yes X No \_\_\_\_\_. If answer is "yes," Type of Consolidation Unitization Agreement
3. If the answer to question two is "no," list all the owners and their respective interests below:

Owner

Land Description

Section B

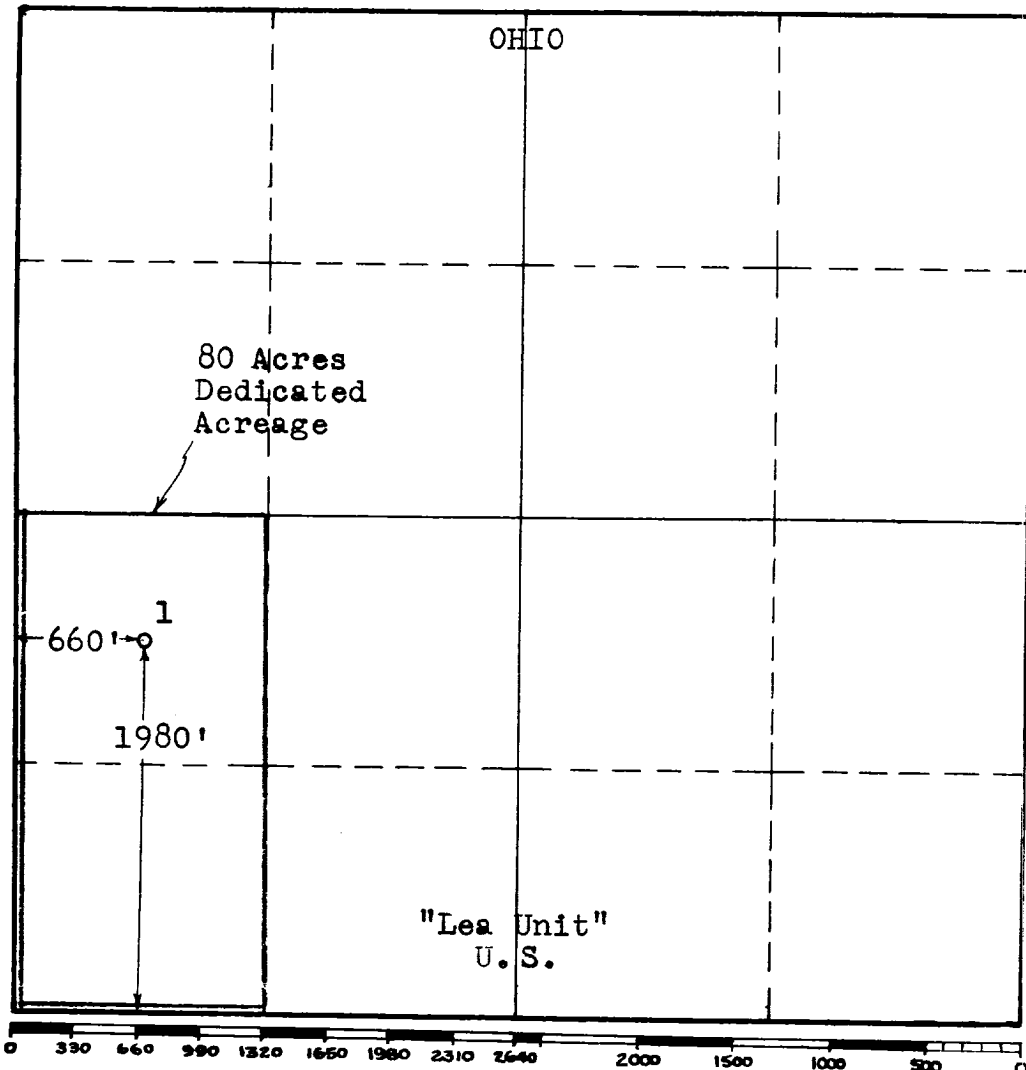

This is to certify that the information in Section A above is true and complete to the best of my knowledge and belief.

The Ohio Oil Company

(Operator)

[Signature]  
(Representative)

Box 2107, Hobbs, N. Mex.  
Address

This is to certify that the well location shown on the plat in Section B was plotted from field notes of actual surveys made by me or under my supervision and that the same is true and correct to the best of my knowledge and belief.

Date Surveyed 11-20-59

/s/ John W. West  
Registered Professional  
Engineer and/or Land Surveyor.

Certificate No. 676



INSTRUCTIONS FOR COMPLETION:

1. Operator shall furnish and certify to the information called for in Section A.
2. Operator shall outline the dedicated acreage for both oil and gas wells on the plat in Section B.
3. A registered professional engineer or land surveyor registered in the State of New Mexico or approved by the Commission shall show on the plat the location of the well and certify this information in the space provided.
4. All distances shown on the plat must be from the outer boundaries of Section.
5. If additional space is needed for listing owners and their respective interests as required in question 3, Section A, please use space below

\* "Owner" means the person who has the right to drill into and to produce from any pool and to appropriate the production either for himself or for himself and another. (65-3-29 (e) NMSA 1953 Comp.)



NEW MEXICO OIL CONSERVATION COMMISSION  
WELL LOCATION AND ACREAGE DEDICATION PLAT

FORM C-128  
Revised 5/1/57

SEE INSTRUCTIONS FOR COMPLETING THIS FORM ON THE REVERSE SIDE

SECTION A

Operator The Chio Oil Company		Lease Lea Unit		Well No. 1
Unit Letter L	Section 12	Township 20 S	Range 34 E	County Lea
Actual Footage Location of Well: 1980 feet from the South line and 660 feet from the West line				
Ground Level Elev. 3656	Producing Formation Devonian	Pool Lea Devonian	Dedicated Acreage: 160 Acres	

1. Is the Operator the only owner in the dedicated acreage outlined on the plat below? YES \_\_\_\_\_ NO X . ("Owner" means the person who has the right to drill into and to produce from any pool and to appropriate the production either for himself or for himself and another. (65-3-29 (e) NMSA 1935 Comp.)
2. If the answer to question one is "no," have the interests of all the owners been consolidated by communitization agreement or otherwise? YES X NO \_\_\_\_\_. If answer is "yes," Type of Consolidation Unitization Agreement
3. If the answer to question two is "no," list all the owners and their respective interests below:

Owner	Land Description

SECTION B

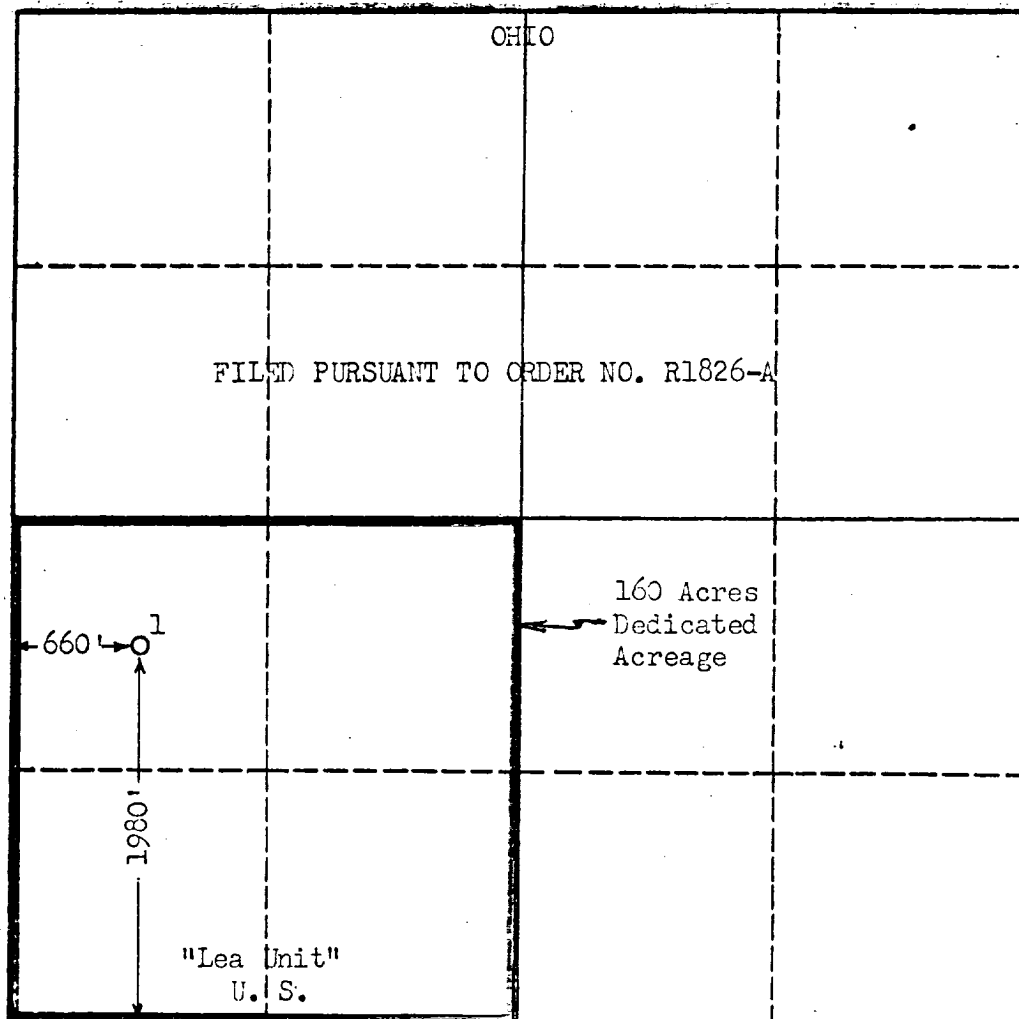

CERTIFICATION

I hereby certify that the information in SECTION A above is true and complete to the best of my knowledge and belief.

*T. O. Webb*  
Name  
T. O. Webb  
Position  
Area Petroleum Engineer  
Company  
The Chio Oil Company  
Date  
1-1-62

I hereby certify that the well location shown on the plat in SECTION B was plotted from field notes of actual surveys made by me or under my supervision, and that the same is true and correct to the best of my knowledge and belief.

Date Surveyed  
11-20-59  
Registered Professional Engineer  
and/or Land Surveyor  
*/s/ John W. West*

Certificate No. 676

0 330 660 990 1320 1650 1980 2310 2640 2000 1500 1000 500 0



NEW MEXICO OIL CONSERVATION COMMISSION

Well Location and Acreage Dedication Plat

Section A.

Date 12-12-60

Operator The Ohio Oil Company Lease Lea Unit  
Well No. 1 Unit Letter L Section 12 Township 20 S Range 34 E NMPM  
Located 1980 Feet From South Line, 660 Feet From West Line  
County Lea G. L. Elevation 3656 Dedicated Acreage 80 Acres  
Name of Producing Formation Bone Springs Pool Lea Bone Springs

1. Is the Operator the only owner\* in the dedicated acreage outlined on the plat below?  
Yes \_\_\_\_\_ No X.
2. If the answer to question one is "no," have the interests of all the owners been consolidated by communitization agreement or otherwise? Yes X No \_\_\_\_\_. If answer is "yes," Type of Consolidation Unitization Agreement
3. If the answer to question two is "no," list all the owners and their respective interests below:

Owner

Land Description

Section B

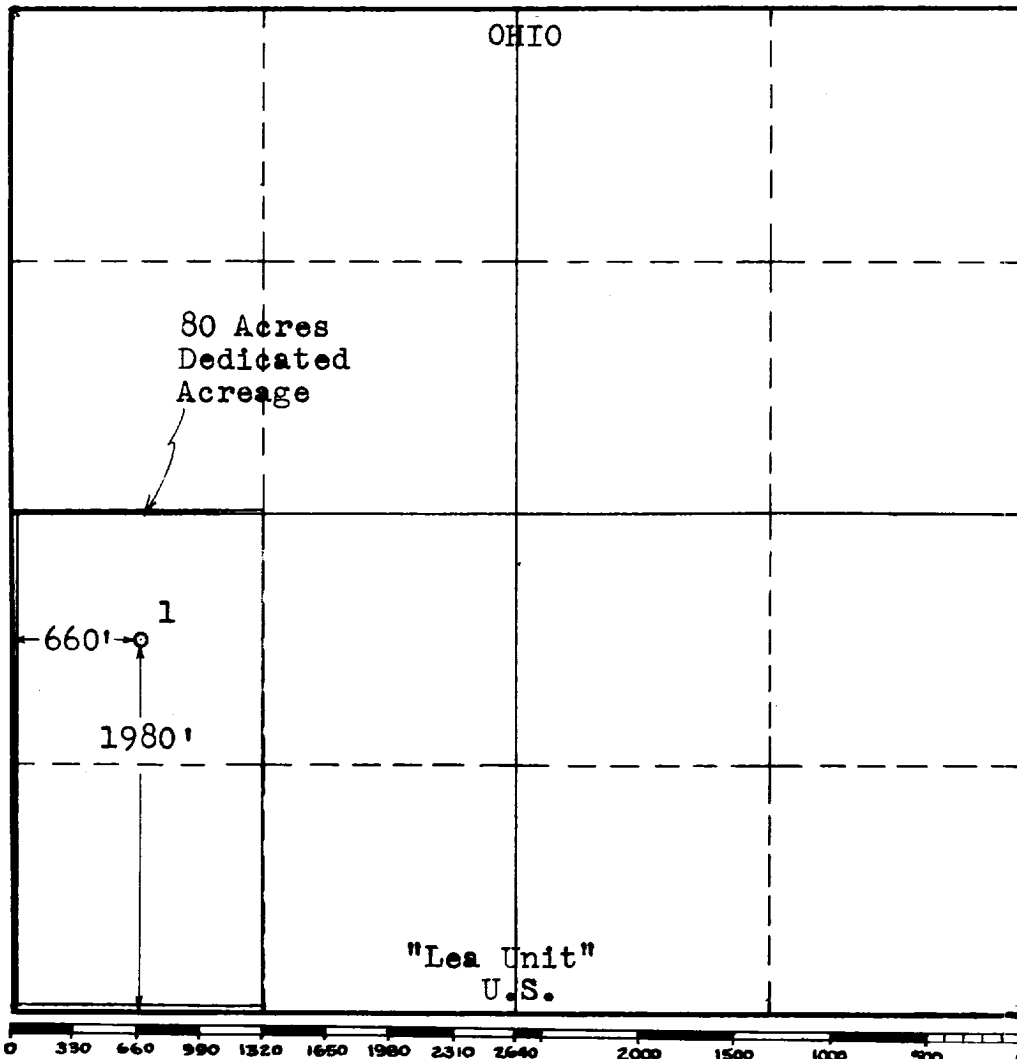

This is to certify that the information in Section A above is true and complete to the best of my knowledge and belief.

The Ohio Oil Company

(Operator)

[Signature]  
(Representative)

Box 2107, Hobbs, N. Mex.  
Address

This is to certify that the well location shown on the plat in Section B was plotted from field notes of actual surveys made by me or under my supervision and that the same is true and correct to the best of my knowledge and belief.

Date Surveyed 11-20-59

/s/ John W. West  
Registered Professional  
Engineer and/or Land Surveyor.

Certificate No. 676



INSTRUCTIONS FOR COMPLETION:

1. Operator shall furnish and certify to the information called for in Section A.
2. Operator shall outline the dedicated acreage for both oil and gas wells on the plat in Section B.
3. A registered professional engineer or land surveyor registered in the State of New Mexico or approved by the Commission shall show on the plat the location of the well and certify this information in the space provided.
4. All distances shown on the plat must be from the outer boundaries of Section.
5. If additional space is needed for listing owners and their respective interests as required in question 3, Section A, please use space below

\* "Owner" means the person who has the right to drill into and to produce from any pool and to appropriate the production either for himself or for himself and another. (65-3-29 (e) NMSA 1953 Comp.)