

UNITED STATES
DEPARTMENT OF THE INTERIOR
BUREAU OF LAND MANAGEMENT

SUBMIT IN TRIPLICATE
(Other instructions on reverse side)

Report Form No. 1004-101
Expires August 31, 1985

LEASE DESIGNATION AND SERIAL NO.

NM 02127-B

IF INDIAN, ALLOTTEE OR TRIBE NAME

SUNDRY NOTICES AND REPORTS ON WELLS

(Do not use this form for proposals to drill or to deepen or plug back to a different reservoir. Use "APPLICATION FOR PERMIT" for such proposals.)

1. WELL <input checked="" type="checkbox"/> GAS WELL <input type="checkbox"/> OTHER <input type="checkbox"/>	7. UNIT AGREEMENT NAME Lea Unit
2. NAME OF OPERATOR Marathon Oil Company	8. FARM OR LEASE NAME Lea Unit
3. ADDRESS OF OPERATOR P. O. Box 552, Midland, Texas 79702	9. WELL NO. 7
4. LOCATION OF WELL (Report location clearly and in accordance with any State requirements. See also space 17 below.) At surface Unit N, 660' FSL and 1980' FWL	10. FIELD AND POOL OR WILDCAT Lea - San Andres
11. PERMIT NO.	11. SEC., T., R., M., OR BLK. AND SURVEY OR AREA Sec. 12, T-20-S, R-34-E
12. ELEVATIONS (Show whether DF, RT, GR, etc.) GR: 3657' KB: 3678'	12. COUNTY OR PARISH Lea
	13. STATE N. Mexico

Check Appropriate Box To Indicate Nature of Notice, Report, or Other Data

NOTICE OF INTENTION TO:

TEST WATER SHUT-OFF	<input type="checkbox"/>	PULL OR ALTER CASING	<input type="checkbox"/>
FRAC TREAT	<input type="checkbox"/>	MULTIPLE COMPLETE	<input type="checkbox"/>
SHOOTING OR ACIDIZING	<input type="checkbox"/>	ABANDON*	<input type="checkbox"/>
SPILL WELL	<input type="checkbox"/>	CHANGE LEASE	<input type="checkbox"/>

SUBSEQUENT REPORT OF:

WATER SHUT-OFF	<input type="checkbox"/>	REPAIRING WELL	<input type="checkbox"/>
FRAC TREATMENT	<input type="checkbox"/>	ALTERING CASING	<input type="checkbox"/>
SHOOTING OR ACIDIZING	<input type="checkbox"/>	ABANDONMENT*	<input type="checkbox"/>
Other	<input type="checkbox"/>		

Other: Recomplete in Bone Spring XX

NOTE: Report results of multiple completion on Well Completion or Recompletion Report and Log form.

17. (For multiple completion or recompletion only.) Clearly state all pertinent details, and give pertinent dates, including estimated date of starting any proposed work. If well is directionally drilled, give subsurface locations and measured and true vertical depths for all markers and zones pertinent to this work.*

Marathon Oil Company proposes to recomplete the Lea Unit Well No. 7 from the San Andres to the Bone Spring. A copy of the workover procedure and well diagram are attached. This work is scheduled to begin approximately May 18, 1987.

RECEIVED
MAY 14 1987
BUREAU OF LAND MANAGEMENT

18. I hereby certify that the foregoing is true and correct.

SIGNED <u>Linda S. C. R. [Signature]</u>	TITLE <u>Engineer</u>	DATE <u>May 12, 1987</u>
(This space for Federal or State office use) Orig. Sgd. Linda S. C. R. [Signature]		
APPROVED BY <u>Acting Area Manager</u>	TITLE <u></u>	DATE <u>5-18-87</u>
CONDITIONS OF APPROVAL, IF ANY:		

*See Instructions on Reverse Side

All distances must be from the outer boundaries of the Section.

Operator Marathon Oil Company			Lease Lea Unit		Well No. 7
Unit Letter N	Section 12	Township 20-S	Range 34-E	County Lea	
Actual Footage Location of Well:					
660 feet from the South line and		1980 feet from the West line			
Ground Level Elev. 3657'	Producing Formation Bone Spring	Pool Lea, SE		Dedicated Acreage: 80 Acres	

1. Outline the acreage dedicated to the subject well by colored pencil or hachure marks on the plat below.
2. If more than one lease is dedicated to the well, outline each and identify the ownership thereof (both as to working interest and royalty).
3. If more than one lease of different ownership is dedicated to the well, have the interests of all owners been consolidated by communitization, unitization, force-pooling, etc?

☒ Yes ☐ No If answer is "yes," type of consolidation Unitization

If answer is "no," list the owners and tract descriptions which have actually been consolidated. (Use reverse side of this form if necessary.)

No allowable will be assigned to the well until all interests have been consolidated (by communitization, unitization, forced-pooling, or otherwise) or until a non-standard unit, eliminating such interests, has been approved by the Division

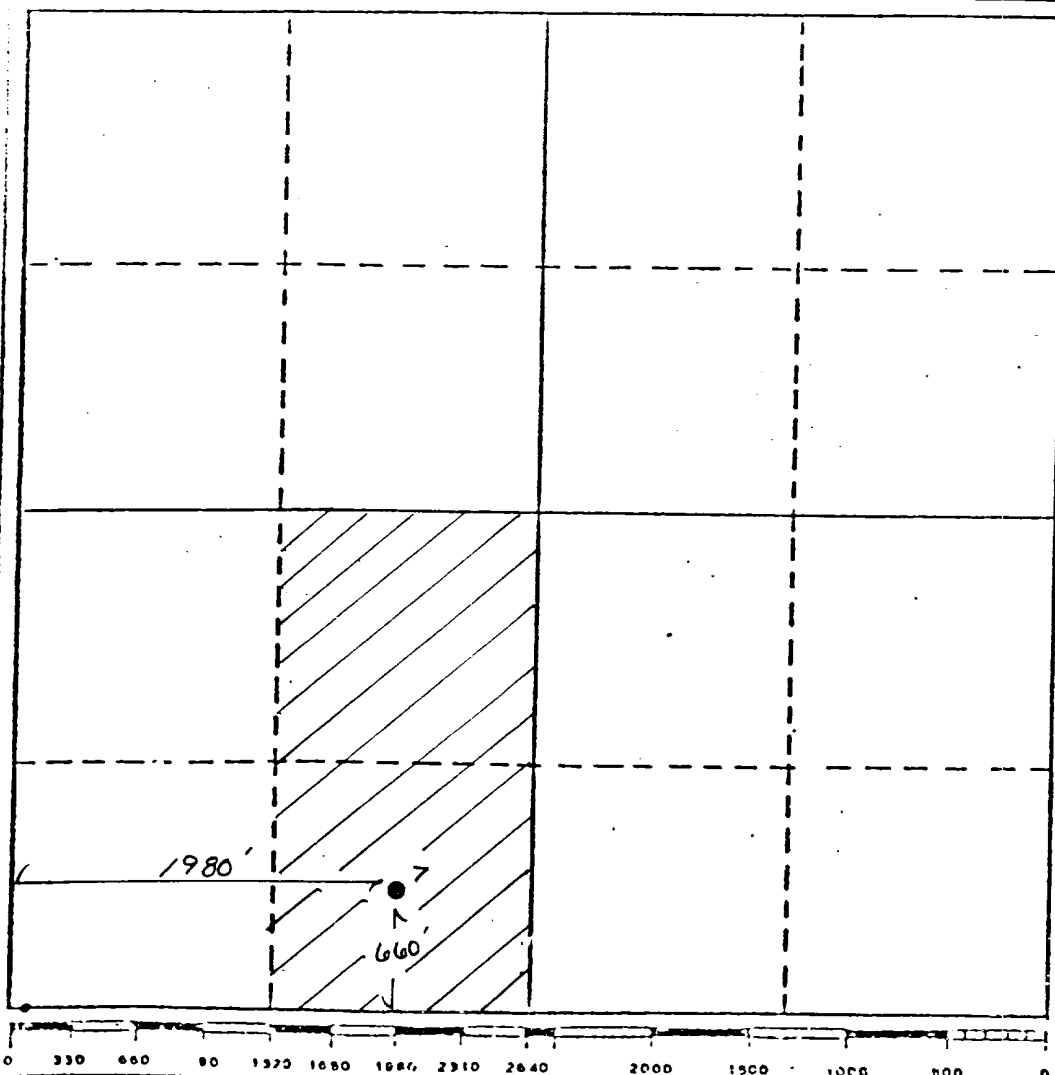

CERTIFICATION

I hereby certify that the information contained herein is true and complete to the best of my knowledge and belief.

Name
Position
Engineer
Company
Marathon Oil Company
Date
May 12, 1987

I hereby certify that the well location shown on this plat was plotted from field notes of actual surveys made by me or under my supervision, and that the same is true and correct to the best of my knowledge and belief.

Date Surveyed
Registered Professional Engineer and/or Land Surveyor
Certificate No.

RECOMPLETION PROCEDURE

Lea Unit No. 7

1. Move in and rig up pulling unit.
2. Kill well with brine water.
3. Pull out of hole with rods and pump.
4. Nipple up BOP's.
5. Pull out of hole with 2 7/8" tubing.
6. Run in hole with cement retainer on 2 7/8" tubing. Set retainer at 6160'.
7. Squeeze San Andres perforations per recommendation.
8. Pull out of hole with tubing.
9. WOC overnight.
10. Run in hole with 6" bit and 4 - 3 1/2" drill collars on 2 7/8" tubing.
11. Rig up reverse unit.
12. Drill out retainer and cement. Clean out hole to ±6300'.
13. Pressure test casing to 500 psi.
14. Drill cement out from 6300' - ±6410'. Clean out hole to 6500'.
15. Pressure test casing to 500 psi.
16. Cleanout hole to 9800'.
17. Rig down reverse unit.
18. Pull out of hole.
19. Perforate Bone Spring Sand at 9712'- 14', 9717'- 21', and 9724'- 26' with 1 JSPP.
20. Pick up and run in hole with RTTS packer on 3 1/2" workstring. Set packer at ±9660'.
21. Acidize and frac per recommendation. Shut-in overnight.
22. Pull out of hole.
23. Set RBP by wireline at ±9700'.
24. Perforate the Bone Spring Dolomite at 9671'-86' with 1 SPF.
25. Pick up and run in hole with RTTS packer on 3 1/2" workstring. Set packer at ±9620'.
26. Acidize Bone Spring Dolomite per recommendation.
27. Swab back load.
28. Pull out of hole.
29. Set RBP by wireline at 9650'.
30. Perforate the Bone Spring (Zone R) Dolomite at 9572'- 76', 9579'- 81', 9586'- 99', and 9601'- 03' with 1 SPF.
31. Pick up and run in hole with RTTS packer on 3 1/2" workstring. Set packer at ±9520'.

32. Acidize Zone "R" Dolomite per recommendation.
33. Swab back load.
34. Pull out of hole.
35. Set RBP by wireline at 9560'.
36. Perforate the Bone Spring (Zone Q) Sand at 9503'-05', 9508'- 10', 9513'- 16', 9521', 9531', 9535'- 38', 9543'- 46', 9549'.
37. Run in hole with RTTS packer on 3 1/2" tubing. Set packer at ±9450'.
38. Acidize and frac the Zone "Q" sand per recommendation. Shut-in overnight.
39. Pull out of hole with tubing and packer. Lay down 3 1/2" tubing.
40. Run in hole with 2 7/8" tubing. Reverse out fill to RBP at 9560'. Release RBP and pull out of hole.
41. Run in hole with 2 7/8" tubing. Reverse out fill to RBP @9650'. Release RBP and pull out of hole.
42. Run in hole with 2 7/8" tubing. Reverse out fill to RBP @ 9700'. Release RBP and pull out of hole.
43. Run in hole with 2 7/8" tubing. Anchor tubing at ±9725'.
44. Nipple down BOP's.
45. Run in hole with 1 1/4" insert pump, 2450'- .875" Class "D" rods and 7275' - .98" fiberglass rods.
46. Place well on production at 9 spm.

WELL DATA SHEET

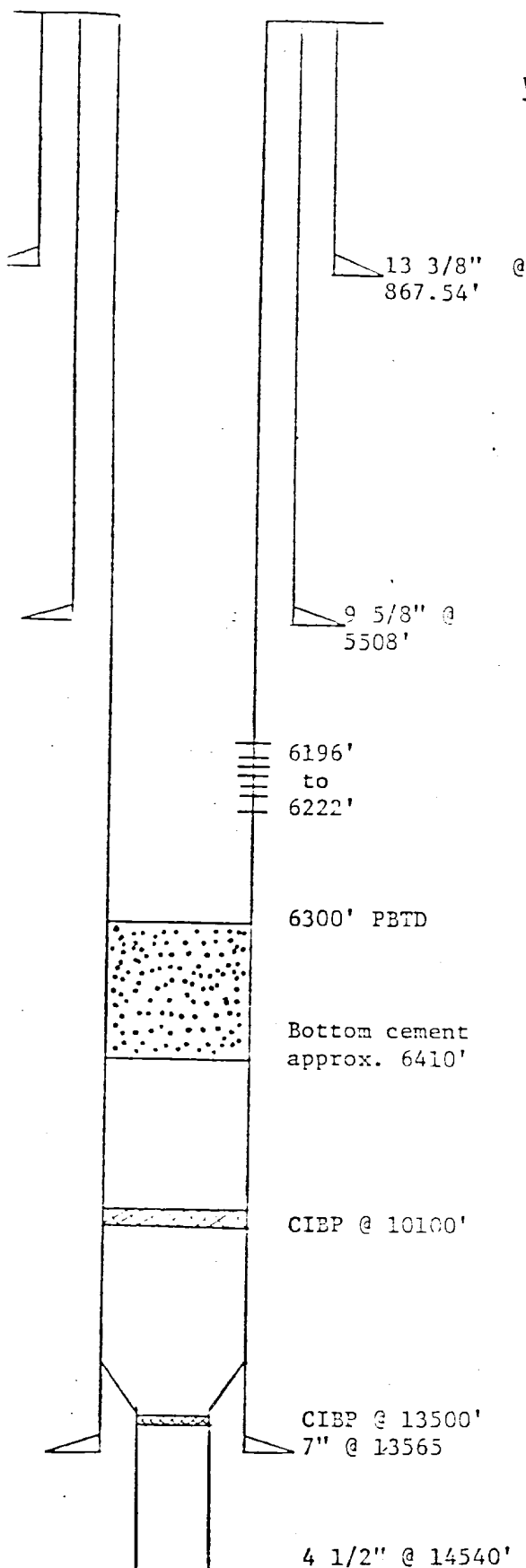

FIELD Lea

LEASE AND WELL NO. Lea Unit Well No. 7

LOCATION Sec. 12, T20S, R34E

COUNTY AND STATE Lea County, New Mexico

STATUS Pumping

TD 14540' PBTD 6300' GL 3678' KB 3657'

SURFACE CASING 13 3/8". 48# set at 867.54' cemented w/800 sx regular. cement circulated.

INTERMEDIATE CASING 9 5/8", 36# @ 5508' cemented 1st stage w/550 sx lite-wate cement followed by 200 sx regular. Cement circulated. Cemented 2nd stage w/1875 sx lite-wate followed by 100 sx regular. Cement circulate

PRODUCTION CASING 7", 29# set at 13565' cemented w/1200 sx inferro

LINER 4 1/2". 14.9#, P-110 liner at 13375' to 14540'

TUBING 2 7/8". 6.5#, STD. J55 to 6089.71' 194 its.

RODS 1 1/2" polish rod & 1 3/4" liner. 64 - 1" rods. 65 - 7/8" rods. 112 3/4" rods. 1 - 2 1/2 x 1 1/2" 24' pump

PUMPING UNIT Lufkin 320

PRESENT COMPLETION: (Formation and Interval)

Wildcat San Andres

6196' - 6222' w/2 JSPF (total 40 holes)

HISTORY 3/62 - Dual completed in Bone Spring & Morrow. IP - 204 BOPD & 3.6 MMCFPD

7/69 - Shut-in (Bone Spring depleted). 7/78 to 1/79 - Deepened to Devonian. IP - 24 BOPD & 516 BWPD by gas lift. 1/82 to 6/82 - Average daily well test 27.5 BOPD & 507 BWPD.

7/82 - Casing leak discovered and repaired. The leak was oil from the San Andres.

10/82 - Completed in San Andres for 59 BOPD, 70 BWPD, & 176 MCFGPD. 2/83 - Installed

rod pump. Potentialled 102 BOPD, 201 BWPD, & 51 MCFPD. 8/9/86 - Well test 5 BOPD, 97 BWPD & 15 MCFPD.

PREPARED BY: Allen S. Wilson
ASW2/71/dah

DATE September 11, 1986