

NEW MEXICO OIL CONSERVATION COMMISSION
Well Location and Acreage Dedication Plat

Section A.

Date March 25, 1958

Operator CABOT CARBON COMPANY Lease State of New Mexico "G"
 Well No. 1 Unit Letter L Section 28 Township 19 South Range 35 East (NMPM)
 Located 1980 Feet From South Line, 660 Feet From West Line
 County Lea G. L. Elevation 3731 Dedicated Acreage 4.25 Acres
 Name of Producing Formation Queen Pool LINDSEY

1. Is the Operator the only owner* in the dedicated acreage outlined on the plat below?
 Yes No
2. If the answer to question one is "no," have the interests of all the owners been consolidated by communitization agreement or otherwise? Yes No . If answer is "yes," Type of Consolidation _____
3. If the answer to question two is "no," list all the owners and their respective interests below:

Owner

Land Description

<u>Owner</u>	<u>Land Description</u>

Section B

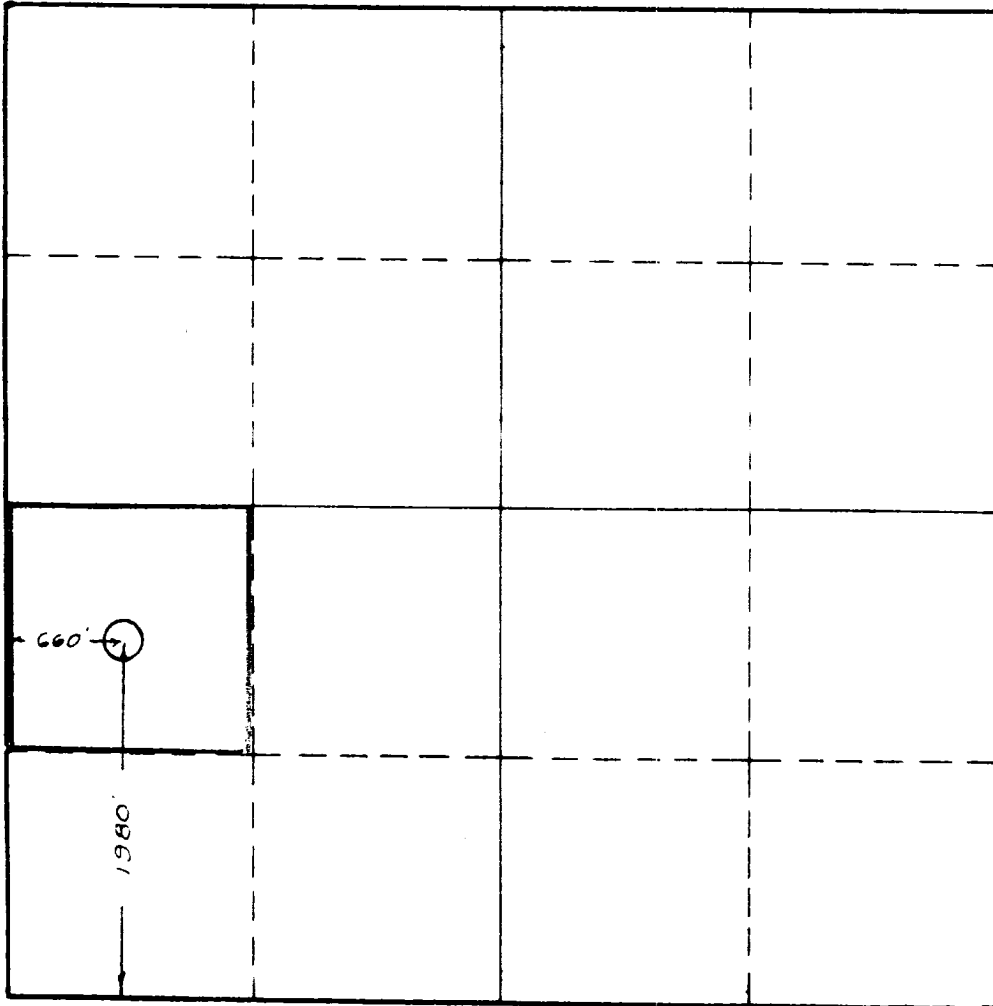

This is to certify that the information in Section A above is true and complete to the best of my knowledge and belief.

Cabot Carbon Company
 (Operator)

Percy C. Quinn
 (Representative)

Box 4395, Midland, Texas
 Address

This is to certify that the well location shown on the plat in Section B was plotted from field notes of actual surveys made by me or under my supervision and that the same is true and correct to the best of my knowledge and belief.

Date Surveyed March 19, 1958

B. W. Keane
 Registered Professional
 Engineer and/or Land Surveyor.

