

NEW MEXICO OIL CONSERVATION COMMISSION  
Santa Fe, New Mexico

Form G-101  
Revised (12/1/55)

NOTICE OF INTENTION TO DRILL

Notice must be given to the District Office of the Oil Conservation Commission and approval obtained before drilling or recompletion begins. If changes in the proposed plan are considered advisable, a copy of this notice showing such changes will be returned to the sender. Submit this notice in QUINTUPLICATE. One copy will be returned following approval. See additional instructions in Rules and Regulations of the Commission. If State Land submit 6 Copies Attach Form G-128 in triplicate to first 3 copies of form G-101

P. O. Box 4395, Midland, Texas  
(Place)

June 20, 1958  
(Date)

OIL CONSERVATION COMMISSION  
SANTA FE, NEW MEXICO

Gentlemen:

You are hereby notified that it is our intention to commence the Drilling of a well to be known as

Cabot Carbon Company  
(Company or Operator)

State of New Mexico "G"  
(Lease)

Well No. 6, in 0 The well is located 1980 feet from the East line and 660 feet from the South line of Section 28, T. 19-S, R. 35-E, NMPM. (GIVE LOCATION FROM SECTION LINE) Pearl Queen Pool, Lea County

If State Land the Oil and Gas Lease is No. E-8183 - E-8184

If patented land the owner is

Address

We propose to drill well with drilling equipment as follows: Rotary

The status of plugging bond is Approved

Drilling Contractor Robinson Bros.  
122 Allen Building, Midland, Texas

We intend to complete this well in the Queen Sand formation at an approximate depth of 5,000 feet.

CASING PROGRAM

We propose to use the following strings of Casing and to cement them as indicated:

Size of Hole	Size of Casing	Weight per Foot	New or Second Hand	Depth	Sacks Cement
12"	8-5/8"	24#	New	325	300
7-7/8"	5-1/2"	15.50#	New	5,000	200

If changes in the above plans become advisable we will notify you immediately.

ADDITIONAL INFORMATION (If recompletion give full details of proposed plan of work.)

Approved \_\_\_\_\_, 19\_\_\_\_  
Except as follows:

OIL CONSERVATION COMMISSION

By \_\_\_\_\_

Sincerely yours,

Cabot Carbon Company  
(Company or Operator)

By Percy C. O'Quinn TF

Position Dist. Prod. Supt.  
Send Communications regarding well to

Name Percy C. O'Quinn  
Address Box 4395, Midland, Texas

NEW MEXICO OIL CONSERVATION COMMISSION  
Well Location and Acreage Dedication Plat

Section A.

Date June 18, 1958

Operator Cabot Carbon Co. (Oil Division) Lease New Mexico State "G"  
Well No. 6 Unit Letter 0 Section 28 Township 19 South Range 35 East N.M.M.S.  
Located 660' Feet From South Line, 1,980' Feet From East Line  
County Lee G. L. Elevation 3,717' Dedicated Acreage 10 Acres  
Name of Producing Formation Queen Pool Pearl

1. Is the Operator the only owner\* in the dedicated acreage outlined on the plat below?  
Yes x No \_\_\_\_\_.
2. If the answer to question one is "no," have the interests of all the owners been consolidated by communitization agreement or otherwise? Yes \_\_\_\_\_ No \_\_\_\_\_. If answer is "yes," Type of Consolidation \_\_\_\_\_
3. If the answer to question two is "no," list all the owners and their respective interests below:

Owner

Land Description

Section B

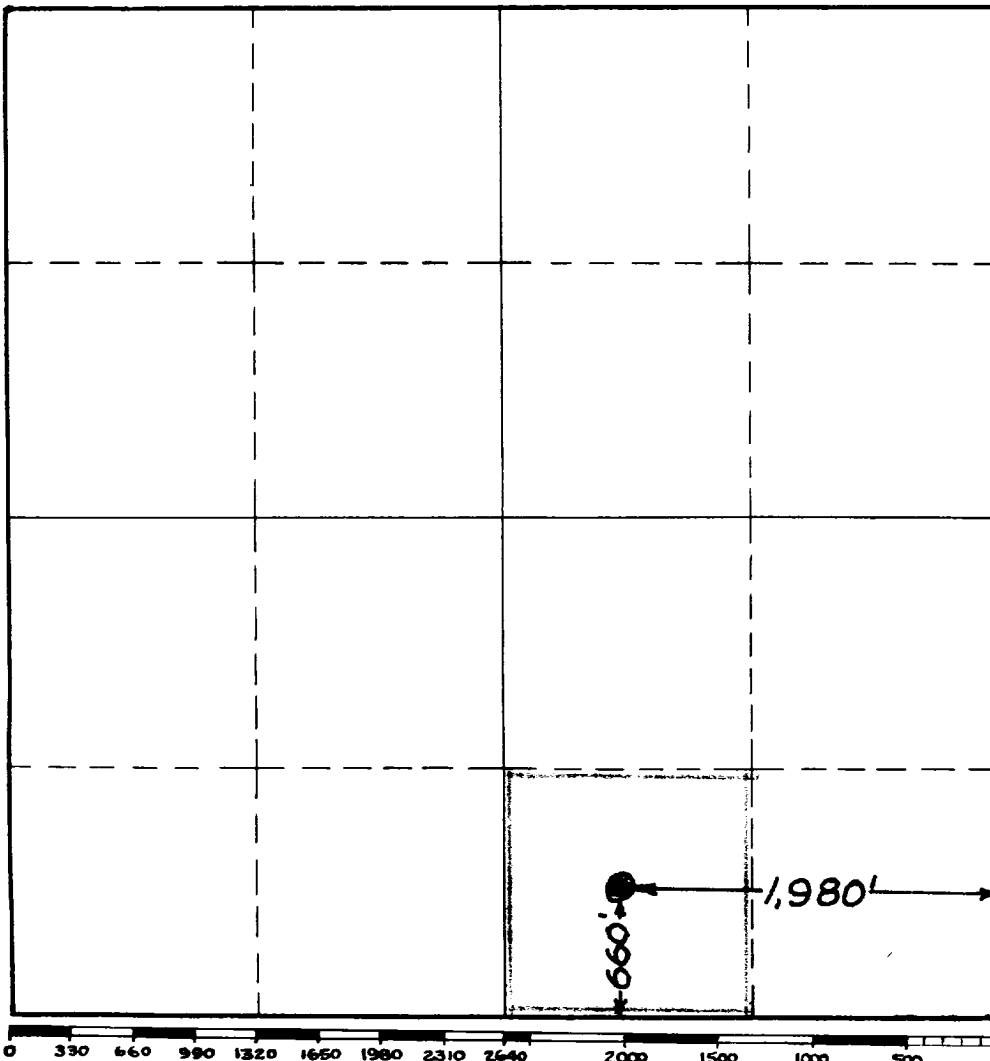

This is to certify that the information in Section A above is true and complete to the best of my knowledge and belief.

Cabot Carbon Company  
(Operator)

Leroy C. Ogilvie, Jr.  
(Representative)

Box 1395, Midland, Texas  
Address

This is to certify that the well location shown on the plat in Section B was plotted from field notes of actual surveys made by me or under my supervision and that the same is true and correct to the best of my knowledge and belief.

Date Surveyed June 18, 1958

Wayne R. Bright  
Registered Professional  
Engineer and/or Land Surveyor.

Certificate No. 3069

INSTRUCTIONS FOR COMPLETION

1. Operator shall furnish and certify to the information called for in Section A.
2. Operator shall outline the dedicated acreage for both oil and gas wells on the plat in Section B.
3. A registered professional engineer or land surveyor registered in the State of New Mexico or approved by the Commission shall show on the plat the location of the well and certify this information in the space provided.
4. All distances shown on the plat must be from the outer boundaries of Section.
5. If additional space is needed for listing owners and their respective interests as required in question 3, Section A, please use space below

\* "Owner" means the person who has the right to drill into and to produce from any pool and to appropriate the production either for himself or for himself and another. (65-3-29 (e) NMSA 1953 Comp.)