

## NOTICE OF INTENTION TO DRILL

Notice must be given to the District Office of the Oil Conservation Commission and approval obtained before drilling or recompletion begins. If changes in the proposed plan are considered advisable, a copy of this notice showing such changes will be returned to the sender. Submit this notice in QUINTUPLICATE. One copy will be returned following approval. See additional instructions in Rules and Regulations of the Commission. If State Land submit 6 Copies Attach Form G- 128 in triplicate to first 3 copies of form G-101

Cactus Drilling Company

6-2-57

(Place)

(Date)

OIL CONSERVATION COMMISSION  
SANTA FE, NEW MEXICO

Gentlemen:

You are hereby notified that it is our intention to commence the Drilling of a well to be known as  
Cactus Drilling Company

(Company or Operator)

Half-Section 10

(Lease)

Well No. 1, in 11

(Unit)

located 300 feet from the West line and 300 feet from the

line of Section 30, T. 1, R. 30, NMPM.

(GIVE LOCATION FROM SECTION LINE)

Pool, 100 County

If State Land the Oil and Gas Lease is No. 1-1007

If patented land the owner is

Address

We propose to drill well with drilling equipment as follows: Rotary tools to 1000, cable tools to 1000.

The status of plugging bond is 1000 and enforce

Drilling Contractor 1000

We intend to complete this well in the 1000 formation at an approximate depth of 1000 feet.

### CASING PROGRAM

We propose to use the following strings of Casing and to cement them as indicated:

Size of Hole	Size of Casing	Weight per Foot	New or Second Hand	Depth	Sacks Cement
17"	15 3/4"	10	New	Approx. 100'	1-1000
11"	9 5/8"	14	Used	Approx. 100'	1-1000
8 1/2"	7 1/8"	15.5	Used	Approx. 500'	300

If changes in the above plans become advisable we will notify you immediately.

ADDITIONAL INFORMATION (If recompletion give full details of proposed plan of work.)

Approved \_\_\_\_\_, 19\_\_\_\_  
Except as follows:

Sincerely yours,

Cactus Drilling Company

(Company or Operator)

By George Parker

Position \_\_\_\_\_  
Send Communications regarding well to

Name \_\_\_\_\_

Address \_\_\_\_\_

OIL CONSERVATION COMMISSION

By John W. Runyan

**NEW MEXICO OIL CONSERVATION COMMISSION**  
**WELL LOCATION AND ACREAGE DEDICATION PLAT**

FORM C-128  
 Revised 5-1-57

**SEE INSTRUCTIONS FOR COMPLETING THIS FORM ON THE REVERSE SIDE**

**SECTION A**

Operator <b>Cactus Drilling Co.</b>		Lease <b>Oil &amp; Gas Lease</b>		Well No. <b>1</b>
Unit Letter <b>M</b>	Section <b>31</b>	Township <b>19 S.</b>	Range <b>10 E.</b>	County <b>Dea</b>
Actual Footage Location of Well: <b>330</b> feet from the <b>001 E</b> line and <b>220</b> feet from the <b>011</b> line				
Ground Level Elev. <b>3735.9</b>	Producing Formation <b>Queen</b>	Pool <b>Undesignated</b>		Dedicated Acreage <b>40</b> Acres

1. Is the Operator the only owner in the dedicated acreage outlined on the plat below? YES ☒ NO ☐ "Owner" means the person who has the right to drill into and to produce from any pool and to appropriate the production either for himself or for himself and another. (65-3-29 (e) NMSA 1935 Comp.)
2. If the answer to question one is "no," have the interests of all the owners been consolidated by communitization agreement or otherwise? YES ☐ NO ☐ If answer is "yes," Type of Consolidation \_\_\_\_\_
3. If the answer to question two is "no," list all the owners and their respective interests below:

Owner	Land Description

**SECTION B**

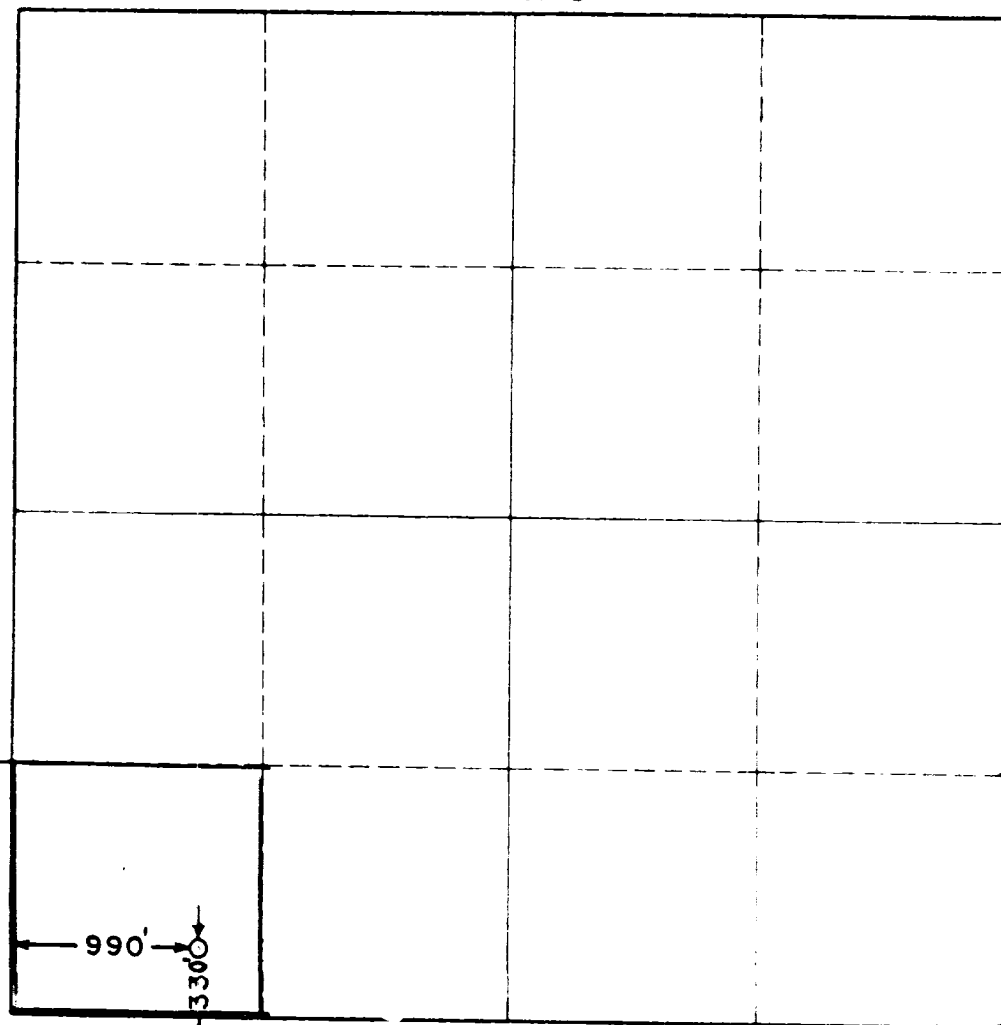

**CERTIFICATION**

I hereby certify that the information in SECTION A above is true and complete to the best of my knowledge and belief.

*George J. Baker*  
 Name

**Vice-President**  
 Position

**Cactus Drilling Co.**  
 Company

**6-22-59**  
 Date

Date

I hereby certify that the well location shown on the plat in SECTION B was plotted from field notes of actual surveys made by me or under my supervision, and that the same is true and correct to the best of my knowledge and belief.

Date Surveyed

**June 1, 1959**

Registered Professional Engineer  
 and or Land Surveyor, **JOHN W. WEST**

*John W. West*  
 Signature

Certificate No.  
**N.M. - P.E. B.L.S. NO. 676**

0 330 660 990 1320 1650 1980 2310 2640 2970 3300 3630 3960 4290 4620 4950 5280 5610 5940 6270 6600