

R-35-E

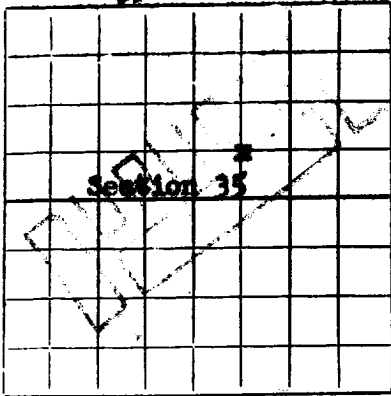

AREA 640 ACRES  
LOCATE WELL CORRECTLY

NEW MEXICO OIL CONSERVATION COMMISSION

Santa Fe, New Mexico

DEC 11 AM 9 20  
WELL RECORD

Mail to District Office, Oil Conservation Commission, to which Form C-101 was sent not later than twenty days after completion of well. Follow instructions in Rules and Regulations of the Commission. Submit in QUINTUPLICATE. If State Land submit 6 Copies

Shell Oil Company  
(Company or Operator)

Record  
(Lease)

Well No. 2, in SW 1/4 of NE 1/4, of Sec. 35, T. 19-S, R. -35-E, NMPM.

Wildcat Pool, Lea County.

Well is 1980 feet from north line and 1980 feet from east line of Section 35. If State Land the Oil and Gas Lease No. is .

Drilling Commenced June 15, 1959. Drilling was Completed October 27, 1959.

Name of Drilling Contractor Cactus Drilling Company

Address Box 348, San Angelo, Texas

Elevation above sea level at Top of Tubing Head 3685'. The information given is to be kept confidential until not confidential, 19.

OIL SANDS OR ZONES

No. 1, from 12,642' to 12,666' No. 4, from . to .  
No. 2, from . to . No. 5, from . to .  
No. 3, from . to . No. 6, from . to .

IMPORTANT WATER SANDS

Include data on rate of water inflow and elevation to which water rose in hole.

No. 1, from . to . feet.  
No. 2, from . to . feet.  
No. 3, from . to . feet.  
No. 4, from . to . feet.

CASING RECORD

SIZE	WEIGHT PER FOOT	NEW OR USED	AMOUNT	KIND OF SHOE	CUT AND PULLED FROM	PERFORATIONS	PURPOSE
13 3/8"	48#	new	99'				Surface String
9 5/8"	10#	new	5233'				Salt String
7"	23# & 29#	new	13,687'	Laricin		12,642'-12,666'	Oil String

MUDDING AND CEMENTING RECORD

SIZE OF HOLE	SIZE OF CASING	WHERE SET	NO. SACKS OF CEMENT	METHOD USED	MUD GRAVITY	AMOUNT OF MUD USED
17 1/2"	13 3/8"	113'	100	Pump & Plug	Cemented to surface	
12 1/4"	9 5/8"	5,249'	2500	Pump & Plug	Cemented to surface	
8 3/4"	7"	13,698'	450	Pump & Plug		

RECORD OF PRODUCTION AND STIMULATION

(Record the Process used, No. of Qts. or Gals. used, interval treated or shot.)

See attachment

Result of Production Stimulation See attachment

Depth Cleaned Out 12,692'

**RECORD OF DRILL-STEM AND SPECIAL      578**

If drill-stem or other special tests or deviation surveys were made, submit report on separate sheet and attach hereto

**TOOLS USED**

Rotary tools were used from 0 feet to 14,100 feet, and from \_\_\_\_\_ feet to \_\_\_\_\_ feet.  
 Cable tools were used from \_\_\_\_\_ feet to \_\_\_\_\_ feet, and from \_\_\_\_\_ feet to \_\_\_\_\_ feet.

**PRODUCTION**

Put to Producing December 1, 19 59  
 OIL WELL: The production during the first 24 hours was 126 barrels of liquid of which 99.2 % was  
 was oil; \_\_\_\_\_ % was emulsion; 0.8 % water; and \_\_\_\_\_ % was sediment. A.P.I.  
 Gravity 43 deg.  
 GAS WELL: The production during the first 24 hours was \_\_\_\_\_ M.C.F. plus \_\_\_\_\_ barrels of  
 liquid Hydrocarbon. Shut in Pressure \_\_\_\_\_ lbs.  
 Length of Time Shut in \_\_\_\_\_

PLEASE INDICATE BELOW FORMATION TOPS (IN CONFORMANCE WITH GEOGRAPHICAL SECTION OF STATE):

Southeastern New Mexico			Northwestern New Mexico		
T. Anhy.....			T. Devonian <u>13,980' (-10,283')</u>		T. Ojo Alamo.....
T. Salt.....			T. Silurian.....		T. Kirtland-Fruitland.....
B. Salt.....			T. Montoya.....		T. Farmington.....
T. Yates <u>3413' (+284')</u>			T. Simpson.....		T. Pictured Cliffs.....
T. 7 Rivers <u>3903' (-206')</u>			T. McKee.....		T. Menefee.....
T. Queen <u>4580' (-883')</u>			T. Ellenburger.....		T. Point Lookout.....
T. Grayburg <u>5167' (-1470')</u>			T. Gr. Wash.....		T. Mancos.....
T. San Andres <u>5250' (-1553')</u>			T. Granite.....		T. Dakota.....
T. Glorieta.....			T. Delaware Mtn. <u>5776' (-2079')</u>		T. Morrison.....
T. Drinkard.....			T. Wolfcamp <u>10,920' (-7223')</u>		T. Penn.....
T. Tubbs.....			T. Bone Spring <u>7880' (-4183')</u>		T. _____
T. Abo.....			T. Atoka <u>11,920' (-8223')</u>		T. _____
T. Penn <u>11,552' (-7855')</u>			T. Woodford (lower Miss. Black		T. _____
T. Miss <u>13,158' (-9461')</u>			Shale) <u>13,808' (-10,111')</u>		T. _____
			T. _____		T. _____

**FORMATION RECORD**

From	To	Thickness in Feet	Formation	From	To	Thickness in Feet	Formation
0	70	70	Surface Sands, Caliche	11220	11300	80	Dolomite, Chert
70	1765	1695	Red Beds	11300	11820	520	Shale, Limestone & Chert
1765	3400	1635	Anhydrite & Salt	11820	12550	730	Limestone, Shale
3400	3700	300	Anhydrite	12550	12930	380	Sand, Shale, Limestone
3700	4820	1120	Dolomite, Sand, Anhydrite	12930	13140	210	Shale
4820	5420	600	Sand & Dolomite	13140	13290	150	Shale, Limestone, Chert
5420	5650	230	Shale & Dolomite	13290	13810	520	Limestone, Chert
5650	5770	120	Chert & Dolomite	13810	13980	170	Black Shale
5770	6220	450	Sand, Dolomite, Chert	13980	14010	30	Limestone
6220	6550	330	Sand, Siltstone, Dolomite	14010	14100	90	Dolomite
6550	7300	750	Limestone, Sand				
7300	7440	140	Dolomite & Sand				
7440	7870	430	Dolomite, Sand, Siltstone				
7870	8650	780	Limestone, Siltstone				
8650	8800	150	Shale, Limestone, Chert				
8800	9310	510	Siltstone, Limestone, Chert				
9310	9910	600	Sand, Siltstone, Limestone				
9910	10260	350	Siltstone & Sand				
10260	10500	240	Shale & Siltstone				
10500	10640	140	Shale, Limestone, Chert				
10640	10800	160	Shale, Dolomite, Chert, Siltstone				
10800	11220	420	Siltstone, Limestone, Shale				

ATTACH SEPARATE SHEET IF ADDITIONAL SPACE IS NEEDED

I hereby swear or affirm that the information given herewith is a complete and correct record of the well and all work done on it so far as can be determined from available records.

December 10, 1959

(Date)

Company or Operator Shell Oil Company Address Box 445, Roswell, New Mexico  
 Name R. A. Lowery Original Signed By \_\_\_\_\_ Position or Title District Exploitation Engineer  
 R. A. LOWERY