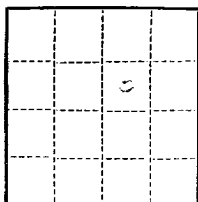

NOV 22 1961

(SUBMIT IN TRIPLICATE)

Budget Bureau No. 42-R358.4.
Approval expires 12-31-60.E. W. STANDLEY
DISTRICT ENGINEER
 UNITED STATES
DEPARTMENT OF THE INTERIOR
GEOLOGICAL SURVEY
Land Office New MexicoLease No. NM-04786

Unit _____

SUNDRY NOTICES AND REPORTS ON WELLS

NOTICE OF INTENTION TO DRILL.....	<input checked="" type="checkbox"/>	SUBSEQUENT REPORT OF WATER SHUT-OFF.....	
NOTICE OF INTENTION TO CHANGE PLANS.....		SUBSEQUENT REPORT OF SHOOTING OR ACIDIZING.....	
NOTICE OF INTENTION TO TEST WATER SHUT-OFF.....		SUBSEQUENT REPORT OF ALTERING CASING.....	
NOTICE OF INTENTION TO RE-DRILL OR REPAIR WELL.....		SUBSEQUENT REPORT OF RE-DRILLING OR REPAIR.....	
NOTICE OF INTENTION TO SHOOT OR ACIDIZE.....		SUBSEQUENT REPORT OF ABANDONMENT.....	
NOTICE OF INTENTION TO PULL OR ALTER CASING.....		SUPPLEMENTARY WELL HISTORY.....	
NOTICE OF INTENTION TO ABANDON WELL.....			

(INDICATE ABOVE BY CHECK MARK NATURE OF REPORT, NOTICE, OR OTHER DATA)

November 21, 1961

Federal "PQ" Lease

Well No. 2-4 is located 2018 ft. from N line and 1980 ft. from E line of sec. 4
SW 1/4 Sec. 4 20 South 35 East N.M.P.M.
 (1/4 Sec. and Sec. No.) (Twp.) (Range) (Meridian)

Pearl Queen Lee New Mexico
 (Field) (County or Subdivision) (State or Territory)
The elevation of the derrick floor above sea level is 3687 ft.

DETAILS OF WORK

(State names of and expected depths to objective sands; show sizes, weights, and lengths of proposed casings; indicate mudding jobs, cementing points, and all other important proposed work)

We plan to drill a 5100' Queen sand test with rotary.

We propose to set approximately 200' of 8 5/8" surface casing and cement with 150 sacks.

We plan on running 4 1/2" pipe as the oil string, setting through the producing sands and cementing with 200 sacks.

All casing will be run and cemented under methods approved by the U. S. Geological Survey.

I understand that this plan of work must receive approval in writing by the Geological Survey before operations may be commenced.

Company John H. TriggAddress P.O. Box 520Roswell, New Mexico

By

Title

Owner

NEW MEXICO OIL CONSERVATION COMMISSION
WELL LOCATION AND ACREAGE DEDICATION PLAT

FORM C-128
 Revised 5/1/57

SEE INSTRUCTIONS FOR COMPLETING THIS FORM ON THE REVERSE SIDE

SECTION A

Operator John H. Trigg		Lease Federal "PQ"		Well No. 2-4
Unit Letter G	Section 4	Township 20 South	Range 35 East	County Lea
Actual Footage Location of Well: 2018.2 feet from the north line and 1980 feet from the east line				
Ground Level Elev. 3675.1	Producing Formation Queen Sand	Pool Pearl Queen	Dedicated Acreage: 40 Acres	

1. Is the Operator the only owner in the dedicated acreage outlined on the plat below? YES ☒ NO ____ . ("Owner" means the person who has the right to drill into and to produce from any pool and to appropriate the production either for himself or for himself and another. (65-3-29 (e) NMSA 1935 Comp.)
2. If the answer to question one is "no," have the interests of all the owners been consolidated by communitization agreement or otherwise? YES ____ NO ____ . If answer is "yes," Type of Consolidation _____
3. If the answer to question two is "no," list all the owners and their respective interests below:

Owner	Land Description

SECTION B

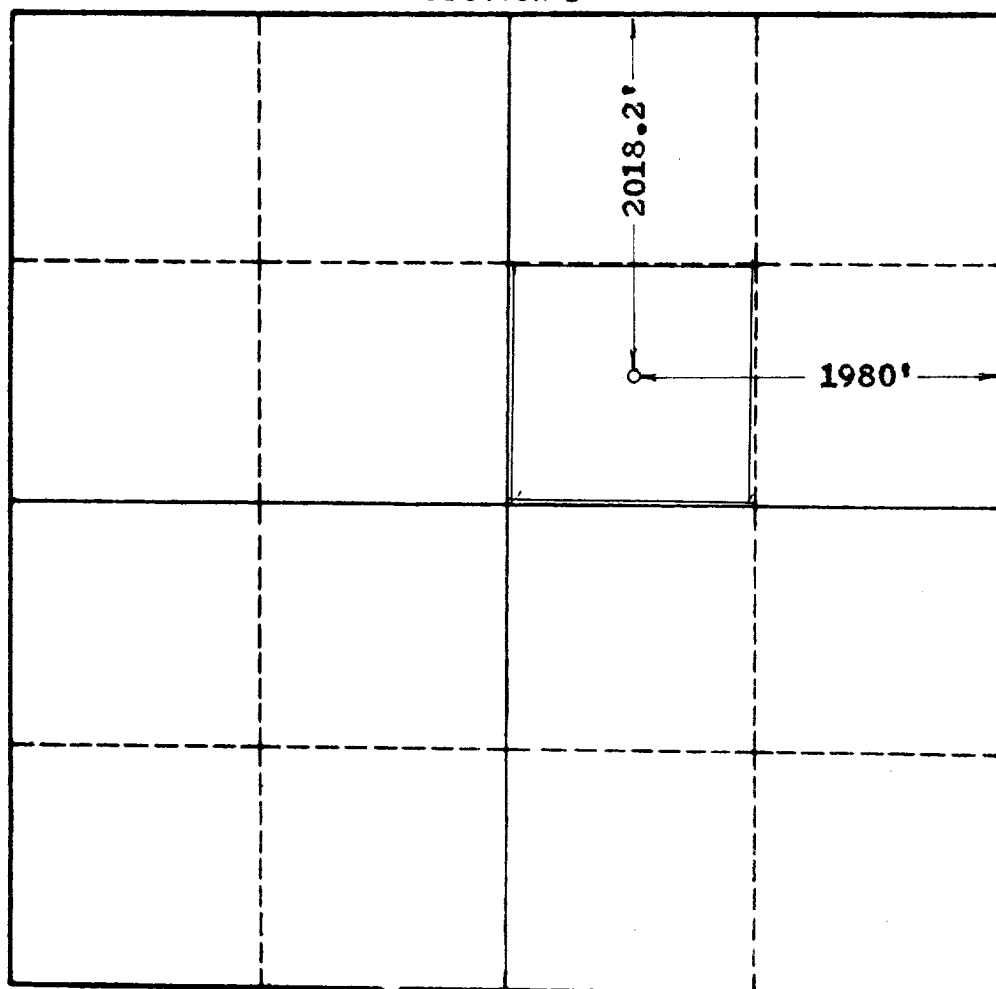

CERTIFICATION

I hereby certify that the information in SECTION A above is true and complete to the best of my knowledge and belief.

Name **John H. Trigg**
 Position **Owner**
 Company **John H. Trigg**
 Date **November 21, 1961**

I hereby certify that the well location shown on the plat in SECTION B is plotted from field notes of actual surveys made by me or under my supervision, and that the same is true and correct to the best of my knowledge and belief.

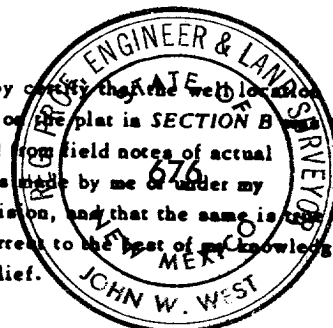

Date Surveyed
October 13, 1961
 Registered Professional Engineer
 and/or Land Surveyor, **JOHN W. WEST**
John W. West
 Certificate No.
N. M. - P. E. & L. S. NO. 676

0 330 660 990 1320 1650 1980 2310 2640 2000 1500 1000 500 0