

Revised 5/1/57

NEW MEXICO OIL CONSERVATION COMMISSION

Well Location and Acreage Dedication Plat

Section A.

Date 7-6-57

Operator Continental Oil Co. Lease Reed A-3
 Well No. 14 Unit Letter O Section 3 Township 20 S Range 36 E NMPM
 Located 660 Feet From South Line, 2310 Feet From East Line
 County Lea G. L. Elevation _____ Dedicated Acreage 648 Acres
 Name of Producing Formation Deer Pool EUMONT

1. Is the Operator the only owner* in the dedicated acreage outlined on the plat below?
Yes _____ No X.
2. If the answer to question one is "no," have the interests of all the owners been consolidated by communitization agreement or otherwise? Yes X No _____. If answer is "yes," Type of Consolidation NEW MEXICO FEDERAL UNIT AGREEMENT
3. If the answer to question two is "no," list all the owners and their respective interests below:

OwnerLand Description

RECEIVED

JUL 10 1957

U. S. GEOLOGICAL SURVEY

HOBBS, NEW MEXICO

Section B

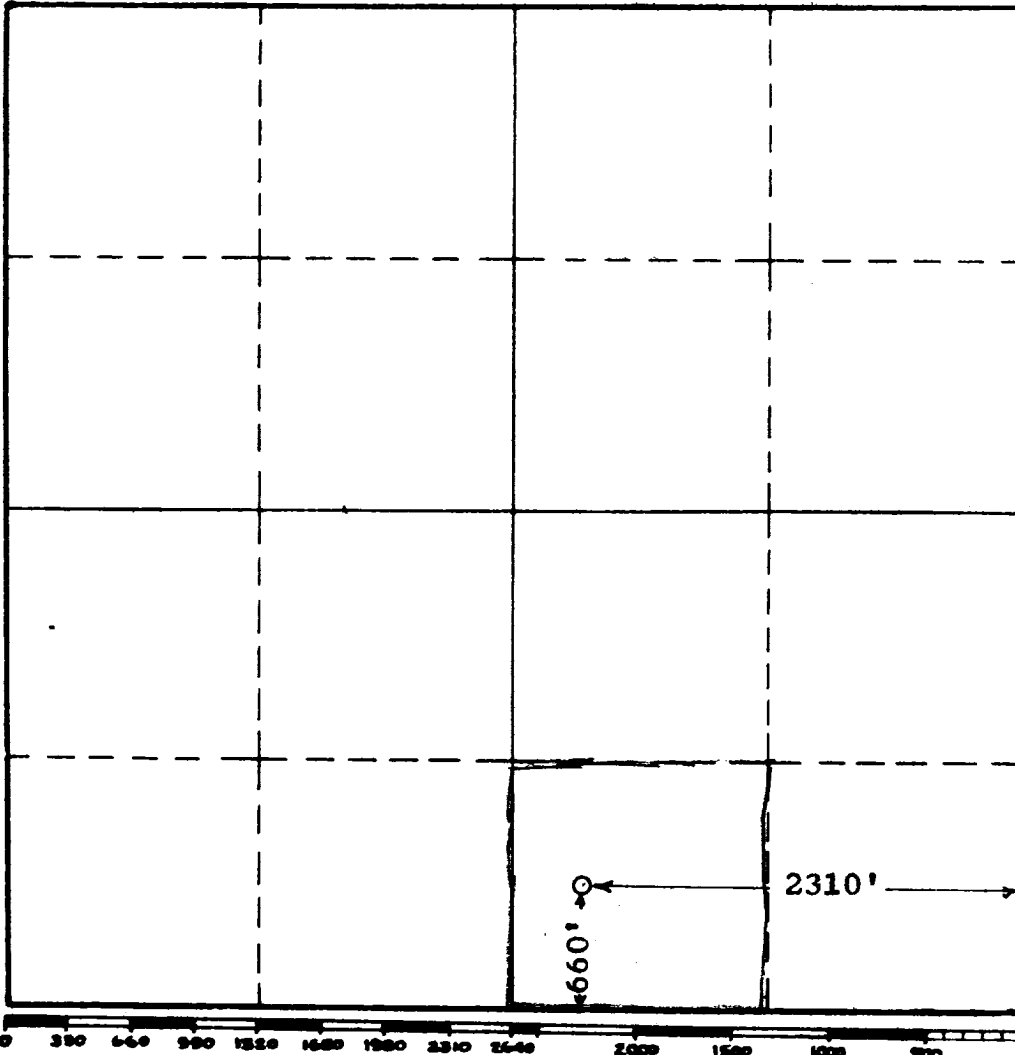

This is to certify that the information in Section A above is true and complete to the best of my knowledge and belief.

Continental Oil Co
(Operator)

[Signature]
(Representative)

Box 427, Hobbs, N.M.
Address

This is to certify that the well location shown on the plat in Section B was plotted from field notes of actual surveys made by me or under my supervision and that the same is true and correct to the best of my knowledge and belief.

Date Surveyed 7-6-57

[Signature]
Registered Professional
Engineer and/or Land Surveyor.

Certificate No. 676

(See instructions for completing this form)