

UNITED STATES
DEPARTMENT OF THE INTERIOR
BUREAU OF LAND MANAGEMENT

N. OIL CONS. COMMISSION
P.O. BOX 1980
HOBBS, NEW MEXICO 88240

FORM APPROVED
Bureau NO. 1004-0135
Expires: March 31, 1993

SUNDRY NOTICES AND REPORTS ON WELLS

Do not use this form for proposals to drill or to deepen or reentry to a different reservoir.
Use "APPLICATION FOR PERMIT—" for such proposals

SUBMIT IN TRIPLICATE

1. Type of Well
☐ Oil Well ☒ Gas Well ☐ Other

2. Name of Operator

Conoco, Inc.

3. Address and Telephone No.

10 Desta Dr. Ste 100W, Midland, TX 79705

4. Location of Well (Footage, Sec., T., R., M., or Survey Description)

660' FSL & 660' FEL
Sec. 11, T-20S, R-36E

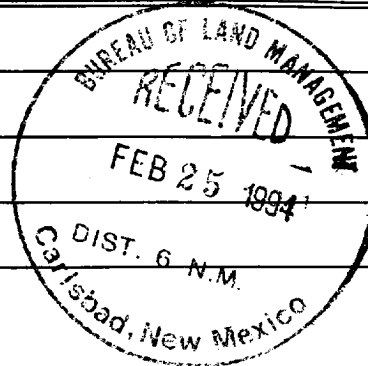

5. Lease Designation and Serial No.

LC 031622A

6. If Indian, Allottee or Tribe Name

7. If Unit or CA, Agreement Designation

8. Well Name and No.

Sanderson A #3

9. API Well No.

300-25-0421400

10. Field and Pool, or Exploratory Area

Eumont Gas

11. County or Parish, State

Lea

12. CHECK APPROPRIATE BOX(s) TO INDICATE NATURE OF NOTICE, REPORT, OR OTHER DATA

TYPE OF SUBMISSION

☒ Notice of Intent

☐ Subsequent Report

☐ Final Abandonment Notice

TYPE OF ACTION

☐ Abandonment

☒ Recompletion

☐ Plugging Back

☐ Casing Repair

☐ Altering Casing

☐ Other

☐ Change of Plans

☐ New Construction

☐ Non-Routine Fracturing

☐ Water Shut-Off

☐ Conversion to Injection

☐ Dispose Water

(Note: Report results of multiple completion on Well Completion or Recompletion Report and Log form.)

13. Describe Proposed or Completed Operations (Clearly state all pertinent details, and give pertinent dates, including estimated date of starting any proposed work. If well is directionally drilled, give subsurface locations and measured and true vertical depths for all markers and zones pertinent to this work.)*

This wellbore was temporarily abandon in the Eunice Monument Grayburg pool when this location was unitized into the EMSUB Waterflood. It is proposed to return this well to production by recompleting to the Queen/Penrose formations in the Eumont Gas Pool according to the following procedure:

1. Drill out the cement retainer at 1600'.
2. Clean out to PBTD at 3480'.
3. Run GR/porosity logs from 3480'-1480'.
4. Perforate the Queen & Penrose at approximately 3210'-3324' and 3331'-3460' or as determined by the logs.
5. Acidize with 2500 gals 15% HCL and stimulate with CO2 foam frac.
6. Return to production.

The 240 acres in SE/4 and S/2 SW/4 of section 11 are to be dedicated to this well. This proration unit was established by Order NSP-415.

14. I hereby certify that the foregoing is true and correct

Signed

Joe G. Lara

Title Sr. Conservation Coordinator

Date 2/24/94

(This space for Federal or State office use)

Approved by **(ORIG. SGD.) JOE G. LARA**

Title **PETROLEUM ENGINEER**

Date 3/21/94

Conditions of approval, if any:

RECEIVED

MAR 23 1994

COBURN
OFFICE

Submit to Appropriate
District Office
State Lease - 4 copies
Fee Lease - 3 copies

State of New Mexico
Energy, Minerals and Natural Resources Department

Form C-102
Revised 1-1-89

OIL CONSERVATION DIVISION

P.O. Box 2088
Santa Fe, New Mexico 87504-2088

DISTRICT I
P.O. Box 1980, Hobbs, NM 88240

DISTRICT II
P.O. Drawer DD, Artesia, NM 88210

DISTRICT III
1000 Rio Brazos Rd., Aztec, NM 87410

WELL LOCATION AND ACREAGE DEDICATION PLAT

All Distances must be from the outer boundaries of the section

Operator Conoco, Inc.			Lease Sanderson A		Well No. 3
Unit Letter P	Section 11	Township 20S	Range 36E	County NMPM	Lea
Actual Footage Location of Well: 660' feet from the South line and 660' feet from the East line					
Ground level Elev. 3563'	Producing Formation Queen		Pool Eumont Gas		Dedicated Acreage: 240 Acres

1. Outline the acreage dedicated to the subject well by colored pencil or hachure marks on the plat below.

2. If more than one lease is dedicated to the well, outline each and identify the ownership thereof (both as to working interest and royalty).

3. If more than one lease of different ownership is dedicated to the well, have the interest of all owners been consolidated by communitization, unitization, force-pooling, etc.?

☐ Yes

☐ No

If answer is "yes" type of consolidation

If answer is "no" list the owners and tract descriptions which have actually been consolidated. (Use reverse side of this form if necessary.)

No allowable will be assigned to the well until all interests have been consolidated (by communitization, unitization, forced-pooling, or otherwise) or until a non-standard unit, eliminating such interest, has been approved by the Division.

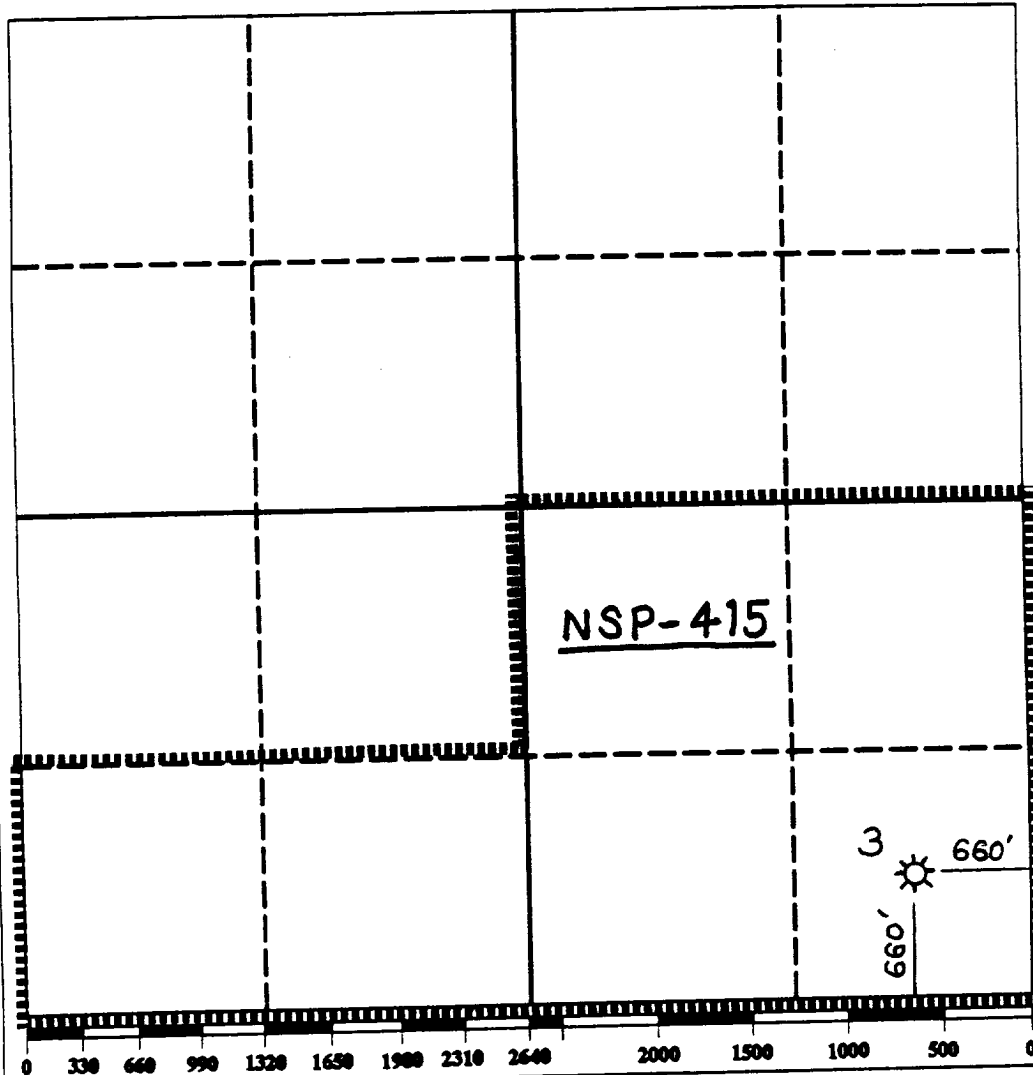

OPERATOR CERTIFICATION

I hereby certify that the information contained herein is true and complete to the best of my knowledge and belief.

Signature

Printed Name

Jerry W. Hoover

Position

Sr. Conservation Coord.

Company

Conoco, Inc.

Date

2/24/94

SURVEYOR CERTIFICATION

I hereby certify that the well location shown on this plat was plotted from field notes of actual surveys made by me or under my supervision, and that the same is true and correct to the best of my knowledge and belief.

Date Surveyed

Signature & Seal of
Professional Surveyor

Certificate No.

RECEIVED

23 1994

OS
OFFICE

1994

1994