

WELL LOCATION SURVEY PLAT.

COMPANY Cactus Drilling Company

LEASE Catron "A"

WELL NO. 1

ED 1-18 PM 1:18

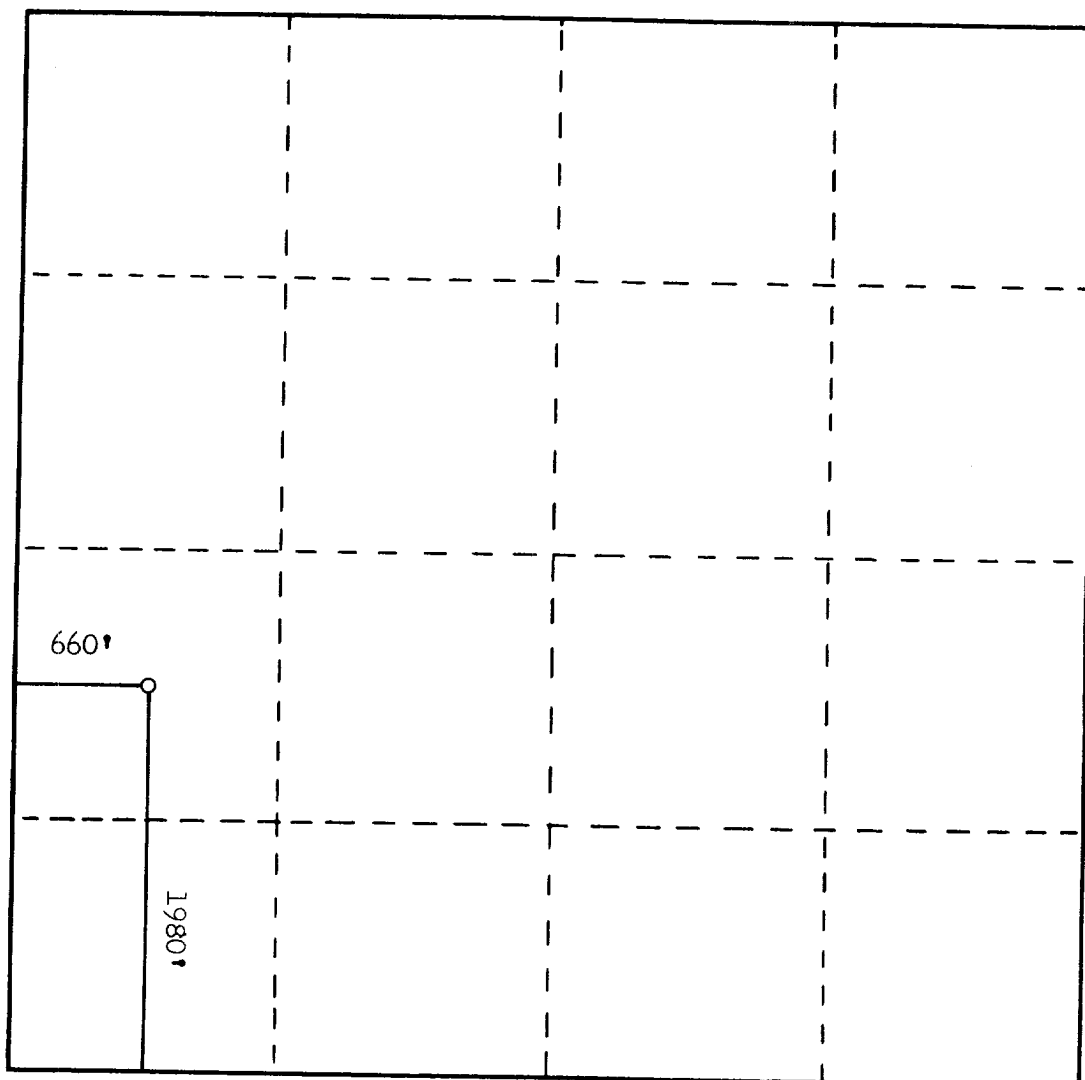

SEC. 19 TWP. 20 S. RGE. 36 E. N.M.P.M.

I CERTIFY THAT THIS SURVEY WAS MADE UNDER
MY DIRECTION, AND THAT THE PLAT IS CORRECT
TO THE BEST OF MY KNOWLEDGE.

George A. Hinckfeld

NEW MEXICO LICENSE NO. 1528