

NEW MEXICO OIL CONSERVATION COMMISSION

Revised 5/1/57

Well Location and Acreage Dedication Plat

Section A.

NOBBS 4-17-58  
Date 4-17-58

Operator HUMBLE OIL & REFG. CO Lease EUMONT GAS NO. 4  
Well No. 1 Unit Letter "N" Section 25 E 26 Township 20 S 21 Range 36 E NMPM  
Located 660 Feet From SOUTH Line, 1980 Feet From WEST Line  
County LEA G. L. Elevation \_\_\_\_\_ Dedicated Acreage 240 Acres  
Name of Producing Formation QUEEN Pool EUMONT GAS

1. Is the Operator the only owner\* in the dedicated acreage outlined on the plat below?  
Yes \_\_\_\_\_ No ✓.
2. If the answer to question one is "no," have the interests of all the owners been consolidated by communitization agreement or otherwise? Yes \_\_\_\_\_ No \_\_\_\_\_. If answer is "yes," Type of Consolidation UNITIZATION
3. If the answer to question two is "no," list all the owners and their respective interests below:

Owner

Land Description

Section B

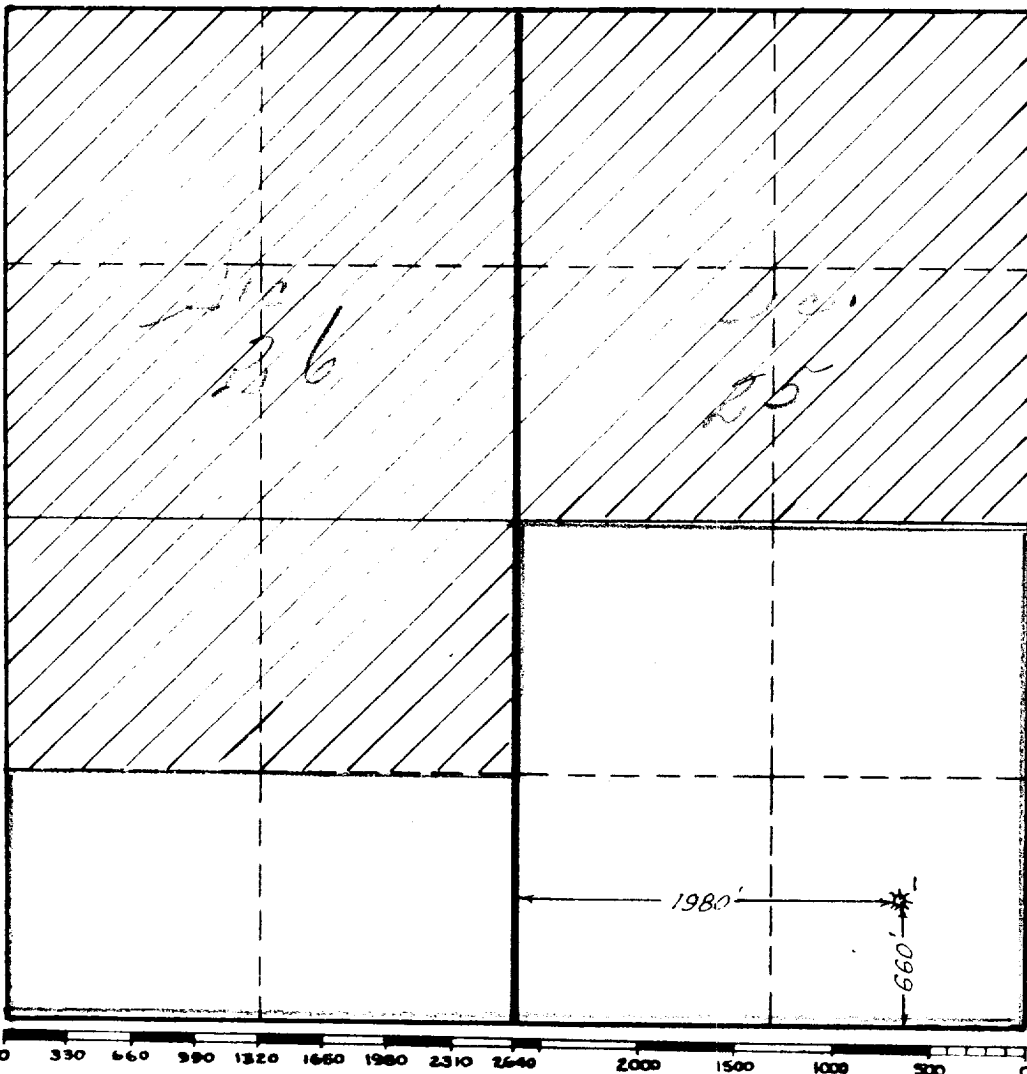

This is to certify that the information in Section A above is true and complete to the best of my knowledge and belief.

HUMBLE OIL & REFG CO  
(Operator)

[Signature]  
(Representative)  
Assistant Division Supt.  
Box 1600 Midland, Texas  
Address

This is to certify that the well location shown on the plat in Section B was plotted from field notes of actual surveys made by me or under my supervision and that the same is true and correct to the best of my knowledge and belief.

Date Surveyed 5-24-37

[Signature]  
Registered Professional  
Engineer and/or Land Surveyor.

Certificate No. 1382

LEASE NO. 61313-14

W-A - 1851