

NEW MEXICO OIL CONSERVATION COMMISSION  
Well Location and Acreage Dedication Plat

Section A.

Date January 12, 1958

Operator Amerada Petroleum Corp. Lease State WE "I"-32  
Well No. 1 Unit Letter 0 Section 32 Township 20-S Range 36-E NMPM  
Located 660 Feet From South Line, 1980 Feet From East Line  
County Lea G. L. Elevation \_\_\_\_\_ Dedicated Acreage 40 Acres  
Name of Producing Formation Between Yates & 7 rivers Pool Undesignated

1. Is the Operator the only owner\* in the dedicated acreage outlined on the plat below?  
Yes X No \_\_\_\_\_.
2. If the answer to question one is "no," have the interests of \_\_\_\_\_ owners been consolidated by communitization agreement or otherwise? Yes \_\_\_\_\_ If answer is "yes," Type of Consolidation \_\_\_\_\_
3. If the answer to question two is "no," list all the owners and their respective interests below:

Owner

Land Description

Section B

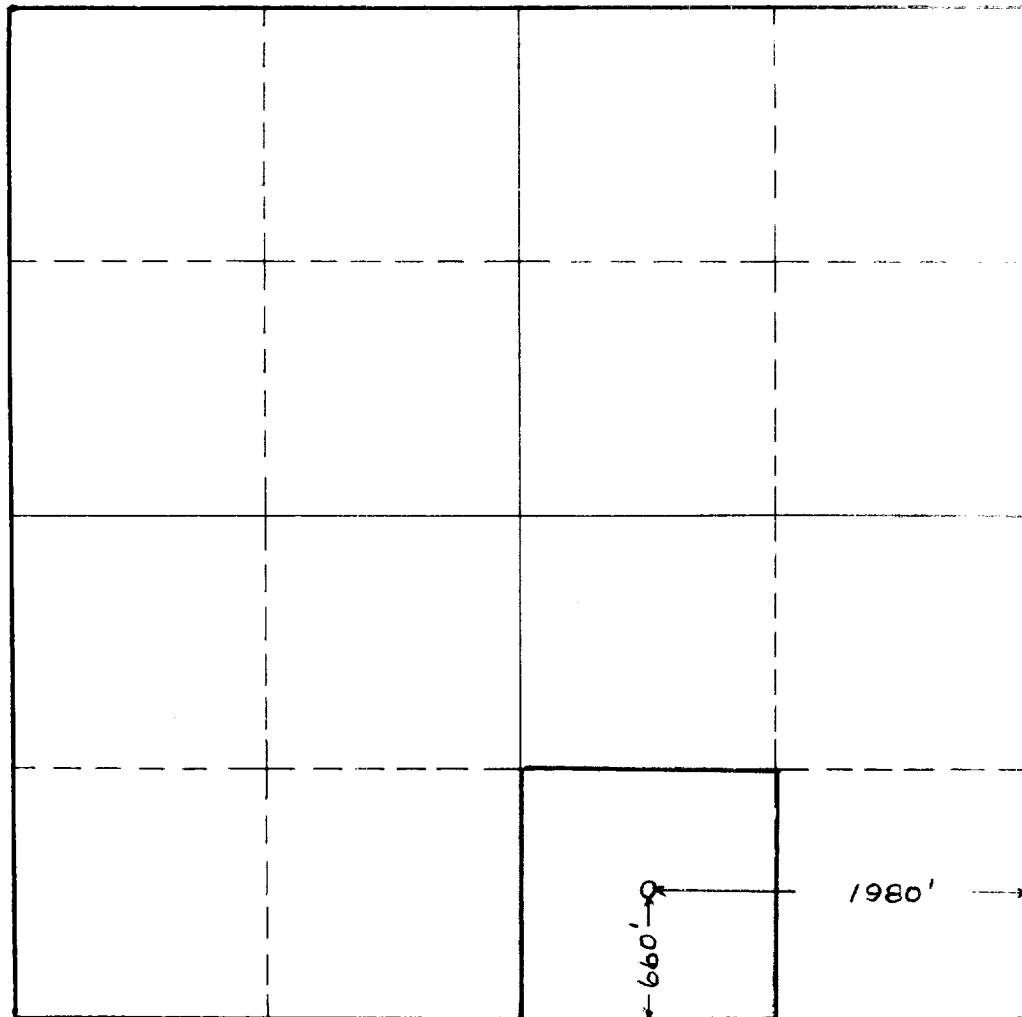

This is to certify that the information in Section A is true and complete to the best of my knowledge and belief.

Amerada Petroleum Corp.

(Operator)

D.C. Capps  
(Representative)

Drawer "D" - Monument, N.M.

Address

This is to certify that the information shown on the plat in Section B was plotted from field notes of actual surveys made by me or under my supervision and that the same is true and correct to the best of my knowledge and belief.

Date Surveyed 12-6-57

John W. West

Registered Professional  
Engineer and/or Land Surveyor.

INSTRUCTIONS FOR COMPLETION:

1. Operator shall furnish and certify to the information called for in Section A.
2. Operator shall outline the dedicated acreage for both oil and gas wells on the plat in Section B.
3. A registered professional engineer or land surveyor registered in the State of New Mexico or approved by the Commission shall show on the plat the location of the well and certify this information in the space provided.
4. All distances shown on the plat must be from the outer boundaries of Section.
5. If additional space is needed for listing owners and their respective interests as required in question 3, Section A, please use space below

\* "Owner" means the person who has the right to drill into and to produce from any pool and to appropriate the production either for himself or for himself and another. (65-3-29 (e) NMSA 1953 Comp.)