

NEW MEXICO OIL CONSERVATION COMMISSION

Well Location and Acreage Dedication Plat

Section A.

Date December 6, 1957

Operator Amerada Petroleum Corp. Lease 1957 DEC 9 AM 8:55 State N.M.
Well No. 1 Unit Letter 0 Section 32 Township 20S Range 36E NMFM
located 660 Feet From South Line, 1980 Feet From the East Line
County Lea G. L. Elevation _____ Dedicated Acreage 160 Acres
Name of Producing Formation Seven Rivers Pool Bumont

1. Is the Operator the only owner* in the dedicated acreage outlined on the plat below?
Yes ☒ No ☐.
2. If the answer to question one is "no," have the interests of all the owners been consolidated by communitization agreement or otherwise? Yes ☐ No ☐. If answer is "yes," Type of consolidation _____
3. If the answer to question two is "no," list all the owners and their respective interests below:

Owner

Land Description

Section B

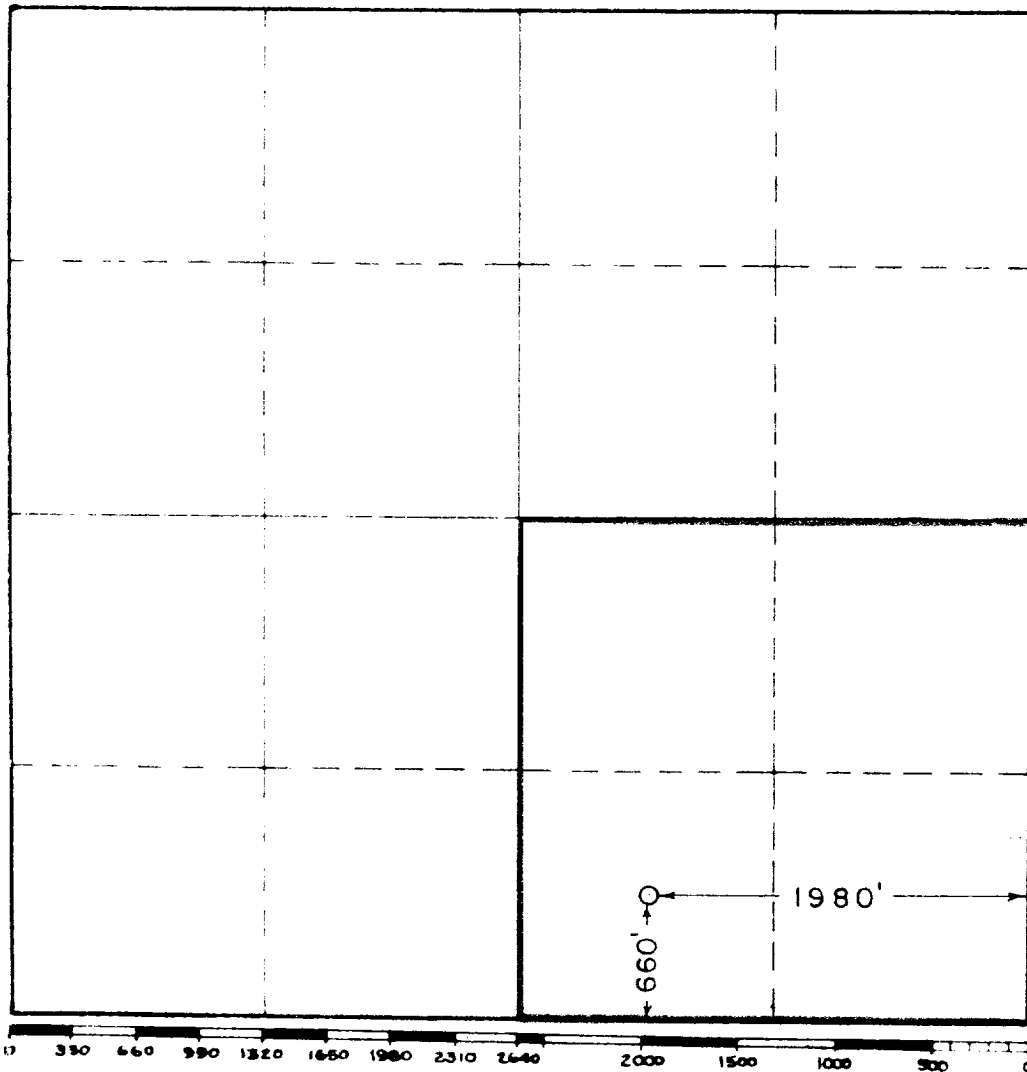

This is to certify that the information in Section A above is true and complete to the best of my knowledge and belief.

Amerada Petroleum Corp.

(Operator)

D.C. Capps

(Representative)

Drawer "D", Monument, N.M.

Address

This is to certify that the well location shown on the plat in Section B was plotted from field notes of actual surveys made by me or under my supervision and that the same is true and correct to the best of my knowledge and belief.

Date Surveyed 12-6-57

Colm H. West
Registered Professional
Engineer and/or Land Surveyor.

Certificate No. 676