

NEW MEXICO
L CONSERVATION COMMISS.

Form C-128

Well Location and/or Gas Proration Plat

Date October 25, 1956

Charm Oil Company

Lease Coll

3

Section 33

Township 208

Range 36E

NMPM

1650

Feet From

East

Line,

2310

Feet From

South

Line,

Lea

County, New Mexico.

G. L. Elevation

Producing Formation

Seven Rivers

Pool

Eumont

Dedicated Acreage

(Note: All distances must be from outer boundaries of Section)

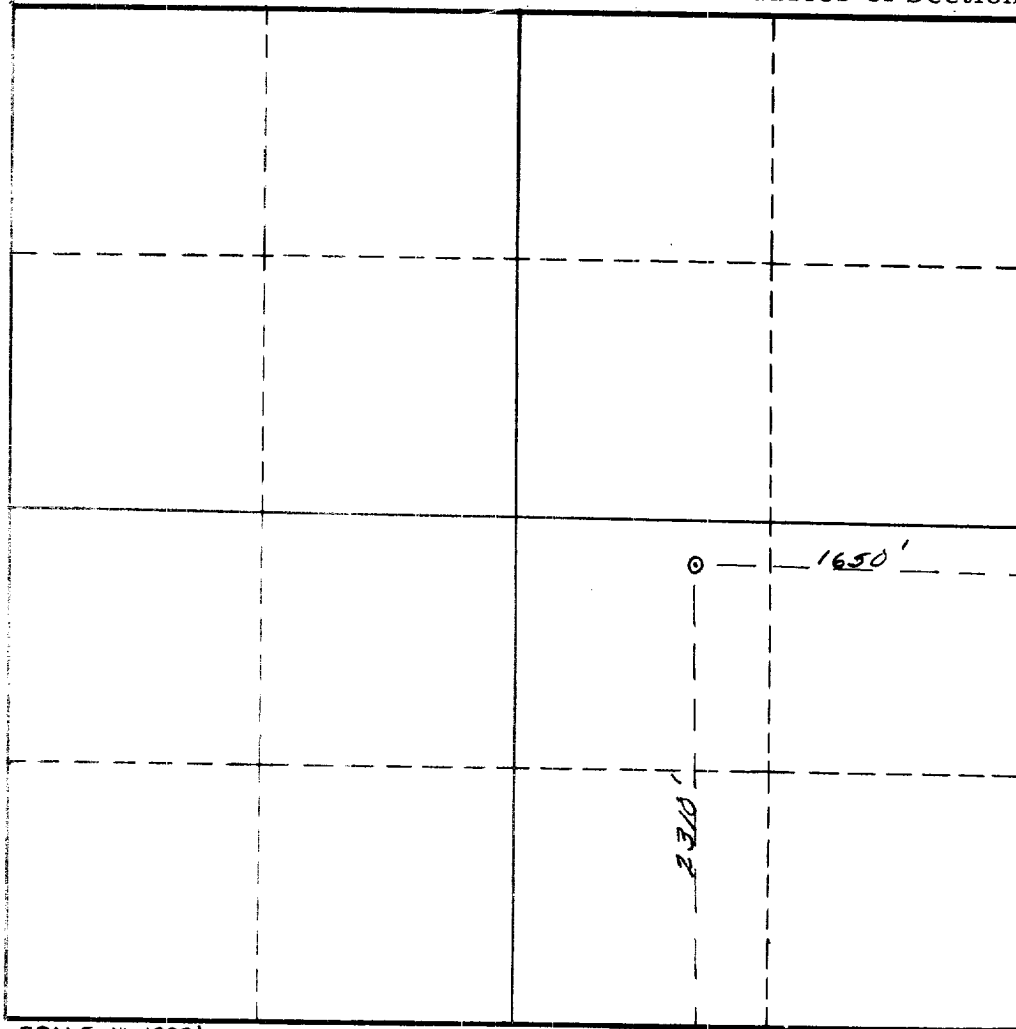

SCALE: 1"=1000'

Is this Well a Dual Comp. ? Yes ☐ No ☐.

If answer to Question 1 is yes, are there any other equally completed wells within the dedicated acreage? Yes ☐ No ☐.

This is to certify that the above plat was prepared from field notes of actual surveys made by me or under my supervision and that the same are true and correct to the best of my knowledge and belief.

Date Surveyed October 19, 1956

Vilas K. Anderson
Registered Professional Engineer and/or
Land Surveyor