

STAKING PLAT

<u>Charm Oil Company</u>	<u>So. Petr. Expl. State</u>	<u>1</u>
Operator	Lease	Well

Lea County, New Mexico

660 feet from N and 1980 feet from E lines of
Section 33, Township 20, Range 36

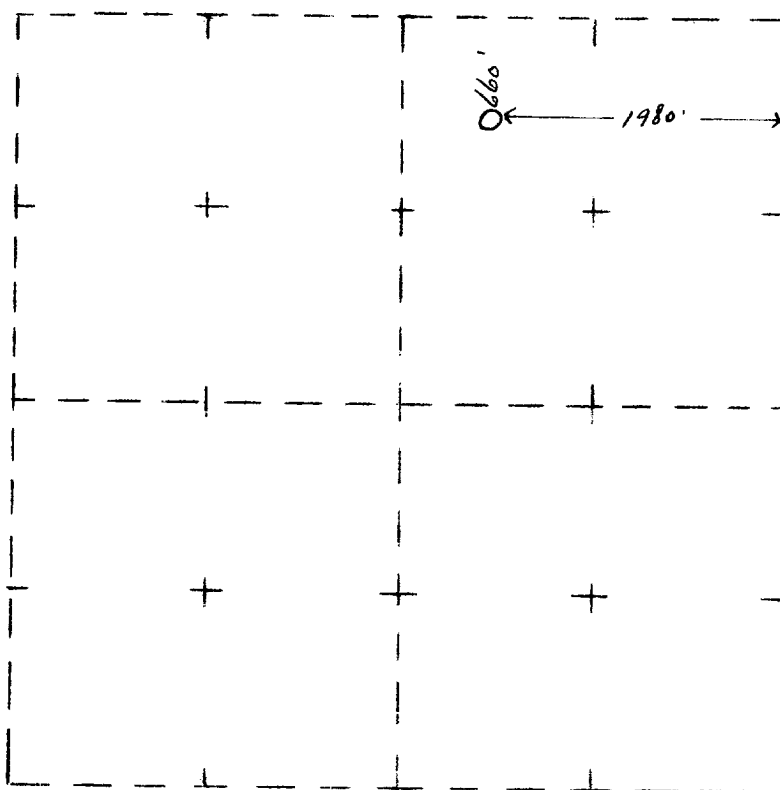

Certificate

The undersigned is registered as a Land Surveyor in the State of New Mexico and hereby swears that this plat was prepared from field notes made under his direction, and that it is true and correct to the best of his knowledge and belief.

Vilas P. Sheldon
Vilas P. Sheldon

1954 MAY 7 AM 9:29

1954 MAY 7 AM 9:29