

NEW MEXICO  
OIL CONSERVATION COMMISSION

Gas Well Plat

Date October 22, 1954

El Paso Natural Gas Company Shell State 10  
Operator Lease Well No.

Name of Producing Formation Queen Pool Bumont

No. Acres Dedicated to the Well 160

SECTION 36 TOWNSHIP 20 S RANGE 36 E

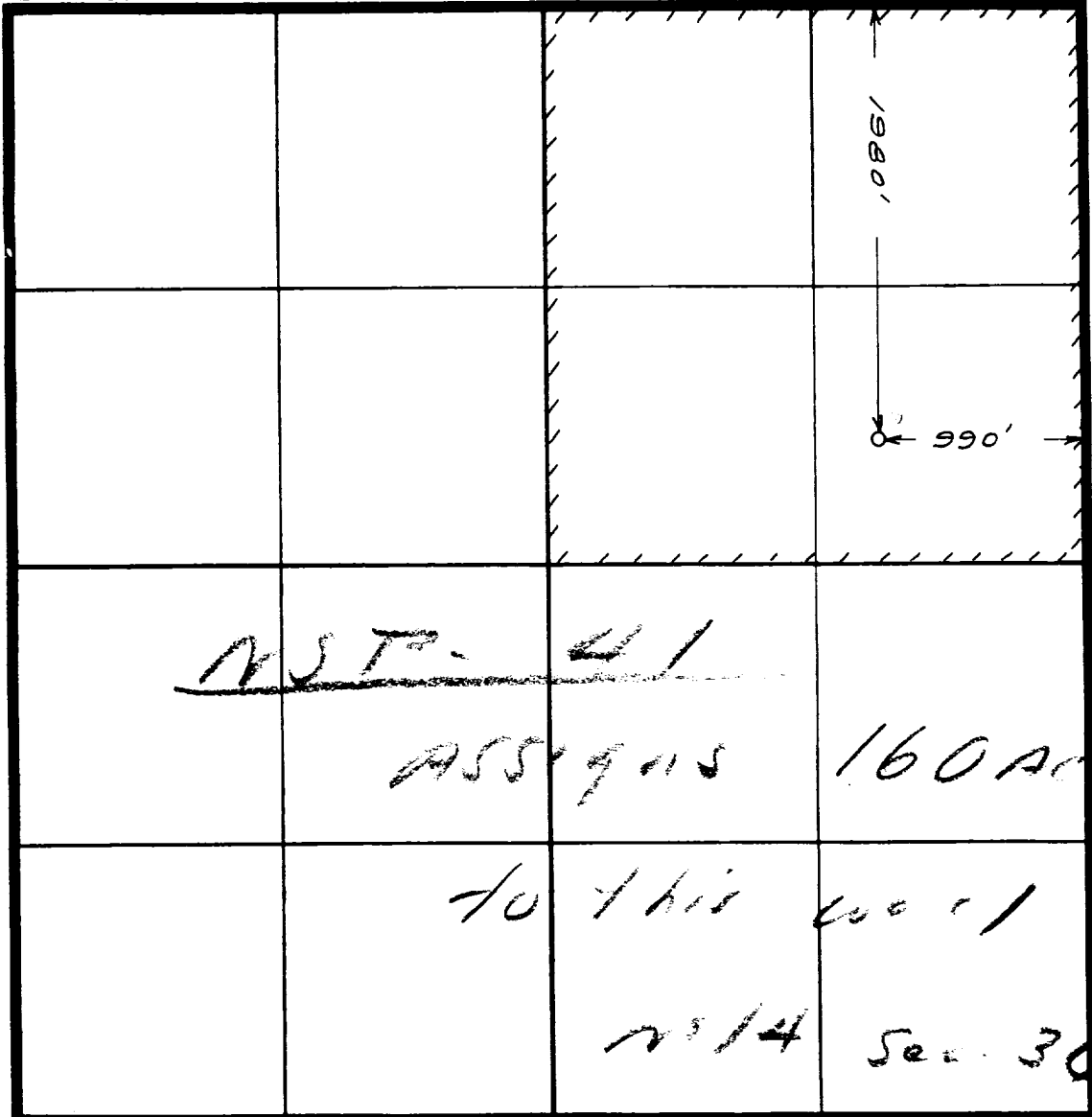

I hereby certify that the information given above is true and complete to the best of my knowledge.

Name Larry C. Zink  
Position Larry C. Zink Division Geologist  
Representing El Paso Natural Gas Company  
Address Box 1384, Jal, New Mexico

(over)

## INSTRUCTIONS

1. Is this gas well a dual completion? Yes        No ✓
2. If the answer to Question 1 is Yes, are there any other dually completed wells within the dedicated acreage? Yes                      No

A separate plat must be filed for each gas well, outlining the area dedicated to such well and showing the location of all other wells (oil and gas) within the outlined area.

Mail in duplicate to the district office for the district in which the well is located.