

**NEW MEXICO  
OIL CONSERVATION COMMISSION**

Form C-128

Well Location and/or Gas Proration Plat

Date 04-18-56

Operator The Texas Company Lease Z. A. McMillan "B"

Well No. 3 Section 4 Township 19-S Range 37-E NMPM

Located 1980' Feet From South Line, 1980' Feet From East Line,

Lea County, New Mexico. G. L. Elevation 3670'

Name of Producing Formation Queen Sand Pool Eumont Oil Dedicated Acreage 40

(Note: All distances must be from outer boundaries of Section)

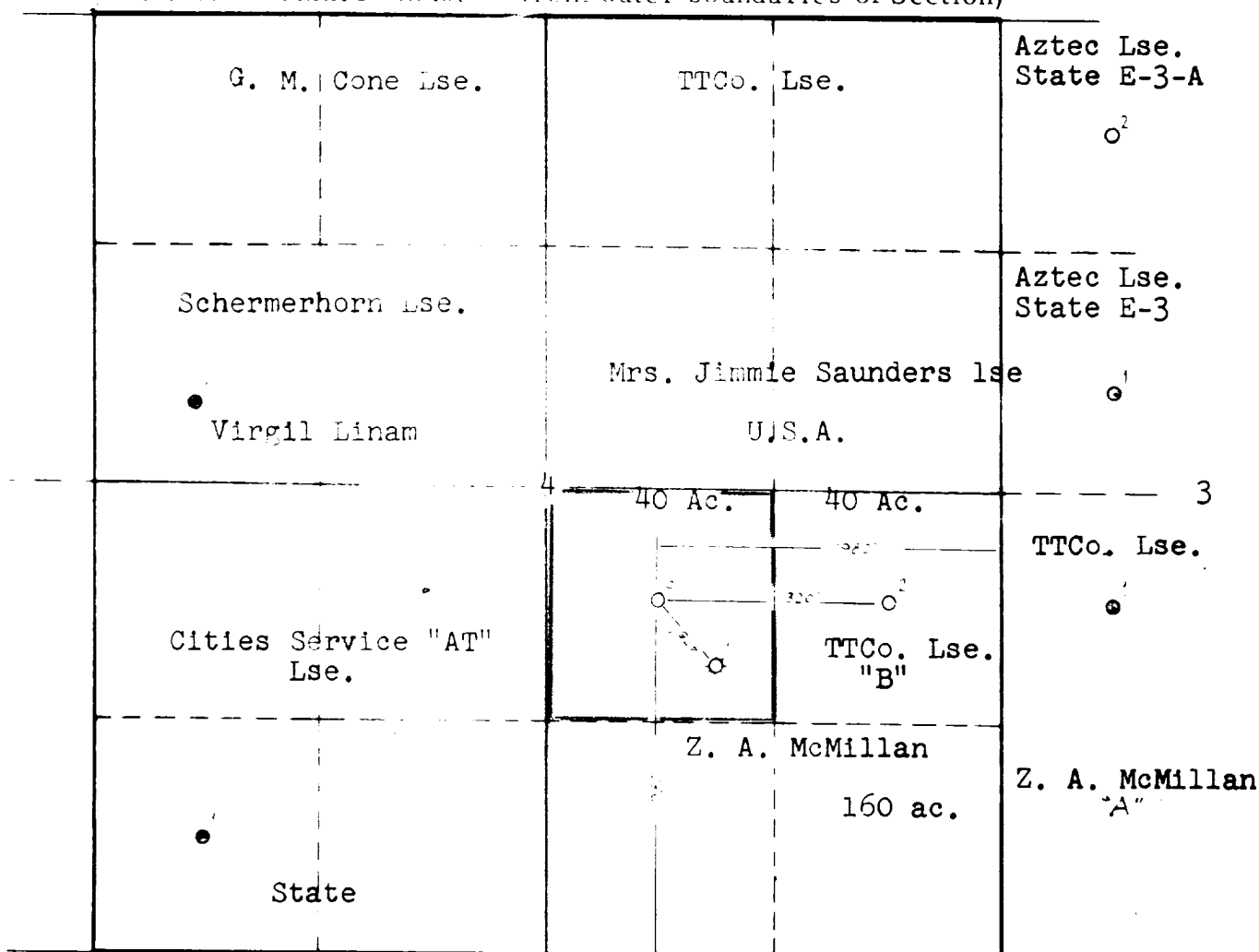

SCALE: 1" = 1000'

1. Is this Well a Dual Comp.? Yes \_\_\_ No X
2. If the answer to Question 1 is yes, are there any other dually completed wells within the dedicated acreage? Yes \_\_\_ No \_\_\_

This is to certify that the above plat was prepared from field notes of actual surveys made by me or under my supervision and that the same are true and correct to the best of my knowledge and belief.

Name Willard M. Duncan  
Position Civil Engineer  
Representing The Texas Company  
Address P.O. Box 1720, Fort Worth, Texas

Date Surveyed 4-17-56  
Willard M. Duncan  
Registered Professional Engineer and/or  
Land Surveyor