

**NEW MEXICO
OIL CONSERVATION COMMISSION**

Form C-128

Well Location and/or Gas Proration Plat

Date July 30, 1956

Operator The Texas Company Lease Mrs. Jimmy Saunders - Federal

Well No. 2 Section 4 Township 19 South Range 37 East NMPM

Located 660 Feet From North Line, 1652 Feet From East Line,

Lea County, New Mexico. G. L. Elevation 3693'

Name of Producing Formation Queen Sand Pool Eumont Dedicated Acreage 45.21

(Note: All distances must be from outer boundaries of Section)

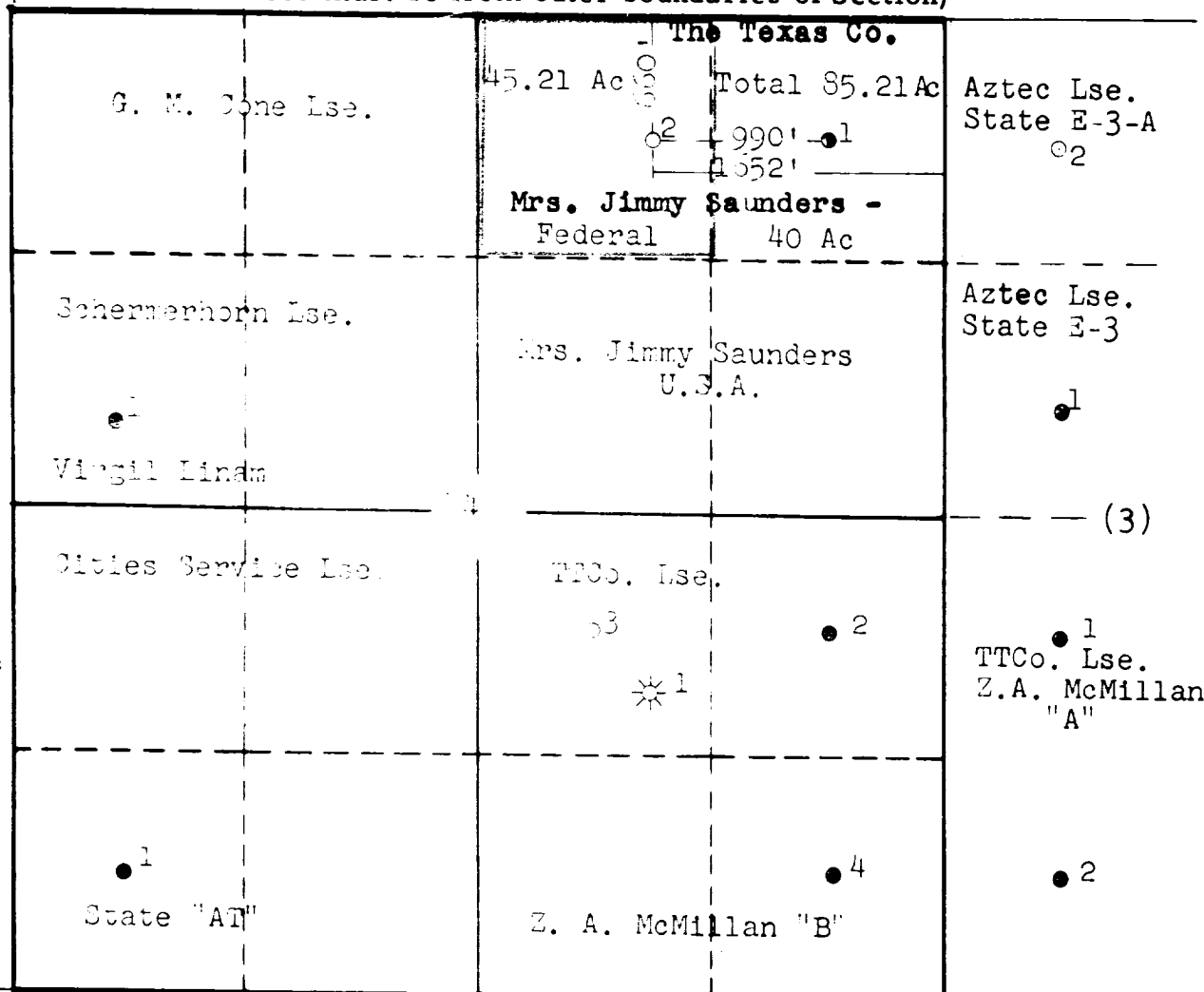

SCALE: 1"=1000'

1. Is this Well a Dual Comp. ? Yes ☐ No ☐.
2. If the answer to Question 1 is yes, are there any other dually completed wells within the dedicated acreage ? Yes ☐ No ☐.

Name _____
Position _____
Representing _____
Address _____

This is to certify that the above plat was prepared from field notes of actual surveys made by me or under my supervision and that the same are true and correct to the best of my knowledge and belief.

Date Surveyed 7/27/56
Registered Professional Engineer and/or Land Surveyor _____