

NEW MEXICO  
OIL CONSERVATION COMMISSION

Form C-128

Well Location and/or Gas Proration Plat

Date 11-1-56

Operator AMERICAN PET. CORP. NOV 5 AM 7:35 Lease STATE MT UNIT

Well No.        Section 5 Township 19 SOUTH Range 37 EAST NMPM

Located 990 Feet From SOUTH Line, 1650 Feet From WEST Line,

LEA County, New Mexico. G. L. Elevation       

Name of Producing Formation        Pool        Dedicated Acreage       

(Note: All distances must be from outer boundaries of Section)

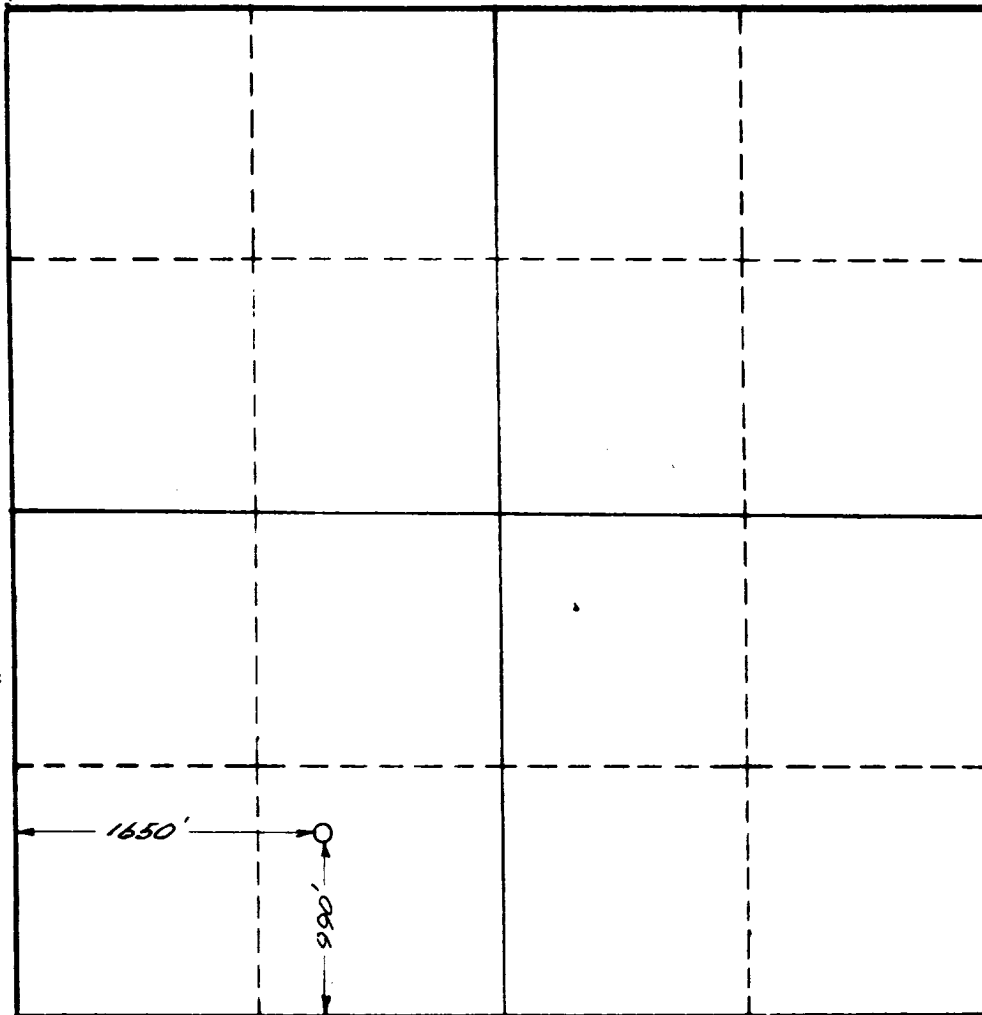

NOTE

This section of form is to be used for gas wells only.



1. Is this Well a Dual Comp. ? Yes        No       .
2. If the answer to Question 1 is yes, are there any other dually completed wells within the dedicated acreage ? Yes        No       .

Name         
Position         
Representing         
Address       

This is to certify that the above plat was prepared from field notes of actual surveys made by me or under my supervision and that the same are true and correct to the best of my knowledge and belief.

Date Surveyed 11/1-56  
John W. West  
Registered Professional Engineer and/or Land Surveyor