

NEW MEXICO OIL CONSERVATION COMMISSION

Well Location and Acreage Dedication Plat

Section A.

Date 5-5-1957

Operator Schermerhorn Oil Corp. Lease Linam "G"
Well No. 1 Unit Letter B Section 5 Township 19 South Range 37 East NMPM
Located 1980 Feet From East Line, 990 Feet From North Line
County Lea G. L. Elevation 3,705 Dedicated Acreage 80 Acres
Name of Producing Formation Queen Pool Eumont

1. Is the Operator the only owner* in the dedicated acreage outlined on the plat below?
Yes x No .
2. If the answer to question one is "no," have the interests of all the owners been consolidated by communitization agreement or otherwise? Yes No . If answer is "yes," Type of Consolidation .
3. If the answer to question two is "no," list all the owners and their respective interests below:

Owner

Land Description

Section B

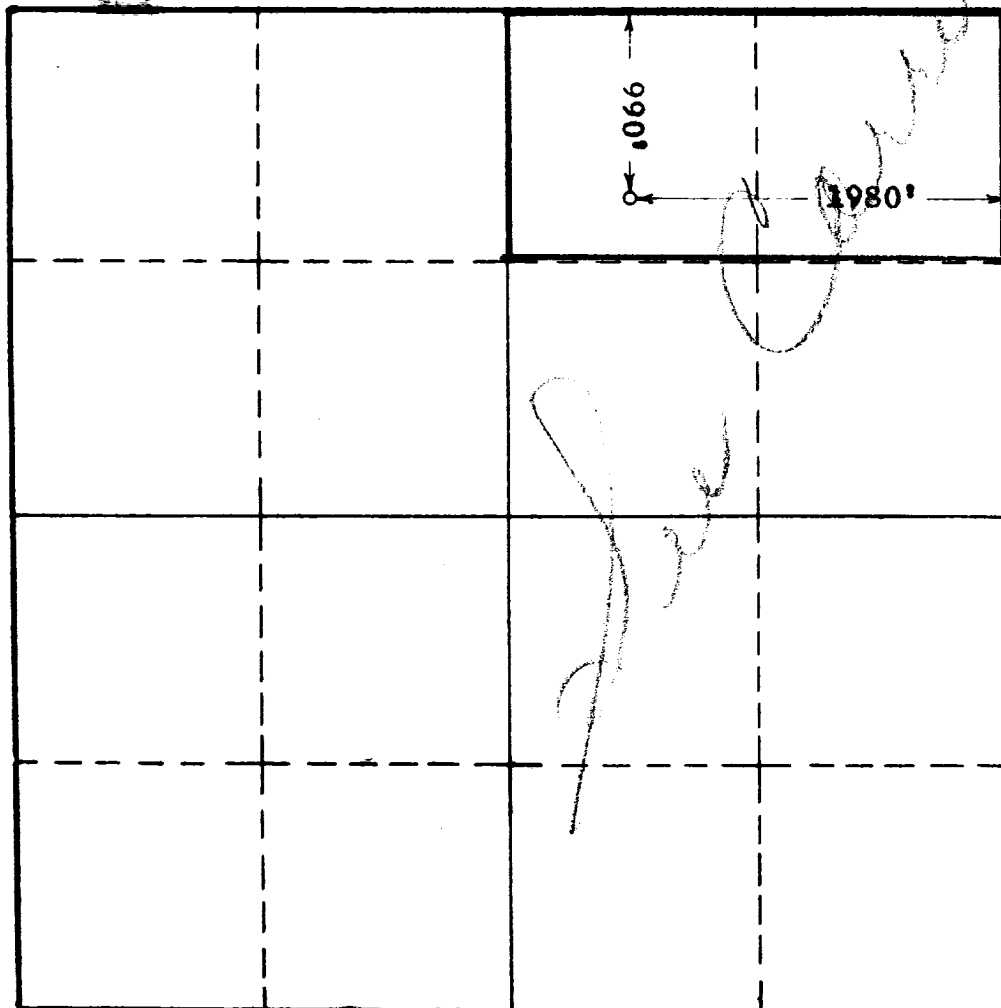

This is to certify that the information in Section A above is true and complete to the best of my knowledge and belief.

SCHERMERHORN OIL CORP.

(Operator)

J. H. Moore
(Representative)

BOX 1537, HOBBS, N. MEX.

Address

This is to certify that the well location shown on the plat in Section B was plotted from field notes of actual surveys made by me or under my supervision and that the same is true and correct to the best of my knowledge and belief.

Date Surveyed 5-4-1957

John W. Tietz
Registered Professional
Engineer and/or Land Surveyor.

Certificate No. 676