

NEW MEXICO
OIL CONSERVATION COMMISSION

Form C-128

Well Location and/or Gas Proration Plat

Date November 21, 1956

Operator Gulf Oil Corp. Lease F.W. Kutter "E"

Well No. 3 Section 10 Township 19-S Range 37-E NMPM

Located 1980 Feet From north Line, 1980 Feet From west Line,

Lea County, New Mexico. G. L. Elevation _____

Name of Producing Formation _____ Pool _____ Dedicated Acreage _____

(Note: All distances must be from outer boundaries of Section)

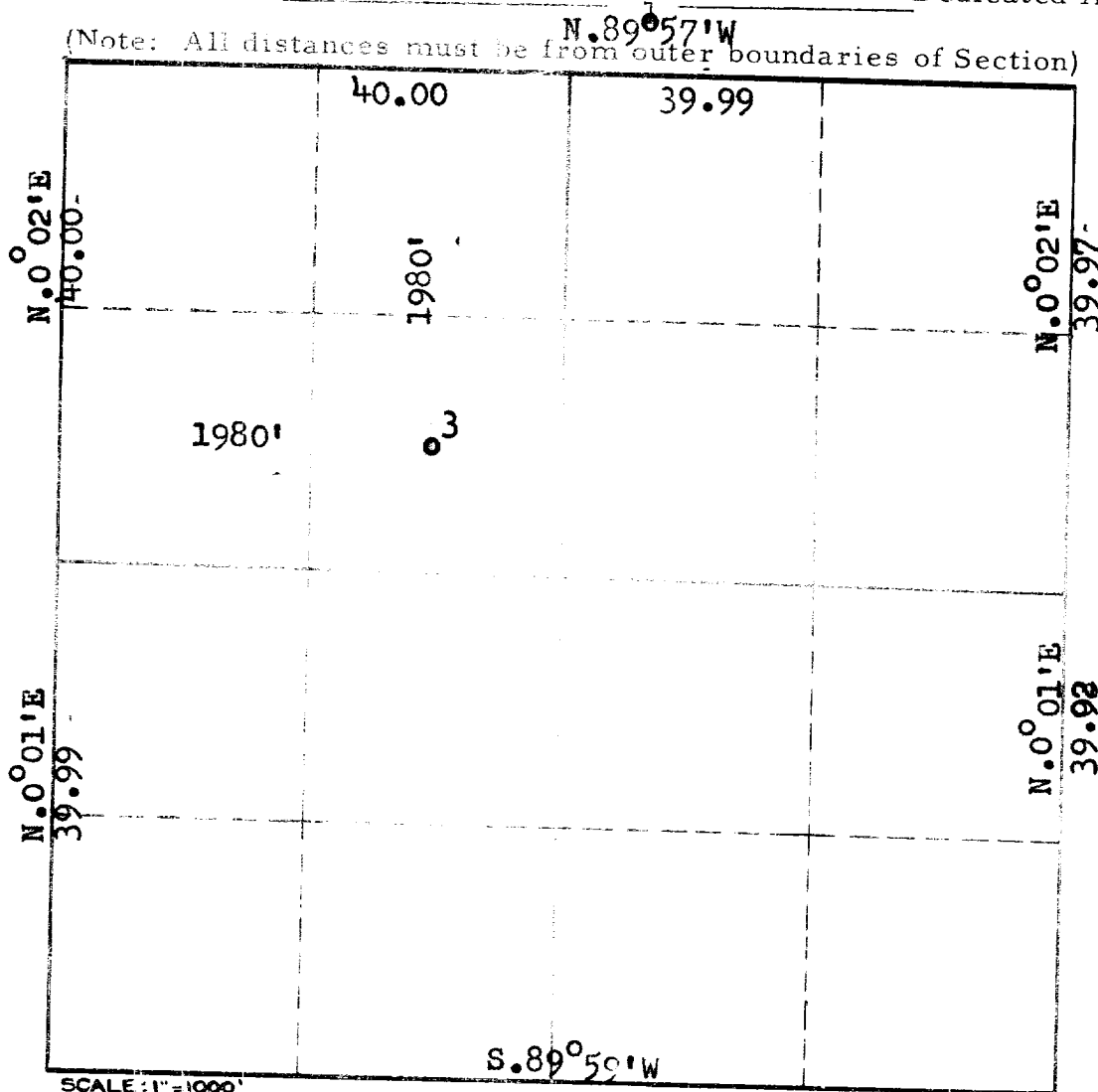

1. Is this Well a Dual Comp. ? Yes _____ No _____

2. If the answer to Question 1 is yes, are there any other dually completed wells within the dedicated acreage? Yes _____ No _____

This is to certify that the above plat was prepared from field notes of actual surveys made by me or under my supervision and that the same are true and correct to the best of my knowledge and belief.

Name _____
Position _____
Representing _____
Address _____

Date Surveyed 11-20-56

Registered Professional Engineer and/or
Land Surveyor J. B. Zant