

District I
PO Box 100, Hobbs, NM 88241-1000
District II
PO Drawer DD, Aramis, NM 88211-4719
District III
1000 Rio Grande Rd., Alamogordo, NM 87410
District IV
PO Box 2088, Santa Fe, NM 87504-2088

State of New Mexico
Energy, Minerals & Natural Resources Department

OIL CONSERVATION DIVISION
PO Box 2088
Santa Fe, NM 87504-2088

Form C-102
Revised February 10, 1994
Instructions on back
Submit to Appropriate District Office
State Lease - 4 Copies
Fee Lease - 3 Copies

☐ AMENDED REPORT

WELL LOCATION AND ACREAGE DEDICATION PLAT

API Number 30-025-05777		Pool Code 76480	Pool Name Eumont Yates SRQ Gas
Property Code 001513	Property Name J. R. Phillips B		Well Number 5
OGRID No. 000990	Operator Name ARCO Permian		Elevation 3584'

10 Surface Location

UL or lot no.	Section	Township	Range	Lot Idn	Feet from the	North/South line	Feet from the	East/West line	County
E	31	19S	37E		1980	North	990	West	Lea

11 Bottom Hole Location If Different From Surface

UL or lot no.	Section	Township	Range	Lot Idn	Feet from the	North/South line	Feet from the	East/West line	County

12 Deduct Acres 160	13 Joint or In/In	14 Consolidation Code	15 Order No.
------------------------	-------------------	-----------------------	--------------

NO ALLOWABLE WILL BE ASSIGNED TO THIS COMPLETION UNTIL ALL INTERESTS HAVE BEEN CONSOLIDATED OR A NON-STANDARD UNIT HAS BEEN APPROVED BY THE DIVISION

<p>Sec. 31-T19S-R37E</p>	<p>17 OPERATOR CERTIFICATION</p> <p>I hereby certify that the information contained herein is true and complete to the best of my knowledge and belief.</p> <p><i>David K. Newell</i></p> <p>Signature David K. Newell Printed Name Senior Engineer Title 12-19-96 Date</p>
	<p>18 SURVEYOR CERTIFICATION</p> <p>I hereby certify that the well location shown on this plat was plotted from field notes of actual surveys made by me or under my supervision, and that the same is true and correct to the best of my belief.</p> <p>Date of Survey Signature and Seal of Professional Surveyor</p> <p>H-44 CF-HOBBS CF-MIDLAND MURRISH MANTHEI</p> <p>Certificate Number</p>

District I
PO Box 1900, Hobbs, NM 88240
District II
PO Drawer DD, Artesia, NM 88211-0719
District III
1000 Rio Brazos Rd., Aztec, NM 87410
District IV
PO Box 2088, Santa Fe, NM 87504-2088

State of New Mexico
Energy, Minerals and Natural Resources Department

OIL CONSERVATION DIVISION
P.O. Box 2088
Santa Fe, New Mexico 87504-2088

Form C-102

Revised February 10, 1994

Instructions on back

Submit to Appropriate District Office

State Lease - 4 Copies

Fee Lease - 3 Copies

☐ AMENDED REPORT

WELL LOCATION AND ACREAGE DEDICATION PLAT

API Number 30-025-05777		Pool Code 76480	Pool Name EUMONT YATES SRQ GAS
Property Code 001513	Property Name J.R. PHILLIPS B		Well Number 5
OGRID No. 000990	Operator Name ARCO Permian		Elevation 3584' GR

¹⁰ Surface Location

UI or lot no. E	Section 31	Township 19S	Range 37E	Lot. Idn	Feet from the 1980'	North/South Line FNL	Feet from the 990'	East/West line FWL	County LEA
---------------------------	----------------------	------------------------	---------------------	----------	-------------------------------	--------------------------------	------------------------------	------------------------------	----------------------

¹¹ Bottom Hole Location If Different From Surface

UL or lot no.	Section	Township	Range	Lot. Idn	Feet from the	North/South Line	Feet from the	East/West line	County
---------------	---------	----------	-------	----------	---------------	------------------	---------------	----------------	--------

¹² Dedicated Acres 160	¹³ Joint or Infill	¹⁴ Consolidation Code	¹⁵ Order No.
---	-------------------------------	----------------------------------	-------------------------

**NO ALLOWABLE WILL BE ASSIGNED TO THIS COMPLETION UNTIL ALL INTERESTS HAVE BEEN CONSOLIDATED
OR A NON-STANDARD UNIT HAS BEEN APPROVED BY THE DIVISION**

	<p>¹⁷ OPERATOR CERTIFICATION I hereby certify that the information contained herein is true and complete to the best of my knowledge and belief.</p> <p><i>Kellie D. Murrish</i> Signature Kellie D. Murrish Printed Name Administrative Assistant Title 05/01/96 Date</p>
	<p>¹⁸ SURVEYOR CERTIFICATION I hereby certify that the well location shown on this plat was plotted from field notes of actual surveys made by me or under my supervision, and that the same is true and correct to the best of my belief.</p> <p>_____ Date of Survey _____ Signature and Seal of Professional Surveyor: _____ Certificate Number</p>

**NEW MEXICO OIL CONSERVATION COMMISSION
WELL LOCATION AND ACREAGE DEDICATION PLAT**

Form C-102
Supersedes C-128
Effective 1-1-65

All distances must be from the outer boundaries of the Section.

Operator ARCO Oil and Gas Company <small>Division of Atlantic Richfield Company</small>			Lease J. R. Phillips "B"		Well No. 5
Unit Letter E	Section 31	Township 19S	Range 37E	County Lea	
Actual Footage Location of Well: <div style="display: flex; justify-content: space-between; align-items: center;"> 990 feet from the West line and 660 feet from the South line </div>					
Ground Level Elev. 3584'	Producing Formation Yates, 7Rivers Queen		Pool Eumont Gas		Dedicated Acreage: 160 Acres

1. Outline the acreage dedicated to the subject well by colored pencil or hachure marks on the plat below.
2. If more than one lease is dedicated to the well, outline each and identify the ownership thereof (both as to working interest and royalty).
3. If more than one lease of different ownership is dedicated to the well, have the interests of all owners been consolidated by communitization, unitization, force-pooling, etc?

☐ Yes ☐ No If answer is "yes," type of consolidation _____

If answer is "no," list the owners and tract descriptions which have actually been consolidated. (Use reverse side of this form if necessary.) _____

No allowable will be assigned to the well until all interests have been consolidated (by communitization, unitization, forced-pooling, or otherwise) or until a non-standard unit, eliminating such interests, has been approved by the Commission.

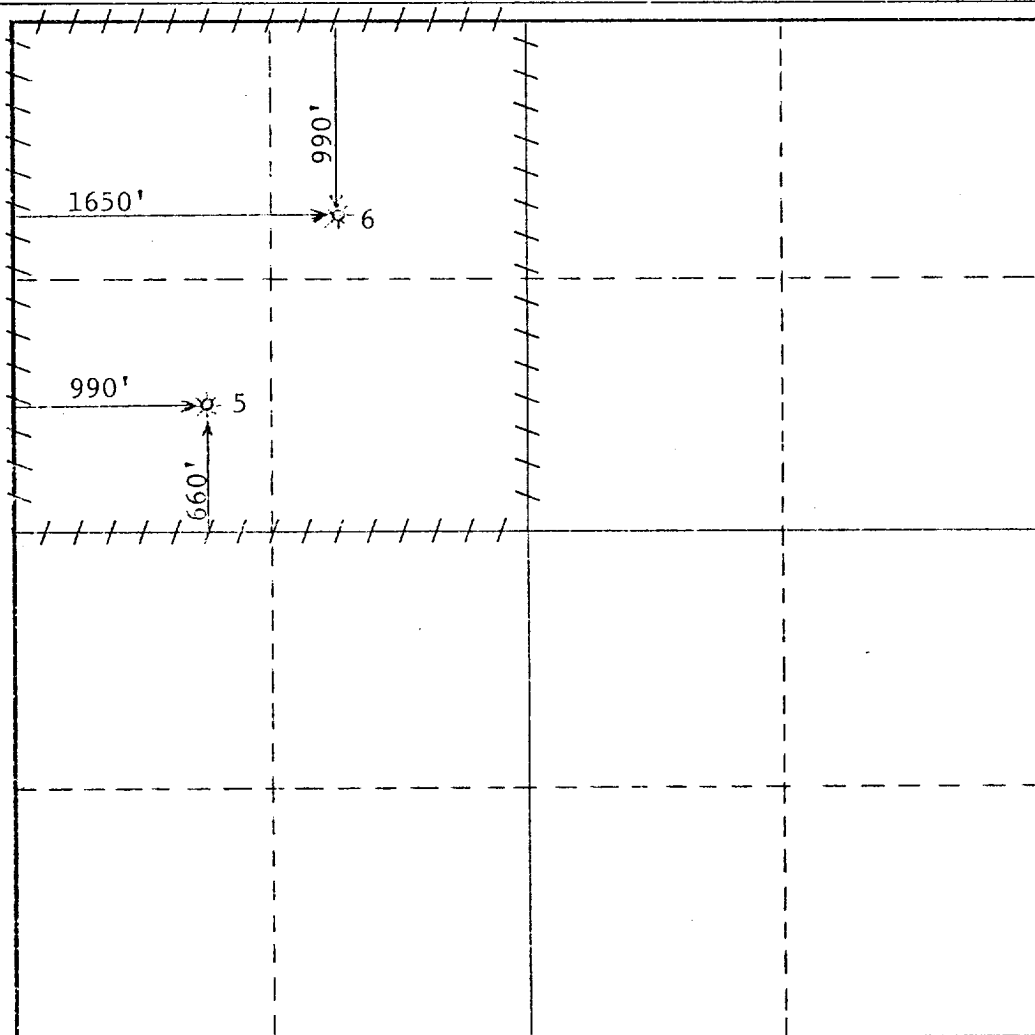

CERTIFICATION

I hereby certify that the information contained herein is true and complete to the best of my knowledge and belief.

Name *[Signature]*
 Position
 Dist. Drlg. Supt.
 Company **ARCO Oil and Gas Company**
Division of Atlantic Richfield Company
 Date **4/10/79**

I hereby certify that the well location shown on this plat was plotted from field notes of actual surveys made by me or under my supervision, and that the same is true and correct to the best of my knowledge and belief.

Date Surveyed _____
 Registered Professional Engineer
 and/or Land Surveyor

Certificate No. _____

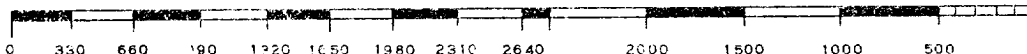

RECEIVED

APR 14 1973
OIL CONSERVATION COMM.
HOBBS, N. M.

Submit to Appropriate
District Office
State Lease - 4 copies
Fee Lease - 3 copies

State of New Mexico
Energy, Minerals and Natural Resources Department

Form C-102
Revised 1-1-89

OIL CONSERVATION DIVISION

DISTRICT I
P.O. Box 1980, Hobbs, NM 88240

P.O. Box 2088
Santa Fe, New Mexico 87504-2088

DISTRICT II
P.O. Drawer DD, Artesia, NM 88210

DISTRICT III
1000 Rio Brazos Rd., Aztec, NM 87410

WELL LOCATION AND ACREAGE DEDICATION PLAT

All Distances must be from the outer boundaries of the section

Operator ARCO Oil and Gas Company			Lease J.R. Phillips B		Well No. 5
Unit Letter E	Section 31	Township 19S	Range 37E	County NMPM	Lea
Actual Footage Location of Well: 1980 feet from the North line and 990 feet from the West line					
Ground level Elev. 3584 GR		Producing Formation Yates 7RQ		Pool Eumont	
				Dedicated Acreage: 40 Acres	

1. Outline the acreage dedicated to the subject well by colored pencil or hatchure marks on the plat below.

2. If more than one lease is dedicated to the well, outline each and identify the ownership thereof (both as to working interest and royalty).

3. If more than one lease of different ownership is dedicated to the well, have the interest of all owners been consolidated by communitization, unitization, force-pooling, etc.?

☐ Yes ☐ No If answer is "yes" type of consolidation _____

If answer is "no" list the owners and tract descriptions which have actually been consolidated. (Use reverse side of this form if necessary.) _____

No allowable will be assigned to the well until all interests have been consolidated (by communitization, unitization, forced-pooling, or otherwise) or until a non-standard unit, eliminating such interest, has been approved by the Division.

OPERATOR CERTIFICATION

I hereby certify that the information contained herein is true and complete to the best of my knowledge and belief.

James D. Cogburn
Signature

James D. Cogburn
Printed Name

Operations Coordinator
Position

ARCO Oil and Gas Co.
Company

09/02/93
Date

SURVEYOR CERTIFICATION

I hereby certify that the well location shown on this plat was plotted from field notes of actual surveys made by me or under my supervision, and that the same is true and correct to the best of my knowledge and belief.

Date Surveyed

Signature & Seal of
Professional Surveyor

Certificate No.

0 330 660 990 1320 1650 1980 2310 2640 2000 1500 1000 500 0

RECEIVED

SEP 18 1993

JOINT CHIEFS
OFFICE

NEW MEXICO
OIL CONSERVATION COMMISSION

Gas Well Plat

INDEXED BY 600
Date July 9, 1954

Sinclair Oil & Gas Company
Operator

Joseph R. Phillips "B"
Lease

5
Well No.

Name of Producing Formation Queen Pool Sumont Gas

No. Acres Dedicated to the Well 160

SECTION 31 TOWNSHIP 19-S RANGE 37-E

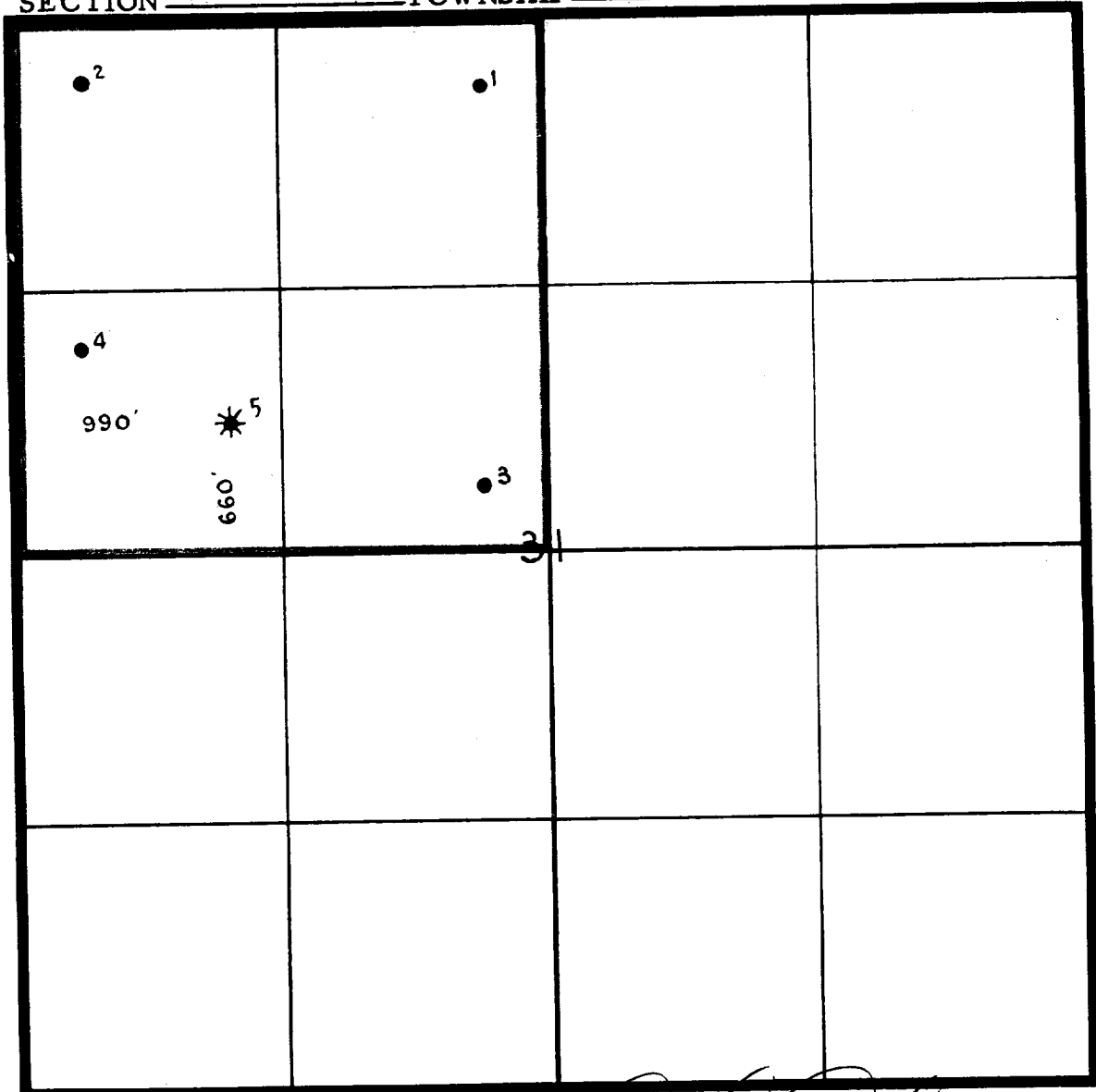

I hereby certify that the information given above is true and complete to the best of my knowledge.

Name [Signature]
Position Vice-President
Representing Sinclair Oil & Gas Company
Address P.O. Box 521, Tulsa, Oklahoma

(over)

INSTRUCTIONS

1. Is this gas well a dual completion? Yes ____ No **X**.
2. If the answer to Question 1 is Yes, are there any other dually completed wells within the dedicated acreage? Yes _____ No **X**

A separate plat must be filed for each gas well, outlining the area dedicated to such well and showing the location of all other wells (oil and gas) within the outlined area.

Mail in duplicate to the district office for the district in which the well is located.