

NEW MEXICO
OIL CONSERVATION COMMISSION

Form C-128

Well Location and/or Correlation Plat

Date FEB 7 1956

Operator CONTINENTAL OIL CO

Well No. 2 Section 2 Township 20S Range 37E NMPM

Located 660 Feet From EAST Line, 1980 Feet From SOUTH Line,

LEA

County, New Mexico. G. L. Elevation _____

Name of Producing Formation _____ Pool _____ Dedicated Acreage _____

(Note: All distances must be from outer boundaries of Section)

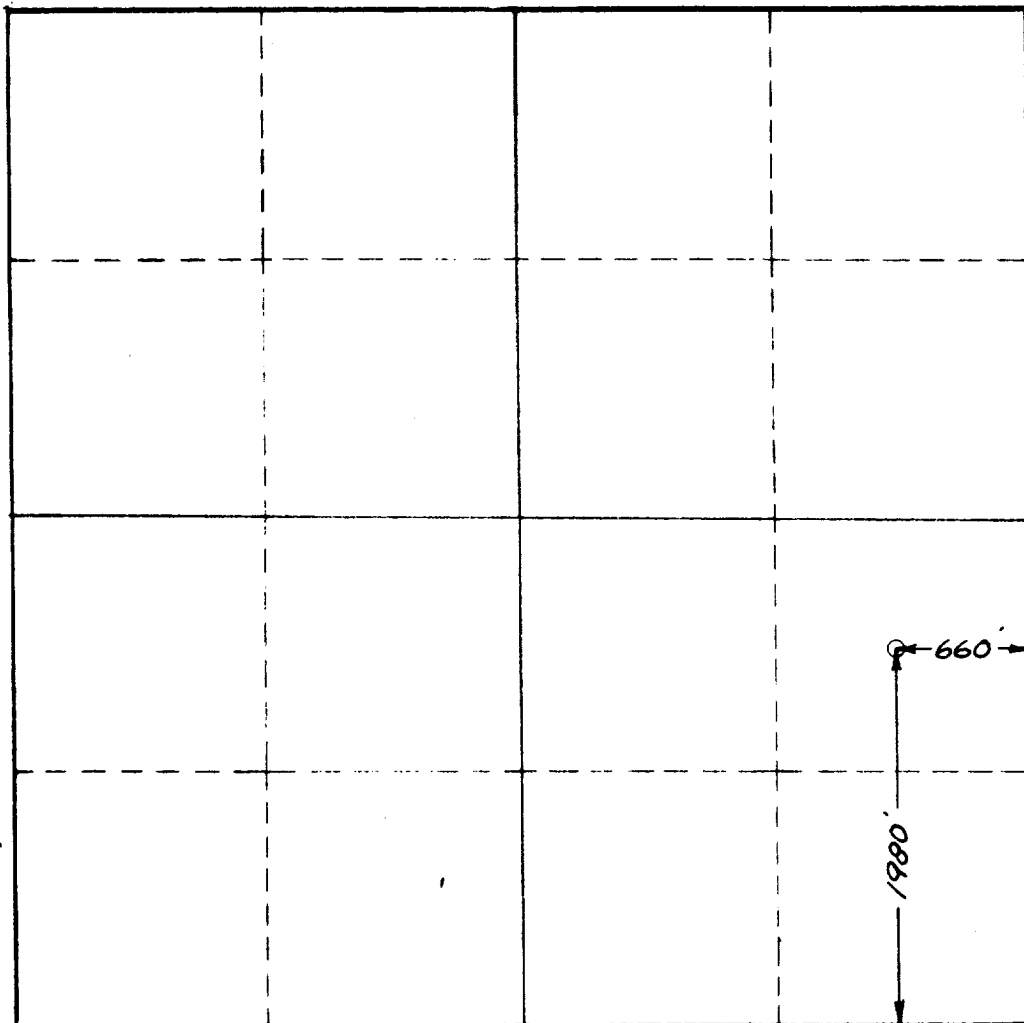

SCALE: 1"=1000'

1. Is this Well a Dual Comp.? Yes ___ No ___
2. If the answer to Question 1 is yes, are there any other dually completed wells within the dedicated acreage? Yes ___ No ___

This is to certify that the above plat was prepared from field notes of actual surveys made by me or under my supervision and that the same are true and correct to the best of my knowledge and belief.

Name _____
Position _____
Representing _____
Address _____

Date Surveyed JAN 23 1956

John W. West
Registered Professional Engineer and/or
Land Surveyor