

NEW MEXICO OIL CONSERVATION COMMISSION

Santa Fe, New Mexico

H0385 OFFICE DEC 6 AM 7:30

NOTICE OF INTENTION TO DRILL OR RECOMPLETE

Notice must be given to the District Office of the Oil Conservation Commission and approval obtained before drilling or recompletion begins. If changes in the proposed plan are considered advisable, a copy of this notice showing such changes will be returned to the sender. Submit this notice in **QUINTUPPLICATE**. One copy will be returned following approval. See additional instructions in Rules and Regulations of the Commission.

Midland, Texas

(Place)

6-30-54

(Date)

OIL CONSERVATION COMMISSION
SANTA FE, NEW MEXICO

Gentlemen:

You are hereby notified that it is our intention to commence the ~~(Drilling)~~ (Recompletion) of a well to be known as

Tennessee Production Company

(Company or Operator)

Ellen Weir

(Lease)

Well No. **1**

in **L**

(Unit)

The well is

located **330**

feet from the **West**

line and **2316**

feet from the

South

line of Section **3**

T. **20-S**

R. **37-E**

NMPM.

Eumont

Pool, **Lea**

County

(GIVE LOCATION FROM SECTION LINE)

If State Land the Oil and Gas Lease is No.

If patented land the owner is **Ellen Weir est.**

Address.

We propose to drill well with drilling equipment as follows:

Reverse circulation rig

The status of plugging bond is **in effect**

Drilling Contractor

We intend to complete this well in the **Queens Sand**

formation at an approximate depth of **3526'-3640'** feet.

CASING PROGRAM

We propose to use the following strings of Casing and to cement them as indicated:

Size of Hole	Size of Casing	Weight per Foot	New or Second Hand	Depth	Sacks Cement

If changes in the above plans become advisable we will notify you immediately.

ADDITIONAL INFORMATION (If recompletion give full details of proposed plan of work.)

1. Plug open hole section from casing shoe (3646) to T.D. (3784') with cement.
2. Perforate & squeeze cement above top of gas sand at 3526'.
3. Recomplete well as a gas producer by perforating casing 3526'-3638'.

Approved....., 19.....
Except as follows:

OIL CONSERVATION COMMISSION

By

Title

Sincerely yours,

TENNESSEE PRODUCTION COMPANY

(Company or Operator)

By

Position

ENGINEER

Send Communications regarding well to

Name

TENNESSEE PRODUCTION CO.

Address

Box 1031

Midland, Texas

W. W. STUDDERT
MEMBER
AMERICAN SOCIETY OF
CIVIL ENGINEERS

REGISTERED ENGINEERS
& LAND SURVEYORS

ARIZONA
COLORADO
IDAHO
LOUISIANA
MONTANA
NEVADA
NEW MEXICO
OKLAHOMA
TEXAS
UTAH
WYOMING

STUDDERT ENGINEERING CO.

CIVIL ENGINEERS

TELEPHONES 4-8682 & 2-1373

221 SOUTH COLORADO
MIDLAND, TEXAS

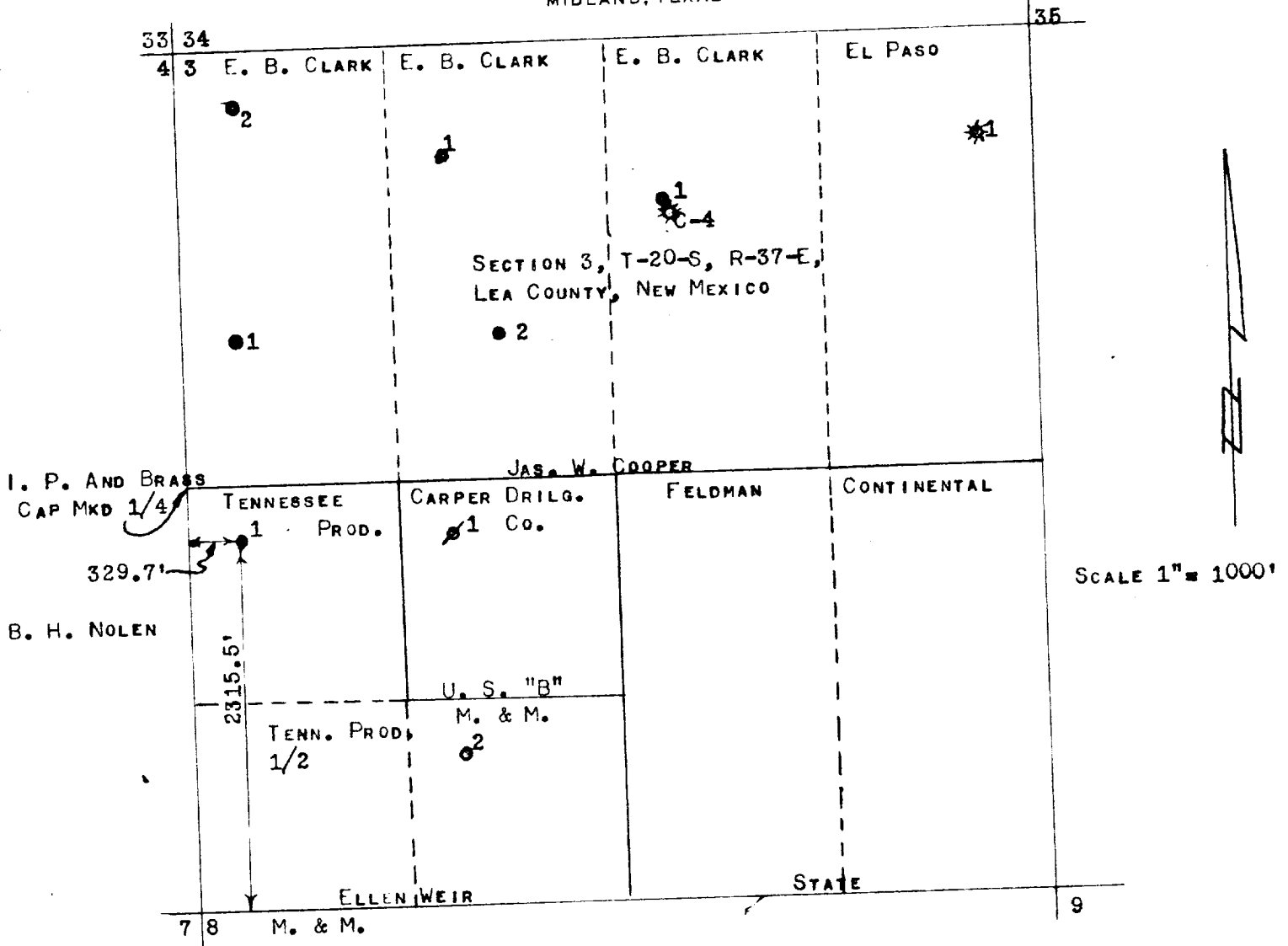

I, EARL K. MONTEITH, REGISTERED LAND SURVEYOR No. 1317, STATE OF NEW MEXICO, HEREBY CERTIFY THAT THIS WELL: TENNESSEE PRODUCTION CO.-ELLEN WEIR #1, 2315.5' FROM THE SOUTH LINE AND 329.7' FROM THE WEST LINE, SECTION 3, T-20-S, R-37-E, LEA COUNTY, NEW MEXICO, WAS SURVEYED ON THE GROUND UNDER MY SUPERVISION THAT THIS PLAT IS TRUE AND CORRECT.

MAY 17, 1954

Earl K. Monteith
EARL K. MONTEITH