

NEW MEXICO OIL CONSERVATION COMMISSION
Santa Fe, New Mexico

MISCELLANEOUS NOTICES

Submit this notice in **TRIPPLICATE** to the District Office, Oil Conservation Commission, before the work specified is to begin. A copy will be returned to the sender on which will be given the approval, with any modifications considered advisable, or the rejection by the Commission or agent, of the plan submitted. The plan as approved should be followed, and work should not begin until approval is obtained. See additional instructions in the Rules and Regulations of the Commission.

Indicate Nature of Notice by Checking Below

NOTICE OF INTENTION TO CHANGE PLANS		NOTICE OF INTENTION TO TEMPORARILY ABANDON WELL		NOTICE OF INTENTION TO DRILL DEEPER	
NOTICE OF INTENTION TO PLUG WELL		NOTICE OF INTENTION TO PLUG BACK	X	NOTICE OF INTENTION TO SET LINER	
NOTICE OF INTENTION TO SQUEEZE	X	NOTICE OF INTENTION TO ACIDIZE		NOTICE OF INTENTION TO SHOOT (Nitro)	
NOTICE OF INTENTION TO GUN PERFORATE	X	NOTICE OF INTENTION (OTHER)		NOTICE OF INTENTION (OTHER)	

OIL CONSERVATION COMMISSION
SANTA FE, NEW MEXICO

Midland, Texas

6-30-54

(Place)

(Date)

Gentlemen:

Following is a Notice of Intention to do certain work as described below at the.....

Tennessee Production Company

Ellen Weir

Well No. **1** in **L**

(Company or Operator)

(Unit)

NW 1/4 **SW** 1/4 of Sec. **3**, T. **-20-S**, R. **-37-E**, NMPM., **Eumont** Pool

(40-acre Subdivision)

Lea

County.

FULL DETAILS OF PROPOSED PLAN OF WORK
(FOLLOW INSTRUCTIONS IN THE RULES AND REGULATIONS)

1. Plug open hole section from casing shoe 3646 to T.D. 3784 with cement.
2. Load hole with mud laden fluid.
3. Squeeze cement through perforations in casing at 3520' to protect formations above gas sand.
4. Perforate the casing opposite the gas sand from 3526' to 3638' with four shots per foot.
5. Cleanout and produce gas from Queens Sand in Eumont Pool.

Approved....., 19.....
Except as follows:

Approved
OIL CONSERVATION COMMISSION

By.....

Title.....

TENNESSEE PRODUCTION COMPANY

Company or Operator

By.....

Position.....

Send Communications regarding well to:

Name.....

Address.....

W. W. STUDDERT
MEMBER
AMERICAN SOCIETY OF
CIVIL ENGINEERS

REGISTERED ENGINEERS
& LAND SURVEYORS

ARIZONA
COLORADO
IDAHO
LOUISIANA
MONTANA
NEVADA
NEW MEXICO
OKLAHOMA
TEXAS
UTAH
WYOMING

STUDDERT ENGINEERING CO.

CIVIL ENGINEERS

TELEPHONES 4-8682 & 2-1373

221 SOUTH COLORADO

MIDLAND, TEXAS

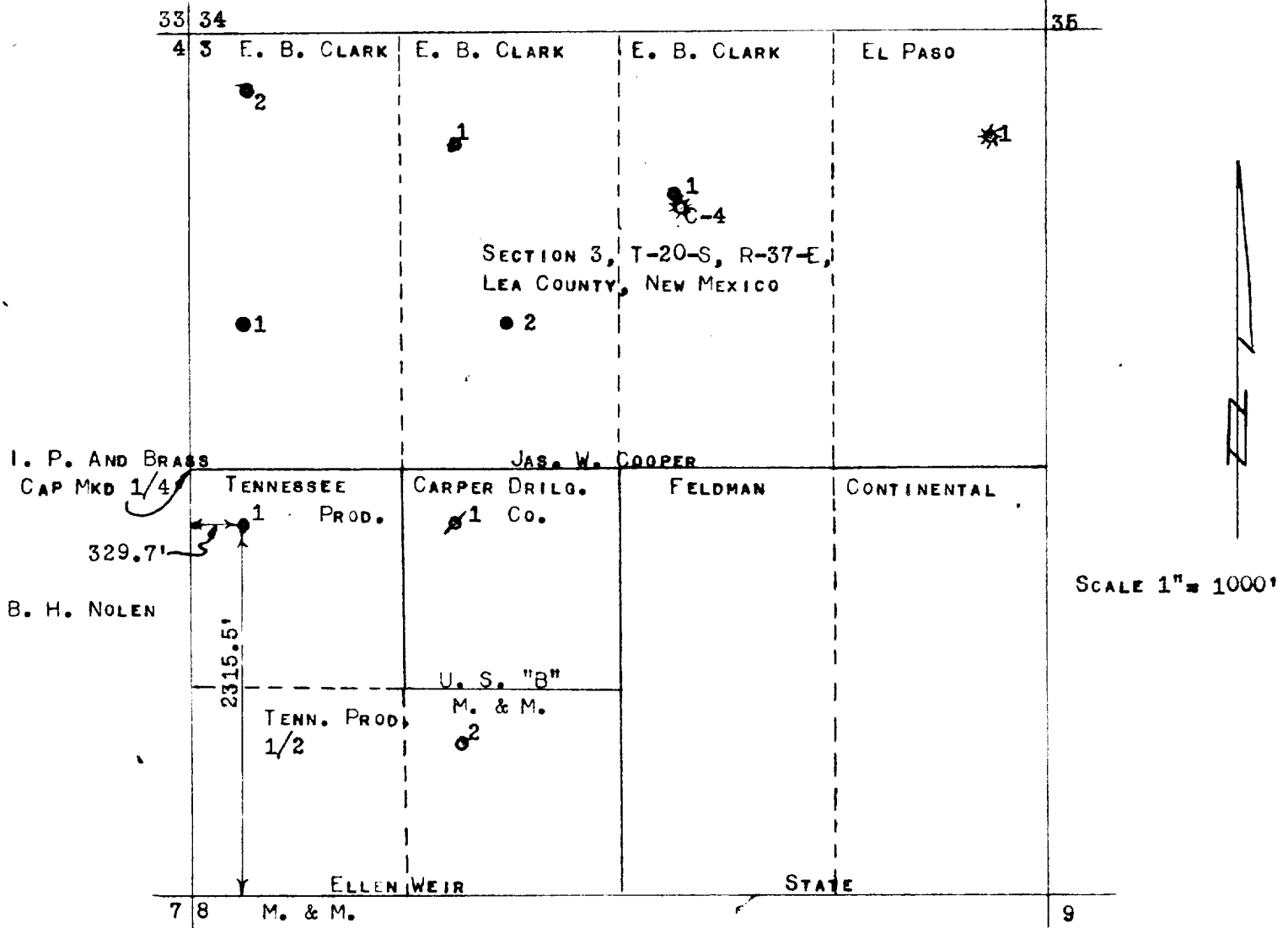

I, EARL K. MONTEITH, REGISTERED LAND SURVEYOR No. 1317, STATE OF NEW MEXICO, HEREBY CERTIFY THAT THIS WELL: TENNESSEE PRODUCTION CO.-ELLEN WEIR #1, 2315.5' FROM THE SOUTH LINE AND 329.7' FROM THE WEST LINE, SECTION 3, T-20-S, R-37-E, LEA COUNTY, NEW MEXICO, WAS SURVEYED ON THE GROUND UNDER MY SUPERVISION THAT THIS PLAT IS TRUE AND CORRECT.

MAY 17, 1954

Earl K. Monteith
EARL K. MONTEITH