

Submit Appropriate
District Office
State Lease - 4 copies
Fee Lease - 3 copies

State of New Mexico
Energy, Minerals and Natural Resources Department

Form C-111
Revised 1-1-88

OIL CONSERVATION DIVISION

P.O. Box 2088
Santa Fe, New Mexico 87504-2088

DISTRICT I
P.O. Box 1980, Hobbs, NM 88240

DISTRICT II
P.O. Drawer DD, Artesia, NM 88210

DISTRICT III
1000 Rio Brazos Rd., Aztec, NM 87410

WELL LOCATION AND ACREAGE DEDICATION PLAT

All Distances must be from the outer boundaries of the section

Operator MARATHON OIL COMPANY			Lease BERTHA BARBER		Well No. 4
Unit Letter K	Section 5	Township 20-S	Range 37-E	County LEA	
Actual Footage Location of Well: 1980 feet from the SOUTH line and 1980 feet from the WEST line					
Ground level Elev. 3571'	Producing Formation EUMONT		Pool EUMONT (Y-SR-Q)		Dedicated Acreage: 320 Acres

1. Outline the acreage dedicated to the subject well by colored pencil or hatchure marks on the plat below.

2. If more than one lease is dedicated to the well, outline each and identify the ownership thereof (both as to working interest and royalty).

3. If more than one lease of different ownership is dedicated to the well, have the interest of all owners been consolidated by communitization, unitization, force-pooling, etc.?

☐ Yes ☐ No If answer is "yes" type of consolidation

If answer is "no" list the owners and tract descriptions which have actually been consolidated. (Use reverse side of this form if necessary.)

No allowable well be assigned to the well until all interests have been consolidated (by communitization, unitization, forced-pooling, or otherwise) or until a non-standard unit, eliminating such interest, has been approved by the Division.

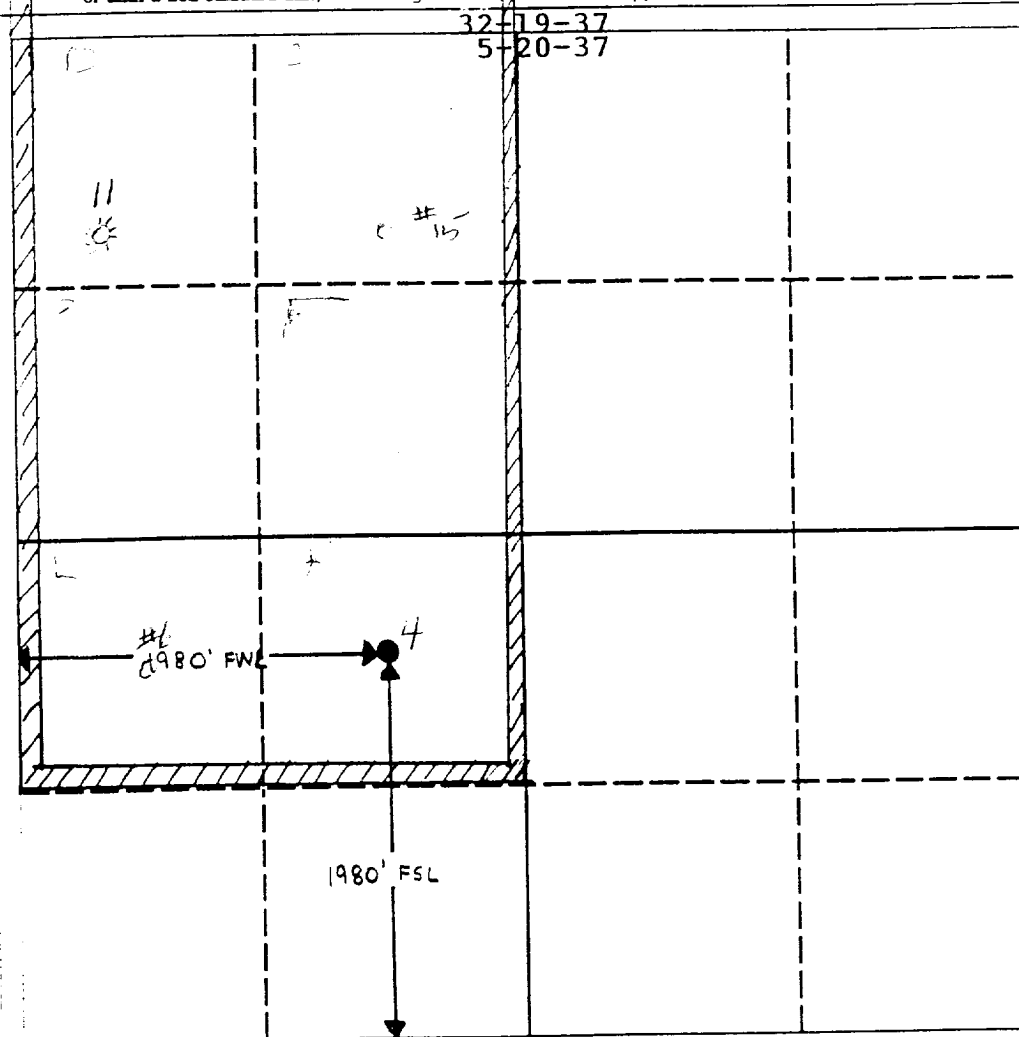

OPERATOR CERTIFICATION

I hereby certify that the information contained herein is true and complete to the best of my knowledge and belief.

Signature
Brent D Lockhart

Printed Name
BRENT D. LOCKHART

Position
ADVANCED ENG. TECH

Company
MARATHON OIL COMPANY

Date
NOVEMBER 3, 1992

SURVEYOR CERTIFICATION

I hereby certify that the well location shown on this plat was plotted from field notes of actual surveys made by me or under my supervision, and that the same is true and correct to the best of my knowledge and belief.

Date Surveyed

Signature & Seal of
Professional Surveyor

Certificate No.

OWWO

COUNTY	LEA	FIELD Monument	STATE NM. MN 05909
OPR	MARATHON OIL CO.		MAP
	4 Barber, Bertha		
	Sec 5, T-20-S, R-37-E		CO-ORD
	1980' FSL, 1980' FWL of Sec.		

	CLASS		EL	
	FORMATION	DATUM	FORMATION	DATUM
Re-Cmp 7-18-69				
CSG & SX - TUBING				
13" at 151' w/150 sx				
9 5/8" at 1131' w/500 sx				
7" at 3770' w/450 sx				
LOGS EL GR RA IND HC A				

TD 3895'; PBD 3765'

IP (San Andres) Perfs 3664-3706' F 138 BOPD + 128 BW. Pot based on 24 hr test thru 20/64" chk, TP 220#

Distribution limited and publication prohibited by subscribers' agreement.
Reproduction rights reserved by Williams & Lee Scouting Service, Inc.

CONT.	PROP DEPTH 3760'	TYPE WO
DATE		

8-18-69	<p>F.R.C. 8-21-69</p> <p>PD 3760' WO (San Andres)</p> <p>(Orig. The Ohio Oil Co. #4 Bertha J. Barber, comp. 11-15-36 from OH 3770-3895', OTD 3895')</p> <p>TD 3895'; PBD 3765'; COMPLETE</p> <p>Sqzd OH 3770-3895'</p> <p>Perf @ 3725', 3730', 3735', 3736', 3740', 3750', 3758' w/1 SPI</p> <p>Acid (3725-58') 1500 gals</p> <p>Sqzd 3725-58' w/60 sx</p> <p>Perf @ 3664', 3668', 3672', 3676', 3678', 3682', 3686', 3692', 3697', 3703', 3706' w/1 SPI</p> <p>Acid (3664-3706') 1200 gals</p>
8-21-69	<p>COMPLETION REPORTED</p>