

DISTRICT I
 P. O. Box 1980
 Hobbs, NM 88241-1980

DISTRICT II
 P. O. Drawer DD
 Artesio, NM 88211-0719

DISTRICT III
 1000 Rio Brazos Rd.
 Aztec, NM 87410

DISTRICT IV
 P. O. Box 2088
 Santa Fe, NM 87507-2088

State of New Mexico
 Energy, Minerals, and Natural Resources Department

Form C-102
 Revised 02-10-94
 Instructions on back

RUC'D / MIDLAND

Submit to the Appropriate
 District Office
 State Lease - 4 copies
 Fee Lease - 3 copies

OIL CONSERVATION DIVISION NOV - 6 1998
 P. O. Box 2088
 Santa Fe, New Mexico 87504-2088

AMENDED REPORT

WELL LOCATION AND ACREAGE DEDICATION PLAT

| | | | | | | | | | |
|---|--------------|--|----------------------------|-----------------------------|-----------------------|---------------------------|-----------------------|------------------------|---------------|
| 1 API Number 30-025-05978 | | 2 Pool Code 46970 | | 3 Pool Name Monument Abo | | | | | |
| 4 Property Code 003341 | | 5 Property Name BERTHA J. BARBER | | | | | | 6 Well Number 12 | |
| 7 OGRID No. 005380 | | 8 Operator Name CROSS TIMBERS OPERATING COMPANY | | | | | | 9 Elevation 3554' | |
| 10 SURFACE LOCATION | | | | | | | | | |
| UL or lot no. A | Section 7 | Township 20 SOUTH | Range 37 EAST, N.M.P.M. | Lot Ida | Feet from the 335' | North/South line NORTH | Feet from the 647' | East/West line EAST | County LEA |
| "BOTTOM HOLE LOCATION IF DIFFERENT FROM SURFACE | | | | | | | | | |
| UL or lot no. | Section | Township | Range | Lot Ida | Feet from the | North/South line | Feet from the | East/West line | County |
| 12 Dedicated Acres | | 13 Joint or Infill | | 14 Consolidation Code | | 15 Order No. | | | |

NO ALLOWABLE WELL BE ASSIGNED TO THIS COMPLETION UNTIL ALL INTERESTS HAVE BEEN CONSOLIDATED OR A NON-STANDARD UNIT HAS BEEN APPROVED BY THE DIVISION

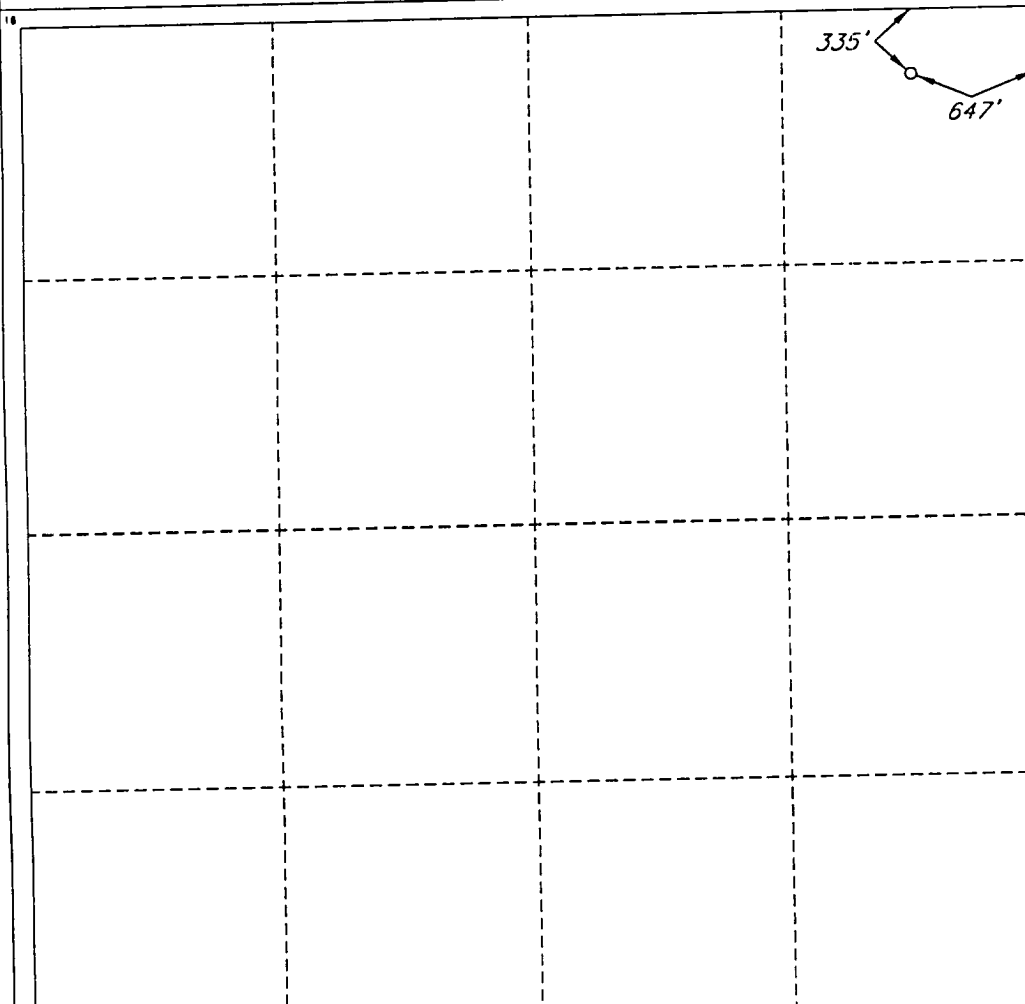

OPERATOR CERTIFICATION

I hereby certify that the information contained herein is true and complete to the best of my knowledge and belief.

Signature
Mark A. Gosch
 Printed Name
 Mark A. Gosch
 Title
 Drilling Engineer
 Date
 November 9, 1998

SURVEYOR CERTIFICATION

I hereby certify that the well location shown on this plat was plotted from field notes of actual surveys made by me or under my supervision, and that the same is true and correct to the best of my belief.

Date of Survey
 NOVEMBER 11 1998
 Signature and Seal of Professional Surveyor

 Certificate No. 12128
 ROGER M. ROBBINS #12128