

NEW MEXICO OIL CONSERVATION COMMISSION  
WELL LOCATION AND ACREAGE DEDICATION PLAT

Supervisor's Office  
1100 North 1st St.  
Albuquerque, N.M. 87102

All distances must be from the outer boundaries of the Section

Owner <b>Amerada Hess Corporation</b>			Lessee <b>T. Anderson</b>		Well No. <b>1</b>
Section <b>K</b>	Section <b>8</b>	Range <b>20-S</b>	Range <b>37-E</b>	County <b>Lea</b>	
Acres of Section Dedication					
1980		South		1980	
East from the		East from the		West	
3543' DF		7 Rvrs. Queen		Eumont Gas	
				80	

1. Outline the acreage dedicated to the subject well by colored pencil or hachure marks on the plat below.
2. If more than one lease is dedicated to the well, outline each and identify the ownership thereof (both as to working interest and royalty).
3. If more than one lease of different ownership is dedicated to the well, have the interests of all owners been consolidated by communitization, unitization, force-pooling, etc?

☐ Yes ☐ No If answer is "yes," type of consolidation \_\_\_\_\_

If answer is "no," list the owners and tract descriptions which have actually been consolidated. (Use reverse side of this form if necessary.) \_\_\_\_\_

No allowable will be assigned to the well until all interests have been consolidated (by communitization, unitization, forced-pooling, or otherwise) or until a non-standard unit, eliminating such interests, has been approved by the Commission.

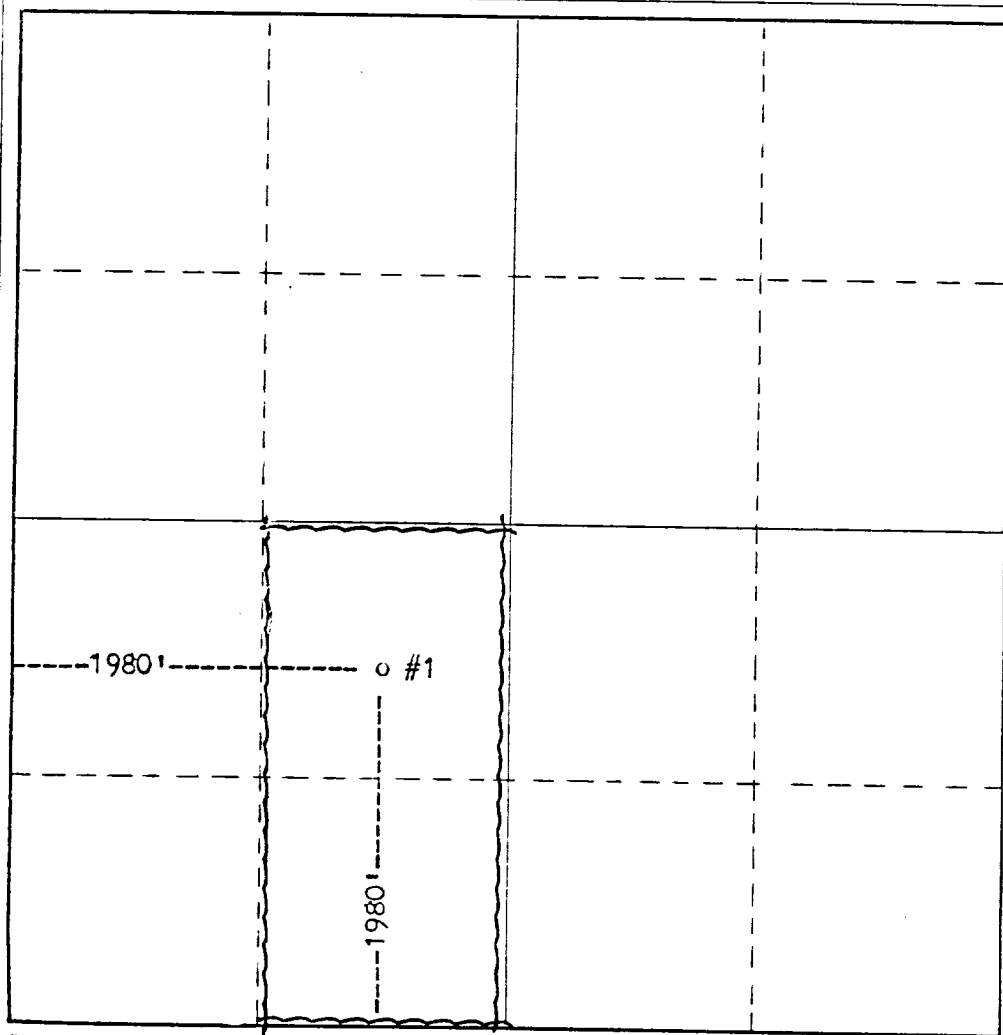

CERTIFICATION

I hereby certify that the information contained herein is true and complete to the best of my knowledge and belief.

Name  
*[Signature]*  
Position  
**Supvr., Admin. Services**  
Company  
**Amerada Hess Corporation**  
Date  
**4-8-74**

I hereby certify that the well location shown on this plat was plotted from field notes of actual surveys made by me or under my supervision, and that the same is true and correct to the best of my knowledge and belief.

Date Surveyed

Registered Professional Engineer and/or Land Surveyor

Certificate No.

RECEIVED

APR 11 1965  
OIL CONSERVATION COM. L.  
HOUSTON, TEX.