

DISTRICT I

P.O. Box 1980, Hobbs, NM 88241-1980

DISTRICT II

P.O. Box Drawer DD, Artesia, NM 88211-0719

DISTRICT III

1000 Rio Brazos Rd., Aztec, NM 87410

DISTRICT IV

P.O. Box 2088, Santa Fe, NM 87504-2088

State of New Mexico
Energy, Minerals and Natural Resources Department**OIL CONSERVATION DIVISION**P.O. Box 2088
Santa Fe, New Mexico 87504-2088

Form C-101

Revised February 10, 1994

Instructions on back

Submit to Appropriate District Office

State Lease - 6 Copies

Fee Lease - 5 Copies

☒ AMENDED REPORT**APPLICATION FOR PERMIT TO DRILL, RE-ENTER, DEEPEN, PLUGBACK, OR ADD A ZONE**

¹ Operator Name and Address TEXACO EXPLORATION & PRODUCTION INC. P.O. BOX 730, HOBBS, NM 88240		² OGRID Number 022351
⁴ Property Code 11127	⁵ Property Name L VAN ETTEN	³ API Number 30-025-06049
		⁶ Well No. 9

7 Surface Location

Ul or lot no.	Section	Township	Range	Lot.Idn	Feet From The	North/South Line	Feet From The	East/West Line	County
L	9	20-S	37-E		1650	SOUTH	990	WEST	LEA

8 Proposed Bottom Hole Location If Different From Surface

Ul or lot no.	Section	Township	Range	Lot.Idn	Feet From The	North/South Line	Feet From The	East/West Line	County

⁹ Proposed Pool 1 MONUMENT PADDOCK	¹⁰ Proposed Pool 2
--	-------------------------------

¹¹ Work Type Code E	¹² WellType Code O	¹³ Rotary or C.T. R	¹⁴ Lease Type Code S	¹⁵ Ground Level Elevation 3540'
¹⁶ Multiple No	¹⁷ Proposed Depth 5350'	¹⁸ Formation PADDOCK	¹⁹ Contractor PRIDE	²⁰ Spud Date 4/13/96

21 Proposed Casing and Cement Program

SIZE OF HOLE	SIZE OF CASING	WEIGHT PER FOOT	SETTING DEPTH	SACKS OF CEMENT	EST. TOP
14.5"	10.75"	40.50#	200'	200sx	Circ.
8.75"	7"	20.00#	3531'	120Csx	Circ.
8.75 O. H.			3770'		

22 Describe the proposed program. If this application is to DEEPEN or PLUG BACK give the data on the present productive zone and proposed new productive zone. Describe the blowout prevention program, if any. Use additional sheets if necessary.

Well was P & A 7/31/84.

1. MIRU pulling unit. Drill out cement plugs @ 0'-250', 1105'-1250', 2225'-2370', 3092'-3150' & 3355'-3500'.

2. Drill new 6-1/4" hole from base of 7" set @ 3531' to new TD of 5350'.

3. Run 5350' of 4-1/2" csg. Cement in two stages w/DV +/- 3100'.

1st stage: 275 sxs 50/50 Poz 'H'. Designed to circ cement thru DV tool.

2nd stage: 150 sxs 35/65 Poz 'H' followed by 100 sxs Class 'H' Neat. Designed to circ to surface.

4. Drill out DV, clean out to +/- 5330'.

5. Perforate Monument Paddock

6. Acidize w/1500 gallons 15% NEFE HCl Acid.

7. Place on Pump.

Permit Expires 1 Year From Approval
Date Unless ~~Being~~ Underway

Re-Entry

23 I hereby certify that the rules and regulations of the Oil Conservation Division have been complied with and that the information given above is true and complete to the best of my knowledge and belief.

Signature *Paul R. Wilcox*

Printed Name Paul R. Wilcox

Title Field Technician

Date 2/28/96

Telephone 397-0442

OIL CONSERVATION DIVISION

Approved By: ORIGINAL SIGNED BY JERRY SEXTON

DISTRICT I SUPERVISOR

Title:

Approval Date MAR 07 1996

Expiration Date:

Conditions of Approval:

Attached ☐

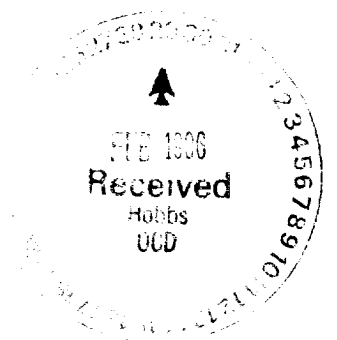

DISTRICT I

P.O. Box 1980, Hobbs, NM 88241-1980

DISTRICT II

P.O. Box Drawer DD, Artesia, NM 88211-0719

DISTRICT III

1000 Rio Brazos Rd., Aztec, NM 87410

DISTRICT IV

P.O. Box 2088, Santa Fe, NM 87504-2088

State of New MexicoEnergy, Minerals and Natural Resources Dep. pnt

Form C-102

Revised February 10, 1994

Instructions on back

Submit to Appropriate District Office

State Lease - 4 Copies

Fee Lease - 3 Copies

☒ AMENDED REPORT**OIL CONSERVATION DIVISION**

P.O. Box 2088

Santa Fe, New Mexico 87504-2088

WELL LOCATION AND ACREAGE DEDICATION PLAT

¹ API Number 30-025-06049	² Pool Code 47080	³ Pool Name MCINUMENT PADDOCK
⁴ Property Code 11127	⁵ Property Name L VAN ETEN	⁶ Well No. 9
⁷ OGRID Number 022351	⁸ Operator Name TEXACO EXPLORATION & PRODUCTION INC.	⁹ Elevation 3540'

¹⁰ Surface Location

Ul or lot no.	Section	Township	Range	Lot.Idn	Feet From The	North/South Line	Feet From The	East/West Line	County
L	9	20-S	37-E		1650	SOUTH	990	WEST	LEA

¹¹ Bottom Hole Location If Different From Surface

Ul or lot no.	Section	Township	Range	Lot.Idn	Feet From The	North/South Line	Feet From The	East/West Line	County

¹² Dedicated Acres 40	¹³ Joint or Infill No	¹⁴ Consolidation Code	¹⁵ Order No.
-------------------------------------	-------------------------------------	----------------------------------	-------------------------

NO ALLOWABLE WILL BE ASSIGNED TO THIS COMPLETION UNTIL ALL INTERESTS HAVE BEEN CONSOLIDATED
OR A NON-STANDARD UNIT HAS BEEN APPROVED BY THE DIVISION

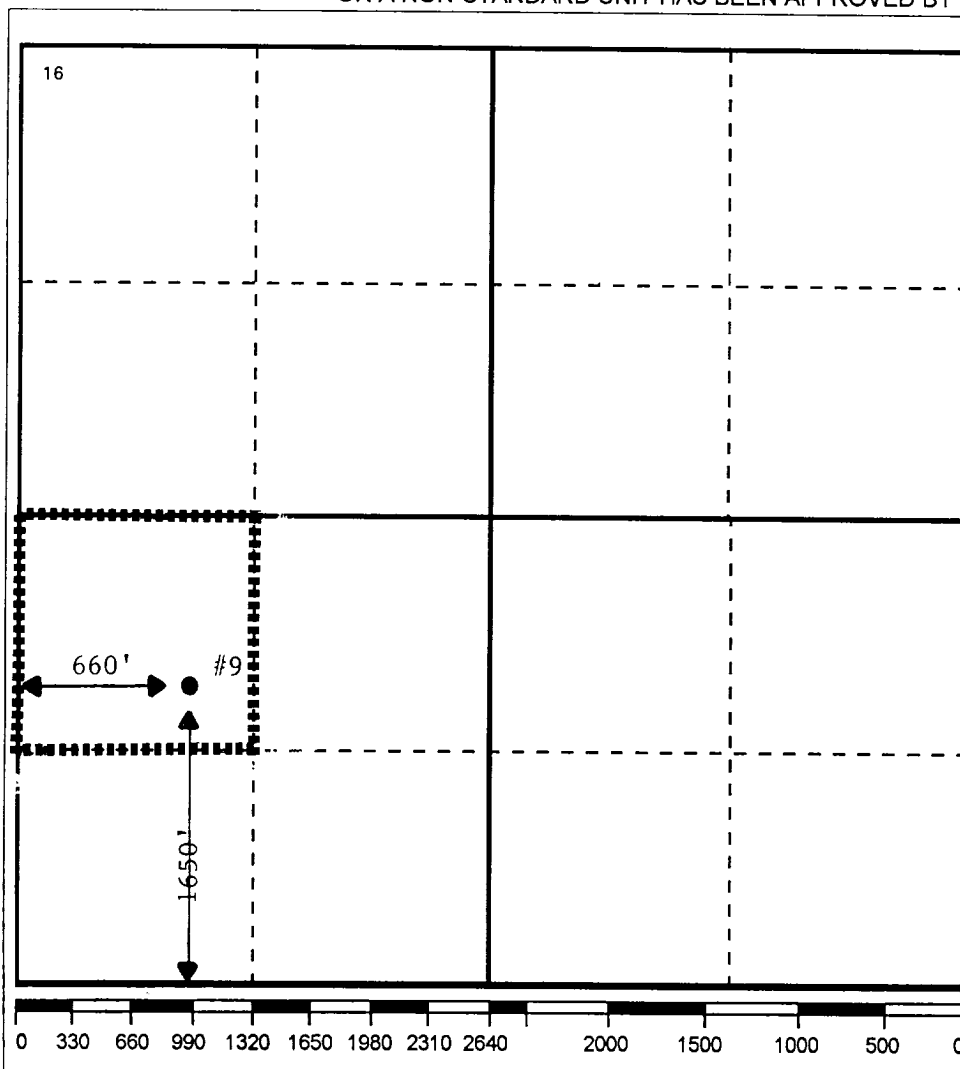
**17 OPERATOR CERTIFICATION**

I hereby certify that the information contained herein is true and complete to the best of my knowledge and belief

Signature

Paul R. Wilcox

Printed Name

Paul R. Wilcox

Position

Field Technician

Date

2/28/96

18 SURVEYOR CERTIFICATION

I hereby certify that the well location shown on this plat was plotted from field notes of actual surveys made by me or under my supervision, and that the same is true and correct to the best of my knowledge and belief.

Date Surveyed

Signature & Seal of

Professional Surveyor

Certificate No.

